

Revised Site Plan for BISTRO of JAPAN O'Fallon, MO

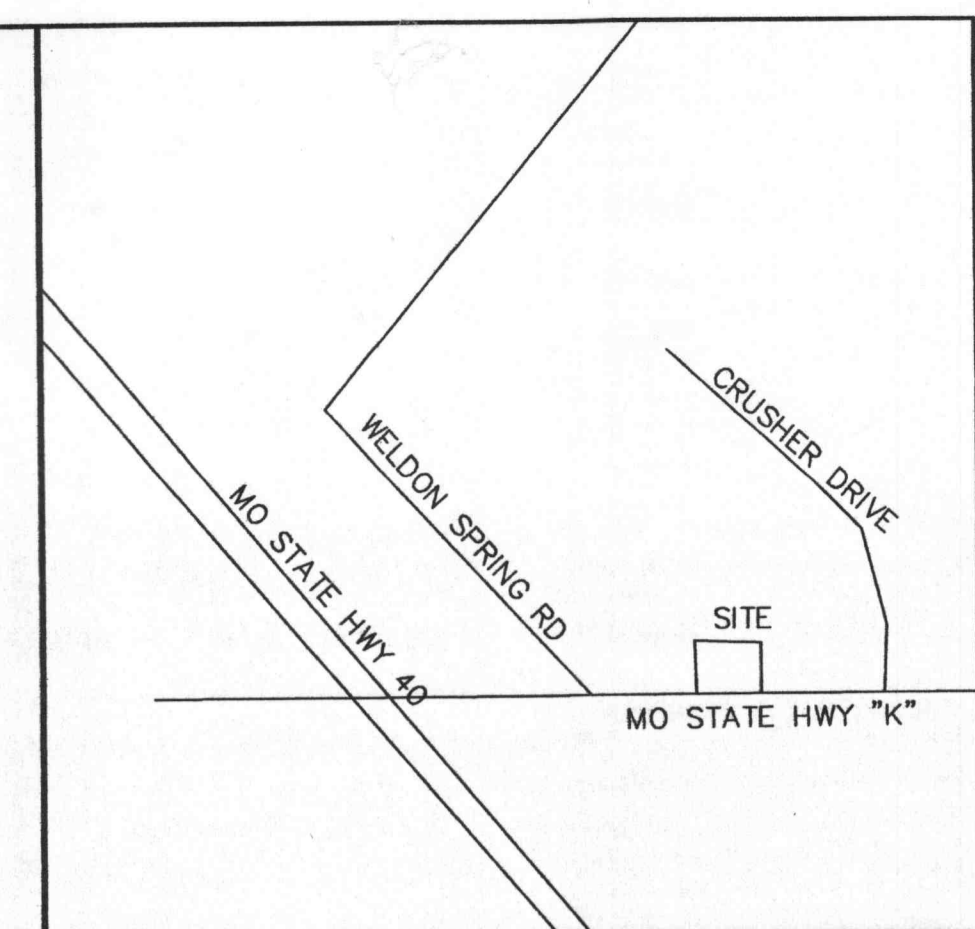

LOCATION MAP SITE NOTES

- NOTIFY CITY OF O'FALLON BUILDING DEPARTMENT 48 HOURS PRIOR TO THE COMMENCEMENT OF CONSTRUCTION.
- REFER TO ARCHITECTURAL PLANS FOR DIMENSIONS AND DETAILS ON THE PROPOSED BUILDING.
- ALL DIMENSIONS ARE TO FACE OF CURB.
- ALL CURBING TO BE 6" VERTICAL CONCRETE CURB.
- ENTRANCES TO BE CONSTRUCTED PER CITY OF O'FALLON SPECIFICATIONS.
- THE SURROUNDING STREETS AND/OR DRIVE FROM THIS DEVELOPMENT USED FOR CONSTRUCTION ACCESS THERETO SHALL BE CLEANED THROUGHOUT THE DAY.
- ALL TRASH AND DEBRIS ON-SITE, EITHER EXISTING OR FROM CONSTRUCTION, MUST BE REMOVED AND PROPERLY DISPOSED OF OFF SITE.
- DEBRIS AND FOUNDATION MATERIAL FROM ANY ON-SITE BUILDING OR STRUCTURE THAT IS TO BE RAZED FOR THIS DEVELOPMENT MUST BE PROPERLY DISPOSED OF OFF SITE.
- PROPOSED STORM SEWER SHALL COMPLY WITH ALL CITY, COUNTY & STATE STORMWATER MANAGEMENT ORDINANCES.
- ALL STORM SEWER CONSTRUCTION TO COMPLY WITH O'FALLON STANDARDS AND DETAILS.
- ALL NON-PAVED AREAS OF THIS DEVELOPMENT TO BE SOEDED, LANDSCAPED AND IRRIGATED PER CITY OF O'FALLON ORDINANCES.
- CONTRACTOR TO VERIFY QUANTITIES BETWEEN ARCHITECTURAL AND CIVIL PLANS.
- DO NOT SCALE DRAWING, FOLLOW DIMENSIONS.
- ALL NECESSARY PAVEMENT MARKINGS SHALL CONFORM TO CITY AND COUNTY STANDARDS.
- PROPOSED UNDERGROUND DETENTION TO BE SIZED TO HANDLE LOT 4F STORM WATER ONLY. STORM COLLECTION POINT (EX. GI-1) TO MEET APPROVAL OF MODOT FOR CONNECTION.
- ON-SITE PRIVATE STORM WATER TO DRAIN TO INLETS GI-3, GI-4 & GI-5.
- PROPOSED UTILITY LOCATIONS ARE APPROXIMATE ONLY. CONTRACTOR TO VERIFY PRIOR TO CONSTRUCTION WITH LOCAL UTILITIES FOR FINAL LOCATION.
- THE ITEMS CURRENTLY STORED ON THE EXTERIOR OF THE SITE, THE ROLL AWAY TRASH CONTAINERS, THE PALLETS AND BOXES, FURNITURE ITEMS AND THE INTERIOR DOOR, WILL BE REMOVED FROM THE SITE OR LOCATED WITHIN AN ENCLOSED AREA.
- THE MATERIALS USED IN THE CONSTRUCTION OF THE NEW ENCLOSURE WILL MATCH THE EXISTING BUILDING MATERIALS.

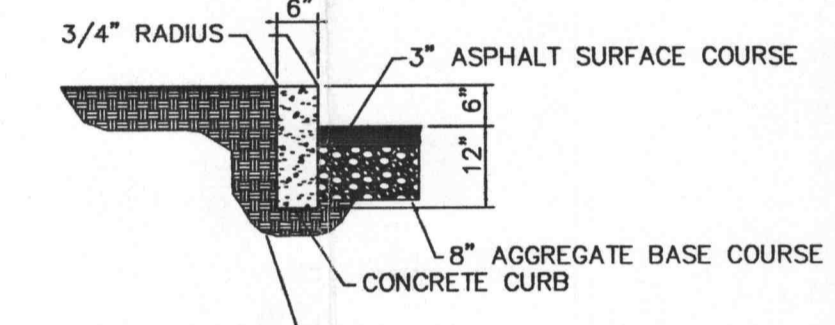

TYPICAL CURB

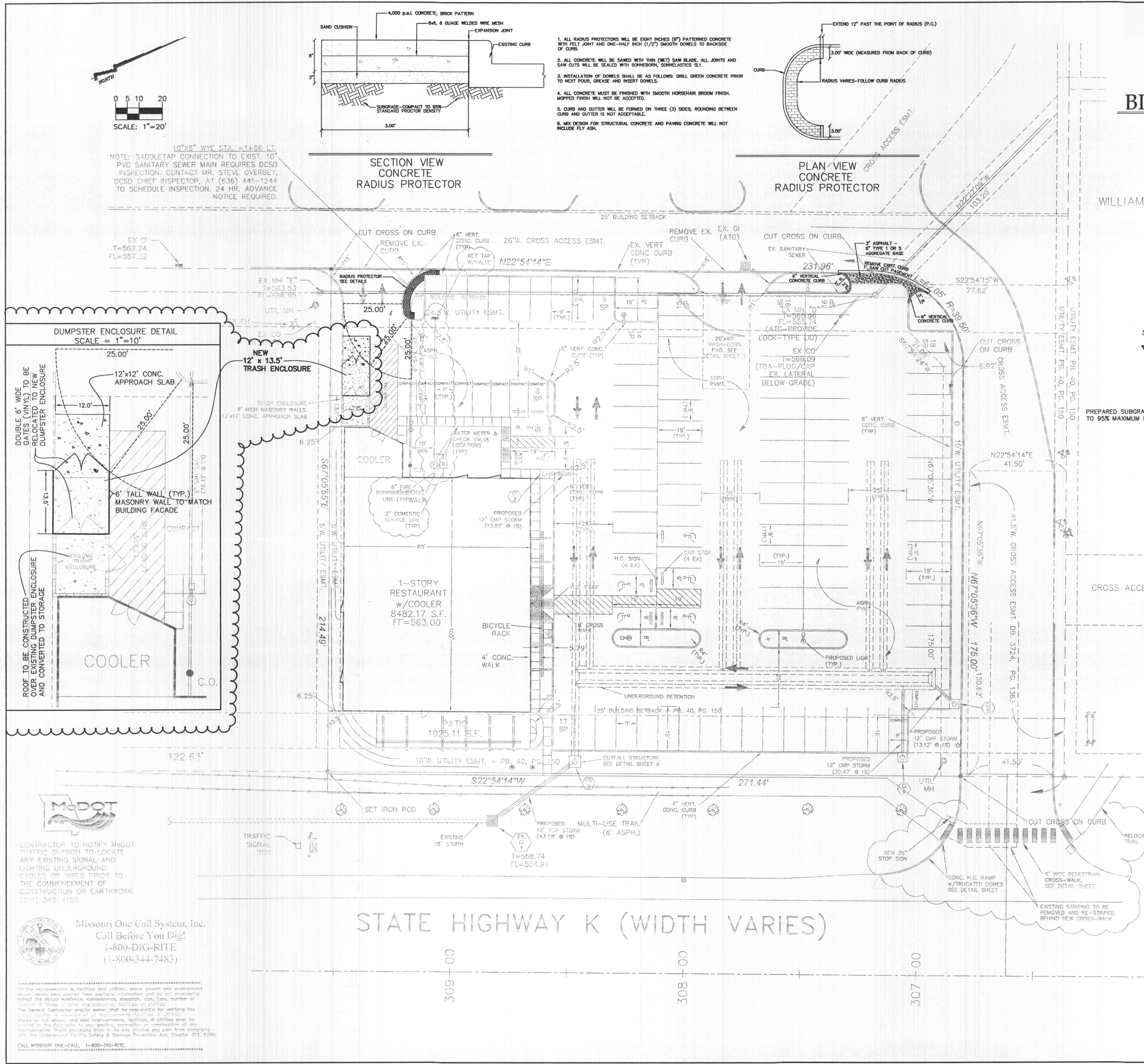

STATE HIGHWAY K (WIDTH VARIES)

CITY OF O'FALLON
COMMUNITY DEVELOPMENT DEPARTMENT
ACCEPTED FOR CONSTRUCTION
BY: [Signature] DATE: 10-4-07
PROFESSIONAL ENGINEER'S SEAL
INDICATES RESPONSIBILITY FOR DESIGN



SHEET INDEX
SHEET 1 SITE PLAN
SHEET 2 A1.1 DEMO FLOOR PLAN
SHEET 3 A1.2 ELEVATIONS & DETAILS

SEPT. 07	3	COMMENTS FROM CITY
AUG. 07	2	COMMENTS FROM CITY
AUG. 07	1	COMMENTS FROM CITY
DATE:	NO.:	REVISION:

MUSLER ENGINEERING COMPANY
CIVIL ENGINEERING - PLANNING - LAND SURVEYING
32 Portwest Court, St. Charles, Missouri 63303
Telephone: (636) 916-0444 Fax: (636) 916-3444

DATE:	DRAWN:	CHECKED:	PROJECT NO.:	SHEET NO.:
JUNE 07	MWN	RSM	07-984	1 OF 3

Bldg Inspector



CONTRACTOR TO NOTIFY MoDOT TRAFFIC DIVISION TO LOCATE ANY EXISTING SIGNAL AND LIGHTING UNDERGROUND CABLES OR WIRES PRIOR TO THE COMMENCEMENT OF CONSTRUCTION OR EARTHWORK. (317) 340-4100.

Missouri One Call System, Inc.
Call Before You Dig!
1-800-DIG-RITE
(1-800-344-7483)

All the improvements & facilities and utilities, above ground and underground shown herein were plotted from available information and do not necessarily reflect the actual existence, nonexistence, elevation, size, type, number or location of these or other improvements, facilities, or utilities. The General Contractor and/or owner shall be responsible for verifying the shown or not shown, and said improvements, facilities, & utilities shall be located in the field prior to any grading, excavation or construction of any improvements. These provisions shall in no way relieve any party from complying with the Underground Facility Safety & Damage Prevention Act, Chapter 319, RSMo.

CALL MISSOURI ONE-CALL, 1-800-DIG-RITE.