



12" X 18" SIGN



12" X 18" SIGN

INTERNATIONAL HANDICAPPED SIGN BY SAFETY SIGN CO., CLEVELAND OHIO, CAT. 12-10-252.

**HANDICAP PARKING SIGNS**  
NOT TO SCALE

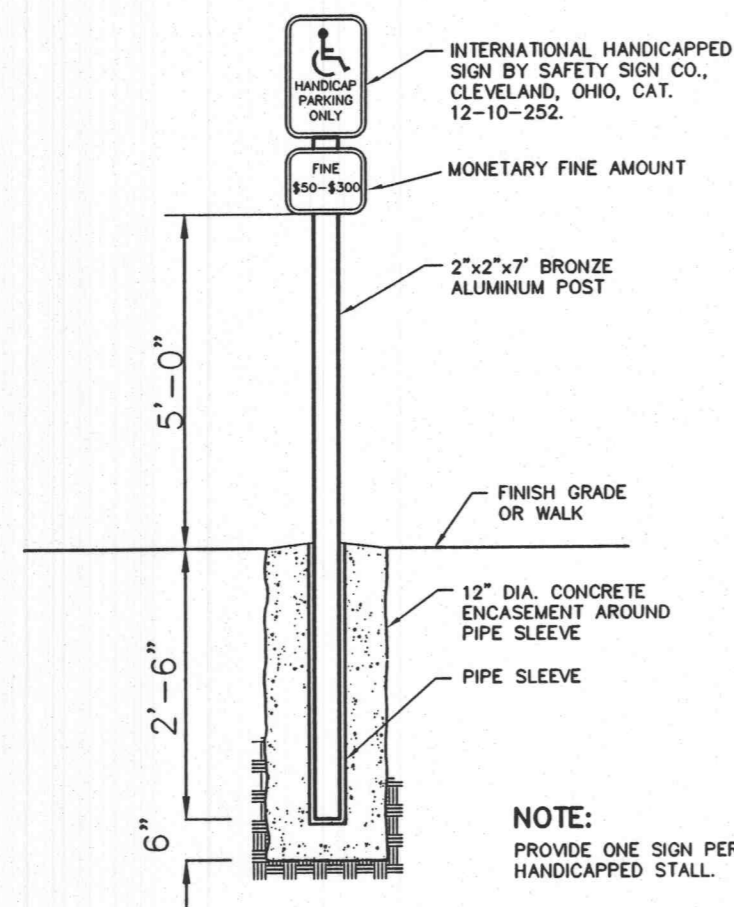

**HANDICAPPED PARKING SIGN**  
NOT TO SCALE

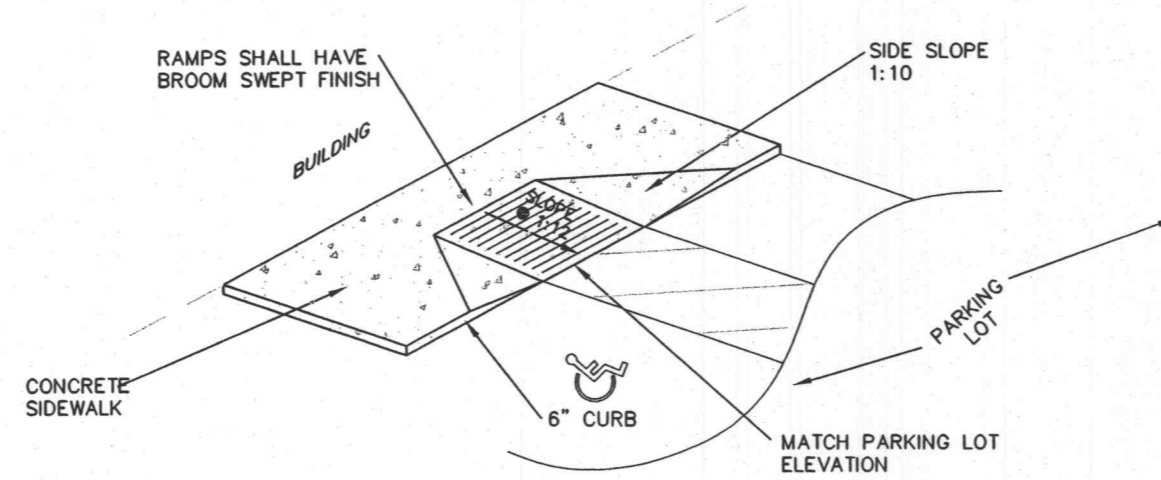

**CONCRETE HANDICAP RAMP "ADJACENT TO BUILDING"**  
NOT TO SCALE

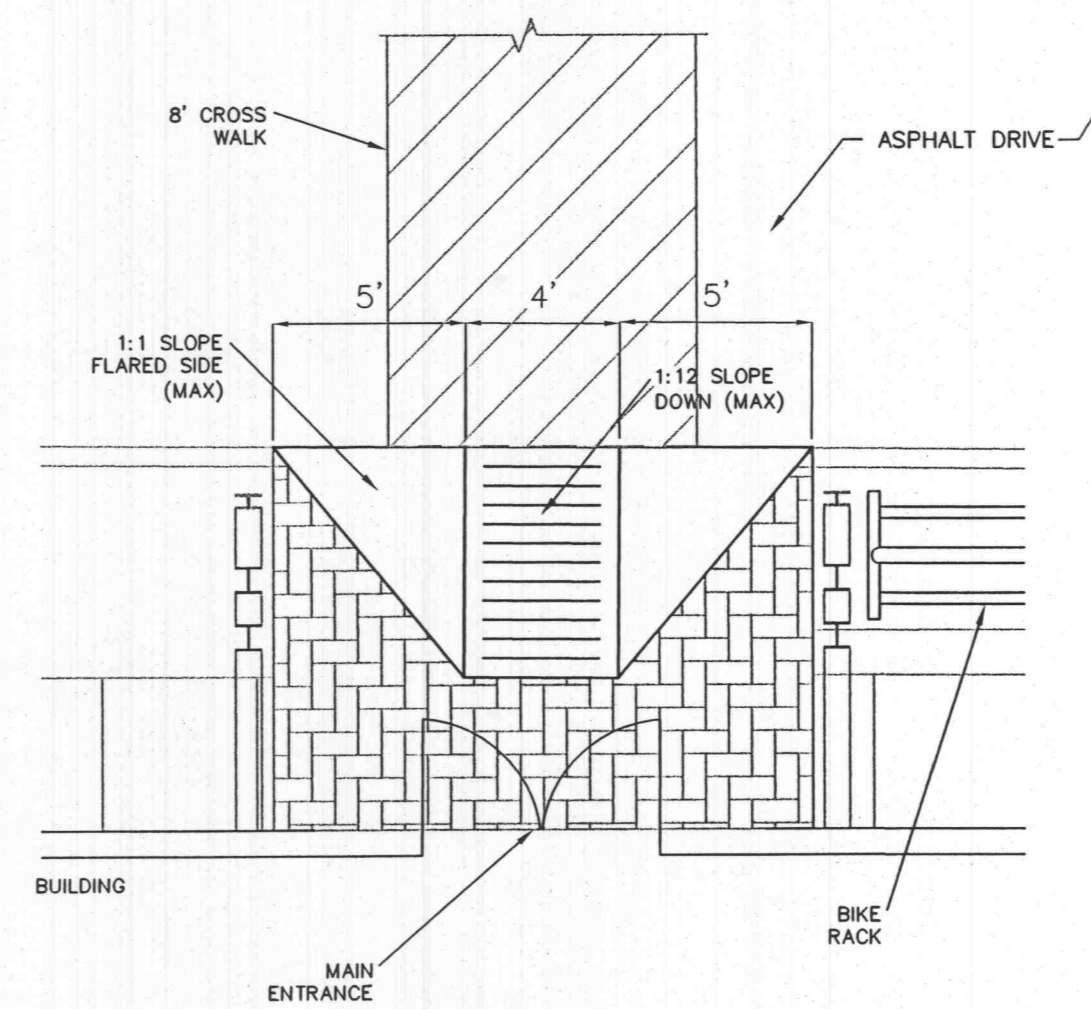

**HANDICAP ACCESS AT MAIN BUILDING ENTRANCE**  
NOT TO SCALE

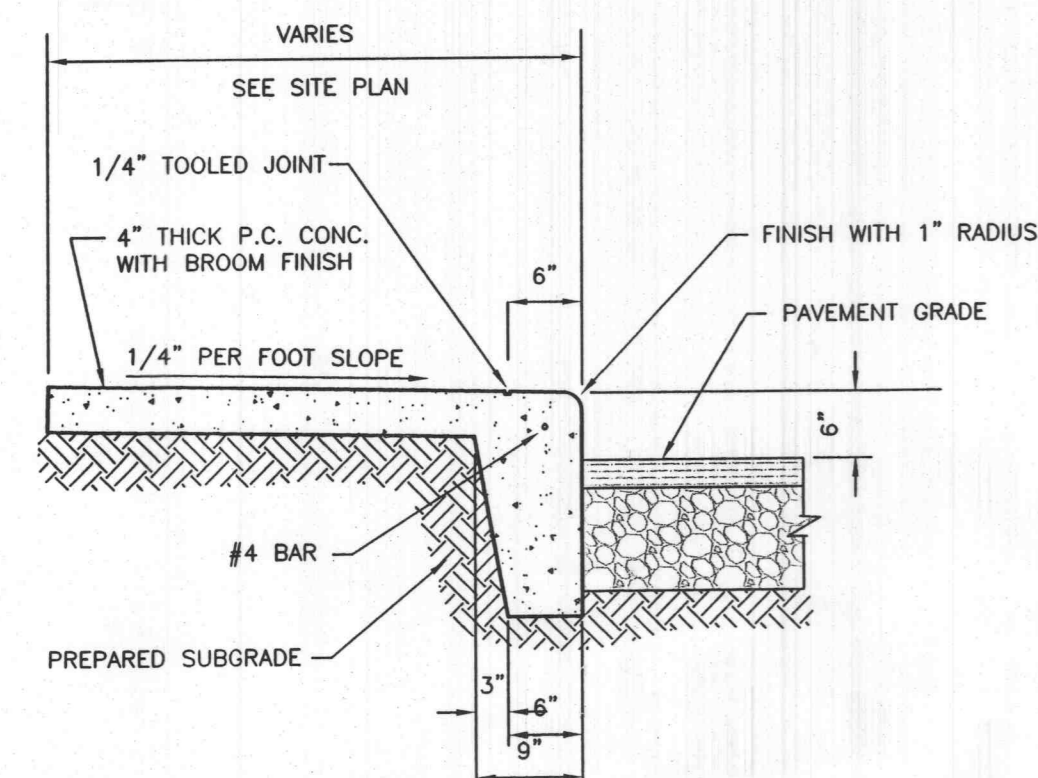

**COMBINATION SIDEWALK/CURB**  
NOT TO SCALE

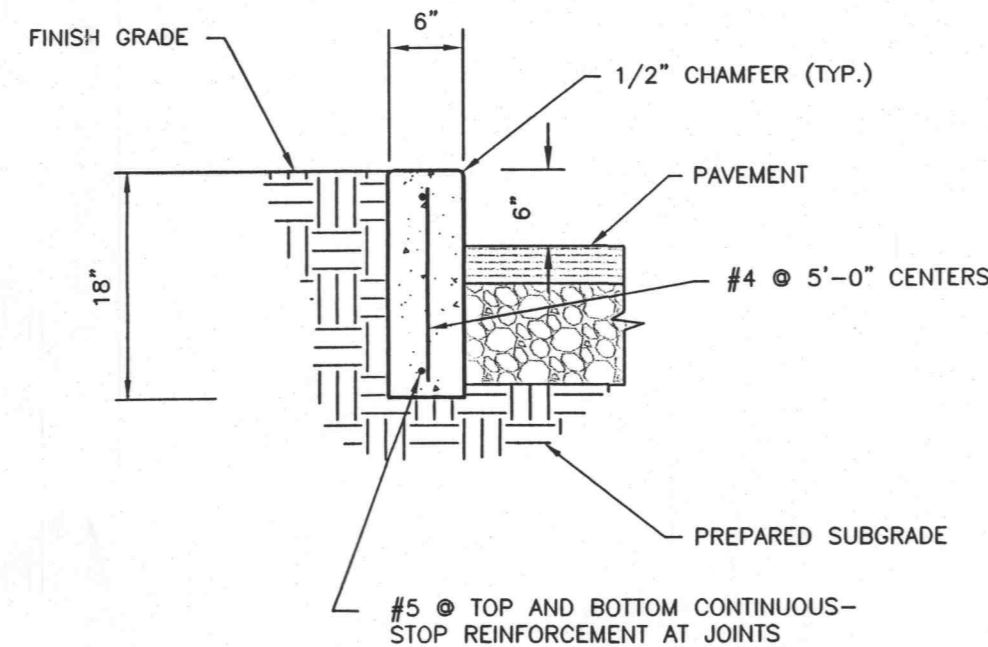

**CONCRETE VERTICAL CURB "INTERIOR DRIVES & ISLANDS"**  
NOT TO SCALE

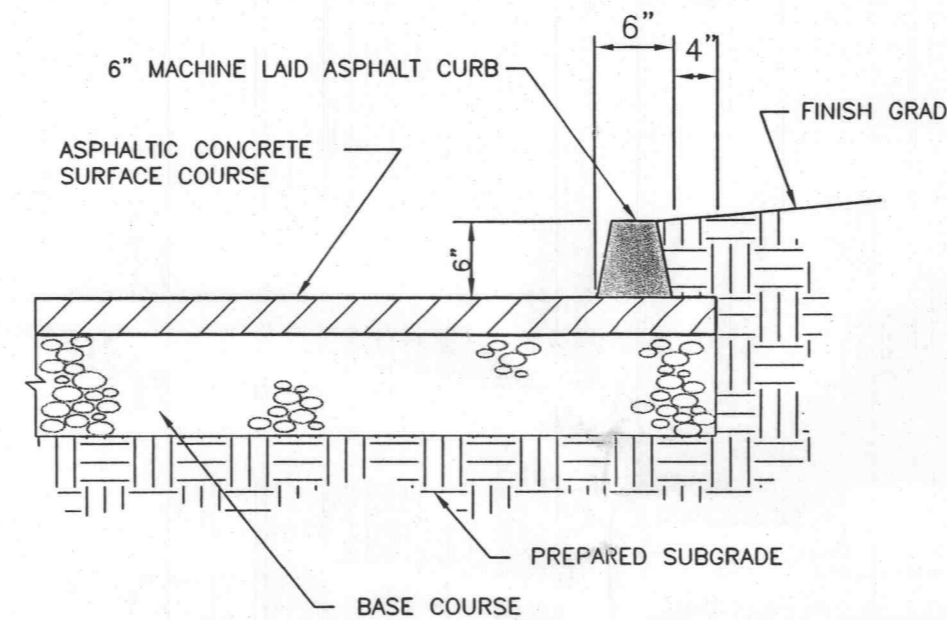

NOTE: IF NEW CURB IS TO BE PLACED ON EXISTING ASPHALTIC CONCRETE PAVEMENT CLEAN AND PREPARE EXISTING SURFACE, AND APPLY TACK COAT PRIOR TO PLACING NEW ASPHALT CURB.

**TEMPORARY CURB DETAIL**  
NOT TO SCALE

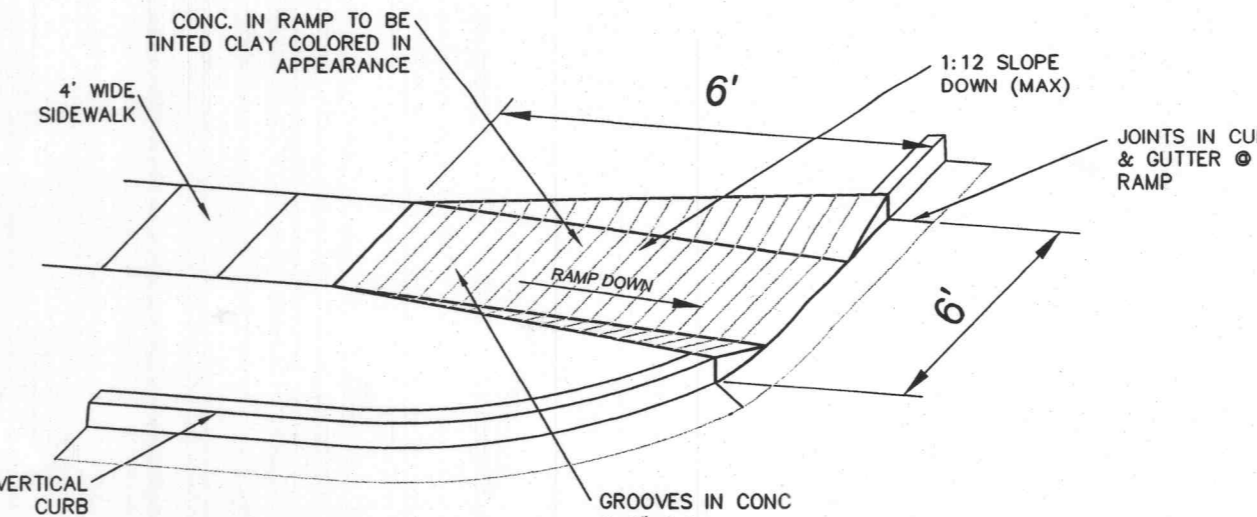

**CONC. WALK w/ HANDICAP ACCESS AT INTERIOR PROPERTIES**  
NOT TO SCALE

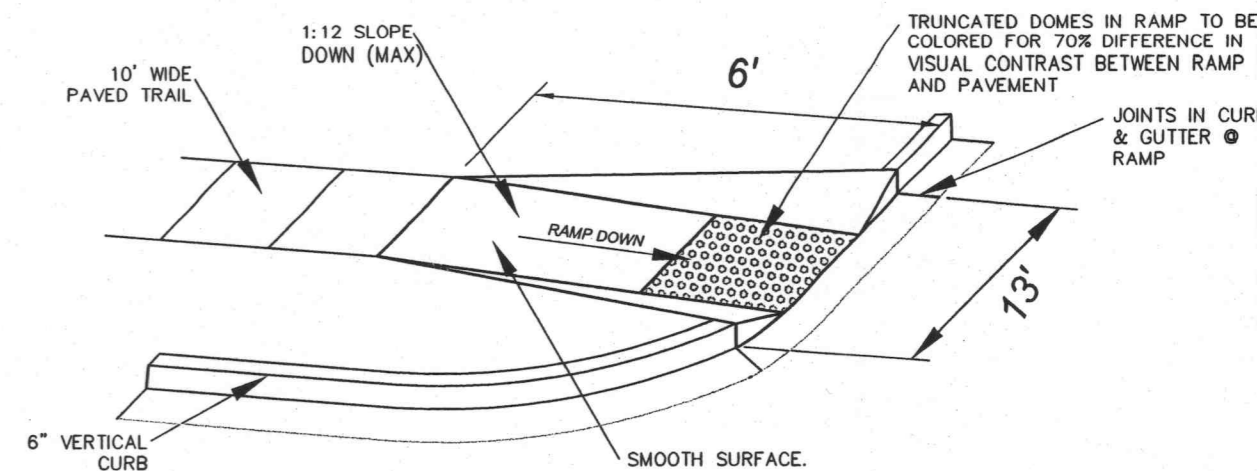

**CONC. WALK w/ HANDICAP ACCESS AT ENTRANCE DRIVES & R/W**  
NOT TO SCALE

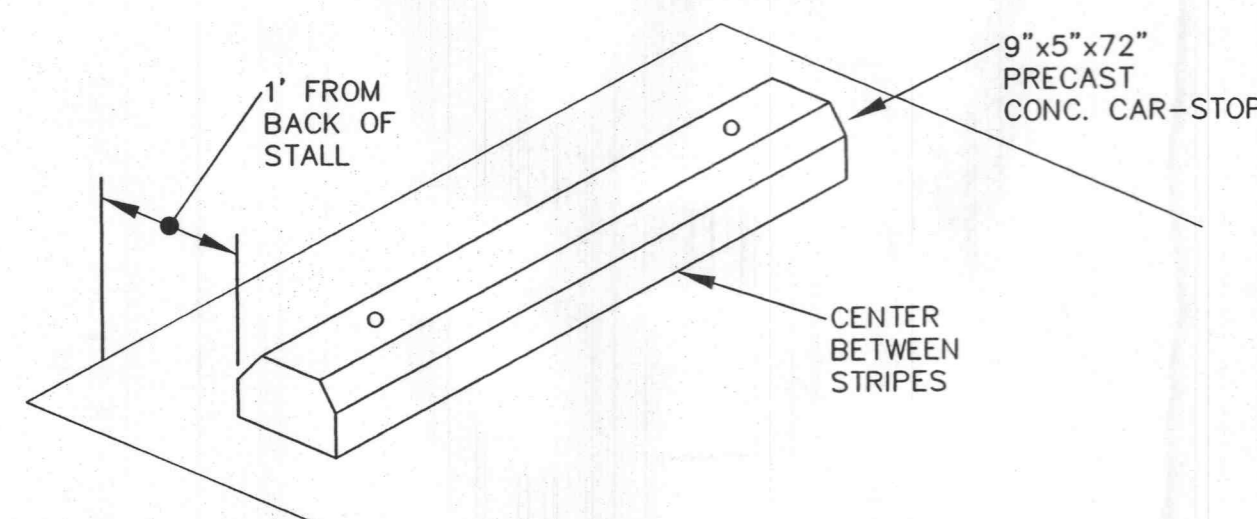

**CONCRETE CAR-STOP**  
NOT TO SCALE

NOTE: FOR HANDICAPPED STALLS ONLY.

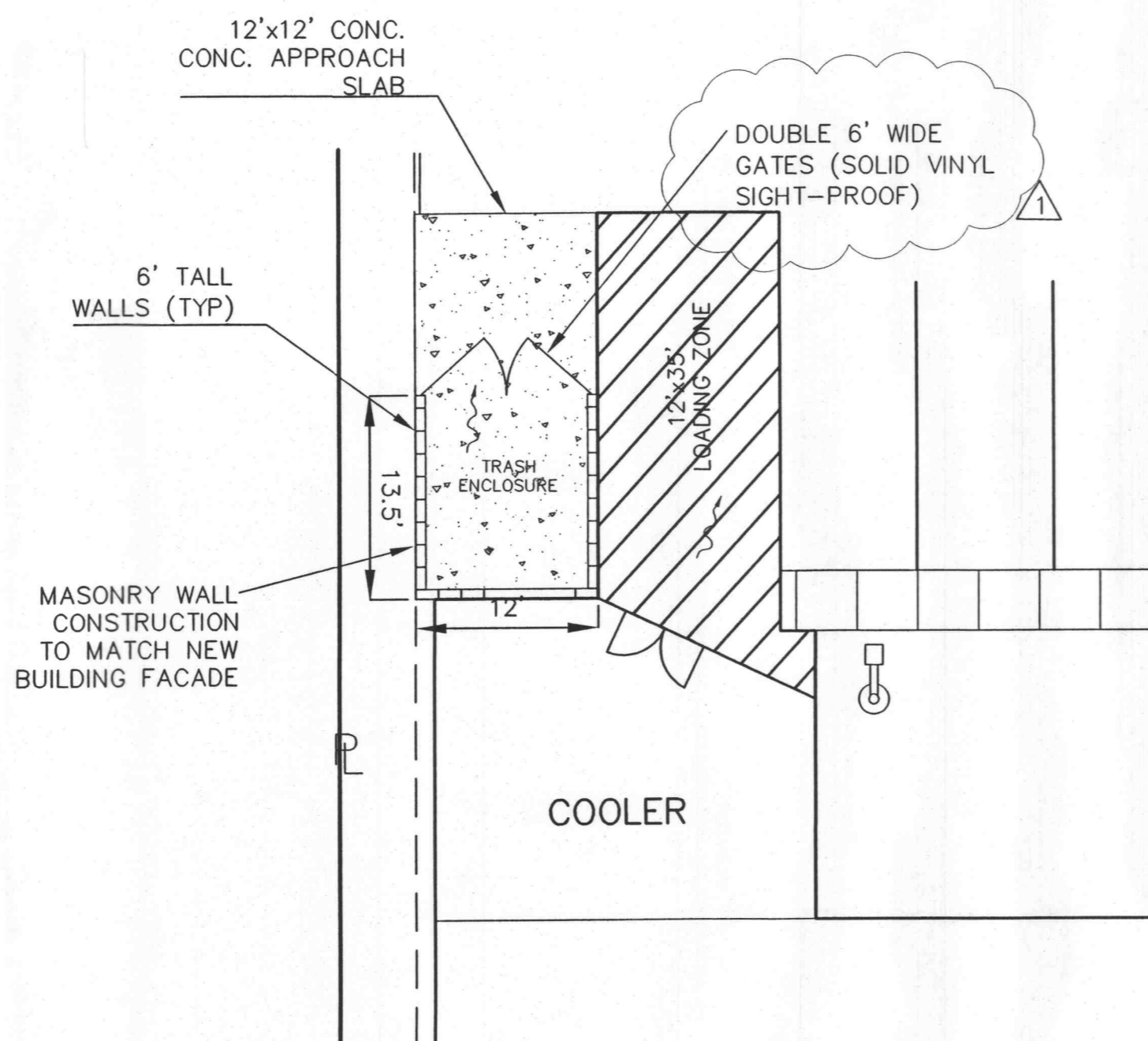

**DUMPSTER ENCLOSURE DETAIL**  
NOT TO SCALE

**Hunico SUPPLY, LLC**  
P.O. BOX 10385  
PORTLAND, OREGON 97286-0385  
1-800-547-5900  
PHONE: (503) 224-8700  
FAX: (503) 274-2055  
www.hunico.com

SINGLE FACE			
MODEL/DEPTH	LENGTH	HEIGHT	WIDTH
1181	7'	18" (548MM)	30" (914MM)
1181	11'	18" (548MM)	30" (914MM)
1 RACK PER BUILDING			

DOUBLE FACE			
MODEL/DEPTH	LENGTH	HEIGHT	WIDTH
1182	7'	18" (548MM)	30" (914MM)
1182	11'	18" (548MM)	30" (914MM)

SELECT DESIRED FINISH  
 UNFINISHED  
 POWDER COAT FINISH (SELECT COLOR)  
 THERMO PLASTIC COATING (SELECT COLOR)  
 STAINLESS STEEL

SELECT DESIRED POWDER COAT FINISH COLOR  
 PRIMAL BLUE-PA-0033  
 RICH BLUE-PA-0018  
 PRIMAL GREY-PA-0005  
 PRIMAL RED-PA-0011  
 PRIMAL BLACK-PA-0014  
 PRIMAL WHITE-PA-0001  
 PRIMAL GREEN-PA-0017

SELECT DESIRED THERMO PLASTIC COATING COLOR  
 BLACK  
 CHERRY  
 DUNE SAND  
 HAZEL GREEN  
 MINT GREEN  
 MOUNTAIN GREEN  
 RED  
 WHITE

NOTES:  
 1. INSTALLATION TO BE COMPLETED IN ACCORDANCE WITH MANUFACTURER'S SPECIFICATIONS.  
 2. DO NOT SCALE DRAWINGS.  
 3. CONTRACTORS REFER TO PRODUCT AND PURCHASING INFORMATION VISIT WWW.PRODUCTDETAILS.COM FOR ADDITIONAL INFORMATION.

OLD SCHOOL BIKE RACKS  
 VERTICAL SERIES - SINGLE AND DOUBLE FACE

PROTECTED BY COPYRIGHT - 008-008 01/25/03 www.ccsdetails.com

**BIKE RACK DETAIL**  
NOT TO SCALE

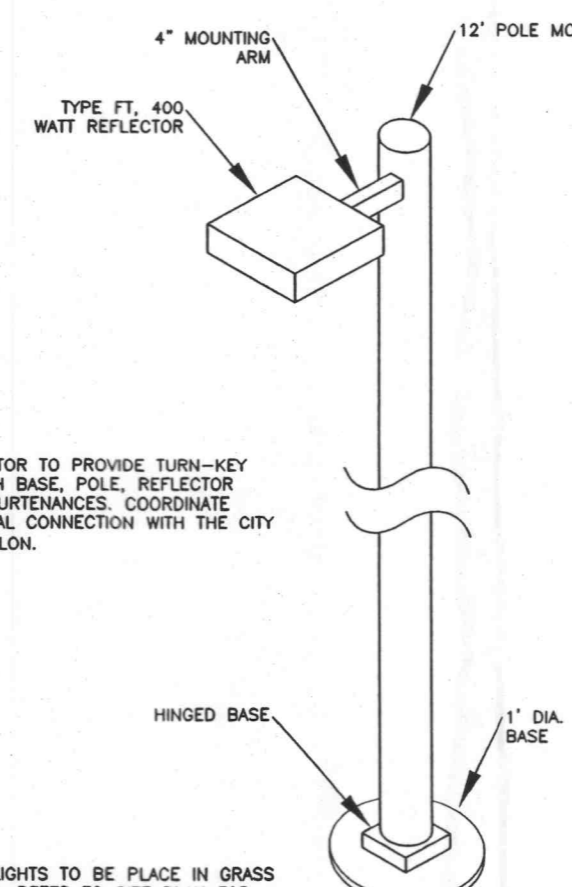

CONTRACTOR TO PROVIDE TURN-KEY UNIT WITH BASE, POLE, REFLECTOR AND APPURTENANCES. COORDINATE ELECTRICAL CONNECTION WITH THE CITY OF FALLON.

NOTE: LIGHTS TO BE PLACED IN GRASS ISLANDS. REFER TO SITE PLAN FOR LOCATIONS. REFER TO ARCHITECTURAL PLANS FOR BUILDING MOUNTED LIGHTS AND THE ELECTRICAL SITE PLAN FOR ADDITIONAL INFORMATION.  
 NOTE: OWNER TO BE CONSULTED FOR FINAL MAKE, MODEL AND COLOR OF LIGHTING FIXTURE.

**STREET LIGHT DETAIL**  
NOT TO SCALE

O'FALLON P & Z FILE NO.: (905.01)

**ENGINEERS' CERTIFICATION:**  
The following applies to ALL sheets and documents involved in the preparation of the plans and documents for this project. The responsibility for Professional Engineering liability on this project is limited to the set of plans displaying the signature and an original stamped seal of the Engineer on each sheet. ALL responsibility is Disclaimed: until ALL review agency approvals are granted; for all other plan sheets issued prior to this issue date; for this set when another set is issued after this date; if the sheets are used individually instead of a set. This applies for ALL sheets and documents involved in this project whether this certification appears on it or not. Copyright. All Rights Reserved.

ZAVRADINOS PROFESSIONAL SERVICES, INC.



RICHARD G. WISCHMANN, PE-2003015059 DATE 8-11-06

1	7-27-06	REVISED PER CITY COMMENTS	JRE
No.	Date	Description	By
Prepared For:			Drawn by: JRE
JOHNNY YOON 523 Mallinmoor Drive St. Charles, MO 63304 (314) 650-3937			Checked by: SWP
Issued on: 5-15-06			Job Number: 04152
Zavradinos Engineering and Surveying Engineers Surveyors Planners 17813 Edison Avenue, Suite 201 Chesterfield, MO 63005 636-946-5555			Sheet: 6/11