

LEGEND

- X - X - X SILTATION FENCE
- TEMPORARY DIVERSION SWALE
- DRAINAGE AREA LIMIT
- ROCK CHECK DAM

ISSUE REMARKS/DATE

- 10-16-2012, INITIAL SUBMITTAL
- 11-29-2012, CITY COMMENTS
- 1-14-2013, CITY & DCSD COMMENTS
- 2-13-2013, CITY COMMENTS
- 3-13-2013, REVISED STORM & SANITARY
- 3-22-2013, REVISED UNDERDRAIN
- 8-1-2013, REVISED STORM SEWERS

PROJECT TITLE
BOARDWALK GARDENS
 OF FALLON, MISSOURI

THE STERLING CO.
ENGINEERS & SURVEYORS
 5055 New Baumgartner Road
 St. Louis, Missouri 63129
 Ph 314-487-0440 Fax 314-487-8944
 www.sterling-eng-survey.com
 Corporate Certificate of Authority #001348

The Professional Engineer's seal and signature shall be on this sheet and apply only to the material and items shown on this sheet. All drawings, instruments or other documents not prepared by the engineer, and the engineer expressly disclaims any and all responsibility for such drawings or documents not exhibiting this seal and signature.

Date: *Michael G. Boerding*
MICHAEL G. BOERDING
 License No. E-28643
 Civil Engineer

MCBRIDE RED HAWK, LLC
 16091 SWINGLEY RIDGE ROAD, SUITE 300
 CHESTERFIELD, MISSOURI 63017
 PH. 636-537-2000
 Contact: Jeremy Roth

OVERALL GRADING SWPPP

P+Z No. 9831.34.09.01
City No.
Date: OCT. 16, 2012
Job No. 10-07-213
Page No.

2.2
 IMP

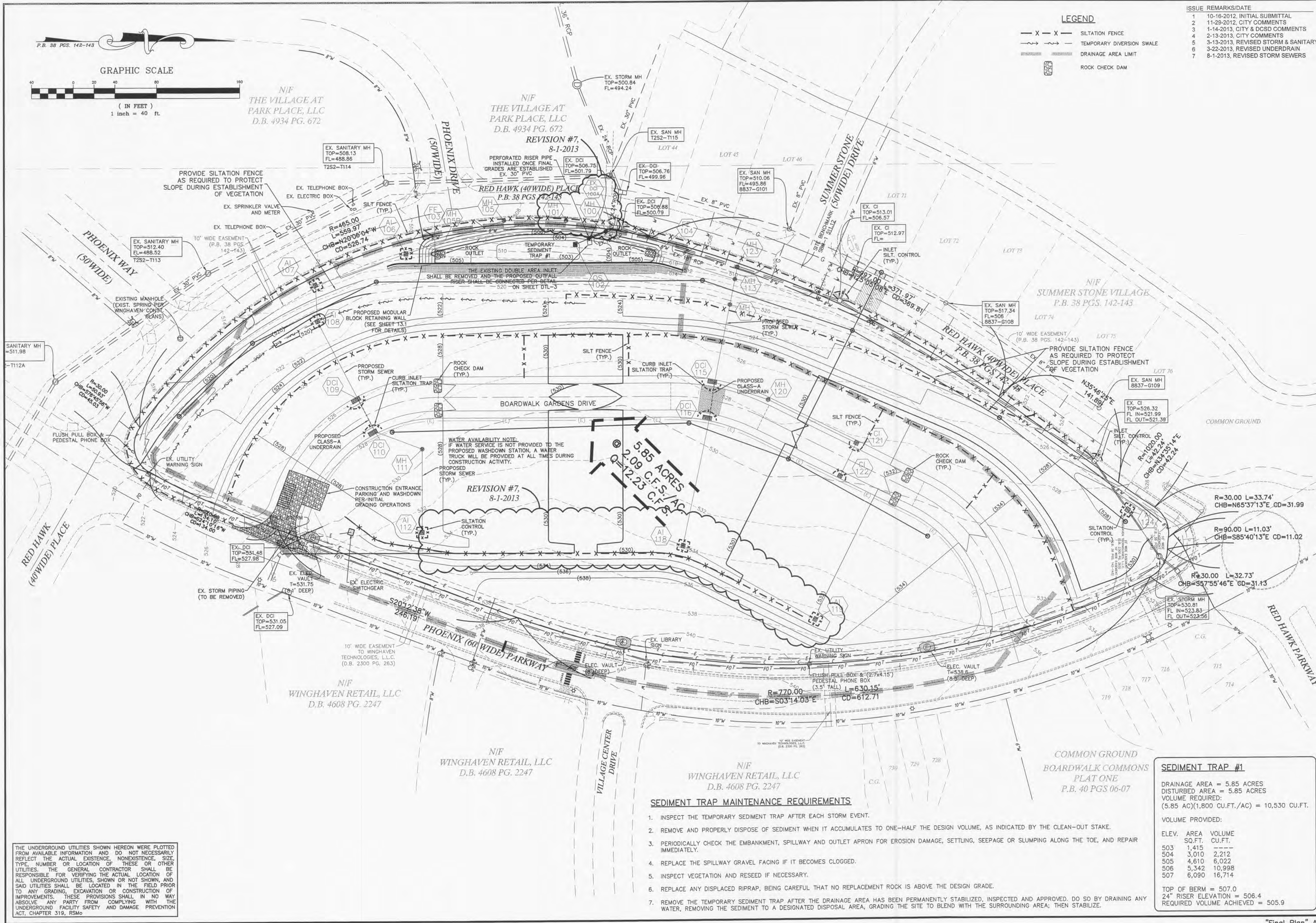

5.85 ACRES
2.09 C.F.S./AC
12.23 C.F.S.

SEDIMENT TRAP MAINTENANCE REQUIREMENTS

1. INSPECT THE TEMPORARY SEDIMENT TRAP AFTER EACH STORM EVENT.
2. REMOVE AND PROPERLY DISPOSE OF SEDIMENT WHEN IT ACCUMULATES TO ONE-HALF THE DESIGN VOLUME, AS INDICATED BY THE CLEAN-OUT STAKE.
3. PERIODICALLY CHECK THE EMBANKMENT, SPILLWAY AND OUTLET APRON FOR EROSION DAMAGE, SETTLING, SEEPAGE OR SLUMPING ALONG THE TOE, AND REPAIR IMMEDIATELY.
4. REPLACE THE SPILLWAY GRAVEL FACING IF IT BECOMES CLOGGED.
5. INSPECT VEGETATION AND RESEED IF NECESSARY.
6. REPLACE ANY DISPLACED RIPRAP, BEING CAREFUL THAT NO REPLACEMENT ROCK IS ABOVE THE DESIGN GRADE.
7. REMOVE THE TEMPORARY SEDIMENT TRAP AFTER THE DRAINAGE AREA HAS BEEN PERMANENTLY STABILIZED, INSPECTED AND APPROVED. DO SO BY DRAINING ANY WATER, REMOVING THE SEDIMENT TO A DESIGNATED DISPOSAL AREA, GRADING THE SITE TO BLEND WITH THE SURROUNDING AREA; THEN STABILIZE.

SEDIMENT TRAP #1

DRAINAGE AREA = 5.85 ACRES
 DISTURBED AREA = 5.85 ACRES
 VOLUME REQUIRED:
 (5.85 AC)(1,800 CU.FT./AC) = 10,530 CU.FT.

VOLUME PROVIDED:

ELEV.	AREA SQ.FT.	VOLUME CU.FT.
503	1,415	---
504	3,010	2,212
505	4,610	6,022
506	5,342	10,998
507	6,090	16,714

TOP OF BERM = 507.0
 24" RISER ELEVATION = 506.4
 REQUIRED VOLUME ACHIEVED = 505.9

THE UNDERGROUND UTILITIES SHOWN HEREON WERE PLOTTED FROM AVAILABLE INFORMATION AND DO NOT NECESSARILY REFLECT THE ACTUAL EXISTENCE, NONEXISTENCE, SIZE, TYPE, NUMBER OR LOCATION OF THESE UTILITIES. THE GENERAL CONTRACTOR SHALL BE RESPONSIBLE FOR VERIFYING THE ACTUAL LOCATION OF ALL UNDERGROUND UTILITIES, SHOWN OR NOT SHOWN, AND SAID UTILITIES SHALL BE LOCATED IN THE FIELD PRIOR TO ANY GRADING, EXCAVATION OR CONSTRUCTION OF IMPROVEMENTS. THESE PROVISIONS SHALL IN NO WAY ABSOLVE ANY PARTY FROM COMPLYING WITH THE UNDERGROUND FACILITY SAFETY AND DAMAGE PREVENTION ACT, CHAPTER 319, RSMo.