

N07°50'38"E
2661.97'

N/F ADELAIDE R. RHODES AND MARY LOU HARMON 1730/1277

N/F RHODES FAMILY FARM, INC. & ADELAIDE RHODES 2623/754

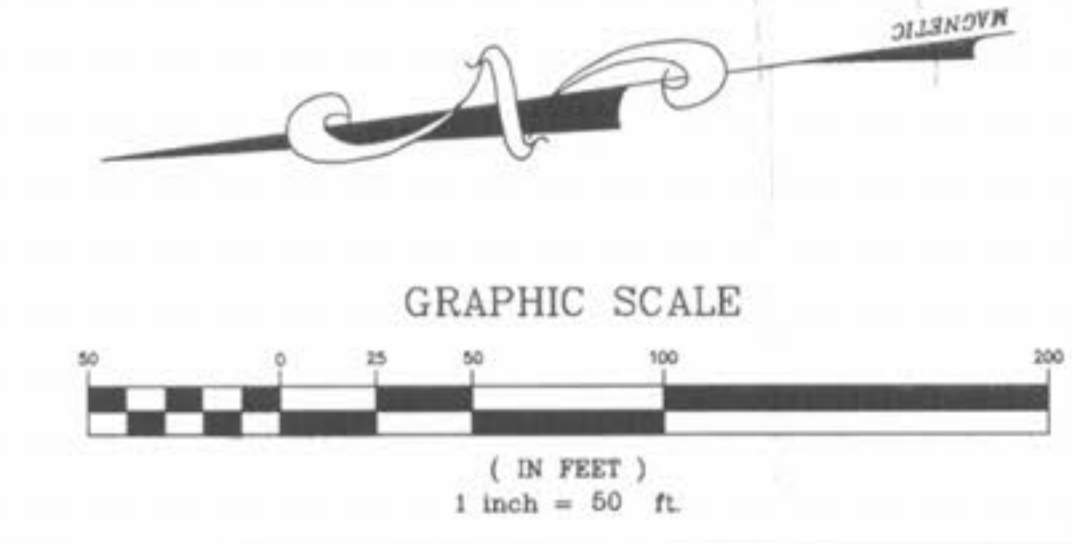

FORCEMAIN TEST PRESSURE: 75 PSI
PUMP SHUT OFF HEAD = 57 FEET = 25 PSI
TEST PRESSURE = 25 PSI + 50 PSI = 75 PSI

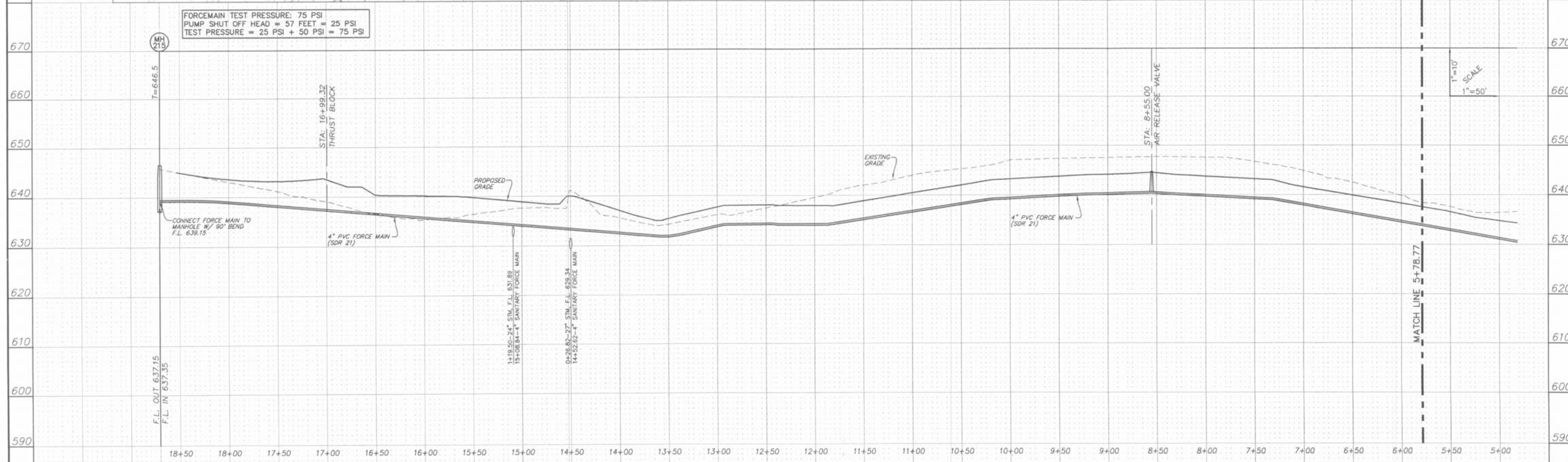

ISSUE REMARKS/DATE

1	04-29-04	FIRST SUBMITTAL
2	06-21-04	REVISED PER CITY OF FALLON COMMENTS

PREPARED FOR:

McBride & Son Homes
Land Development, Inc.
#1 McBride & Son Center Drive
Chesterfield, Missouri 63005
(636) 537-2000

STATE OF MISSOURI
Professional Engineer
No. 0000000000
PE 2020016612
J. L. STERLING

PREPARED BY:

THE STERLING CO.
ENGINEERS & SURVEYORS
5055 NEW BAUMGARTNER ROAD
ST. LOUIS, MISSOURI 63129
(314) 546-4400 FAX: 481-6844
E-Mail: Sterling@sterling-eng-sur.com

DRAWN: [] DESIGNED: [] CHECKED: []

PROJECT: **BRIARCHASE ADDITION**

SHEET TITLE: **FORCE MAIN PLAN/PROFILES**

NO	02	06	142
M.S.D.			SHEET
P#		21	
DIGITAL FILE LOCATION	SERVER=STERLING-2		
			OF 22