

K:\0203043 HWY N (McBride)\IMPROVEMENTS\3043storm.dwg 11/14/2002 07:28:00 AM CST

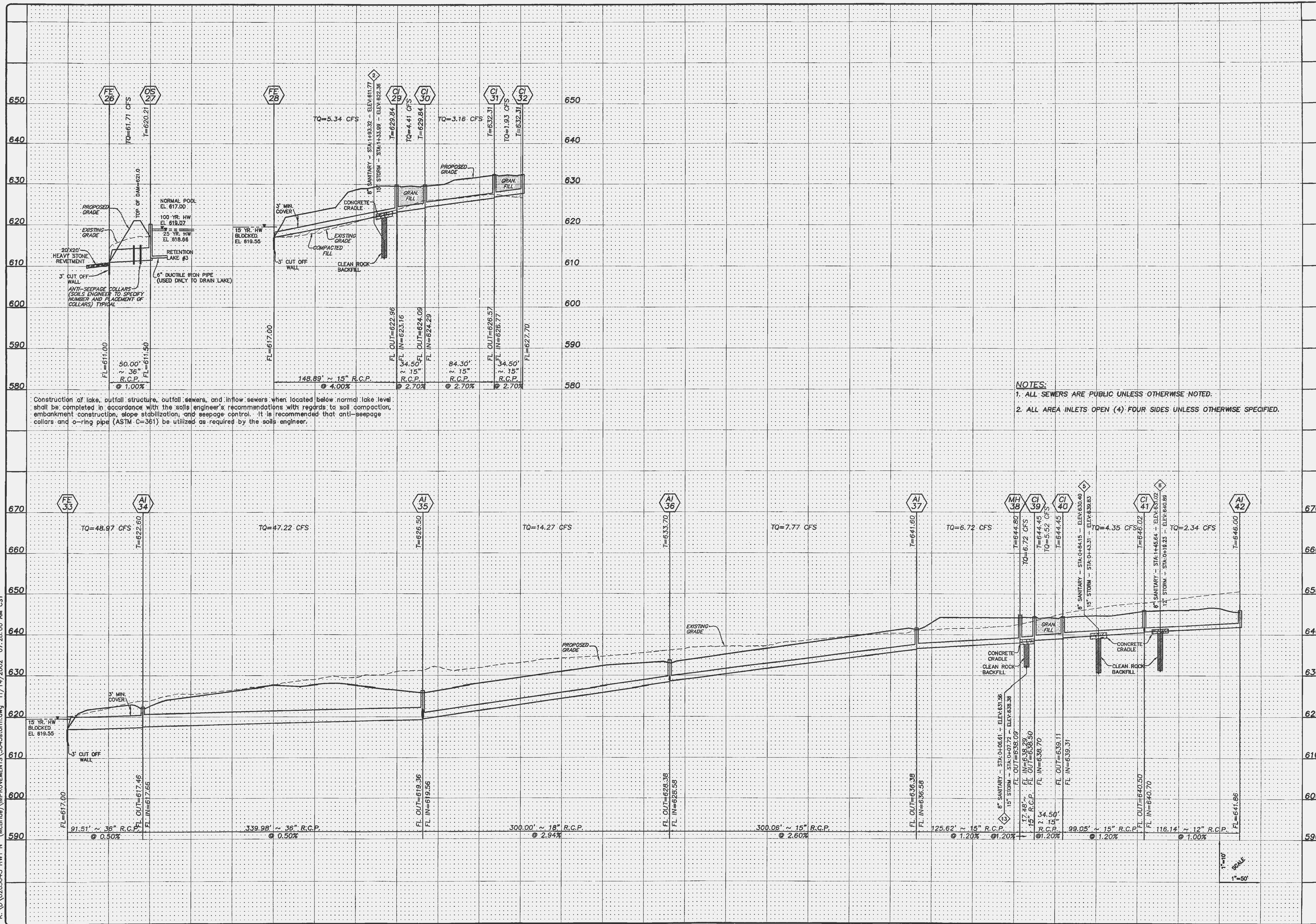

NOTES:
 1. ALL SEWERS ARE PUBLIC UNLESS OTHERWISE NOTED.
 2. ALL AREA INLETS OPEN (4) FOUR SIDES UNLESS OTHERWISE SPECIFIED.

Construction of lake, outfall structure, outfall sewers, and inflow sewers when located below normal lake level shall be completed in accordance with the soils engineer's recommendations with regards to soil compaction, embankment construction, slope stabilization, and seepage control. It is recommended that anti-seepage collars and o-ring pipe (ASTM C-361) be utilized as required by the soils engineer.

ISSUE	REVISION/DATE
1	11-14-02 T.E. Submittal
2	02-05-03 City of Fallon Comments
3	02-28-03 Client Revisions
4	03-12-03 City of Fallon Comments
5	04-02-03 City of Fallon Comments

PREPARED FOR:
McBride & Son Homes, Inc.
 #1 McBride & Son Center Drive
 Chesterfield, Missouri 63005
 (636) 537-2000

THE **STERLING** CO.
 ENGINEERS & SURVEYORS
 5055 NEW BAUMGARTNER ROAD
 ST. LOUIS, MISSOURI 63129
 (314)-487-0440 FAX 487-8944
 E-Mail: Sterling@sterling-eng-sur.com

PROJECT: **BRIARCHASE**
 SHEET TITLE: **STORM SEWER PROFILES**

NO.	02	03	043
M.S.D.	SHEET		
P#	11		
ORIGINAL FILE LOCATION	C:\0203043\HWY N		
DATE	11/14/02		
BY	T.E.		
CHECKED	R.L.A.		
DATE	11/14/02		

BASE MAP