

K:\D\020304\IMPROVEMENTS\3043storm.dwg 11/14/2002 07:28:00 AM CST

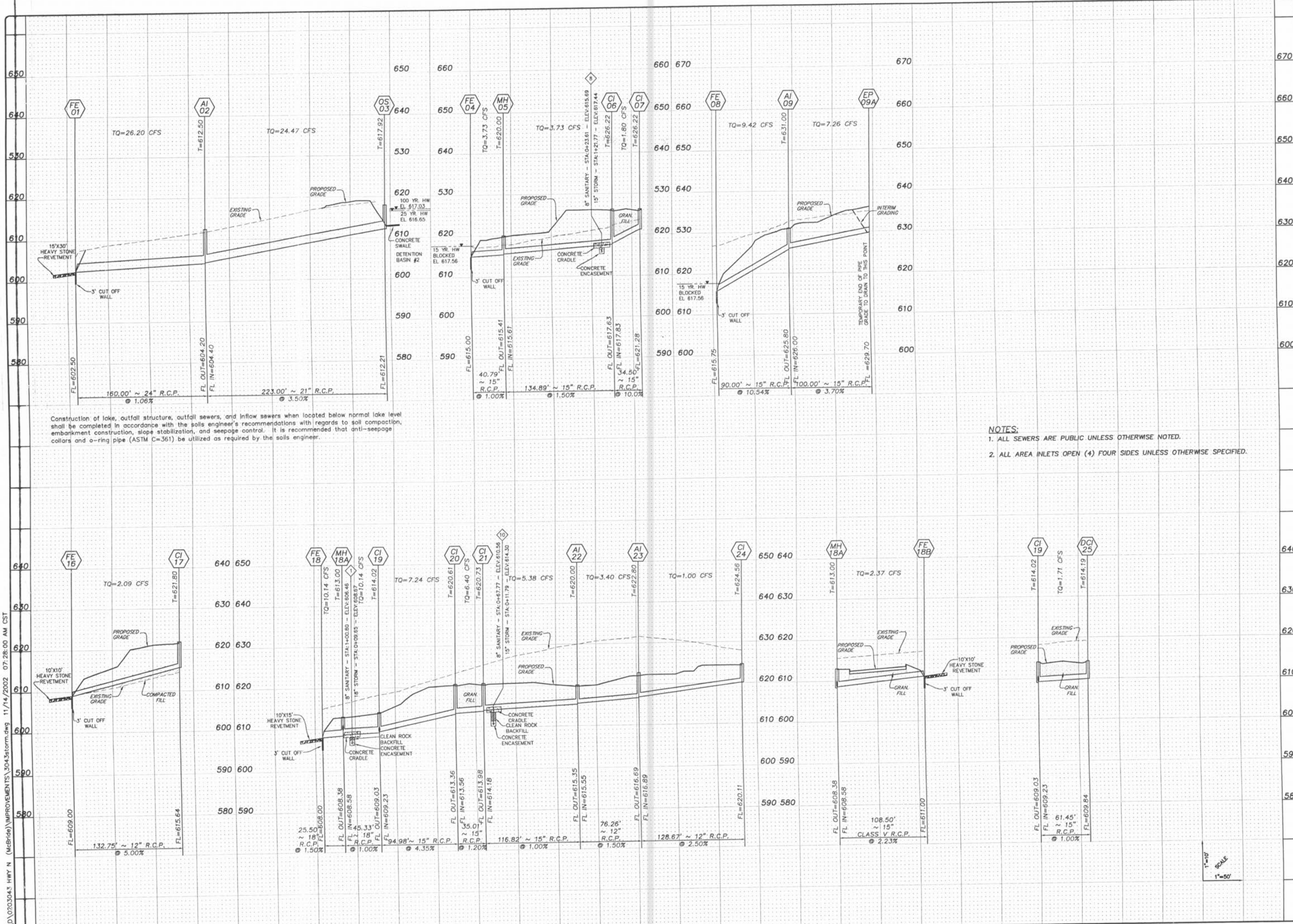

Construction of lake, outfall structure, outfall sewers, and inflow sewers when located below normal lake level shall be completed in accordance with the soils engineer's recommendations with regards to soil compaction, embankment construction, slope stabilization, and seepage control. It is recommended that anti-seepage collars and o-ring pipe (ASTM C-361) be utilized as required by the soils engineer.

- NOTES:**
1. ALL SEWERS ARE PUBLIC UNLESS OTHERWISE NOTED.
 2. ALL AREA INLETS OPEN (4) FOUR SIDES UNLESS OTHERWISE SPECIFIED.

SCALE
1"=50'

ISSUE	REMARKS/DATE
1	11-14-02 1st Submittal
2	02-05-03 City of OFallon Comments
3	02-26-03 Client Revisions
4	03-12-03 City of OFallon Comments
5	04-22-03 City of OFallon Comments
6	06-26-03 Client Revisions

PREPARED FOR:
McBride & Son Homes, Inc.
 #1 McBride & Son Center Drive
 Chesterfield, Missouri 63005
 (636) 537-2000



THE **STERLING** CO.
 ENGINEERS & SURVEYORS
 5055 NEW BAUMGARTNER ROAD
 ST. LOUIS, MISSOURI 63129
 (314) 487-0440 FAX 487-8644
 E-Mail: Sterling@sterling-eng-sur.com

PROJECT:	BRIARCHASE	
DRAWN:	DESIGNED:	CHECKED:
SHEET TITLE: STORM SEWER PROFILES		

NO.	02 03 043
M.S.D.	SHEET
P#	10
SCALE	1"=50'
OF	18

BASE MAP