

K:\D\0203043 HWY N (McBride)\IMPROVEMENTS\3043storm.dwg 11/14/2002 07:28:00 AM CST

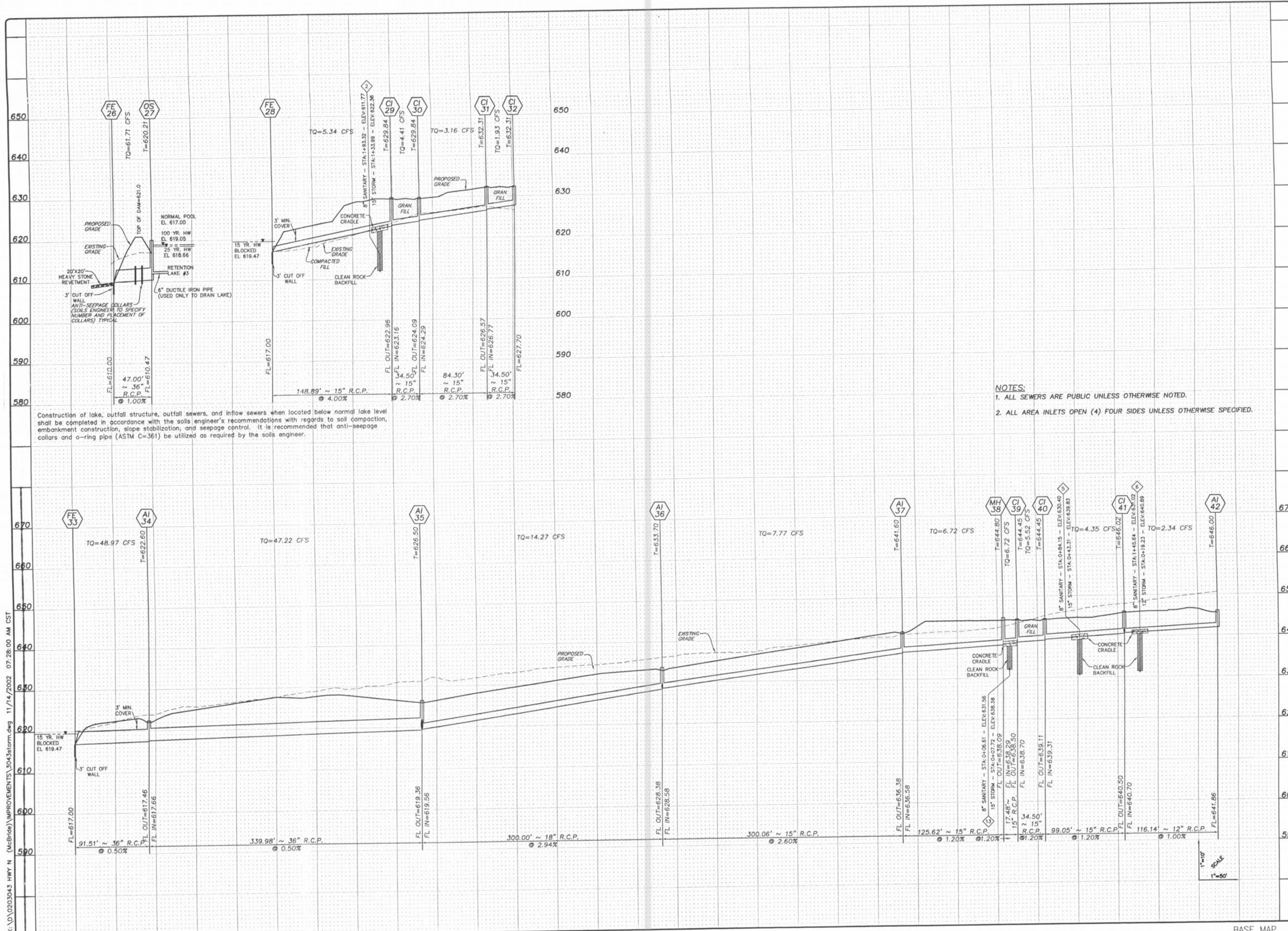

Construction of lake, outfall structure, outfall sewers, and inflow sewers when located below normal lake level shall be completed in accordance with the soils engineer's recommendations with regards to soil compaction, embankment construction, slope stabilization, and seepage control. It is recommended that anti-seepage collars and o-ring pipe (ASTM C-361) be utilized as required by the soils engineer.

- NOTES:
1. ALL SEWERS ARE PUBLIC UNLESS OTHERWISE NOTED.
 2. ALL AREA INLETS OPEN (4) FOUR SIDES UNLESS OTHERWISE SPECIFIED.

ISSUE	REMARKS/DATE
1	11-14-02 1st Submittal
2	02-05-03 City of OFallon Comments
3	02-28-03 Client Revisions
4	03-12-03 City of OFallon Comments
5	04-02-03 City of OFallon Comments
6	06-26-03 Client Revisions

PREPARED FOR:
McBride & Son Homes, Inc.
 #1 McBride & Son Center Drive
 Chesterfield, Missouri 63005
 (636) 537-2000

PREPARED BY:
THE STERLING CO.
 ENGINEERS & SURVEYORS
 5055 NEW BAUMGARTNER ROAD
 ST. LOUIS, MISSOURI 63113
 (314) 441-4441 FAX 487-8944
 E-Mail: Sterling@sterling-eng-sur.com

DRAWN: _____
 DESIGNED: _____
 CHECKED: _____

PROJECT:
BRIARCHASE

SHEET TITLE:
 STORM SEWER PROFILES

No.	02	03	043
M.S.D.	SHEET		
P#	11		
ORIGINAL FILE LOCATION	C:\HWY\3043\3043storm.dwg		
DATE	11/14/02		
BY	JLB		
OF	18		

BASE MAP