

THORN BROOK DRIVE

HORIZONTAL SCALE: 1" = 50'  
VERTICAL SCALE: 1" = 10'

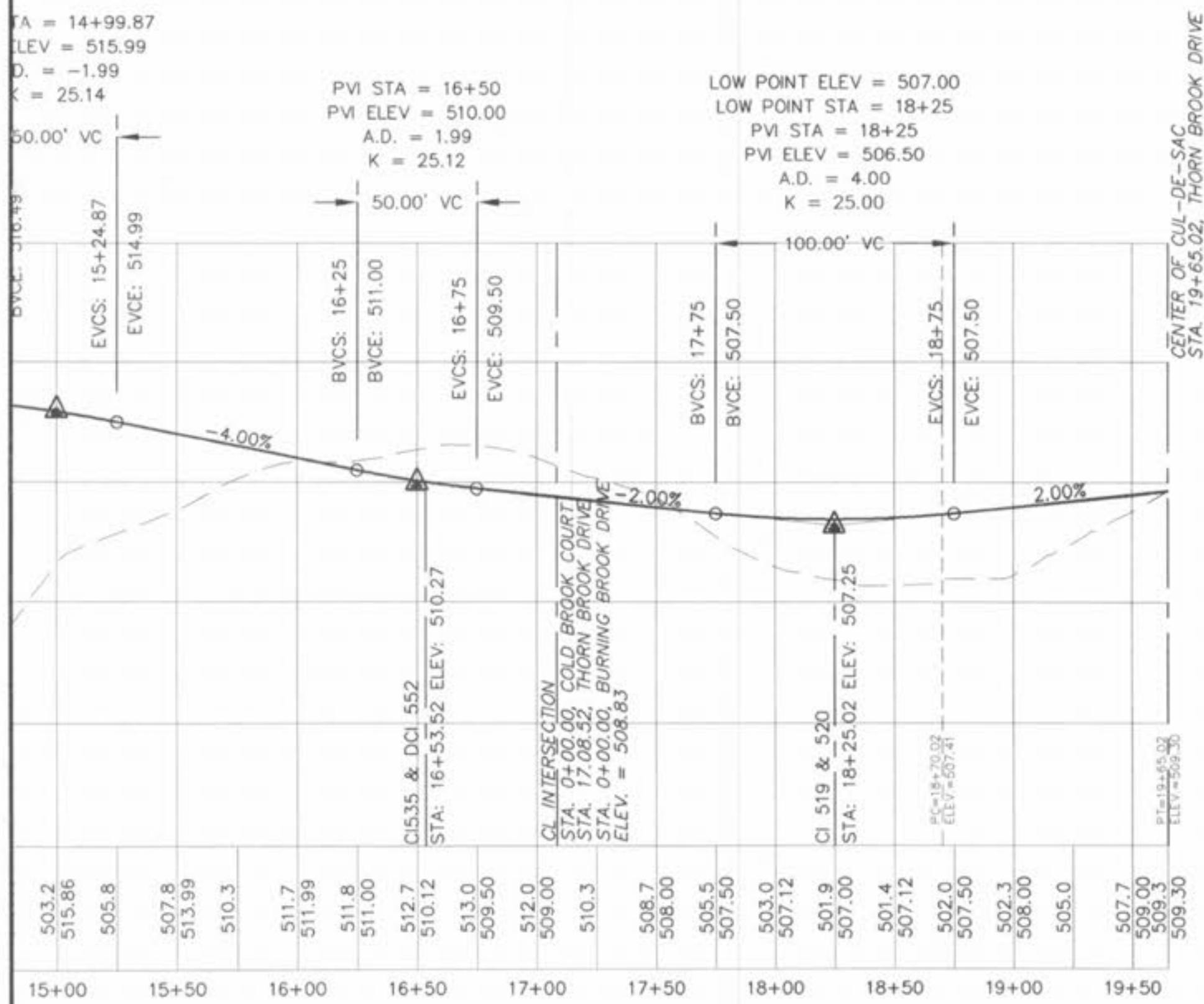

THORN BROOK DRIVE

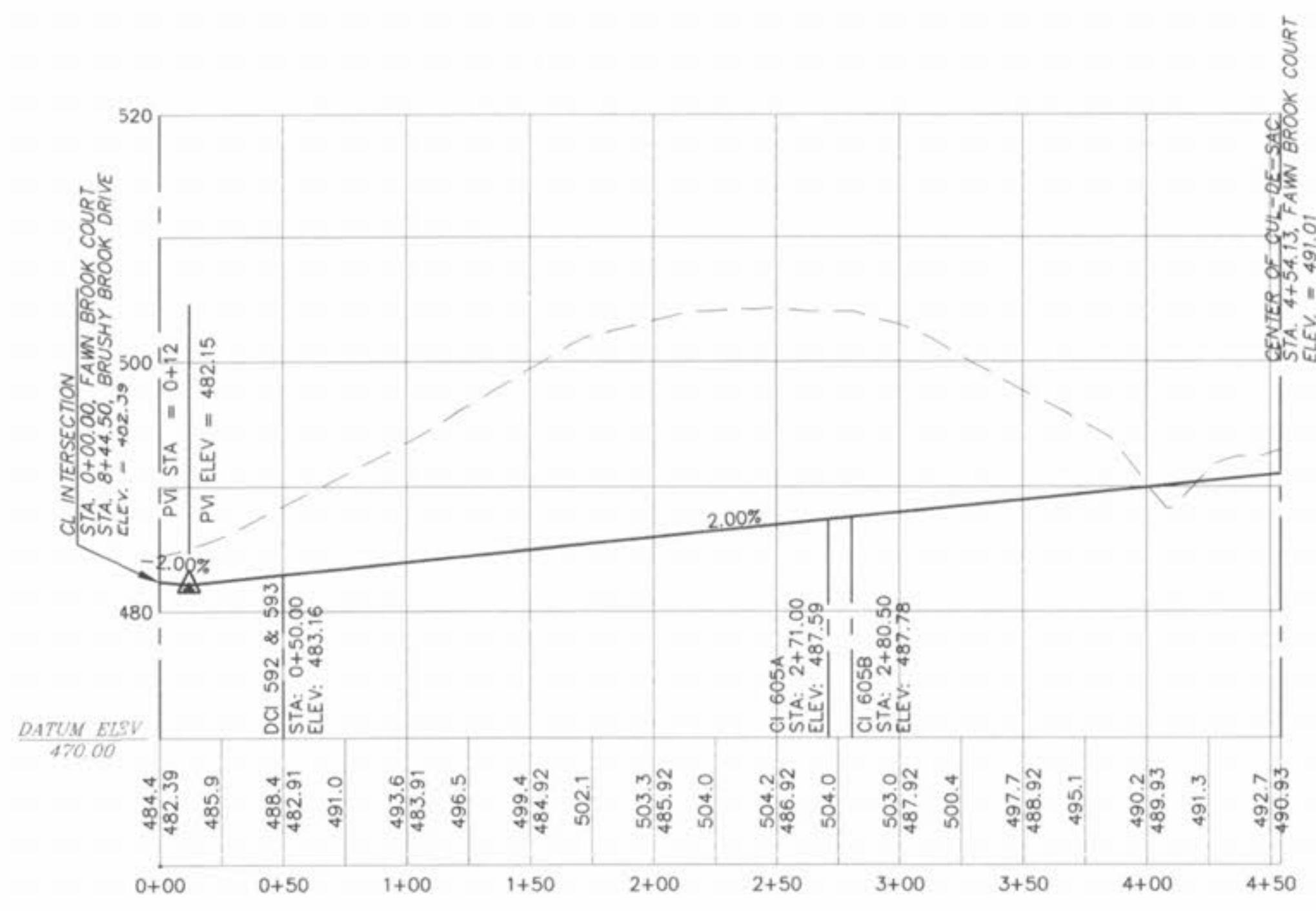

FAWN BROOK COURT

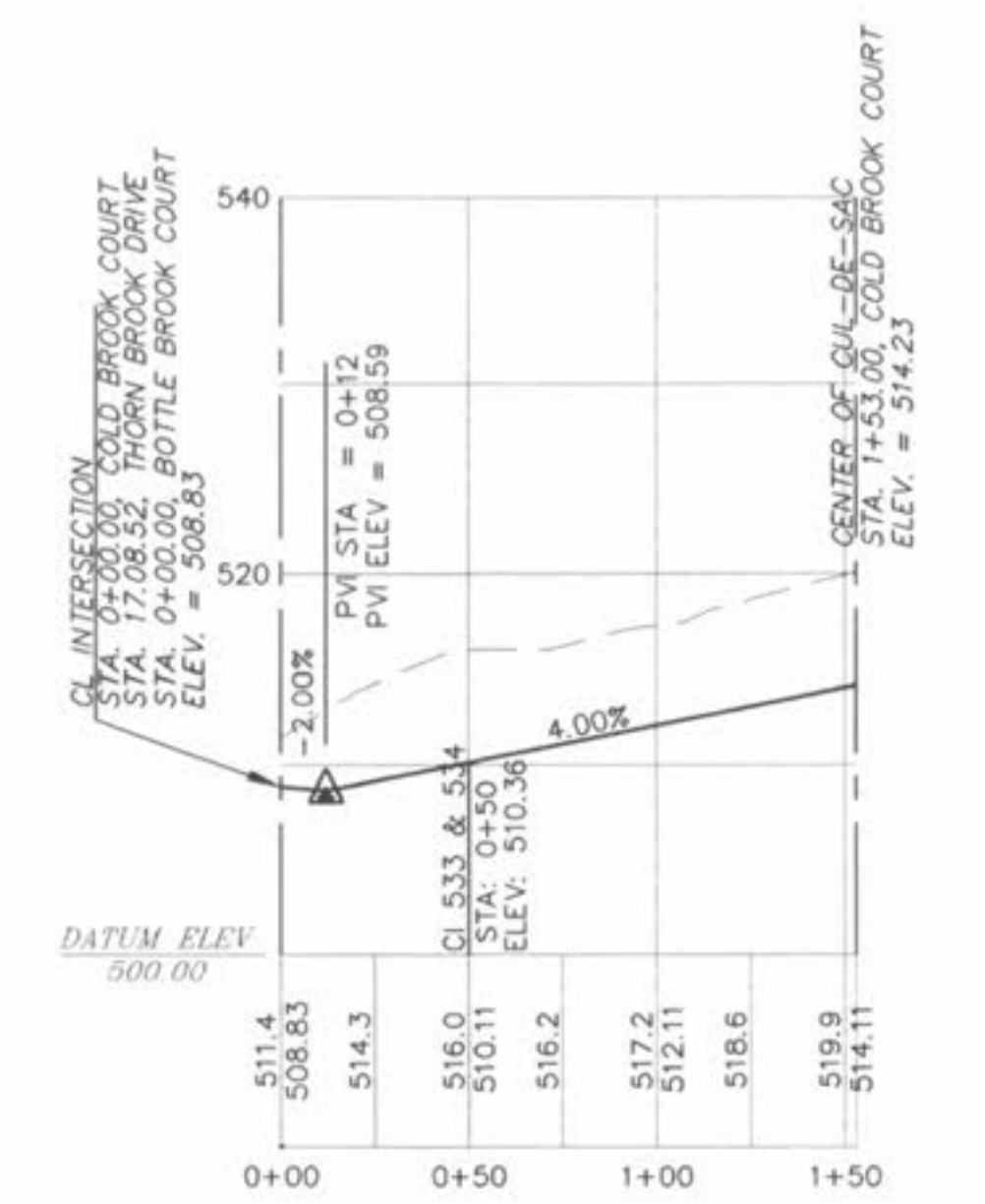

COLD BROOK COURT

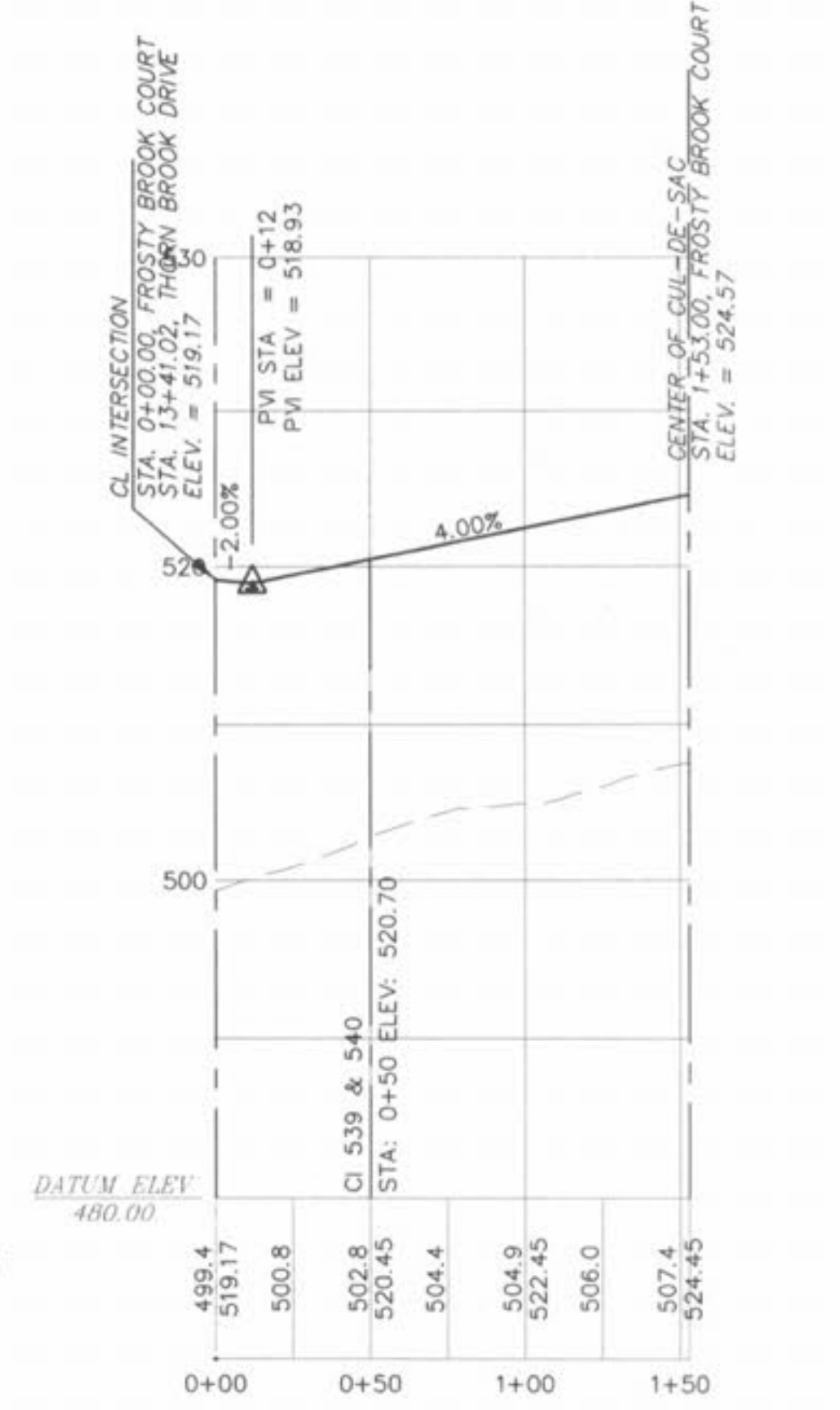

FROSTY BROOK COURT

**PICKETT RAY & SILVER**  
CIVIL ENGINEERS  
PLANNERS  
LAND SURVEYORS  
333 Mid Rivers Mall Drive  
St. Peters, MO 63376  
Phone (636) 397-1211  
Fax (636) 397-1104

**BROOKSIDE VILLAGE A**  
STREET PROFILES  
SUMMIT POINTE L.C.  
Prepared For:  
239 FOXHILL ROAD  
ST. CHARLES, MO 63501  
(636) 940-5500

REV.	NO.	DATE	REV. PER CITY COMMENTS
3	8/11/05	7/28/05	

**ENGINEERS AUTHENTICATION**  
The responsibility for professional engineering liability on this project is hereby limited to the set of plans authenticated by the seal, signature, and date hereunder attached. Responsibility is disclaimed for all other engineering plans involved in this project and specifically excludes revisions after this date unless reauthenticated.

PICKETT RAY & SILVER, INC.  
STATE OF MISSOURI  
REGISTERED PROFESSIONAL ENGINEER  
HAROLD J. BARTCH  
NUMBER E-17751

DRAWN	DATE
E.J.S.	FEB, 2005
CHECKED	DATE
D.W.D.	FEB, 2005
PROJECT #	03029_SUPO.01R
TASK #	002 FIELD BOOK 847