

TYPICAL GUARDRAIL SECTION
N.T.S.

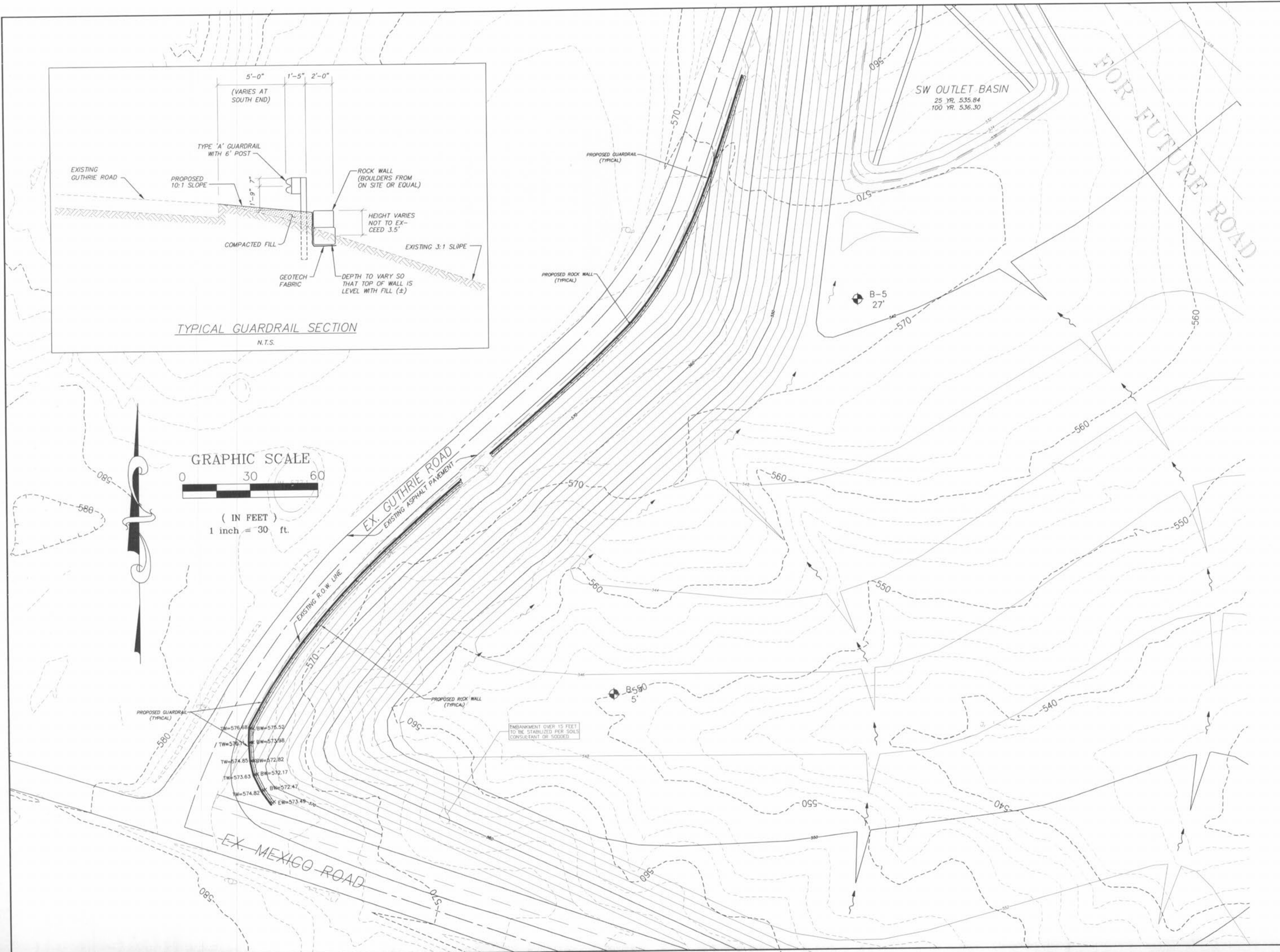
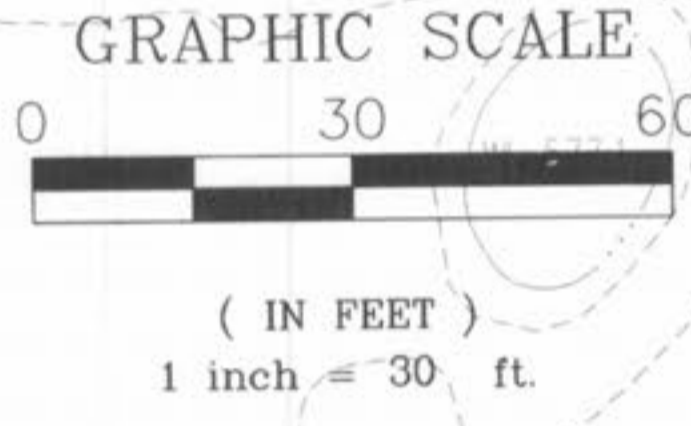

I:\server\projects\03029\dwg\03029GUARDRAIL.DWG, 8/11/2005 1:27:01 PM, NICK

PICKETT RAY & SILVER
 CIVIL ENGINEERS
 PLANNERS
 LAND SURVEYORS

333 Mid Rivers Mall Drive
 St. Peters, MO 63378
 Phone (636) 397-1211
 Fax (636) 397-1104

BROOKSIDE
 GUARDRAIL PLAN

Prepared For:
 Summit Pointe L.C.

219 FOX HILL ROAD
 ST. CHARLES, MISSOURI
 636-466-9596

REVISIONS	NO.	DATE	REV.	PER	CITY	COMMENTS
	3	8/11/05				

ENGINEERS AUTHENTICATION
 The responsibility for professional engineering liability on this project is hereby limited to the set of plans authenticated by the seal, signature, and date hereunder attached. Responsibility is disclaimed for all other engineering plans involved in this project and specifically excludes revisions after this date unless reauthenticated.

PICKETT RAY & SILVER, INC.
 STATE OF MISSOURI
 REGISTERED PROFESSIONAL ENGINEER
 HAROLD J. BARTCH
 NUMBER E-1775

DRAWN	DWD	DATE	7/08/05
CHECKED	JH	DATE	7/08/05
PROJECT #	03029.SUPO.01R		
TASK #	002	FIELD BOOK	847

BROOKSIDE
 GUARDRAIL PLAN
 SHEET 27A OF 149
 © Copyright 2005 by Pickett, Ray & Silver Inc.