

UTILITY NOTE:
 UNDERGROUND FACILITY STRUCTURES AND UTILITIES HAVE BEEN PLOTTED FROM AVAILABLE SURVEYS AND RECORDED INFORMATION AND, THEREFORE, THEIR LOCATIONS MUST BE CONSIDERED APPROXIMATE ONLY. VERIFICATION OF LOCATION OF ALL UNDERGROUND STRUCTURES AND FACILITIES EITHER SHOWN OR NOT SHOWN ON THESE PLANS, SHALL BE THE RESPONSIBILITY OF THE CONTRACTOR.

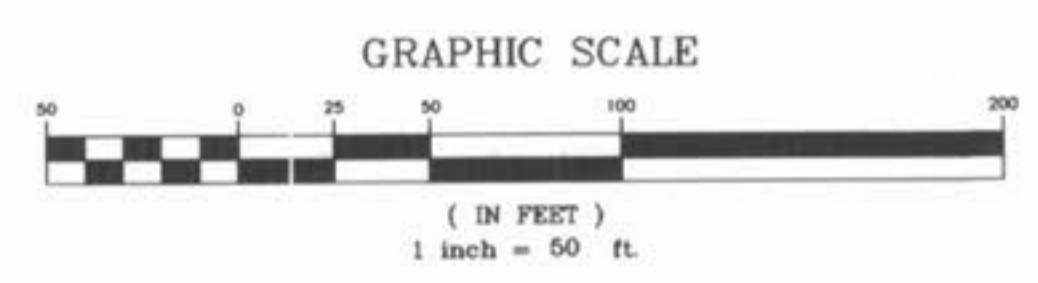

NOTE: SANITARY SEWER FORCE MAIN AS CONSTRUCTED TO BE CENTERED IN 10' W. EASEMENT

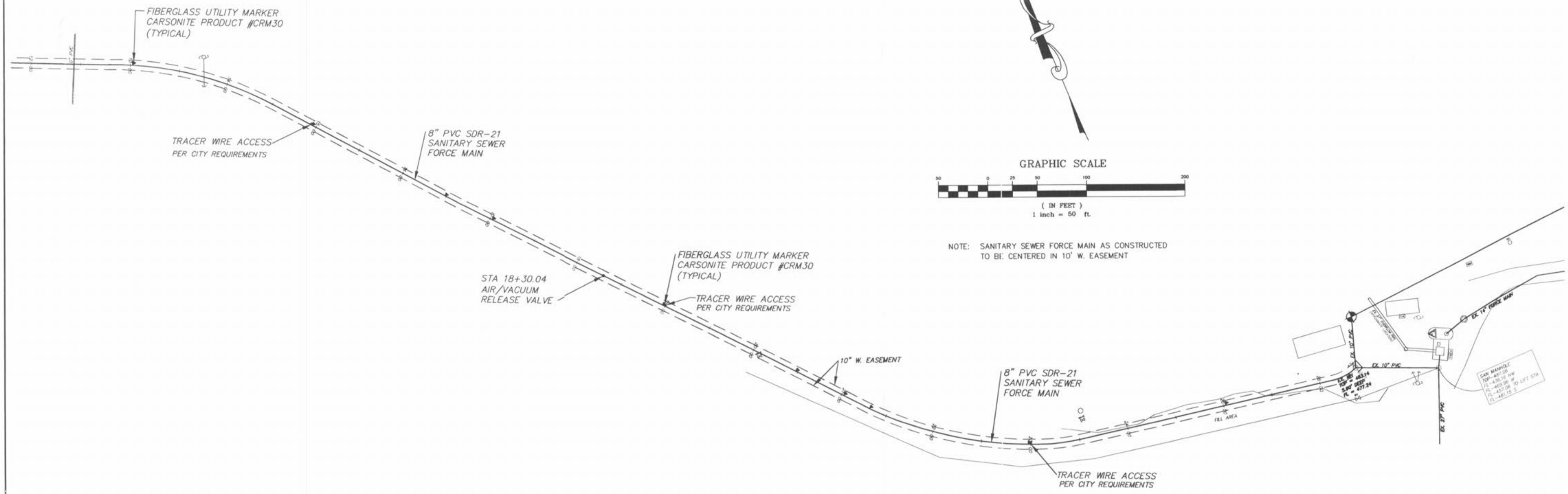
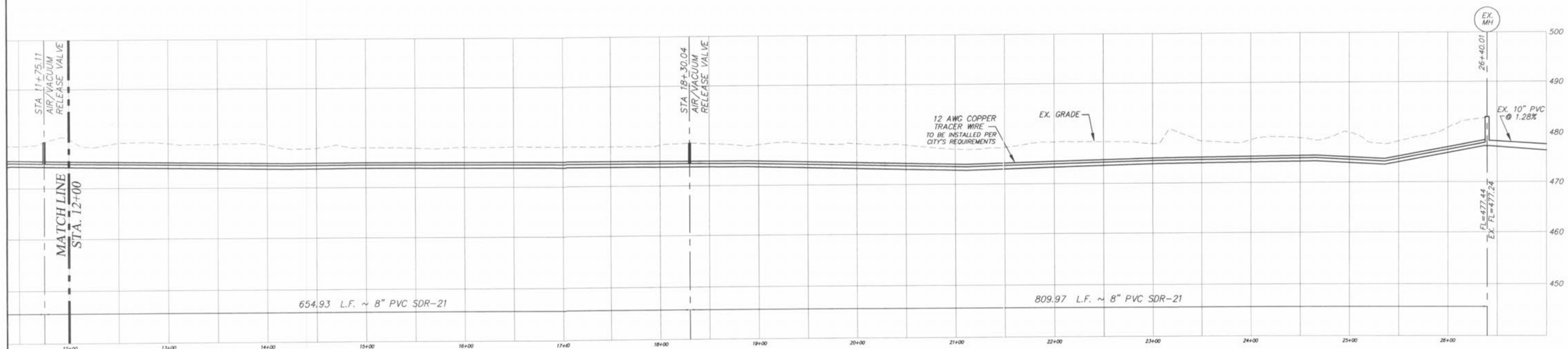

654.93 L.F. ~ 8" PVC SDR-21

809.97 L.F. ~ 8" PVC SDR-21

SCALES
 HOR: 1"=50'
 VER: 1"=10'

PICKETT RAY & SILVER
 CIVIL ENGINEERS
 PLANNERS
 LAND SURVEYORS

333 Mid Rivers Mall Drive
 St. Peters, MO 63376
 Phone (636) 397-1211
 Fax (636) 397-1104

BROOKSIDE VILLAGE A
 FORCE MAIN PLAN & PROFILE

Prepared For:
SUMMIT POINTE L.C.

239 FOX HILL ROAD
 SUMMIT POINT, MO 63081
 (636) 940-9300

| REVISIONS NO. | DATE | DESCRIPTION |
|---------------|----------|-------------------------------------|
| 1 | 9/21/04 | ADDED FLOW FROM EXPLAN PROPERTY |
| 2 | 8/11/05 | REV. PER CITY COMMENTS 7/28/05 |
| 3 | 11/22/05 | REV. OFF-SITE FORCE MAIN PER CLIENT |
| 4 | 12/22/05 | REV. PER CITY COMMENTS |

ENGINEERS AUTHENTICATION
 The responsibility for professional engineering liability on this project is hereby limited to the set of plans authenticated by the seal, signature, and date hereunder attached. Responsibility is disclaimed for all other engineering plans involved in this project and specifically excludes revisions after this date unless reauthenticated.

PICKETT, RAY & SILVER, INC.
 STATE OF MISSOURI
 REGISTERED PROFESSIONAL ENGINEER
 ELMER ANDERSON
 NUMBER: E-16146
 12/23/05

| | | | |
|-----------|----------------|------------|-----------|
| DRAWN | CAD | DATE | FEB, 2005 |
| CHECKED | DWD | DATE | FEB, 2005 |
| PROJECT # | 03029.SUPO.01R | | |
| TASK # | 002 | FIELD BOOK | 847 |