

\\server\projects\03029\dwg\03029-PRO.dwg, 8/11/2005 1:06:43 PM, NICK

FALLING BROOK DRIVE

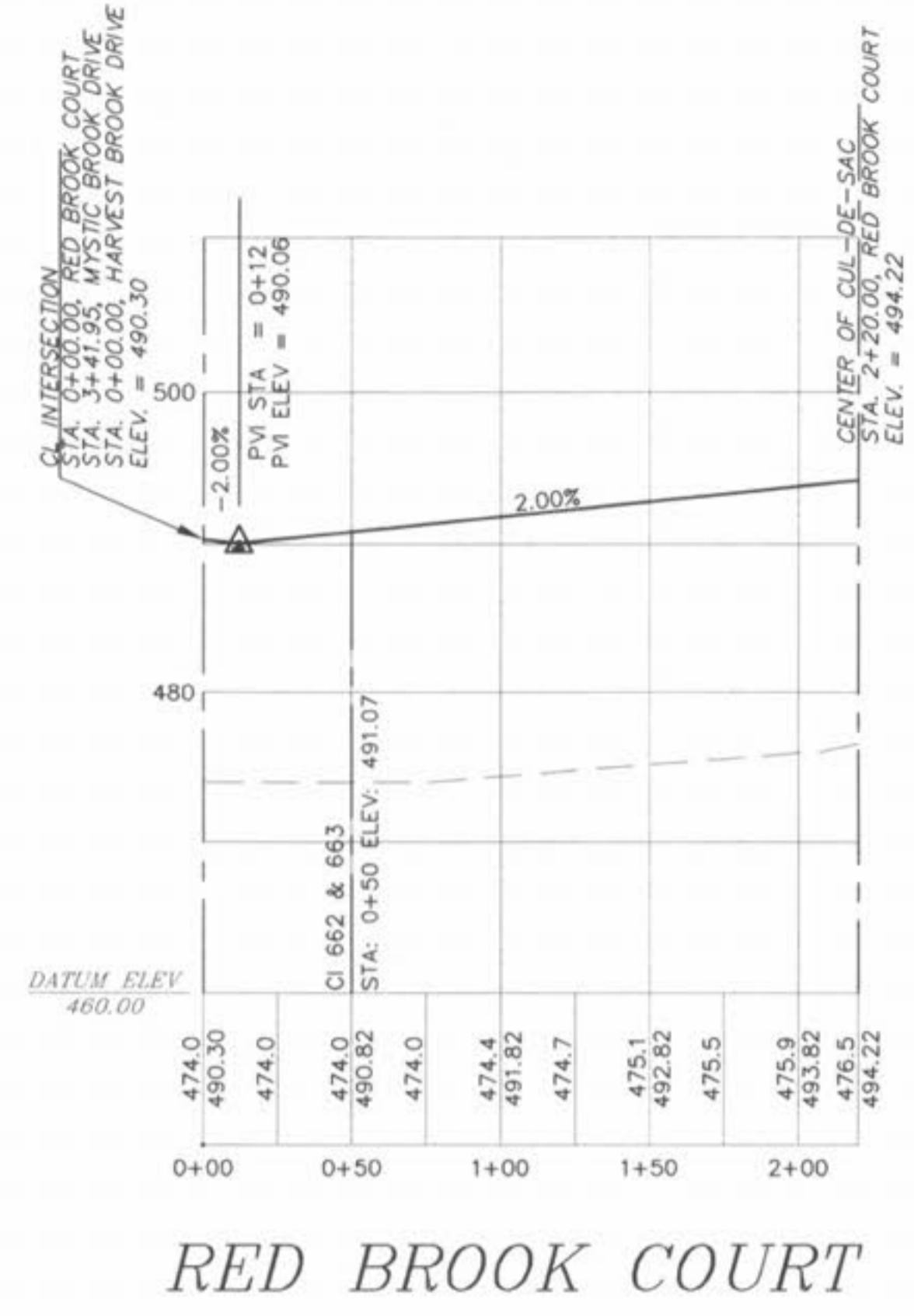
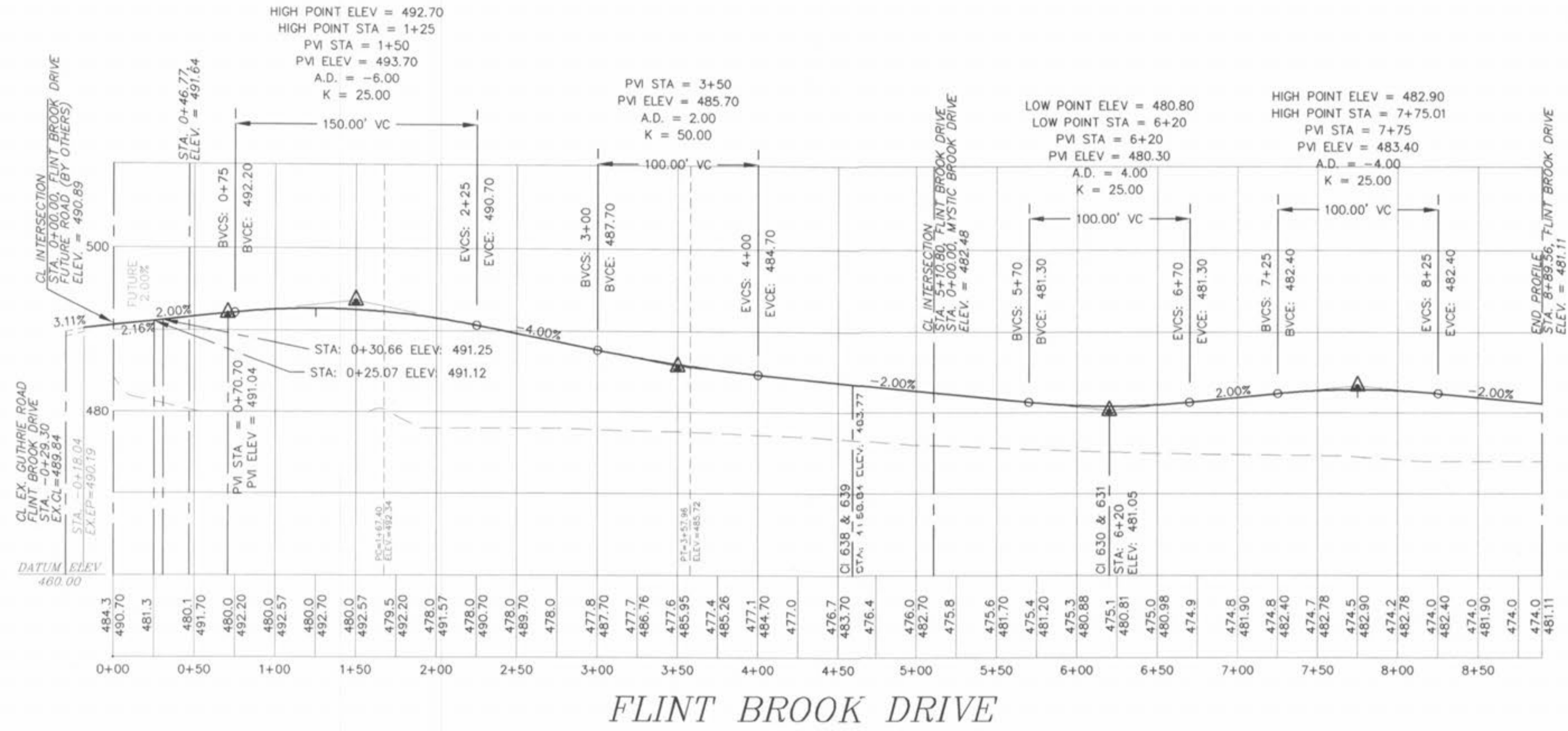
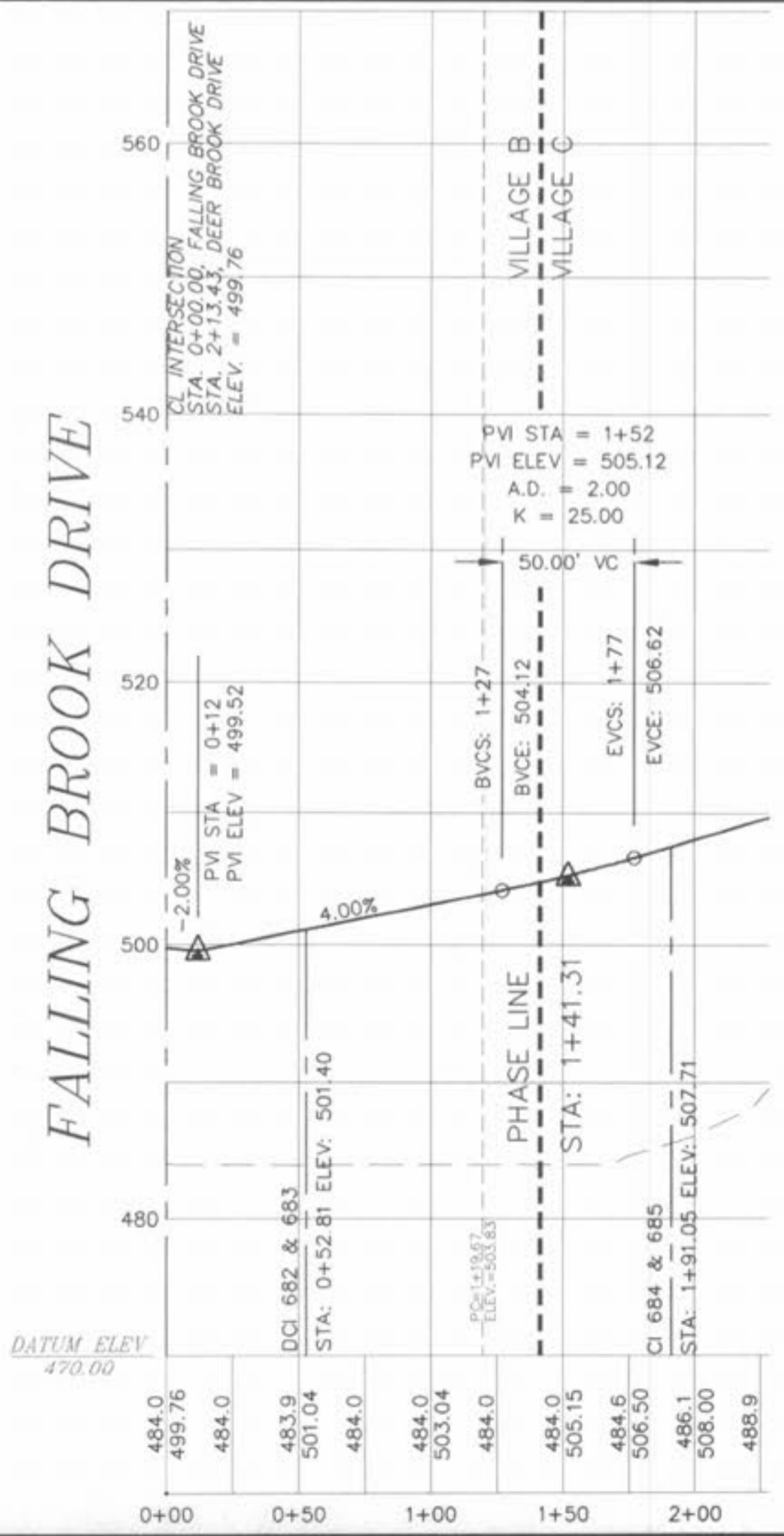

HORIZONTAL SCALE: 1" = 50'
VERTICAL SCALE: 1" = 10'

PICKETT RAY & SILVER
CIVIL ENGINEERS
PLANNERS
LAND SURVEYORS

333 Mid Rivers Mall Drive
St. Peters, MO 63376
Phone (636) 397-1211
Fax (636) 397-1104

BROOKSIDE VILLAGE B
STREET PROFILES

Prepared For:
SUMMIT POINTE L.C.

239 FOX HILL ROAD
ST. PETERS, MO. 63301
(636) 949-2529

REVISIONS	NO.	DATE	REV. PER CITY COMMENTS
3	6/31/05		

ENGINEERS AUTHENTICATION
The responsibility for professional engineering liability on this project is hereby limited to the set of plans authenticated by the seal, signature, and date hereunder attached. Responsibility is disclaimed for all other engineering plans involved in this project and specifically excludes revisions after this date unless reauthenticated.

PICKETT RAY & SILVER, INC.
STATE OF MISSOURI
REGISTERED PROFESSIONAL ENGINEER
HAROLD J. BARTCH
NUMBER E-17751

DRAWN E.J.S.	DATE FEB., 2005
CHECKED D.W.D.	DATE FEB., 2005
PROJECT # 03029.SUP0.01R	
TASK # 002 FIELD BOOK 847	

VILLAGE B
STREET PROFILES

SHEET **82B** OF 149

Copyright 2005 by Pickett, Ray & Silver Inc.