

VILLAGE A PHASE ONE AS-BUILTS

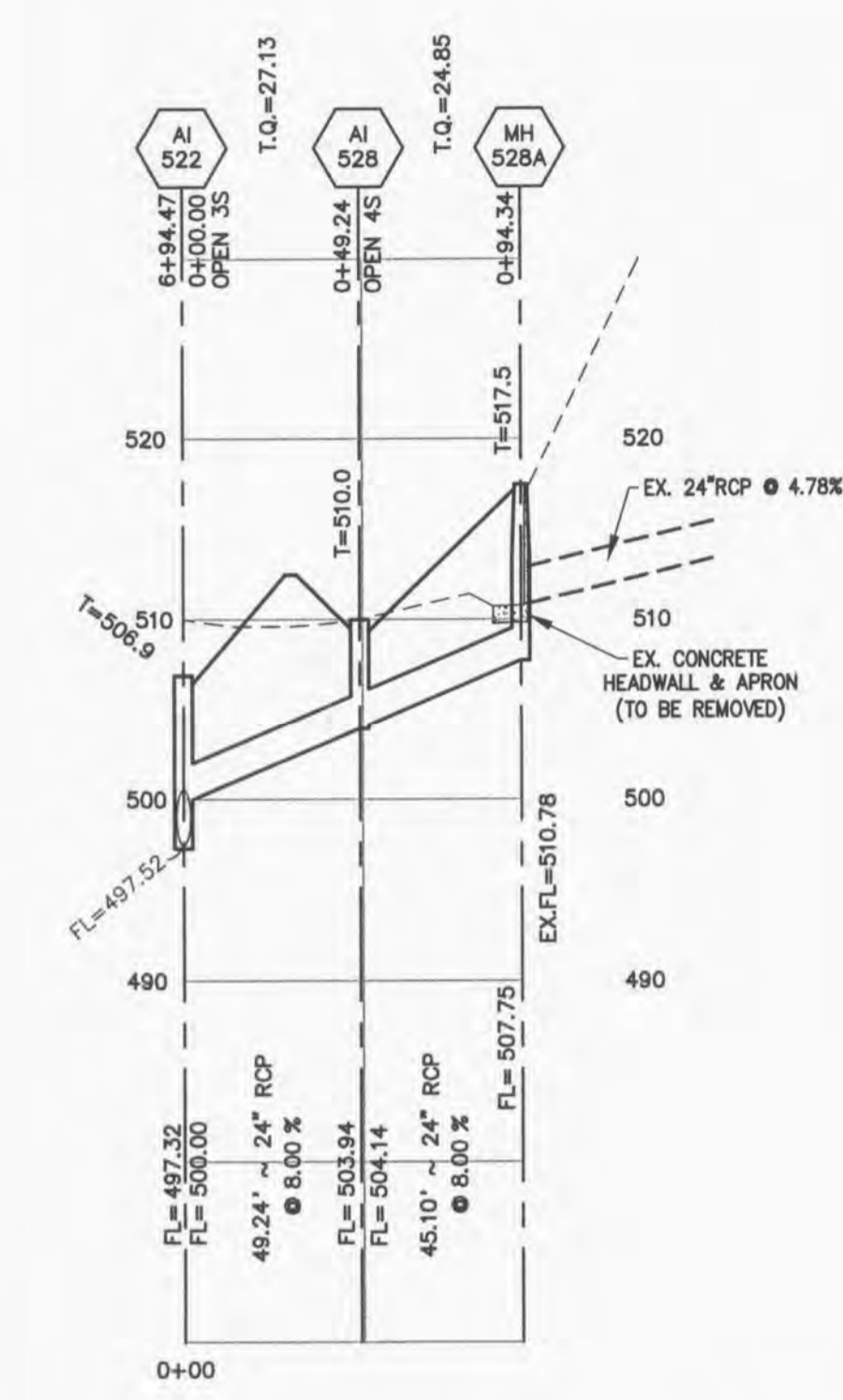
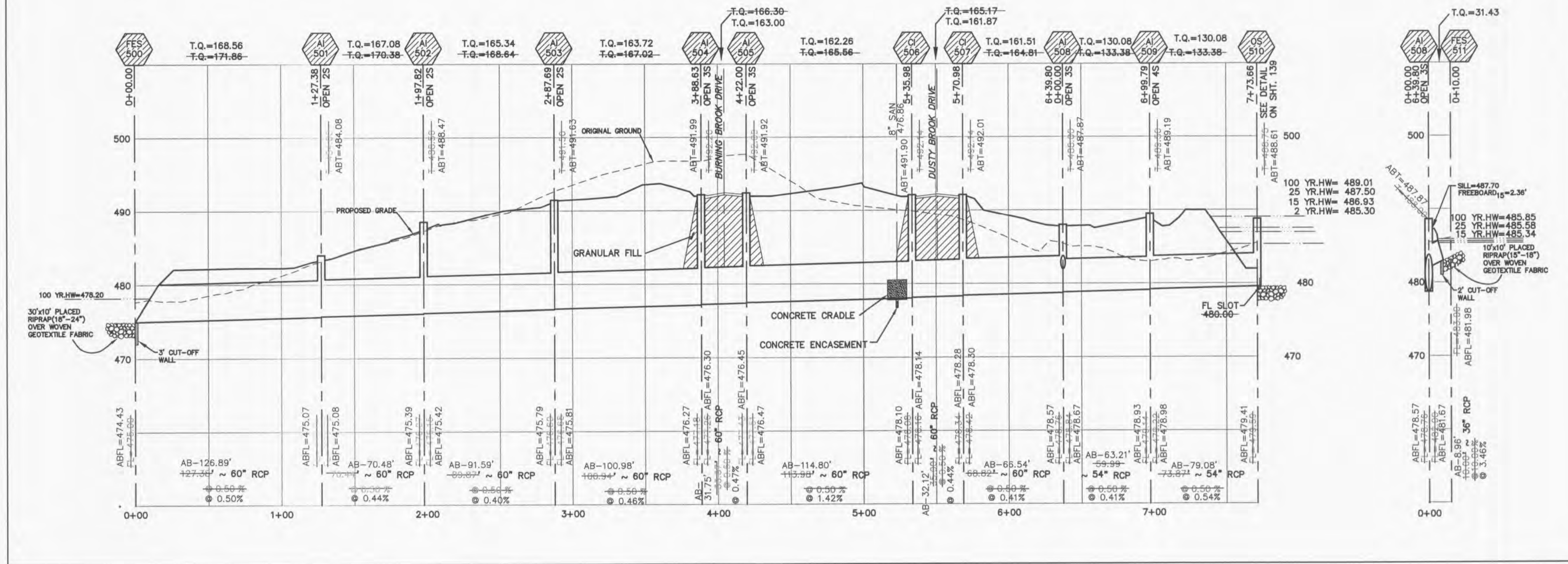

SCALE: 1"=50' HORIZONTAL
1"=10' VERTICAL
ALL STORM SEWERS MUST MAINTAIN A MINIMUM OF 36" COVER OVER TOP OF PIPE.

STORM SEWERS WHICH CROSS OVER EXISTING OR PROPOSED SANITARY SEWER TRENCHES SHALL BE GRADED IN CONCRETE (OR ENCASED H.D.P.E.) THROUGH THE FULL WIDTH OF THE SANITARY SEWER TRENCH. THE TRENCH SHALL BE BACKFILLED AND COMPACTED GRANULAR FILL TO THE BOTTOM OF THE CONCRETE CRADLE.

IF THE STORM AND SANITARY SEWERS ARE PARALLEL AND IN THE SAME TRENCH OR OVERDIG, THE UPPER SHALL BE PLACED ON A SHELF AND THE LOWER SHALL BE BEDDED IN COMPACTED GRANULAR FILL TO THE FLOW LINE OF THE UPPER.

ALL SANITARY LATERAL STREET CROSSINGS, IF TRENCHED, SHALL BE BACKFILLED WITH GRANULAR MATERIAL (AGGREGATE).

NOTE: THE EXISTING DISCHARGE POINT OF EACH EXISTING FLARED END SECTION IN THIS PHASE SHALL BE EVALUATED IN THE FIELD BY THE ENGINEER, CONTRACTOR, AND CITY INSPECTOR FOR EFFECTIVENESS AND FIELD MODIFIED, IF NECESSARY, TO REDUCE EROSION AND UNDERMINING.

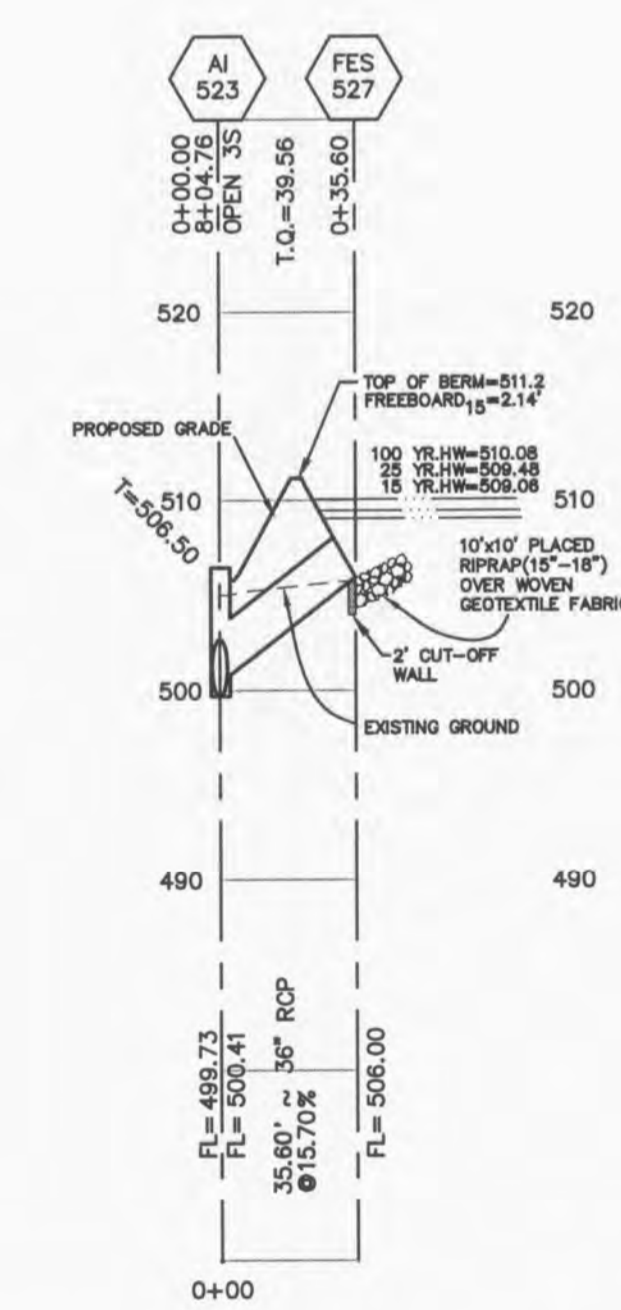
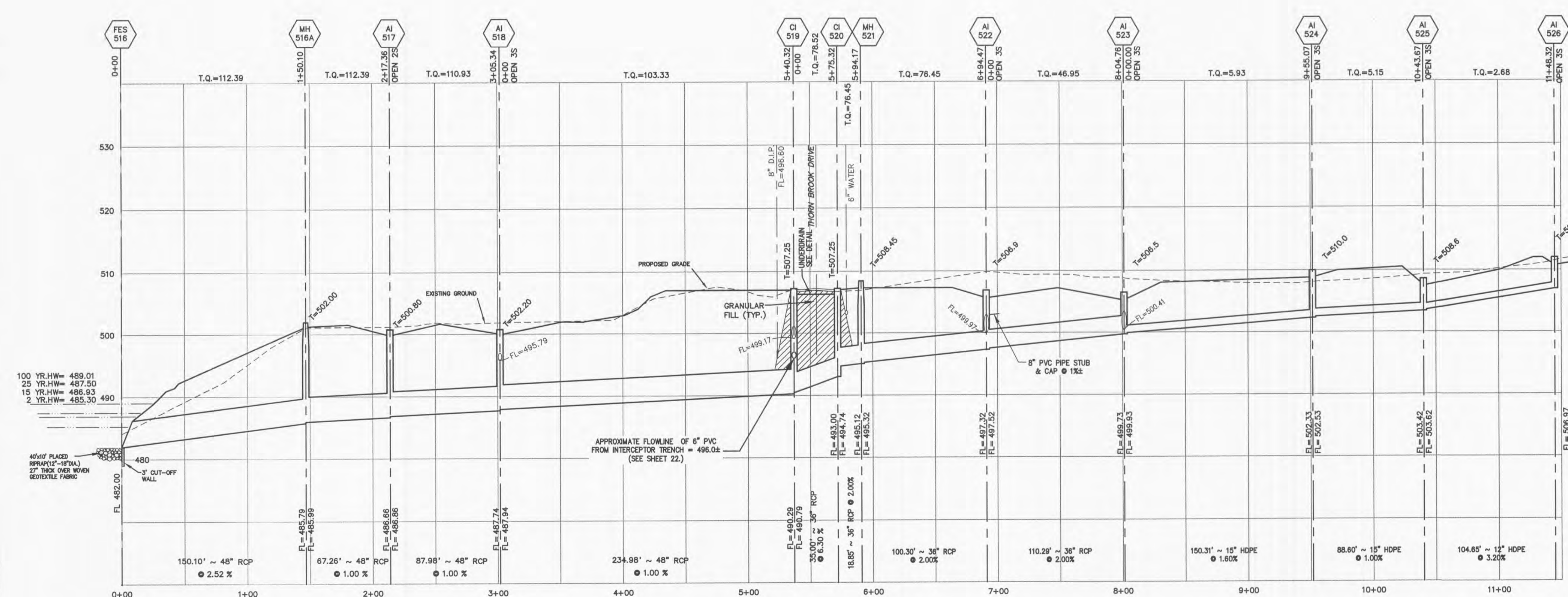

PROJECT TITLE
BROOKSIDE VILLAGE A

PICKETT, RAY & SILVER INC
CIVIL ENGINEERING, LAND SURVEYING,
AND NATURAL RESOURCES SERVICES
St. Peters
22 Richmond Center Court
St. Peters, MO 65059
Phone (636) 397-1211 Fax (636) 397-1104
www.prs3.com 1-800-708-3918

ENGINEERS AUTHENTICATION
THE RESPONSIBILITY FOR PROFESSIONAL ENGINEERING LIABILITY ON THIS PROJECT IS HEREBY LIMITED TO THE SET OF PLANS AUTHENTICATED BY THE SEAL, SIGNATURE AND DATE. ENGINEERS ATTACHED RESPONSIBILITY IS DISCLAIMED FOR ALL OTHER ENGINEERING PLANS REVISED IN THIS PROJECT AND SPECIFICALLY EXCLUDES REVISIONS AFTER THIS DATE UNLESS REAUTHENTICATED.

PICKETT, RAY & SILVER, INC.
NO LICENSE #000325

DOUGLAS S. TIEMANN
PROFESSIONAL ENGINEER LICENSE E-23345

150 YEARS
Lombardo
H.O.M.E.S.
OF EXCELLENCE

Developer / Owner Information
Lombardo Homes of St. Louis, LLC
2299 Technology Drive, Suite 150
O'Fallon, Missouri 63368

CITY OF O'FALLON Storm Sewer Profiles

P+Z No. 2603.04

City No.

Page No.

17 of 40