

THIS SHEET FOR DRAINAGE PURPOSES ONLY - NOT FOR CONSTRUCTION

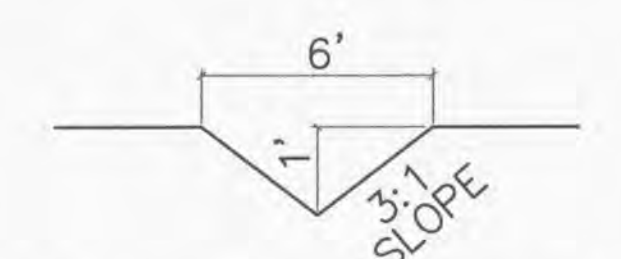

YARD SWALE (TYP.)
NOTE: DITCH TO BE EITHER
SODDED OR SEEDED & MULCHED.

V-DITCH: 1' DEEP, 3:1 SIDES
n = 0.030, Slope = 2.0% (MIN.)
Q = 3.00 cfs (MAX.)
DEPTH = 0.81'

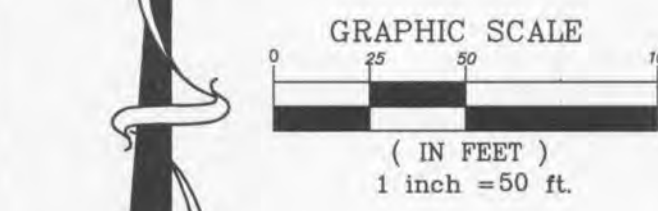

UTILITY NOTE:
UNDERGROUND FACILITY STRUCTURES AND UTILITIES HAVE BEEN
PLOTTED FROM AVAILABLE SURVEYS AND RECORDED INFORMATION AND,
THEREFORE, THEIR LOCATIONS MUST BE CONSIDERED APPROXIMATE ONLY.
VERIFICATION OF LOCATION OF ALL UNDERGROUND STRUCTURES AND
FACILITIES EITHER SHOWN OR NOT SHOWN ON THESE PLANS, SHALL BE
THE RESPONSIBILITY OF THE CONTRACTOR.

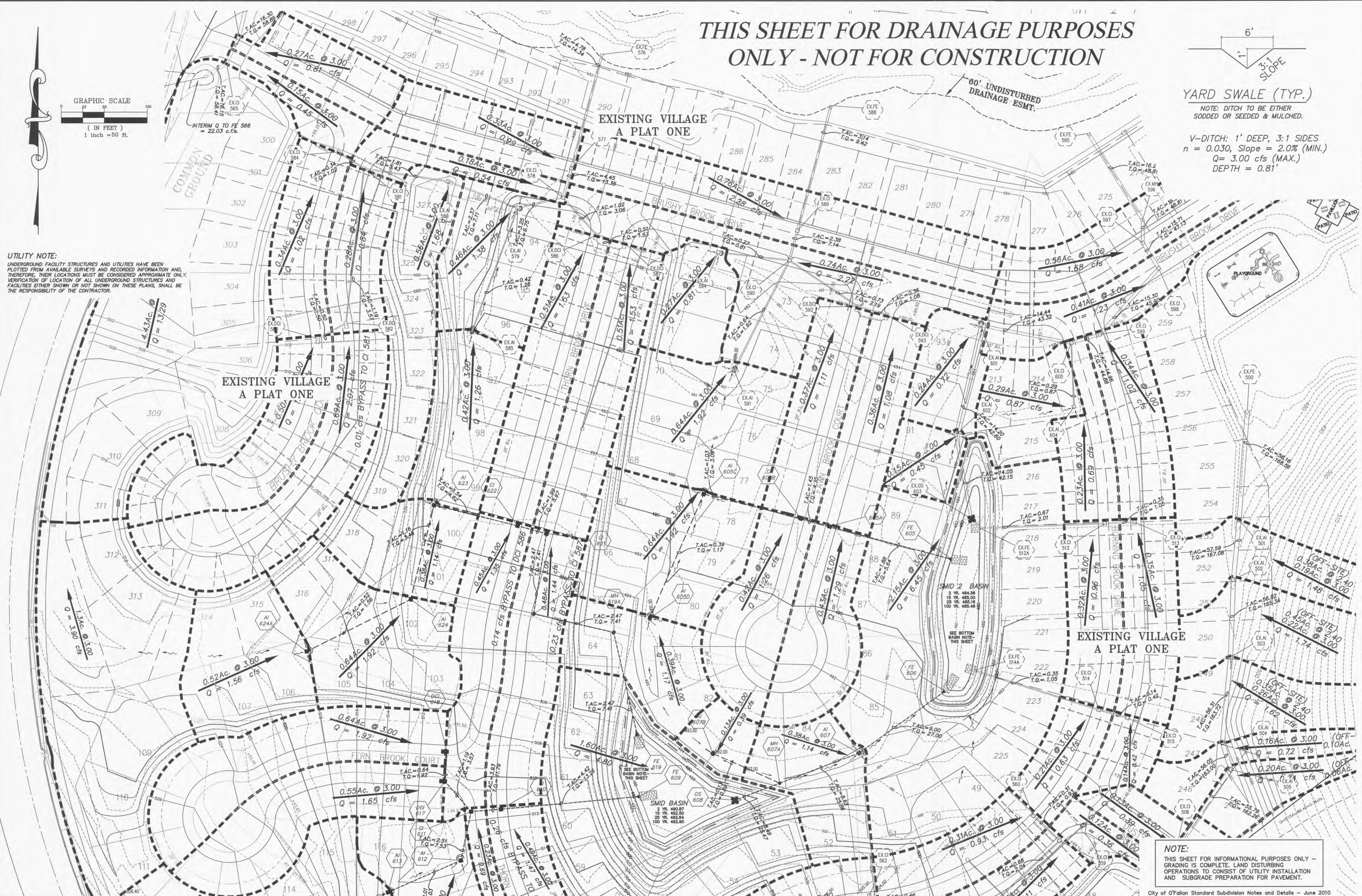

PROJECT TITLE

**BROOKSIDE
VILLAGE A**

PRS No. 03029L0MB01R

PICKETT, RAY & SILVER INC

CIVIL ENGINEERING, LAND SURVEYING,
AND NATURAL RESOURCES SERVICES

St. Peters
22 Richmond Center Court
St. Peters, MO 65076

Phone (636) 397-1211 Fax (636) 397-1104
www.prs3.com 1-800-708-3918

ENGINEERS AUTHORIZATION
THE RESPONSIBILITY FOR PROFESSIONAL ENGINEERING
SERVICES ON THIS PROJECT IS HEREBY LIMITED TO THE
SET OF PLANS AUTHORIZED BY THE SEAL, SIGNATURE,
AND DATE HERETOBY ATTACHED. RESPONSIBILITY IS
DISCLAIMED FOR ALL OTHER ENGINEERING PLANS INVOLVED
IN THIS PROJECT AND SPECIALLY INCLUDES REVISIONS
AFTER THE DATE THESE SERVICES WERE RENDERED.



DOUGLAS S. TIEMANN
PROFESSIONAL ENGINEER LICENSE E-23345

Developer / Owner Information

Lombardo Homes of St. Louis, LLC
2299 Technology Drive, Suite 150
O'Fallon, Missouri 63368

CITY OF O'FALLON Drainage Area Map

P+Z No. 2603.04

City No.

Page No.

23 of 40

NOTE:
THIS SHEET FOR INFORMATIONAL PURPOSES ONLY -
GRADING IS COMPLETE. LAND DISTURBING
OPERATIONS TO CONSIST OF UTILITY INSTALLATION
AND SUBGRADE PREPARATION FOR PAVEMENT.

City of O'Fallon Standard Subdivision Notes and Details - June 2010