

ISSUE	DATE / REMARKS
1	06/28/2017 Initial Submittal
2	10/06/2017 City Comments
3	11/10/2017 City Comments
4	12/16/2017 City Comments
5	01/11/2018 City Resubmittal

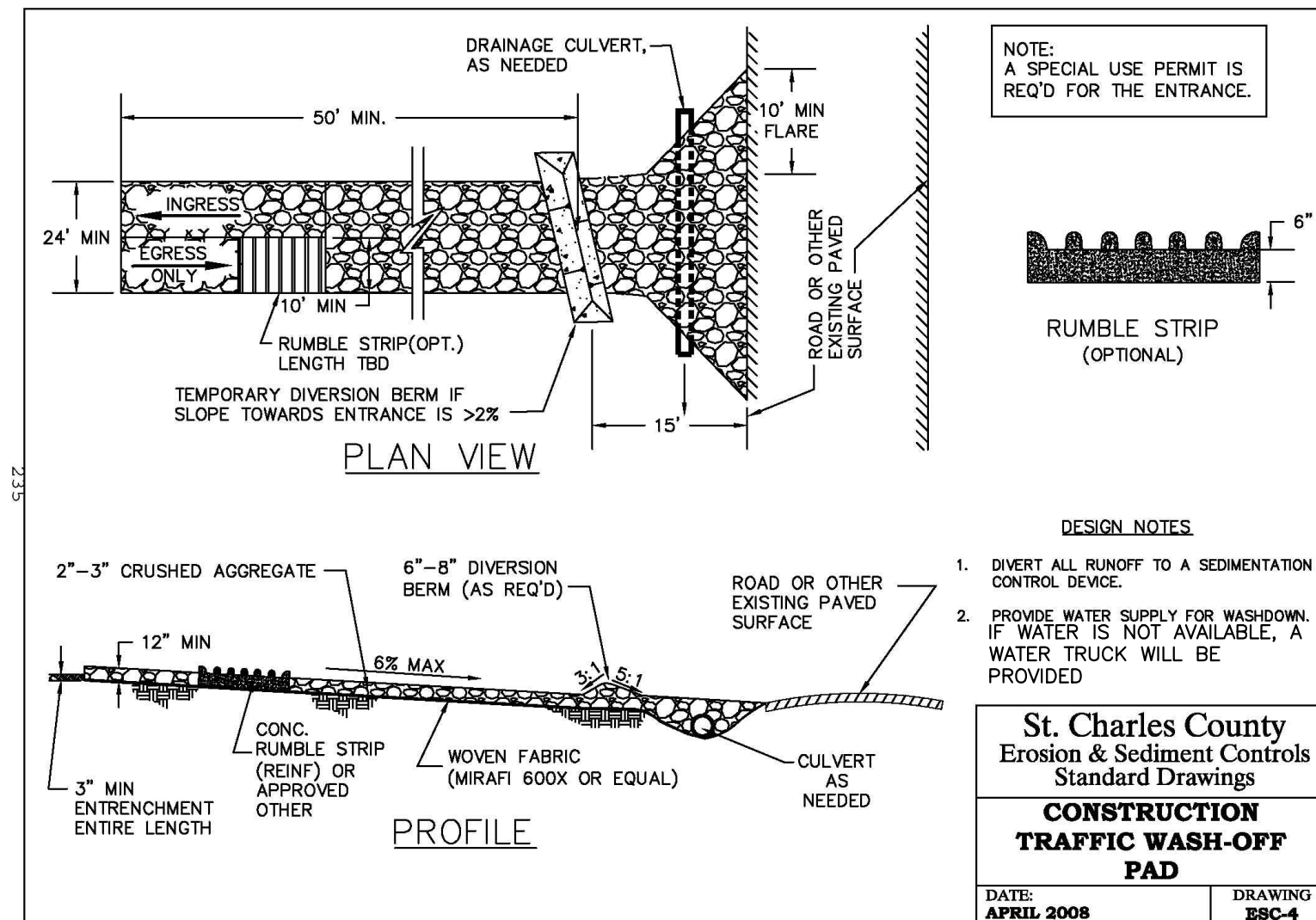
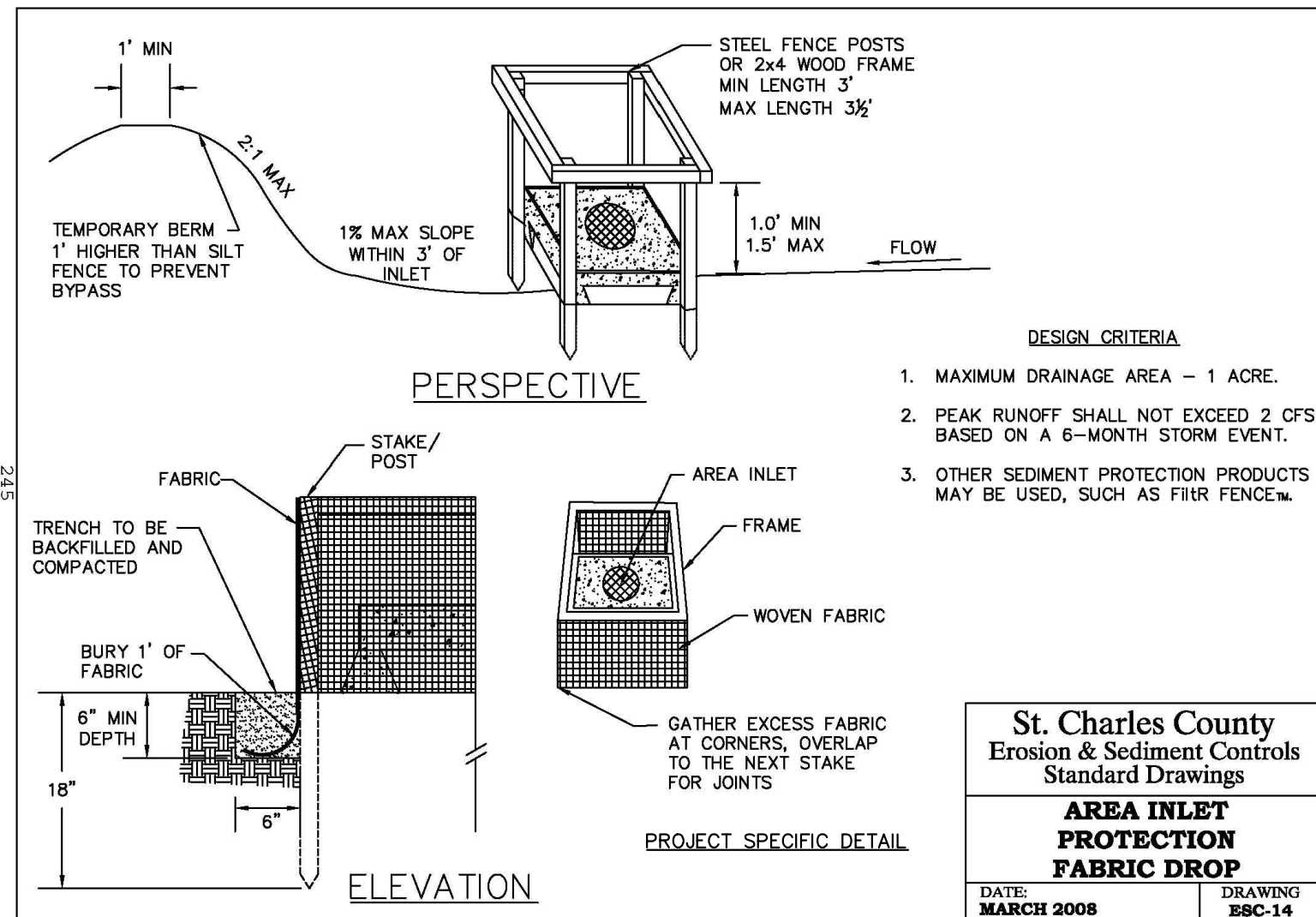

RollMax® Installation Guidelines:

North American Green is the world's leading provider of performance-guaranteed erosion control solutions. For more than 25 years, our line of erosion and sediment control products has kept our customers on solid ground. Our short-term and long-term Erosion Control Blankets (ECBs) and Turf Reinforcement Mats (TRMs) keep you one step ahead of just about any erosion challenge.

North American Green provides everything you need to know for quick, accurate erosion control installation tailored to your site. From start to finish, the North American Green® RollMax System® product installation instructions are based on extensive research and field-proven techniques to ensure project success. The following pages offer instructions and guidelines for several scenarios you may encounter during the installation of the RollMax System.

EXPERIENCE YOU CAN RELY ON

We are the industry leader when it comes to providing comprehensive erosion and sediment control and turf reinforcement solutions. We have developed integrated systems and products with the sole objective to ensure absolute customer satisfaction. Our products are backed by the most thorough quality assurance practices in the industry. In addition, we provide comprehensive design assistance for every North American Green system.

For additional installation assistance with the RollMax System, please visit www.naerogreen.com, e-mail customerservice-nag@naerogreen.com, or call 800-772-2040 and we will be happy to put you in touch with an erosion control specialist who can assist you.

Installation Made Easy

When under the pressure of severe conditions, even the best erosion control products can't function to their full potential without proper installation and anchoring. North American Green supplies a wide variety of fastener options for nearly every application and soil type.

For use in cohesive soils, wire staples are a cost-effective means to fasten RollMax System Rolled Erosion Control Products (RECPs). Available in 6 in., 8 in., 10 in., and 12 in. lengths, our U-shaped staples reach various depths to ensure adequate pull-out resistance. For installation using our handy Pin Pounder installation tool, 6 in. V-top staples or 6 in. circle top pins are available.

Our biodegradable BioStaples® are available in 4 in. and 6 in. lengths and provide an environmentally friendly alternative to metal staples. For an even more durable, deeper-reaching yet all-natural anchoring option, our wood EcoStaples® are available in 6 in., 12 in., 18 in., and 24 in. lengths.

For severe applications needing the ultimate, long-lasting hold, try our 12 in. and 18 in. rebar staples, our 12 in. plastic ShoreMax® stakes, or our complete line of percussion earth anchors. The earth anchors reach deep into the soil strata to offer enhanced anchoring in the worst conditions. Our variety of earth anchors are designed for durability and holding power under extreme hydraulic stresses and adverse soil conditions.

STAPLE PATTERNS

Proper staple patterns must be used to achieve optimal results in RECP installation. We recommend the following general stapling patterns as guidance for use with our RECPs as seen in (Figure 1). Site-specific staple pattern recommendations based on soil type and severity of application may be acquired through our Erosion Control Materials Design Software (ECMDS®). www.ecmids.com

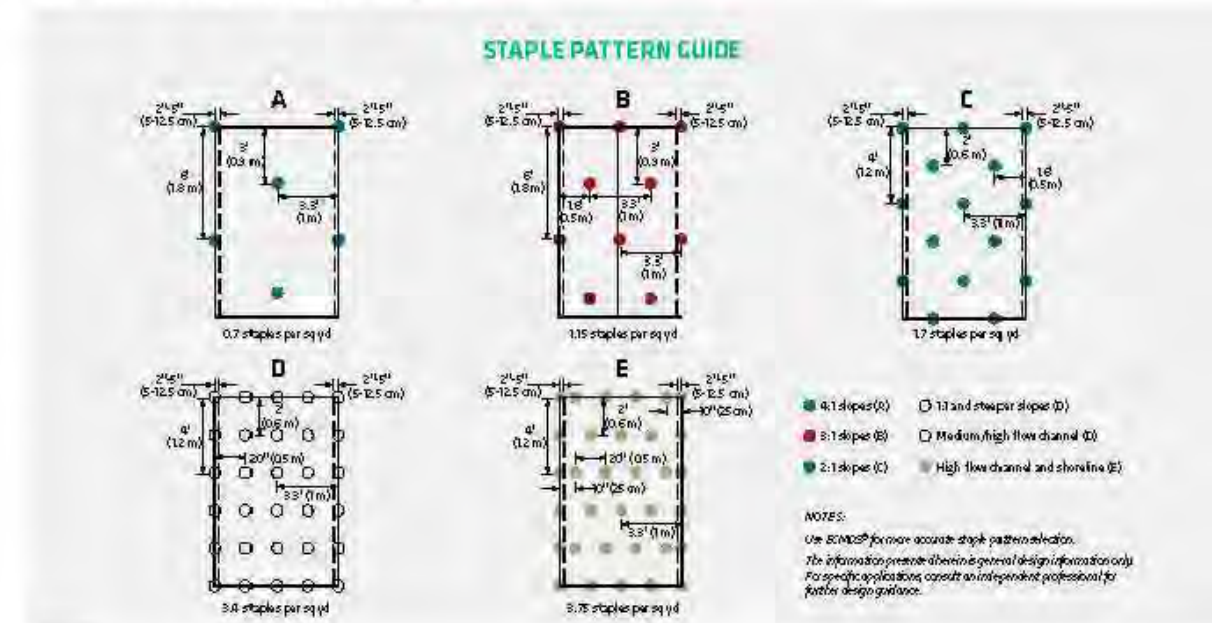

Slope Installation

The following slope guide outlines general recommendations for installing RollMax System temporary and/or permanent RECPs on sloping applications. Consult the staple pattern guide (Figure 1) for fastener spacing recommendations based on the slope severity.

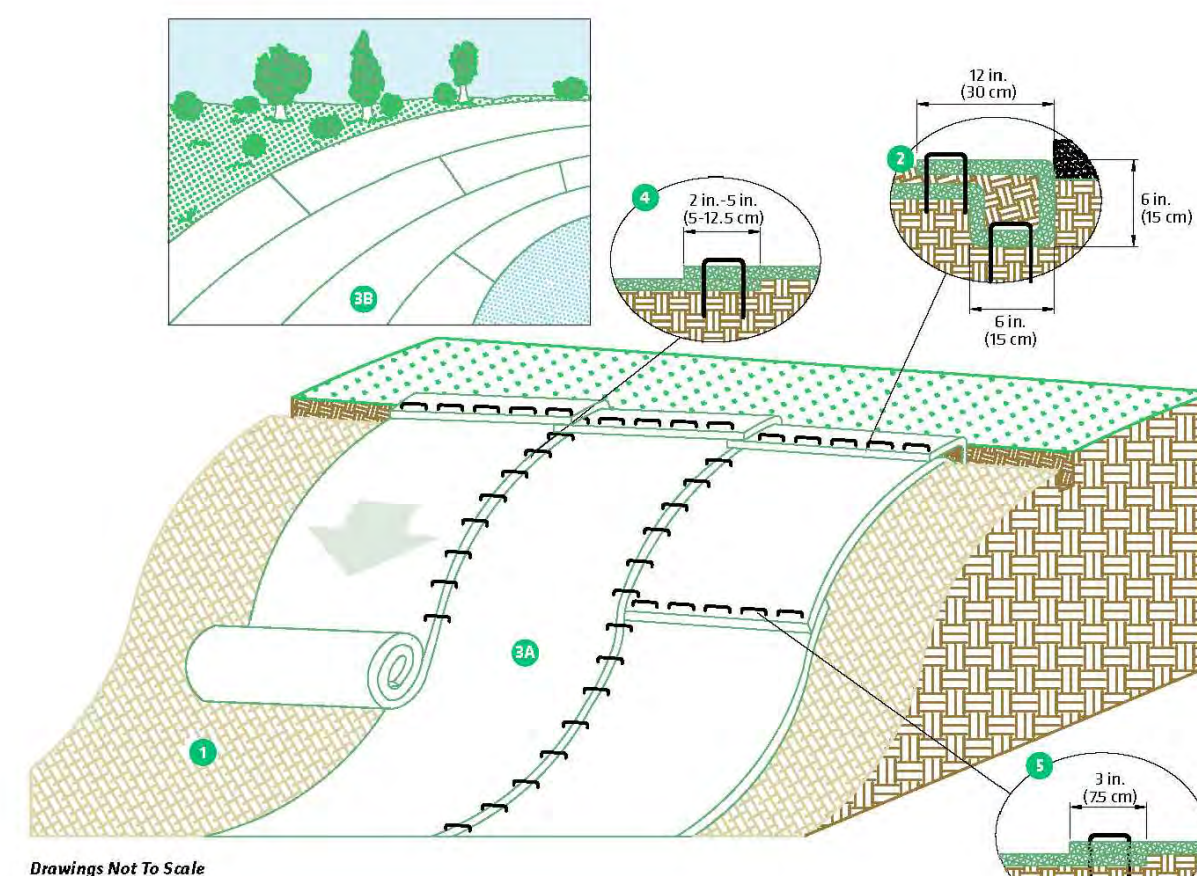

- SLOPE INSTALLATION STEPS**
1. Prepare soil before installing RECPs, including any necessary application of lime, fertilizer and seed.
 2. Begin at the top of the slope by anchoring the RECPs in a 6 in. (15 cm) deep x 6 in. (15 cm) wide trench with approximately 12 in. (30 cm) of RECPs extended beyond the upslope portion of the trench. Anchor the RECPs with a row of staples/stakes approximately 12 in. (30 cm) apart in the bottom of the trench. Backfill and compact the trench after stapling. Apply seed to the compacted soil and fold the remaining 12 in. (30 cm) portion of RECPs back over the seed and compacted soil. Secure RECPs over compacted soil with a row of staples/stakes spaced approximately 12 in. (30 cm) apart across the width of the RECPs.
 3. Roll the RECPs (3A) down or (3B) horizontally across the slope. RECPs will unroll with appropriate side against the soil surface. All RECPs must be securely fastened to soil surface by placing staples/stakes in appropriate locations as shown in the staple pattern guide.
 4. The edges of parallel RECPs must be stapled with an approximately 2 in. (5-12.5 cm) overlap depending on the RECP type.
 5. Consecutive RECPs spliced down the slope must be end-over-end (shingle style) with an approximate 3 in. (7.5 cm) overlap. Staple through overlapped area, approximately 12 in. (30 cm) apart across entire RECPs width.*
- *NOTE: In adverse soil conditions longer staples/stakes or earth anchors may be necessary to properly secure the RECPs.**

Channel Installation

The following channel guide outlines general recommendations for installing RollMax System temporary and/or permanent RECPs in concentrated flow applications. Consult the staple pattern guide (Figure 1) for fastener spacing recommendations based on the channel severity.

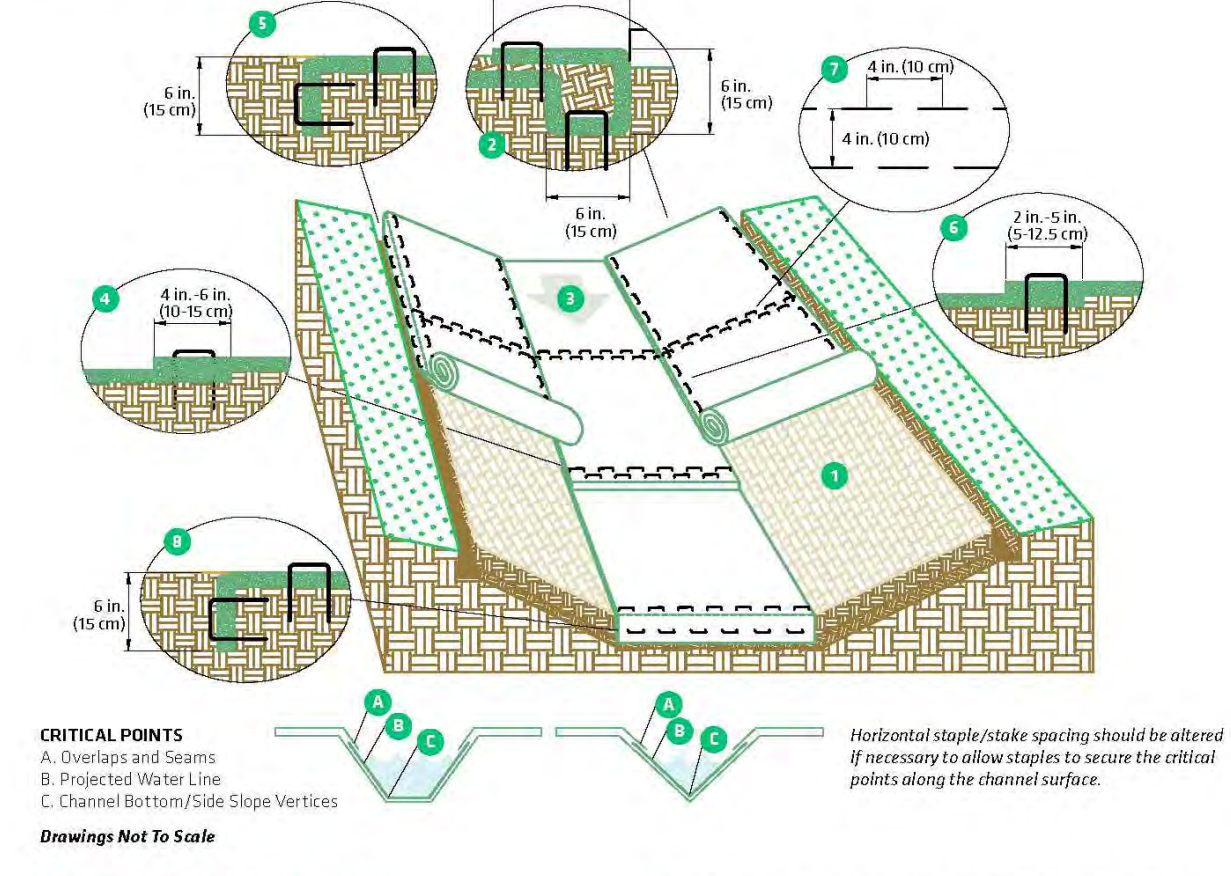

- CHANNEL INSTALLATION STEPS**
1. Prepare soil before installing RECPs, including any necessary application of lime, fertilizer and seed.
 2. Begin at the top of the channel by anchoring the RECPs in a 6 in. (15 cm) deep x 6 in. (15 cm) wide trench with approximately 12 in. (30 cm) of RECPs extended beyond the upslope portion of the trench. For supplemental scour protection, use RevErosion System ShoreMax® Mat at the channel/culvert outlet as needed. Anchor the RECPs with a row of staples/stakes approximately 12 in. (30 cm) apart in the bottom of the trench. Backfill and compact the trench after stapling. Apply seed to the compacted soil and fold the remaining 12 in. (30 cm) portion of RECPs back over the seed and compacted soil. Secure RECPs over compacted soil with a row of staples/stakes spaced approximately 12 in. (30 cm) apart across the width of the RECPs.
 3. Roll center RECPs in direction of water flow in bottom of channel. RECPs will unroll with appropriate side against the soil surface. All RECPs must be securely fastened to soil surface by placing staples/stakes in appropriate locations as shown in the staple pattern guide.
 4. Place consecutive RECPs end-over-end (shingle style) with a 4 in. (10-15 cm) overlap. Use a double row of staples staggered 4 in. (10 cm) apart and 4 in. (10 cm) on center to secure RECPs.
 5. Full-length edge of RECPs at top of side slopes must be anchored with a row of staples/stakes approximately 12 in. (30 cm) apart in a 6 in. (15 cm) deep x 6 in. (15 cm) wide trench. Backfill and compact the trench after stapling.
 6. Adjacent RECPs must be overlapped approximately 2 in. (5-12.5 cm) (depending on RECP type) and stapled.*
 7. In high flow channel applications a staple check slot is recommended at 30 to 40 ft (9-12 m) intervals. Use a double row of staples staggered 4 in. (10 cm) apart and 4 in. (10 cm) on center over entire width of the channel.
 8. The terminal end of the RECPs must be anchored with a row of staples/stakes approximately 12 in. (30 cm) apart in a 6 in. (15 cm) deep x 6 in. (15 cm) wide trench. Backfill and compact the trench after stapling.
- *NOTE: In adverse soil conditions longer staples/stakes or earth anchors may be necessary to properly secure the RECPs.**



PROJECT TITLE

Brookview

OFFALLON, MISSOURI

THE **STERLING** CO.
ENGINEERS & SURVEYORS

5055 New Baumgartner Road
St. Louis, Missouri 63129
Ph 314-487-0440 Fax 314-487-8944
www.sterling-eng-sur.com
Corporate Certificate of Authority #001348



Date: 01/11/18
SEAN ACKLEY
LICENSE # PE-2009018679
Civil Engineer

McBride Guthrie, LLC
16091 Swingley Ridge Road, Suite 300
Chesterfield, Missouri 63017
Ph. (636) 537-2000
Fax (636) 537-2546

SWPPP DETAILS

P-Z No. 17-005894
City No. 17-008288
Date: 01/11/18
Job No. 17-02-041

Page No.

4.9

IMP