

ISSUE	DATE	REMARKS
1	06/26/2017	Initial Submittal
2	10/06/2017	City Comments
3	11/10/2017	City Comments
4	12/15/2017	City Comments
5	01/11/2018	City Resubmittal

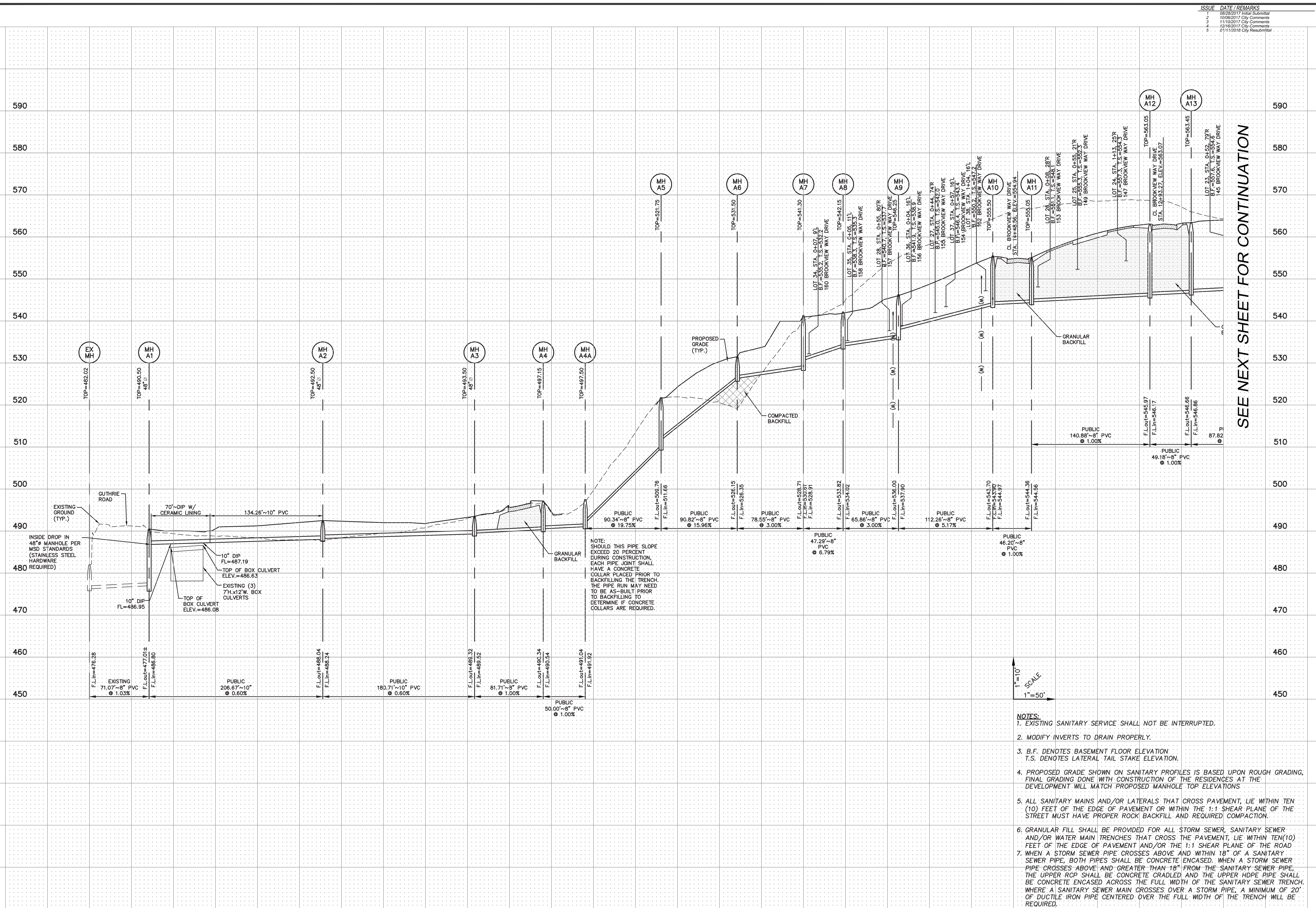

SEE NEXT SHEET FOR CONTINUATION

1" = 10'
1" = 50'

- NOTES:**
- EXISTING SANITARY SERVICE SHALL NOT BE INTERRUPTED.
 - MODIFY INVERTS TO DRAIN PROPERLY.
 - B.F. DENOTES BASEMENT FLOOR ELEVATION
T.S. DENOTES LATERAL TAIL STAKE ELEVATION.
 - PROPOSED GRADE SHOWN ON SANITARY PROFILES IS BASED UPON ROUGH GRADING, FINAL GRADING DONE WITH CONSTRUCTION OF THE RESIDENCES AT THE DEVELOPMENT WILL MATCH PROPOSED MANHOLE TOP ELEVATIONS
 - ALL SANITARY MAINS AND/OR LATERALS THAT CROSS PAVEMENT, LIE WITHIN TEN (10) FEET OF THE EDGE OF PAVEMENT OR WITHIN THE 1:1 SHEAR PLANE OF THE STREET MUST HAVE PROPER ROCK BACKFILL AND REQUIRED COMPACTION.
 - GRANULAR FILL SHALL BE PROVIDED FOR ALL STORM SEWER, SANITARY SEWER AND/OR WATER MAIN TRENCHES THAT CROSS THE PAVEMENT, LIE WITHIN TEN(10) FEET OF THE EDGE OF PAVEMENT AND/OR THE 1:1 SHEAR PLANE OF THE ROAD
 - WHEN A STORM SEWER PIPE CROSSES ABOVE AND WITHIN 18" OF A SANITARY SEWER PIPE, BOTH PIPES SHALL BE CONCRETE ENCASED. WHEN A STORM SEWER PIPE CROSSES ABOVE AND GREATER THAN 18" FROM THE SANITARY SEWER PIPE, THE UPPER RCP SHALL BE CONCRETE CRADLED AND THE UPPER HDPE PIPE SHALL BE CONCRETE ENCASED ACROSS THE FULL WIDTH OF THE SANITARY SEWER TRENCH. WHERE A SANITARY SEWER MAIN CROSSES OVER A STORM PIPE, A MINIMUM OF 20" OF DUCTILE IRON PIPE CENTERED OVER THE FULL WIDTH OF THE TRENCH WILL BE REQUIRED.

PROJECT TITLE

Brookview
OF FALLON, MISSOURI

THE STERLING CO.
ENGINEERS & SURVEYORS
5055 New Baumgartner Road
St. Louis, Missouri 63129
Ph 314-487-0440 Fax 314-487-8944
www.sterling-eng-sur.com
Corporate Certificate of Authority #001348



Date: 01/11/18
SEAN ACKLEY
LICENSE # PE-2009018679
Civil Engineer

McBride Guhrlic, LLC
16091 Swingley Ridge Road, Suite 300
Chesterfield, Missouri 63017
Ph. (636) 537-2000
Fax (636) 537-2546

SANITARY SEWER PROFILES

P+Z No. 17-005894
City No. 17-008288
Date: 01/11/18
Job No. 17-02-041
Page No.

8.1

IMP