

Drawing name: V:\1702041\_Guthrie\_Road\_Drawings\Engineering\Improvements\041 IMP.dwg Plotted on: Jan 11, 2019 - 5:43am Plotted by: ackley

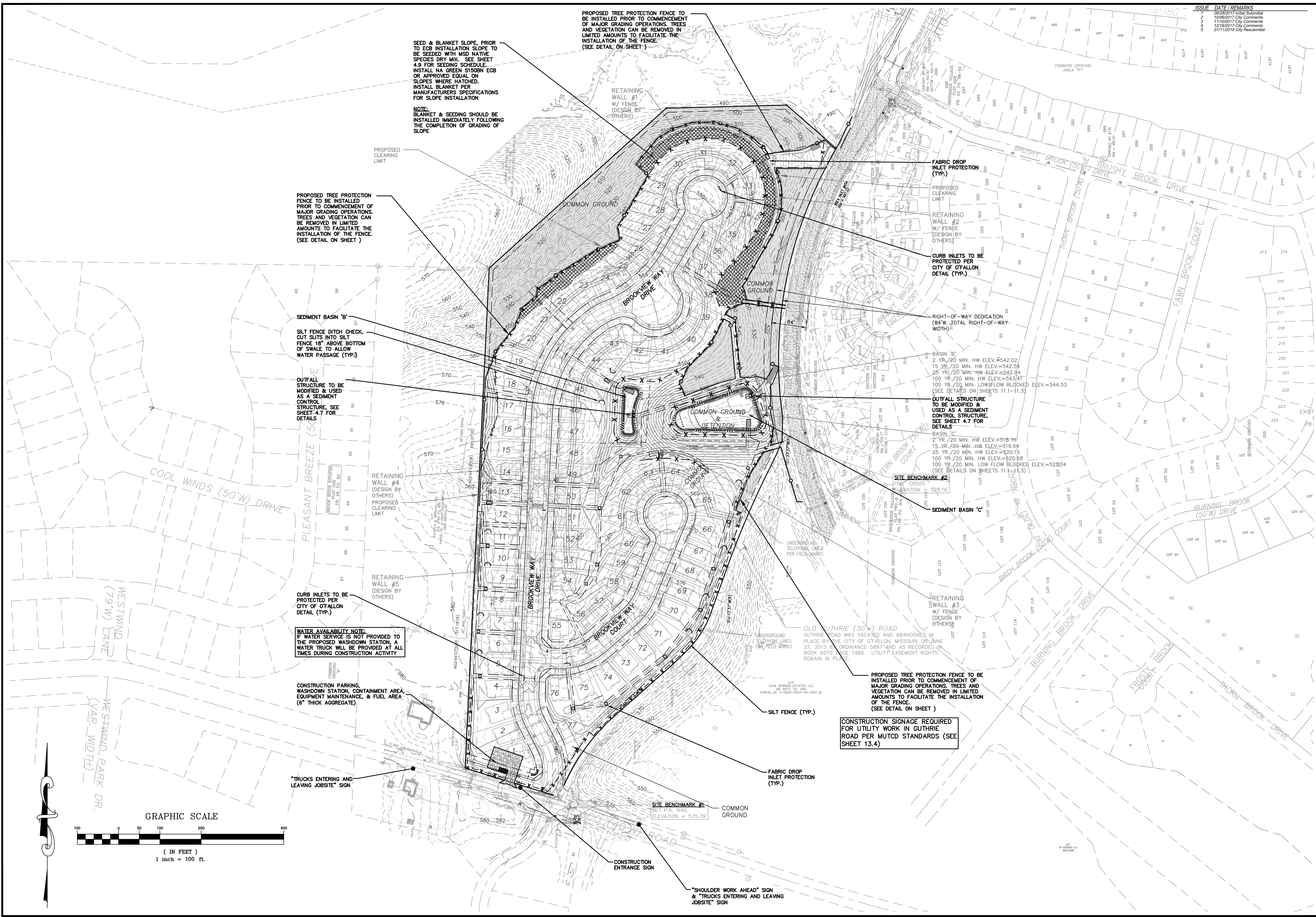

| ISSUE | DATE       | REMARKS           |
|-------|------------|-------------------|
| 1     | 06/28/2017 | Initial Submittal |
| 2     | 10/06/2017 | City Comments     |
| 3     | 11/10/2017 | City Comments     |
| 4     | 12/16/2017 | City Comments     |
| 5     | 01/11/2018 | City Resubmittal  |

SEED & BLANKET SLOPE. PRIOR TO ECB INSTALLATION SLOPE TO BE SEED WITH MSD NATIVE SPECIES DRY MIX. SEE SHEET 4.9 FOR SEEDING SCHEDULE. INSTALL NA GREEN S150BN ECB OR APPROVED EQUAL ON SLOPES WHERE MATCHED. INSTALL BLANKET PER MANUFACTURERS SPECIFICATIONS FOR SLOPE INSTALLATION

NOTE: BLANKET & SEEDING SHOULD BE INSTALLED IMMEDIATELY FOLLOWING THE COMPLETION OF GRADING OF SLOPE

PROPOSED TREE PROTECTION FENCE TO BE INSTALLED PRIOR TO COMMENCEMENT OF MAJOR GRADING OPERATIONS. TREES AND VEGETATION CAN BE REMOVED IN LIMITED AMOUNTS TO FACILITATE THE INSTALLATION OF THE FENCE. (SEE DETAIL ON SHEET )

SEDIMENT BASIN 'B'  
SILT FENCE DITCH CHECK. CUT SLITS INTO SILT FENCE 18" ABOVE BOTTOM OF SWALE TO ALLOW WATER PASSAGE (TYP.)

OUTFALL STRUCTURE TO BE MODIFIED & USED AS A SEDIMENT CONTROL STRUCTURE. SEE SHEET 4.7 FOR DETAILS

WATER AVAILABILITY NOTE: IF WATER SERVICE IS NOT PROVIDED TO THE PROPOSED WASHDOWN STATION, A WATER TRUCK WILL BE PROVIDED AT ALL TIMES DURING CONSTRUCTION ACTIVITY

CONSTRUCTION PARKING, WASHDOWN STATION, CONTAINMENT AREA, EQUIPMENT MAINTENANCE, & FUEL AREA (6" THICK AGGREGATE)

"TRUCKS ENTERING AND LEAVING JOBSITE" SIGN

PROPOSED TREE PROTECTION FENCE TO BE INSTALLED PRIOR TO COMMENCEMENT OF MAJOR GRADING OPERATIONS. TREES AND VEGETATION CAN BE REMOVED IN LIMITED AMOUNTS TO FACILITATE THE INSTALLATION OF THE FENCE. (SEE DETAIL ON SHEET )

FABRIC DROP INLET PROTECTION (TYP.)

PROPOSED CLEARING LIMIT

RETAINING WALL #2 W/ FENCE (DESIGN BY OTHERS)

CURB INLETS TO BE PROTECTED PER CITY OF OFALLON DETAIL (TYP.)

RIGHT-OF-WAY DEDICATION (84' W. TOTAL RIGHT-OF-WAY WIDTH)

BASIN 'B'  
2 YR./20 MIN. HW ELEV.=542.02  
15 YR./20 MIN. HW ELEV.=542.58  
25 YR./20 MIN. HW ELEV.=542.94  
100 YR./20 MIN. HW ELEV.=543.41  
100 YR./20 MIN. LOW FLOW BLOCKED ELEV.=544.53  
(SEE DETAILS ON SHEETS 11.1-11.3)

OUTFALL STRUCTURE TO BE MODIFIED & USED AS A SEDIMENT CONTROL STRUCTURE. SEE SHEET 4.7 FOR DETAILS  
BASIN 'C'  
2 YR./20 MIN. HW ELEV.=518.76  
15 YR./20 MIN. HW ELEV.=519.64  
25 YR./20 MIN. HW ELEV.=520.15  
100 YR./20 MIN. HW ELEV.=520.68  
100 YR./20 MIN. LOW FLOW BLOCKED ELEV.=526.04  
(SEE DETAILS ON SHEETS 11.1-11.3)

RETAINING WALL #3 W/ FENCE (DESIGN BY OTHERS)

SEDIMENT BASIN 'C'

RETAINING WALL #4 (DESIGN BY OTHERS)

PROPOSED CLEARING LIMIT

RETAINING WALL #5 (DESIGN BY OTHERS)

PROPOSED TREE PROTECTION FENCE TO BE INSTALLED PRIOR TO COMMENCEMENT OF MAJOR GRADING OPERATIONS. TREES AND VEGETATION CAN BE REMOVED IN LIMITED AMOUNTS TO FACILITATE THE INSTALLATION OF THE FENCE. (SEE DETAIL ON SHEET )

CONSTRUCTION SIGNAGE REQUIRED FOR UTILITY WORK IN GUTHRIE ROAD PER MUTCD STANDARDS (SEE SHEET 13.4)

SILT FENCE (TYP.)

FABRIC DROP INLET PROTECTION (TYP.)

SITE BENCHMARK #1  
SET IN PK. NAIL  
ELEVATION = 575.79'

CONSTRUCTION ENTRANCE SIGN

"SHOULDER WORK AHEAD" SIGN & "TRUCKS ENTERING AND LEAVING JOBSITE" SIGN

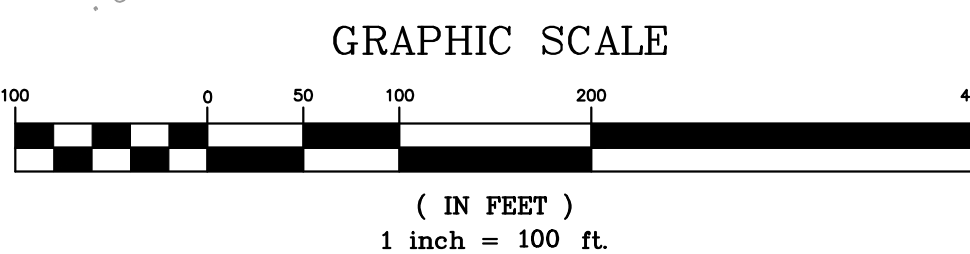

PROJECT TITLE

Brookview

OFALLON, MISSOURI

**THE STERLING CO.**  
ENGINEERS & SURVEYORS  
5055 New Baumgartner Road  
St. Louis, Missouri 63129  
Ph 314-487-0440 Fax 314-487-8944  
www.sterling-eng-sur.com  
Corporate Certificate of Authority #001348



Date: 01/11/18  
SEAN ACKLEY  
LICENSE # PE-2009018679  
Civil Engineer

McBride Guthrie, LLC  
16091 Swingley Ridge Road, Suite 300  
Chesterfield, Missouri 63017  
Ph. (636) 537-2000  
Fax (636) 537-2546

OVERALL SWPPP

P+Z No. 17-005894  
City No. 17-008288  
Date: 01/11/18  
Job No. 17-02-041

Page No.

4.4

IMP