

BRYAN ROAD

A.A.D.T. - 2022 = 16,447

V = 40 M.P.H.

FUNCTIONAL CLASSIFICATION-PRINCIPAL ARTERIAL

FEISE ROAD

A.A.D.T. - 2022 = 6,022

V = 35 M.P.H.

FUNCTIONAL CLASSIFICATION-MAJOR COLLECTOR

NGS BENCHMARK F-149 Elev 542.80 (NAVD88)
LOCATION: CITY OF O'FALLON, MO. APPROXIMATELY
12 MILES WEST OF THE CITY OF ST. CHARLES AND
7.5 MILES EAST OF WENTZVILLE AND IN FRONT OF
THE CITY OF O'FALLON MUNICIPAL CENTER. TO REACH
THE STATION FROM THE INTERSECTION OF THE I-70
BIDWATER PARKWAY AND STATE STREET, GO
NORTH 0.5 MILES ON MAIN STREET TO THE STATION
ON THE RIGHT AT THE SOUTHEAST CENTER OF THE
ENTRANCE TO THE CITY OF O'FALLON MUNICIPAL
BUILDING. THE STATION IS A STANDARD CGS DISK
STAMPED --F 149 1935-- AND SET IN A 4-INCH
SQUARE CONCRETE MONUMENT PROJECTING 3 INCHES
ABOVE THE GROUND. THE STATION IS 78.4 FEET
NORTHWEST OF THE CITY OF O'FALLON MUNICIPAL
BUILDING ENTRANCE SIGN, 61.2 FEET SOUTHWEST
OF A LIGHT STANDARD, AND 25.7 FEET NORTHEAST
OF A LIGHT STANDARD.

	EXISTING	NEW
BUILDINGS AND STRUCTURES		
GUARD RAIL		
GUARD CABLE		
CONCRETE RIGHT-OF-WAY MARKER		
STEEL RIGHT-OF-WAY MARKER		
LOCATION SURVEY MARKER		
UTILITIES		
FIBER OPTICS	- FO -	- FO -
OVERHEAD CABLE TV	- OTV -	- OTV -
UNDERGROUND CABLE TV	- UTV -	- UTV -
OVERHEAD TELEPHONE	- OT -	- OT -
UNDERGROUND TELEPHONE	- UT -	- UT -
OVERHEAD POWER	- OE -	- OE -
UNDERGROUND POWER	- UE -	- UE -
SANITARY SEWER	- S -	- S -
STORM SEWER	- SS -	- SS -
GAS	- G -	- G -
WATER	- W -	- W -
MANHOLE		
FIRE HYDRANT		
WATER VALVE		
WATER METER		
DROP INLET		
DITCH BLOCK		
GROUND MOUNTED SIGN		
LIGHT POLE		
H-FRAME POWER POLE		
TELEPHONE PEDESTAL		
FENCE		
CHAIN LINK		
WOVEN WIRE		
GATE POST		
BENCHMARK		

NOTE: DASHED OR OPEN SYMBOLS INDICATE EXISTING FEATURES

KEY MAP
LOCATION OF
ST. CHARLES COUNTY

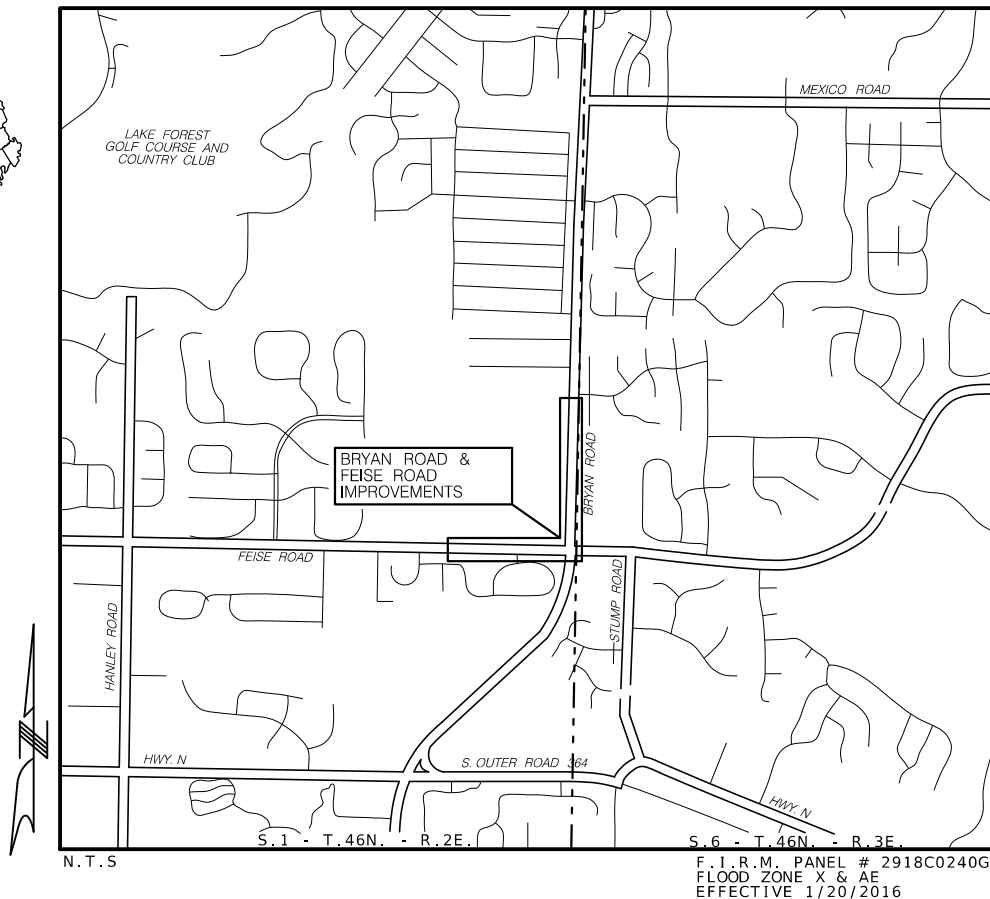

REMOVED AND REPLACED	(RR)	PROFILE GRADE LINE	PGL	DRIVE	DR.
REMOVE	(R)	GATE POST	GP	RADIUS	R. OR RAD.
TO BE ABANDONED	(TBA)	POWER POLE	PP	PERMANENT	PERM.
USE IN PLACE	(UIP)	RIGHT OF WAY	R/W OR ROW	MODULAR BLOCK RETAINING WALL	MBRW
DO NOT DISTURB	(DND)	CONCRETE	CONC.	SHOULDER	SHLDR.
TO BE REM'D AND RELOCATED	(TBRR)	SIDEWALK	SDWK.	PAVEMENT	PVMT.
(BY CONTRACTOR)		ASPHALT	ASPH.	MANHOLE	MH
ADJUST TO GRADE	(ATG)	EACH	EA.	BITUMINOUS	BIT.
TO BE REM'D AND REPLACED	(TBRBO)	TELEPHONE MANHOLE	TMH.	TYPICAL	TYP.
BY OTHERS		GAS VALVE	GV	NOT TO SCALE	N.T.S.
TO BE ABANDONED AND FILLED	(ATCBO)	WATER VALVE	WM	TEMPORARY	TEMP.
ADJUST TO GRADE BY OTHERS	(F-F)	WATER METER	BOP	EASEMENT	ESMT.
FACE TO FACE	(F-B)	BEGINNING OF PROJECT	EOP	PAGE	PG.
FACE TO BASELINE	(F-C)	END OF PROJECT	EOP	VERTICAL POINT OF INTERSECTION	VPI
FACE TO CENTERLINE	(C-C)	EDGE OF PAVEMENT	EXST. OR EXIST.	VERTICAL POINT OF CURVATURE	VPC
CENTER TO CENTER	BDLG.	EXISTING	PRPS. OR PROP.	VERTICAL POINT OF TANGENCY	VPT
BUILDING	FOC	PROPOSED	BK.	STATION	STA.
FACE OF CURB	MIN.	BACK	AHD.	TEMPORARY CONSTRUCTION EASEMENT	T.C.E.
MINIMUM	ENTR.	AHEAD	BOC	PROPOSED SIDEWALK UTILITY EASEMENT	P.S.U.E.
ENTRANCE	SE	BACK OF CURB	ELEV. OR EL.	PERMANENT WALL EASEMENT	P.W.E.
SUPERELEVATION RATE	MSE	ELEVATION	RD.	PERMANENT DRAINAGE EASEMENT	P.D.E.
MAX. SUPERELEVATION RATE		ROAD			

DISCLAIMER:
THE PROFESSIONAL WHOSE SIGNATURE AND PERSONAL SEAL APPEAR HEREON ASSUMES RESPONSIBILITY ONLY FOR WHAT APPEARS ON THIS PAGE, AND DISCLAIMS PURSUANT TO SECTION 327.411 RSMO) SPECIFICATION, ESTIMATES, REPORTS OR OTHER DOCUMENTS OR INSTRUMENTS NOT SEALED BY THE UNDERSIGNED PROFESSIONAL RELATING TO OR INTENDED TO BE USED FOR ANY PART OR PARTS OF THE PROJECT TO WHICH THIS PAGE REFERS.
THE EXISTENCE AND APPROXIMATE LOCATION OF UTILITY FACILITIES KNOWN TO EXIST, AS SHOWN ON THE PLANS, ARE BASED ON THE BEST INFORMATION AVAILABLE TO THE COMMISSION AT THIS TIME. THIS INFORMATION IS PROVIDED BY THE COMMISSION "AS-IS" AND THE COMMISSION EXPRESSLY DISCLAIMS ANY REPRESENTATION OR WARRANTY AS TO THE COMPLETENESS, ACCURACY, OR SUITABILITY OF THE INFORMATION FOR ANY USE. RELIANCE UPON THIS INFORMATION IS DONE AT THE RISK AND PERIL OF THE USER, AND THE COMMISSION SHALL NOT BE LIABLE FOR ANY DAMAGES THAT MAY ARISE FROM ANY ERROR IN THE INFORMATION. IT IS, THEREFORE, THE RESPONSIBILITY OF THE CONTRACTOR TO VERIFY THE EXISTENCE, LOCATION AND STATUS OF ANY FACILITY. SUCH VERIFICATION INCLUDES DIRECT CONTACT WITH THE LISTED UTILITIES.

DESCRIPTION	SHEET NUMBER
TITLE SHEET -----	1
GENERAL NOTES (2 SHEETS)-----	1A
TYPICAL SECTIONS (TS) (2 SHEETS)---	2
QUANTITIES (QU) (5 SHEETS)-----	3
PLAN (PN)(5 SHEETS)-----	4-8
PROFILE (PR)(8 SHEETS)-----	9-16
COORDINATE/REFERENCE POINTS (CP)---	17
SIGNAL PLAN (SG)-----	18-28
PAVEMENT MARKINGS & SIGNAGE (PM)---	29-34
WARPING SHEETS (WP) -----	35-36
PAVEMENT JOINTING (PJ) -----	37-38
STORM SEWERS (SS)(2 SHEETS)-----	39-40
TRAFFIC CONTROL SHEETS (TC)-----	41-42
CROSS SECTIONS (XS)-----	XS1-XS15
RIGHT OF WAY (RW)-----	RW1-RW2

APPROVED
Jeannie Greenlee 04/22/2024

BY: _____ DATE: _____
PROFESSIONAL ENGINEER'S SEAL
INDICATES RESPONSIBILITY FOR DESIGN

BRYAN ROAD		
BEGINNING OF PROJECT	107+76.60	
END OF PROJECT	119+61.33	
APPARENT LENGTH	1184.73	FEET
EQUATIONS AND EXCEPTIONS:	0.00	FEET
FEISE ROAD		
BEGINNING OF PROJECT	45+27.30	
END OF PROJECT	52+95.56	
APPARENT LENGTH	768.26	FEET
EQUATIONS AND EXCEPTIONS:	0.00	FEET
TOTAL CORRECTIONS	0.00	FEET
NET LENGTH OF PROJECT	1952.99	FEET
STATE LENGTH	0.370	MILES
FOR INFORMATION ONLY		
ESTIMATED DISTURBED ACRES	1.57	ACRES

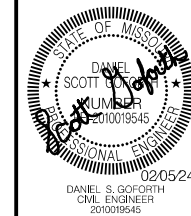

DATE PREPARED	
02/05/2024	
ROUTE	STATE
.	MO
DISTRICT	SHEET NO.
STL	1
COUNTY	
ST. CHARLES	
JOB NO.	
.	
CONTRACT ID.	
.	
PROJECT NO.	
1201400	
BRIDGE NO.	

[illegible]

KALECO, LLC
7 BAXTER LANE
CHESTERFIELD, MO 63017
(217-370-7623)

VOLKERT
 CERTIFICATE OF AUTHORITY
 NO. F00391502
 401 S. 18TH STREET
 SUITE 250
 ST. LOUIS, MO 63103

BYRAN ROAD & FEISE
ROAD IMPROVEMENTS

TITLE SHEET