

SITE PLAN - ELECTRICAL

SCALE: 1" = 20'-0"

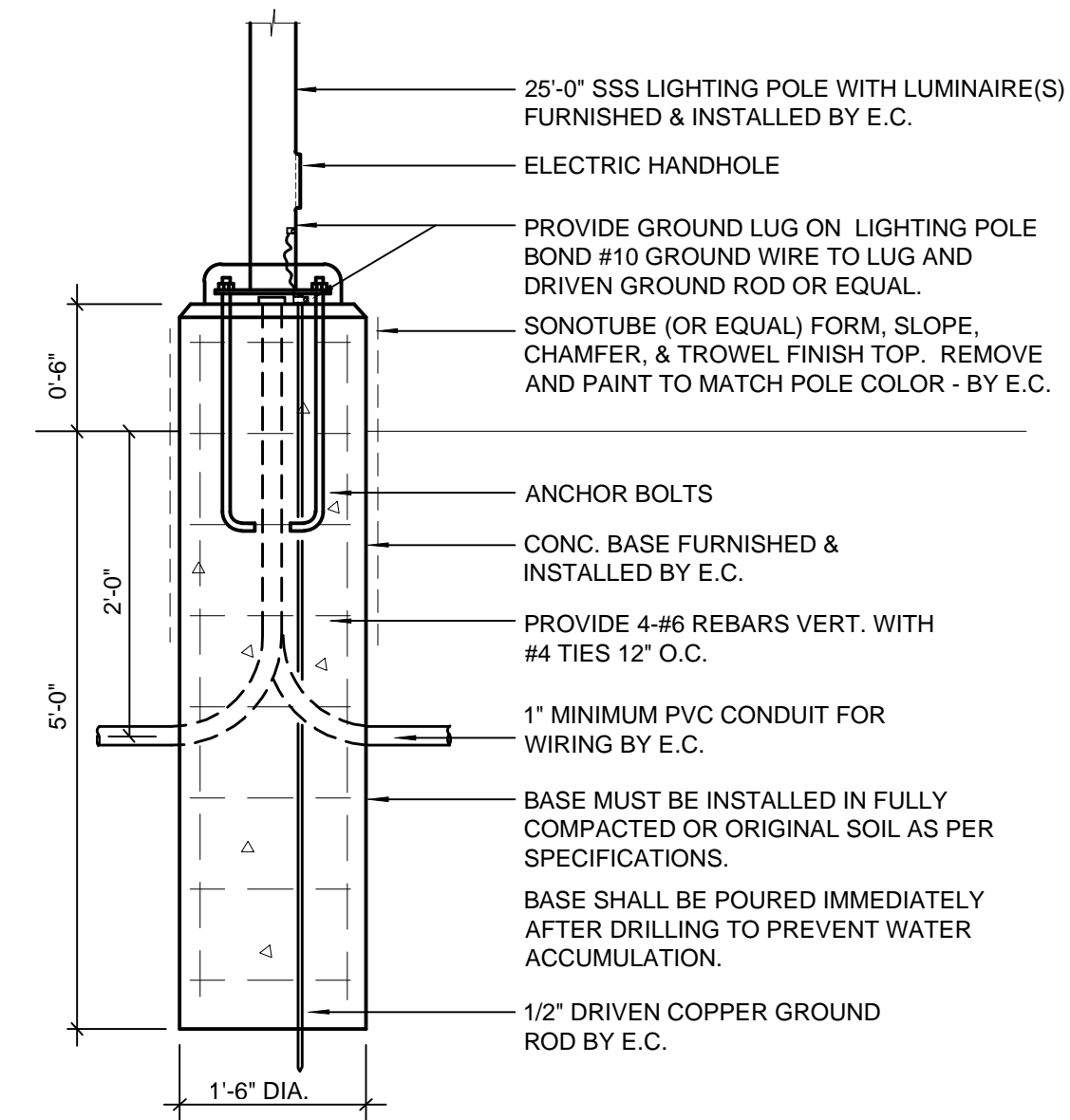

1 LIGHT STANDARD DETAIL
NO SCALE

PLAN NOTES - SITE ELECTRICAL

1. PROPOSED C/T CABINET AND METER BASE. COORDINATE WITH AMEREN AND OWNER PRIOR TO START OF CONSTRUCTION.
2. SERVICE FEEDER, SEE RISER DIAGRAM DETAIL 1/E1.0.
3. PROPOSED AMEREN TRANSFORMER AND PAD PER AMEREN STANDARDS. COORDINATE CONNECTION TO 120/240V-1PH-3W SERVICE WITH AMEREN PRIOR TO START OF CONSTRUCTION.
4. STUB-UP 2" SCHEDULE 40 PVC. CONDUIT FOR COMMUNICATIONS SERVICE.
5. TERMINATE COMMUNICATIONS CONDUIT AT SERVICE POINT. VERIFY WITH OWNERS PROVIDER.
6. (2) 3" SCHEDULE 40 PVC PRIMARY CONDUITS PER AMEREN STANDARDS AND SPECIFICATIONS.

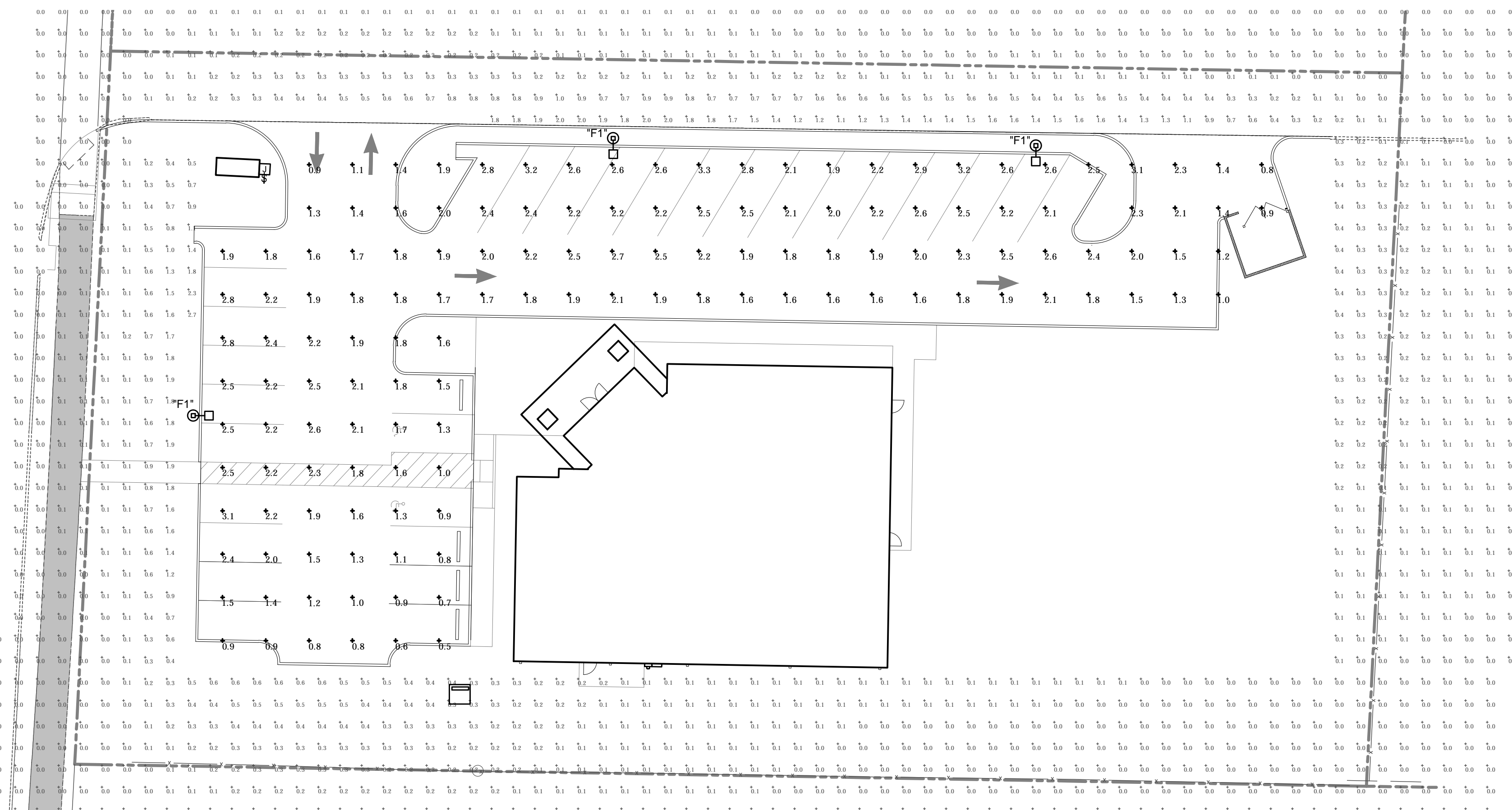

SITE PLAN - LIGHTING PHOTOMETRIC

SCALE: 1" = 20'-0"

FIXTURES MOUNTED ON 25' POLE
LIGHT LEVEL CALCULATED ON THE GROUND

Luminaire Schedule

Symbol	Qty	Label	Arrangement	Lum. Watts	Total Watts	LLF	Description - Lumark #
⊙	3	F1	SINGLE	163	489	0.912	PRV-A60-D-UNV-T4-BZ-HSS

Calculation Summary

Label	Calc Type	Units	Avg	Max	Min	Avg/Min	Max/Min
SITE	Illuminance	Fc	1.91	3.3	0.5	3.82	6.60
SPILL LIGHT	Illuminance	Fc	0.15	2.7	0.0	N.A.	N.A.

RESULTS ARE BASED ON CURRENT INFORMATION PROVIDED AT THE TIME OF REQUEST. ANY CHANGES IN FIXTURE HEIGHT OR LOCATION, LAMP WATTAGE, LAMP TYPE, AND EXISTING FIELD CONDITIONS, WILL AFFECT THE RESULTS. THESE RESULTS WILL HOLD CURRENT LAYOUT AND REQUIRE A CHANGE REQUEST AND RECALCULATION.

This electronic drawing file is released under the authority of KEVIN S. GRIESEMER, Missouri License # PE-23628, who maintains the original file and whose registration expires on December 31, 2019. This electronic drawing file may be used as a background drawing. Pursuant to State of Missouri Regulations of the Missouri Board of Architects, Professional Engineers, Professional Land Surveyors, and Landscape Architects, the user of this electronic drawing file agrees to assume all responsibility for any modification to or use of this drawing file that is inconsistent with the requirements of the Rules and Regulations of the Missouri Code of State Regulations Title 4, Division 30. No person may make any modifications to this electronic drawing file without the engineers' express written permission.

© 2018 G&W Engineering Corp.



Electrical Documents For:
Bryan Road Animal Hospital
 ## Bryan Road
 O'Fallon, Missouri 63366

 Kevin S. Griesemer - Engineer
 MO# PE-23628
 Expiration Date: Dec. 31, 2019

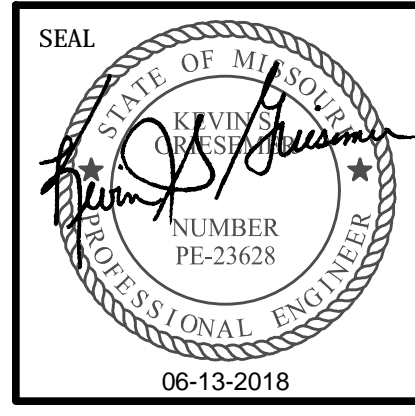

REVISIONS	
ISSUED FOR PERMIT	05-23-18
JOB NO:	2018-0266.00
DRAWN BY:	T.F.D./M.P.W.
CHECKED BY:	K.S.G.
DATE:	05-23-18
SHEET NO.	

E4.0

SITE PLAN - LIGHTING