

PAVEMENT MARKING NOTES

1. ALL PAVEMENT MARKING SHALL FOLLOW ST. LOUIS COUNTY STANDARD DRAWING C902.10 GUIDELINES FOR PAVEMENT MARKING AND LANE STRIPING UNLESS OTHERWISE NOTED.

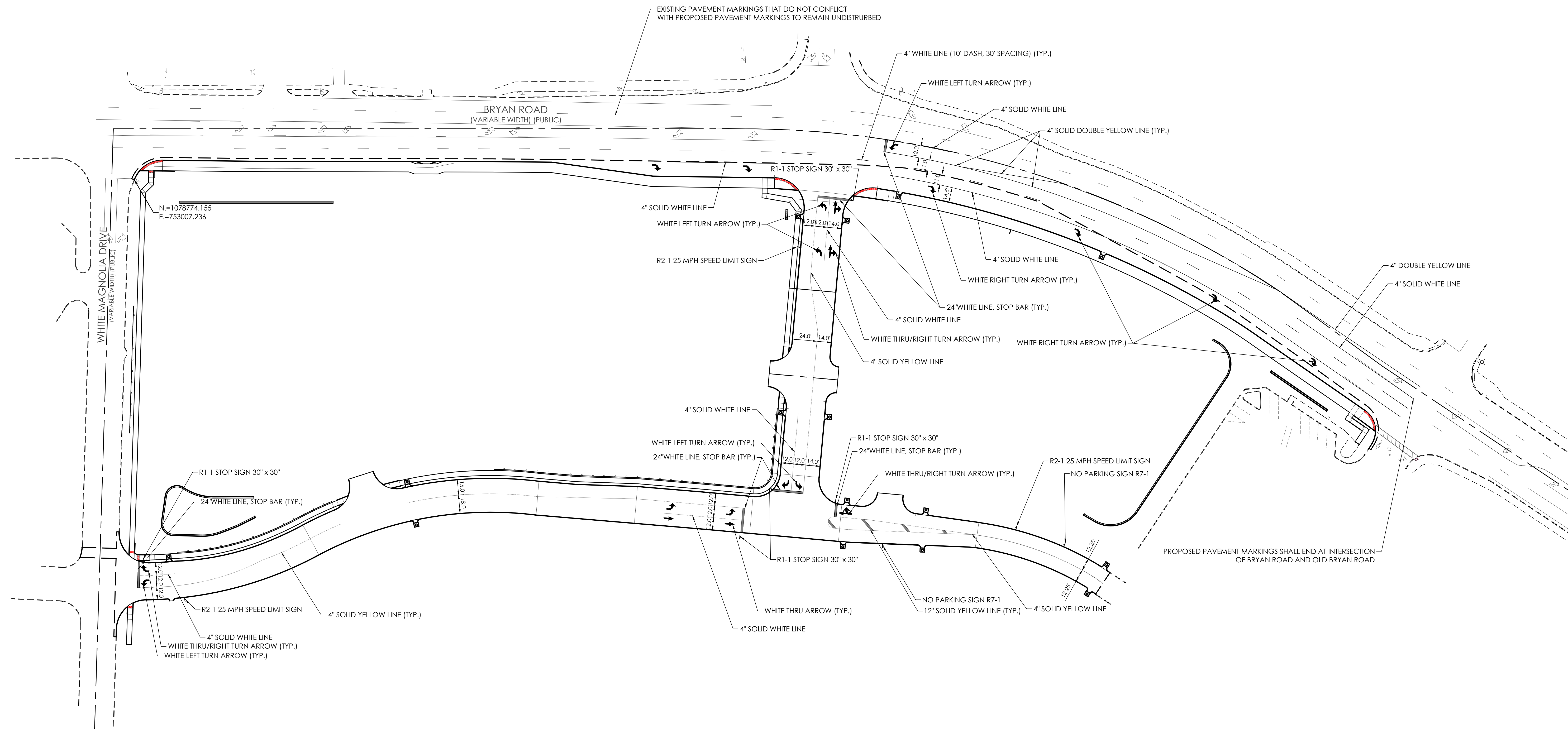

**ENGINEERS AUTHENTICATION**  
The responsibility for professional engineering liability on this project is hereby limited to the set of plans authorized by the seal, signature, and date hereunder attached. Responsibility is disclaimed for all other engineering plans involved in this project and specifically excludes revisions after the date stated hereunder.  
STEVEN D. MARKON P.E.  
PROFESSIONAL ENGINEER  
PE 2200007195



**NOLES PROPERTIES LLC**  
BRYAN ROAD COMMERCIAL DEVELOPMENT  
TBD BRYAN ROAD  
OFALLON, MO 63376  
NOLES PROPERTIES LLC  
11361 OLIVE BLVD  
CREVE COEUR, MO 63141

Project: Bryan Road Commercial Development  
Date: 5/2/2023

#	Revision Date	Description of Changes
1	6/26/2023	REVISED PER CITY OF OFALLON AND OFALLON FIRE COMMENTS
2	7/17/2023	REVISED PER CITY OF OFALLON COMMENTS
3	7/17/2023	REVISED PER CITY OF OFALLON COMMENTS

Sheet Title: **STRIPING AND SIGNAGE PLAN**  
Sheet Number: **C-207**  
Project No.: 2202920  
Drawn By: P. HEITZ  
Checked By: M. FOGARTY  
ISSUED FOR CONSTRUCTION

V:\work\p\1000\CIVIL 3D PROJECTS\2022\2202920\_Noles\_Bryan Rd Commercial Development\CONSTRUCTION DRAWINGS\SHEETS\C-207 PAVEMENT MARKING PLAN.dwg



**UNDERGROUND UTILITIES AND OSHA SAFETY NOTE:**  
Underground utilities and structures have been plotted from available information and therefore, their location must be considered approximate only. It is the responsibility of the individual contractors to notify the utility companies before actual construction. All O.S.H.A. rules and regulations established for the type of construction required by these plans shall be strictly followed (i.e. trenching, blasting, etc.)

