

CITY OF FALLON STORM AND SANITARY STRUCTURE ADJUST TO GRADE NOTES:

- SANITARY AND STORM SEWER STRUCTURES SHALL NOT BE RAISED WITH BRICKS AND GROUT.
- CONTRACTOR SHALL CONFIRM FIELD VERIFY STRUCTURE SHAPE, SIZE AND APPURTENANCES AND COORDINATE WITH THE CITY OF FALLON INSPECTOR PRIOR TO WORK TO DETERMINE THE PROPER METHODOLOGY AND RECOMMENDATIONS THAT WILL ALLOW RAISING THE STRUCTURE TOP TO THE PROPOSED GRADE.

UTILITY PLAN SCHEDULE

CODE	DESCRIPTION	DETAIL
U-101	PROPOSED LIGHT STANDARD. GENERAL CONTRACTOR SHALL DESIGN BUILD ELECTRICAL COMPONENTS FOR SITE LIGHTING AND COORDINATE WITH AMEREN UE FOR TRANSFORMER, CONDUIT AND WIRING TO LIGHTING. LIGHTING AND ALL ASSOCIATED APPURTENANCES SHALL BE INCLUDED IN THE BID.	
U-102	PROPOSED LAND DISTURBANCE LIMITS (TYP.)	
U-103	PROPOSED 2" GAS MAIN. G.C. SHALL INCLUDE IN BID COST TO EXTEND GAS MAIN AND CAP FOR FUTURE CONNECTIONS. COORDINATE ALL WORK WITH GAS COMPANY PRIOR TO INSTALLATION.	
U-104	POINT OF CONNECTION FOR WATER MAIN EXTENSION. CONNECT AT EXISTING WATER VALVE AND REMOVE CAP AND OR PLUG FOR 12" WATER MAIN EXTENSION. EXISTING VALVE SHALL BE ADJUST TO GRADE.	
U-105	EXISTING FIBER OPTIC VAULT. G.C. TO INCLUDE COST TO RAISE EXISTING VAULT AND COORDINATE WITH FIBER COMPANY.	
U-106	EXISTING FIBER OPTIC VAULT TO BE REMOVED AND REPLACED WITH HS-20 RATED VAULT PER FIBER COMPANY SPECIFICATIONS.	
U-108	NO WORK SHALL OCCUR ON STARBUCKS PROPERTY UNTIL AFTER AUTHORIZATION BY PROPERTY OWNER HAS BEEN OBTAINED AND OFFSITE EASEMENTS ARE IN PLACE.	
U-109	"CAUTION" EXISTING FIBER OPTIC LINES. PROTECT EXISTING FIBER OPTIC LINES. DEPTHS ARE FROM 4 FOOT TO 5 FOOT AT THE NORTHERN END TO 1 FOOT TO 2 FOOT AT THE SOUTHERN END OF THE PROPERTY. G.C. SHALL POITHOLE AND CONFIRM DEPTHS OF UTILITIES IN THE BRYAN ROAD CORRIDOR.	
U-110	"CAUTION" EXISTING UNDERGROUND ELECTRIC AND FIBER OPTIC LINES. DEPTHS ARE UNKNOWN. VERIFY PRIOR TO CONSTRUCTION OF ENTRANCE.	
U-111	PROPOSED ENTRANCE AND TURN LANE. REFER TO TYPICAL SECTION AND WARPING DETAIL.	
U-112	PROPOSED ENTRANCE AND WALK. REFER TO DETAIL FOR ELEVATIONS.	
U-113	PROPOSED MDOOT TYPE 4 RIP-RAP.	
U-114	PROPOSED UNDERGROUND ELECTRIC BY AMEREN UE. GENERAL CONTRACTOR SHALL COORDINATE WITH AMEREN UE FOR ELECTRIC SERVICES.	
U-115	PROPOSED SWITCHGEAR CONFIRM LOCATION WITH AMEREN UE.	
U-116	EXISTING 4 IN CONDUITS. COORDINATE WITH AMEREN UE.	
U-117	PROPOSED POINT OF CONNECTION TO EXISTING WATER MAIN. TRAFFIC CONTROL SHALL BE PROVIDED WITH PLATES. FULL SLAB REPLACEMENT SHALL BE REQUIRED.	
U-118	PROPOSED 2 X 5 MDOOT TYPE 2 RIP RAP.	
U-119	PROPOSED 48" TALL ADA COMPLIANT RAIL. REFER TO DETAIL.	
U-120	PROPOSED INSERT-A-TEE VALVE PER CITY OF FALLON SPECIFICATIONS.	



ENGINEERS AUTHENTICATION
 The responsibility for all civil engineering actions on this project is hereby limited to the set of plans authorized by the seal, signature, and date hereunder attached. Responsibility is disclaimed for all other engineering plans involved in this project and specifically excludes revisions after the date shown hereunder.
STEVEN M. LARSON P.E.
 PROFESSIONAL ENGINEER
 PE 220007195

NOLES PROPERTIES LLC
 BRYAN ROAD COMMERCIAL DEVELOPMENT
 TBD BRYAN ROAD
 FALLON, MO 63376
NOLES PROPERTIES LLC
 11361 OLIVE BLVD
 CREVE COEUR, MO 63141

Date: 5/2/2023

#	Revision Date	Description of Changes
1	6/26/2023	REVISED PER CITY OF FALLON AND OF FALLON FIRE COMMENTS
2	7/17/2023	REVISED PER CITY OF FALLON COMMENTS
3	7/17/2023	REVISED PER CITY OF FALLON COMMENTS

Sheet No. **C-400**
 Project No. 2202920
 Drawn By P. HEITZ
 Checked By M. FOGARTY
 ISSUED FOR CONSTRUCTION



UNDERGROUND UTILITIES AND OSHA SAFETY NOTE:
 Underground utilities and structures have been plotted from available information and therefore, their location must be considered approximate only. It is the responsibility of the individual contractors to notify the utility companies before actual construction. All O.S.H.A. rules and regulations established for the type of construction required by these plans shall be strictly followed (ie. trenching, shoring, etc.)

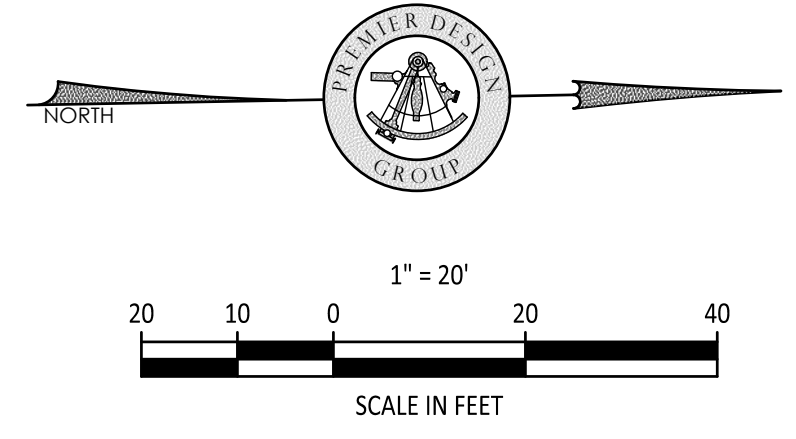

GRADING AND UTILITY PLAN NORTH