

**Table 6.3 Temporary Seeding Plant Materials and Minimum Seeding Rate\***

Species	Seeding Rate		Plant Characteristics
	lbs. per acre	lbs. per 1,000 ft.2	
Oats	80	2	Not cold tolerant, height up to 2 feet
Cereals: Rye/Wheat	90/120	2/2.5	Cold tolerant, height up to 3 feet, low pH tolerant
Millet, Sudangrass	45 / 60	1/1.25	Warm season annual, aggressive growth height up to 5 feet
Annual Ryegrass	75	2	May be added to mix, not heat tolerant, height up to 16 inches
Annual Lespedeza** plus Tall Fescue	15 plus 45	0.5 plus 1	Warm season annual legume, makes own nitrogen, tolerated low pH

\* In Areas receiving less than 30 inches of precipitation, use 75 percent of these rates.  
 \*\* If there is any possibility the seeding will be required to control erosion for more than one year, then consider the addition of fescue or another permanent species as part of a mixture when seeding.

**Table 6.4 Seeding Dates for Temporary Seeding**

Species	Seeding Dates Optimum and Acceptable											
	Jan	Feb	Mar	Apr	May	Jun	Jul	Aug	Sep	Oct	Nov	Dec
Oats												
Cereals: Rye/Wheat												
Millet, Sudangrass												
Annual Ryegrass												
Annual Lespedeza** plus Tall Fescue												

\* If site may not be developed within one year, consider permanent species listed in Table 6.5.

Table Key  
 Optimum Seeding Times  
 Acceptable Seeding Times

**Table 6.5 Planting Dates Optimum and Acceptable\* Planting Dates**

Species	Seeding Dates Optimum and Acceptable											
	Jan	Feb	Mar	Apr	May	Jun	Jul	Aug	Sep	Oct	Nov	Dec
Turf Fescue												
Tall Fescue												
Kentucky Bluegrass												
Perennial Ryegrass												
Ryeloop												
Reed Canary												
Bermuda - Common												
Bermuda - Hybrid												
Buffalograss1												
Zoysia2												
Birdsfoot Trefoil												
Common Lespedeza												
Red Clover												
White Clover												
Wheat/Rye3												
Oats 3,4												

1 Can also be sprigged.  
 2 Usually sprigged. Space plugs every 6.8 or 12 inches with 4,000, 2,250 or 1,000 sprigs/1,000 sq. ft. respectively  
 3 Check with your local Noxious Weed Department before planting  
 4 Nurse crop only.

Table Key  
 Optimum Seeding Times  
 \*With Mulch Cover Acceptable Seeding Times

**Table 6.8 Seeding Rates**

Species	Missouri: Full Seeding Rate1	
	lbs./acre	(PLS)2
<b>Cool Season Grasses</b>		
Perennial Ryegrass	150	
Canada wildrye	24	
Tall Fescue	150	
Crested Wheatgrass	16	
Kentucky Bluegrass	120	
Bromegrass	100	
Redtop	8	
Reed Canary	40	
Common Bermuda	4	
<b>Warm Season Grasses</b>		
Hybrid Bermuda	-	
Buffalograss	8 (grain)	
Blue grama	6	
Zoysia	-	
Sideoats grama	15	
Little bluestem	13	
Big bluestem	16	
Indiangrass	16	
Switchgrass	9	
<b>Legumes3</b>		
Birdsfoot trefoil	10	
Annual lespedeza	16	
Red clover	12	
White clover	4	
Alfalfa	9	
<b>Companion Crops</b>		
Wheat	1 bu./acre	
Rye (cereal)	1 bu./acre	
Oats	1.5 bu./acre	

1. Note: Rates based on typical construction site conditions where seedbed is normally less than ideal. Planned future use or specific site conditions may dictate an increase or decrease in rates.  
 2. PLS or Pure Live Seed = the amount of seed guaranteed to grow.  
 3. Legumes alone will not provide adequate erosion protection: use with a grass in a mixture.

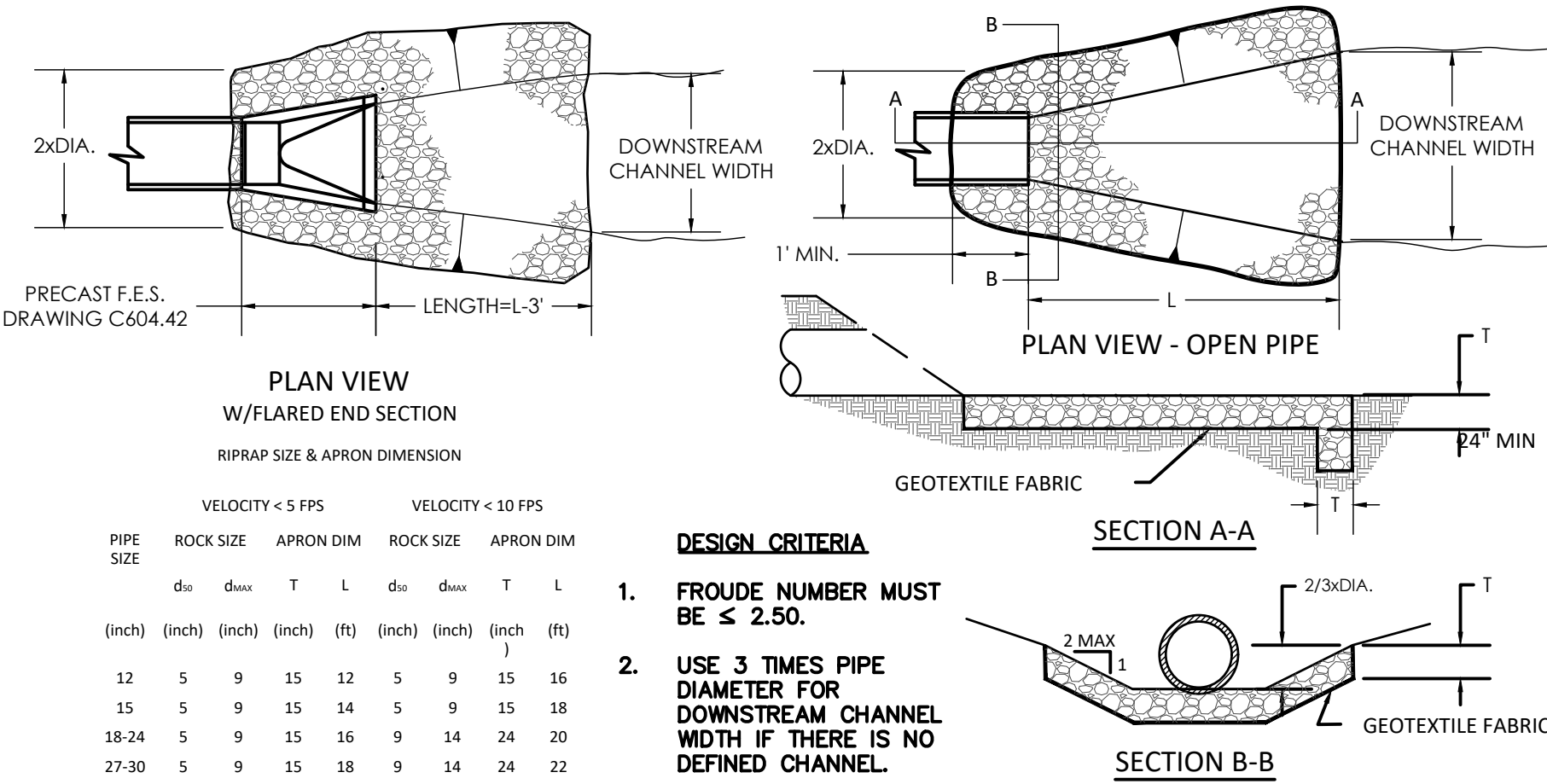

St. Charles County  
 Erosion & Sediment Controls  
 Standard Drawings

**TEMPORARY OUTLET  
 PIPE DISCHARGE  
 PROTECTION**

DATE: MARCH 2008 DRAWING: ESC-26

**6 TEMPORARY OUTLET PIPE DISCHARGE PROTECTION**

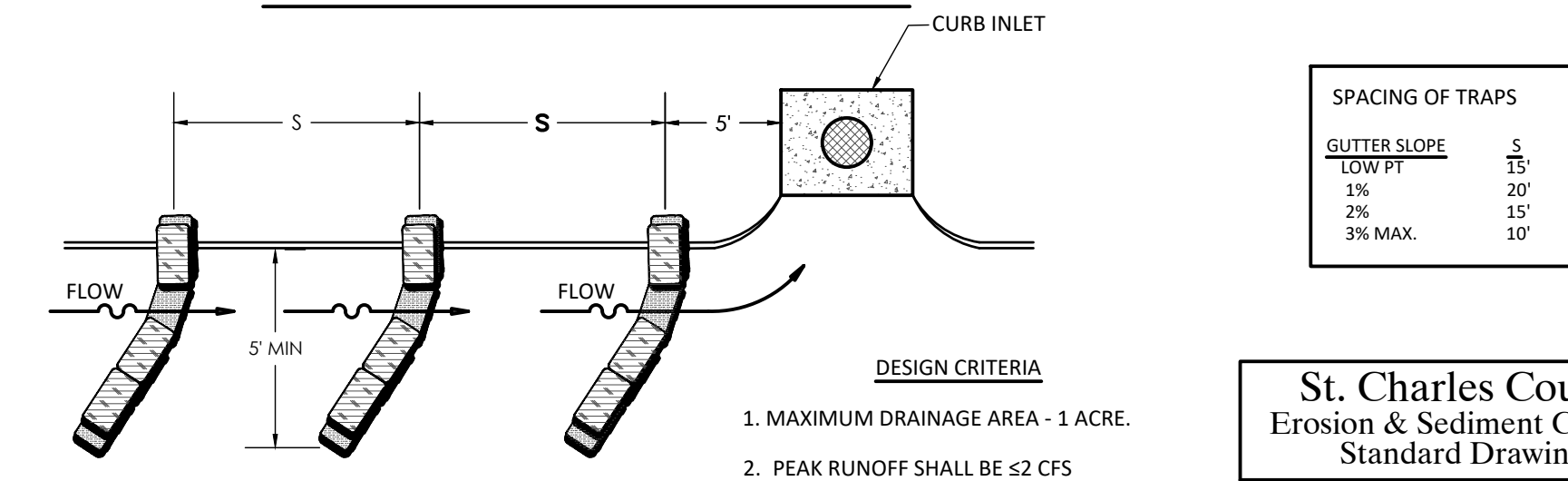
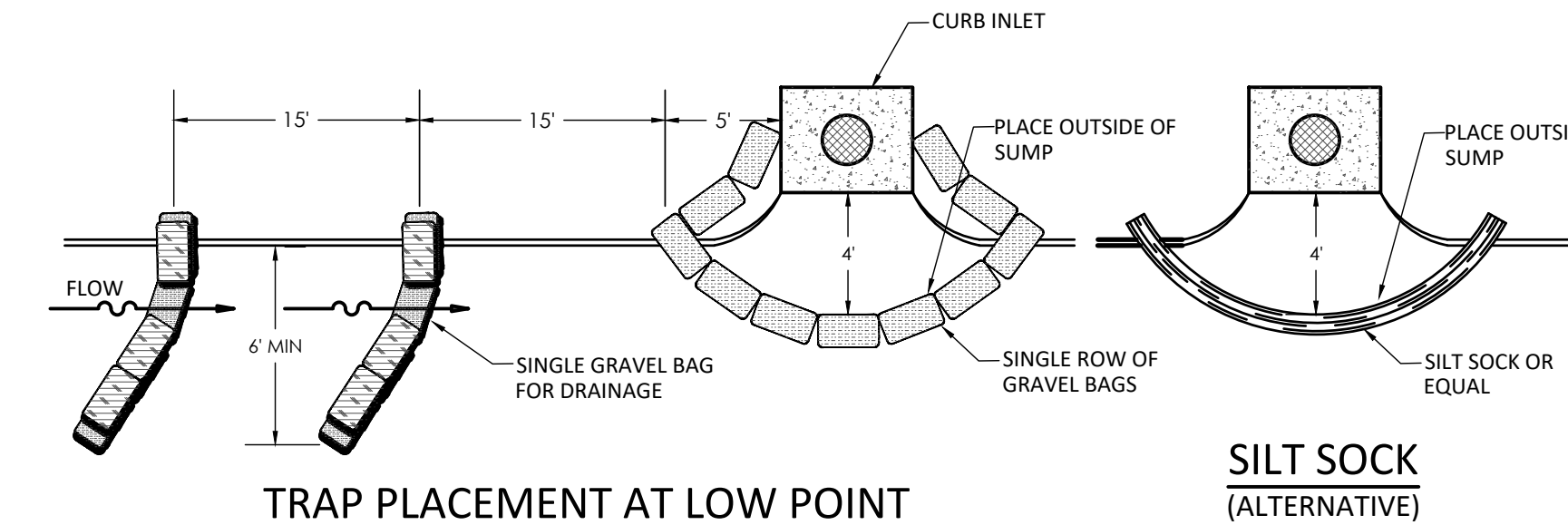

St. Charles County  
 Erosion & Sediment Controls  
 Standard Drawings

**CURB INLET  
 PROTECTION**

DATE: MARCH 2008 DRAWING: ESC-17

**5 CURB INLET PROTECTION**

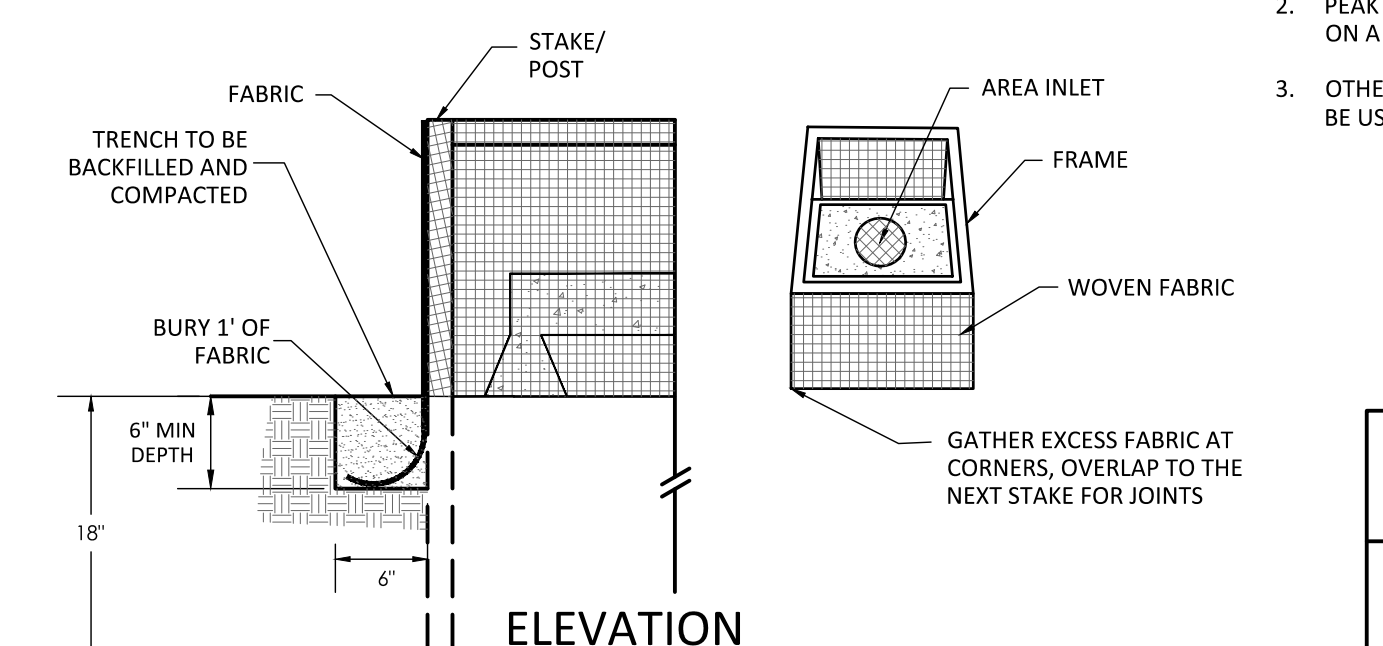
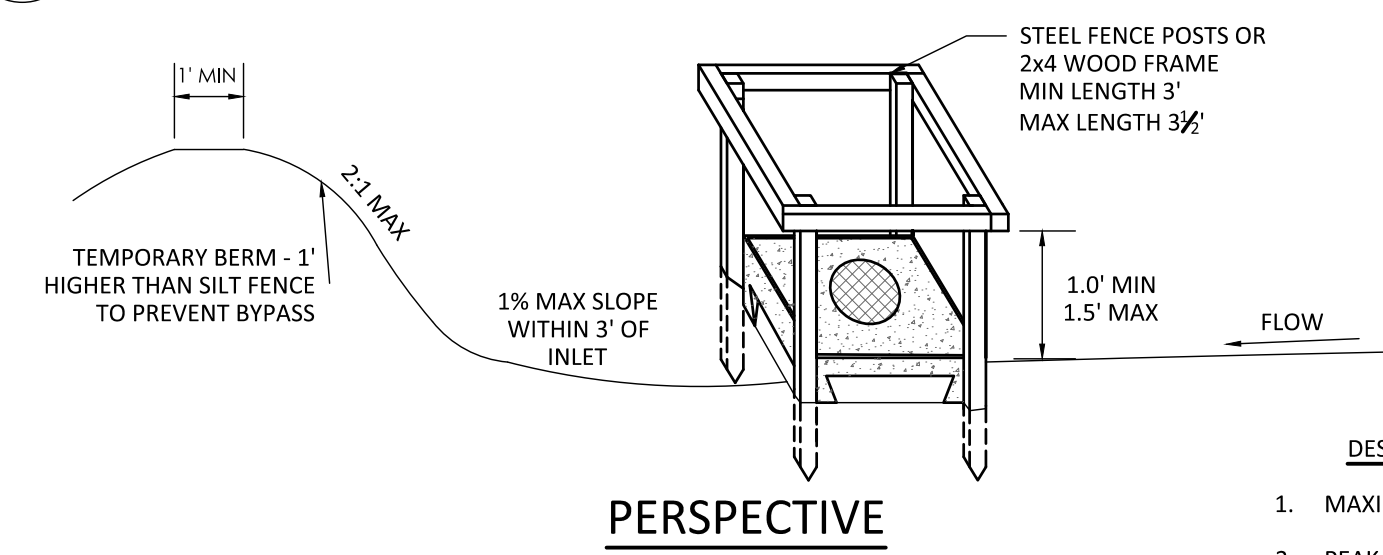

St. Charles County  
 Erosion & Sediment Controls  
 Standard Drawings

**AREA INLET  
 PROTECTION  
 FABRIC DROP**

DATE: MARCH 2008 DRAWING: ESC-14

**4 AREA INLET PROTECTION FABRIC DROP**

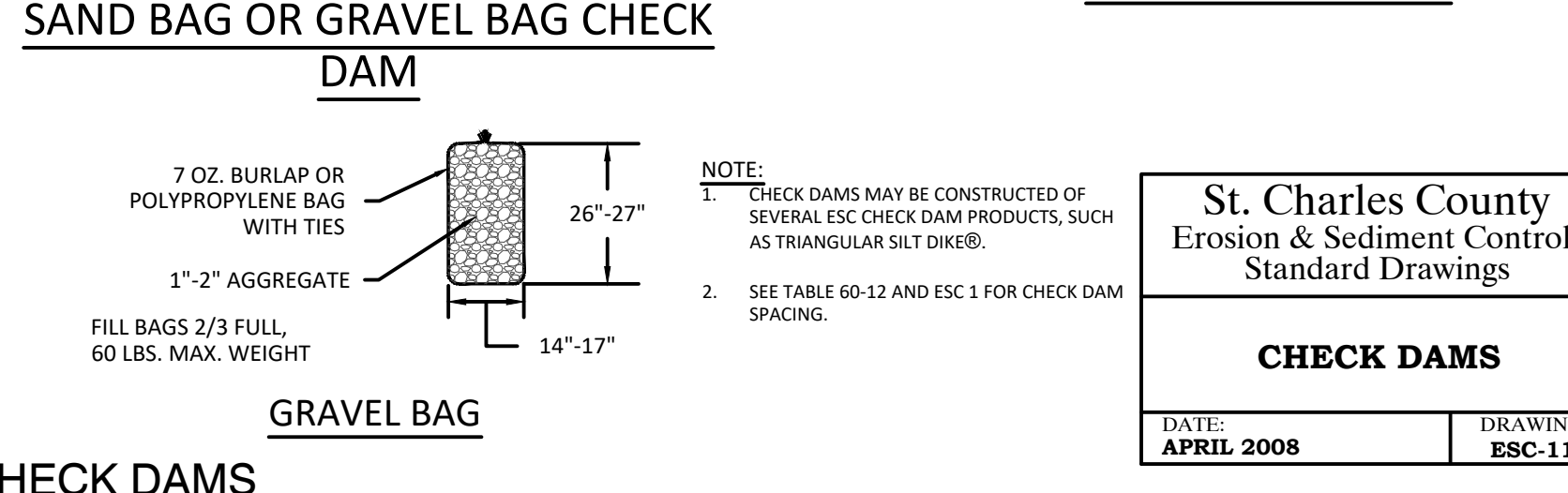
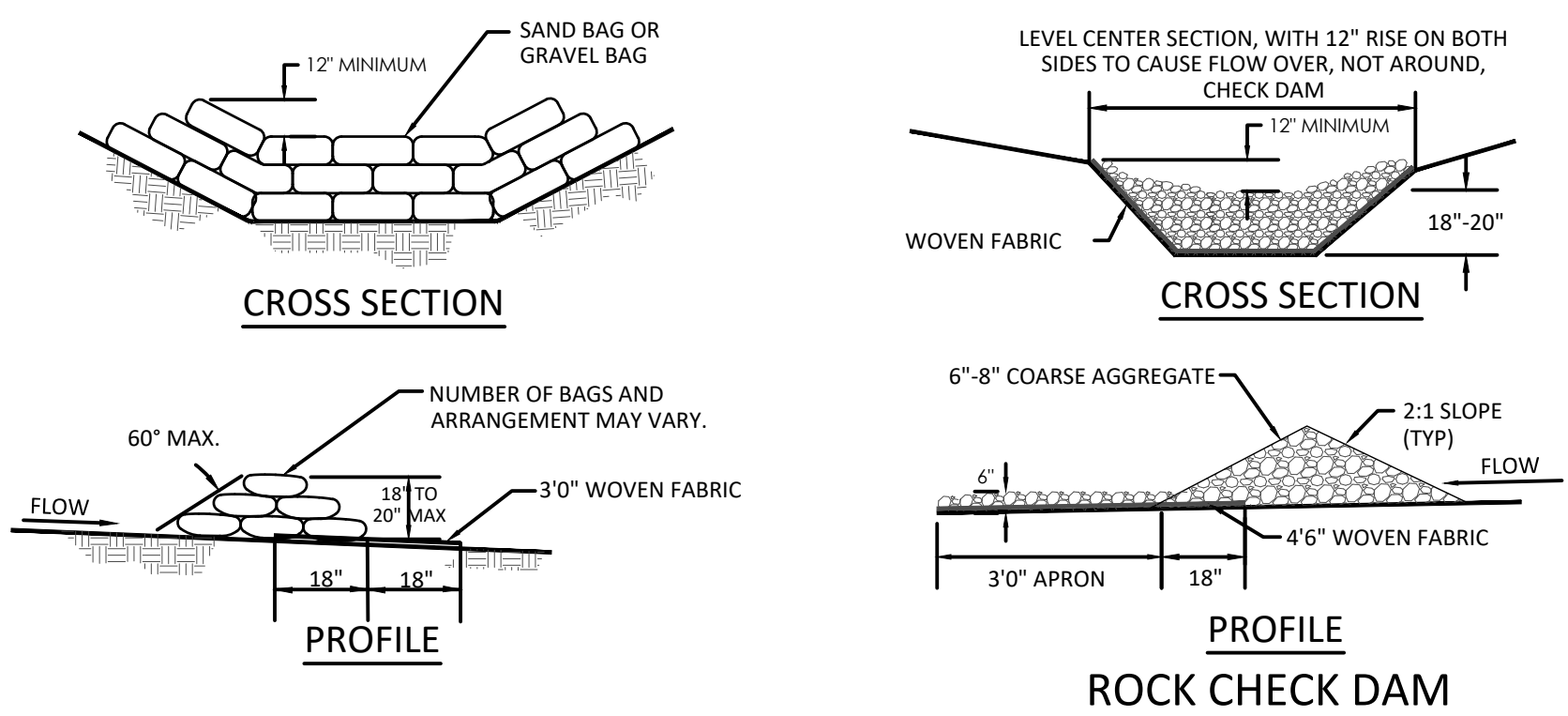

**3 CHECK DAMS**

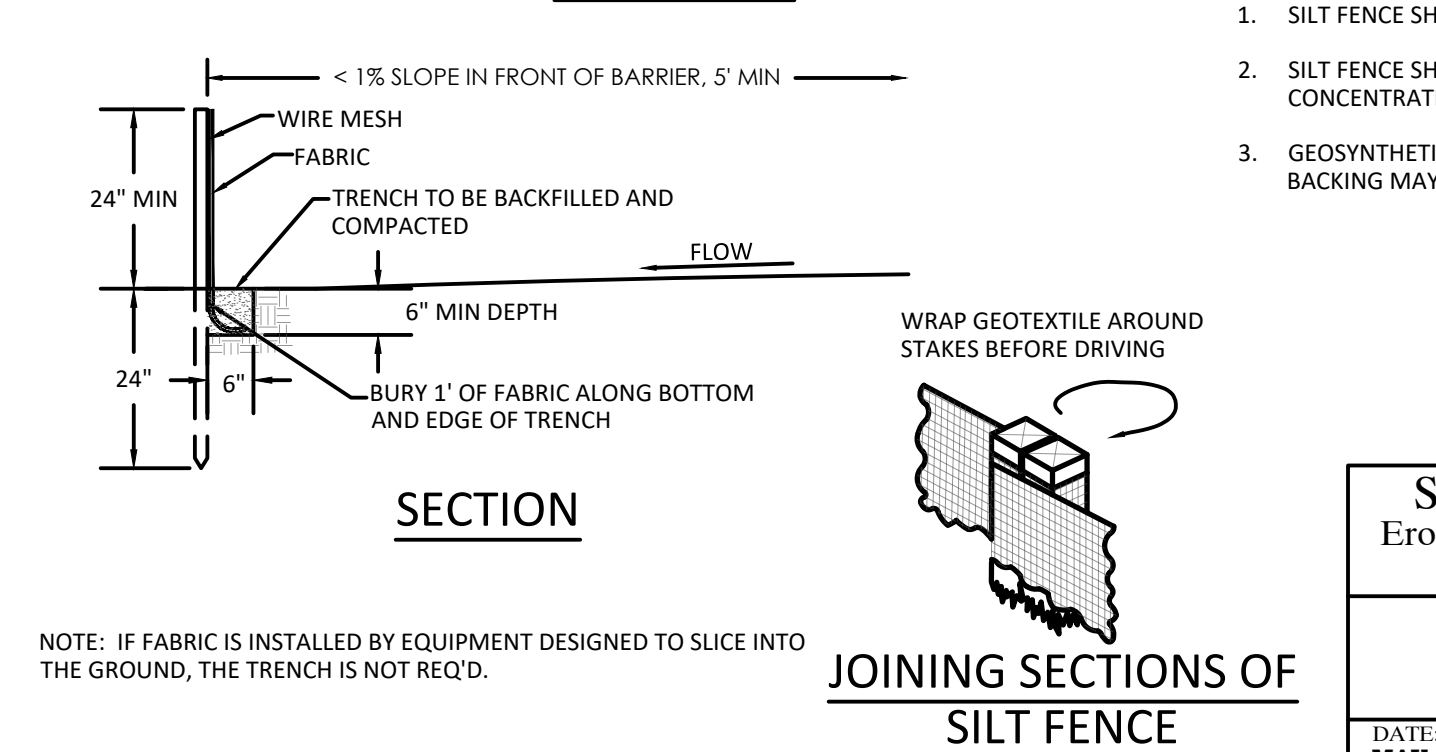
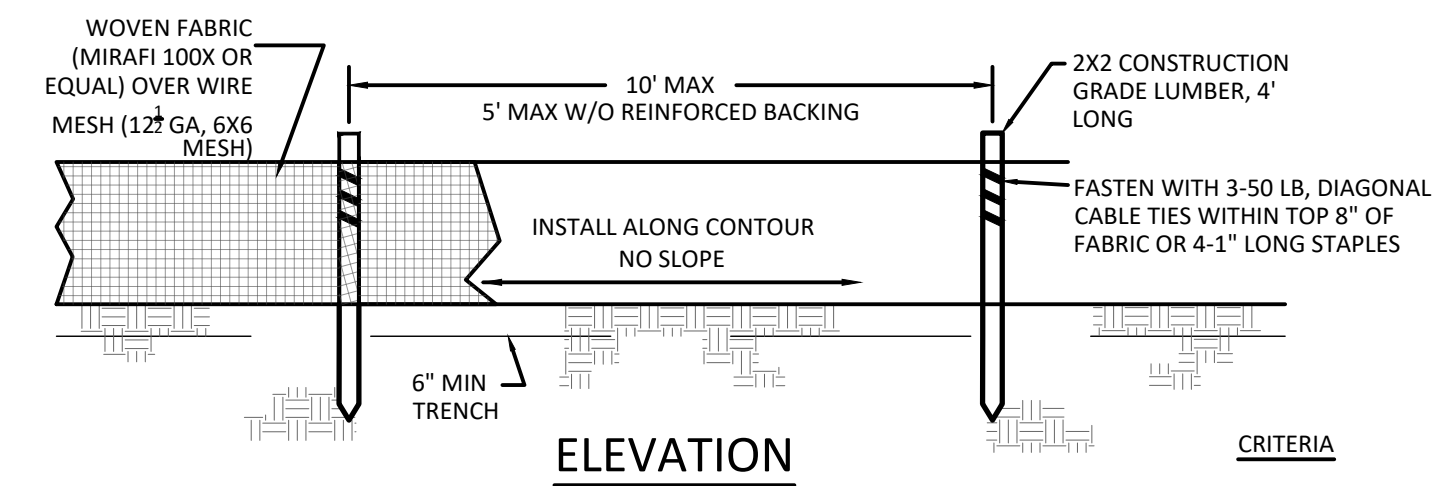

St. Charles County  
 Erosion & Sediment Controls  
 Standard Drawings

**SILT FENCE  
 INSTALLATION  
 SHEET FLOW (ONLY)**

DATE: MAY 2005 DRAWING: ESC-5

**2 SILT FENCE INSTALLATION**

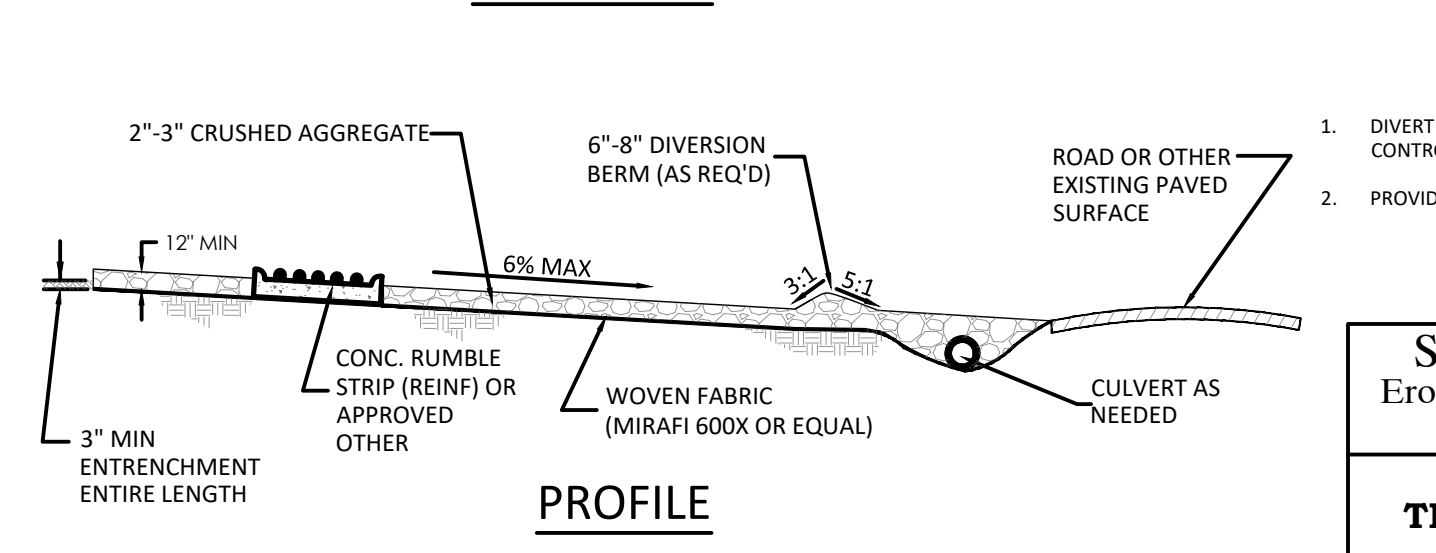
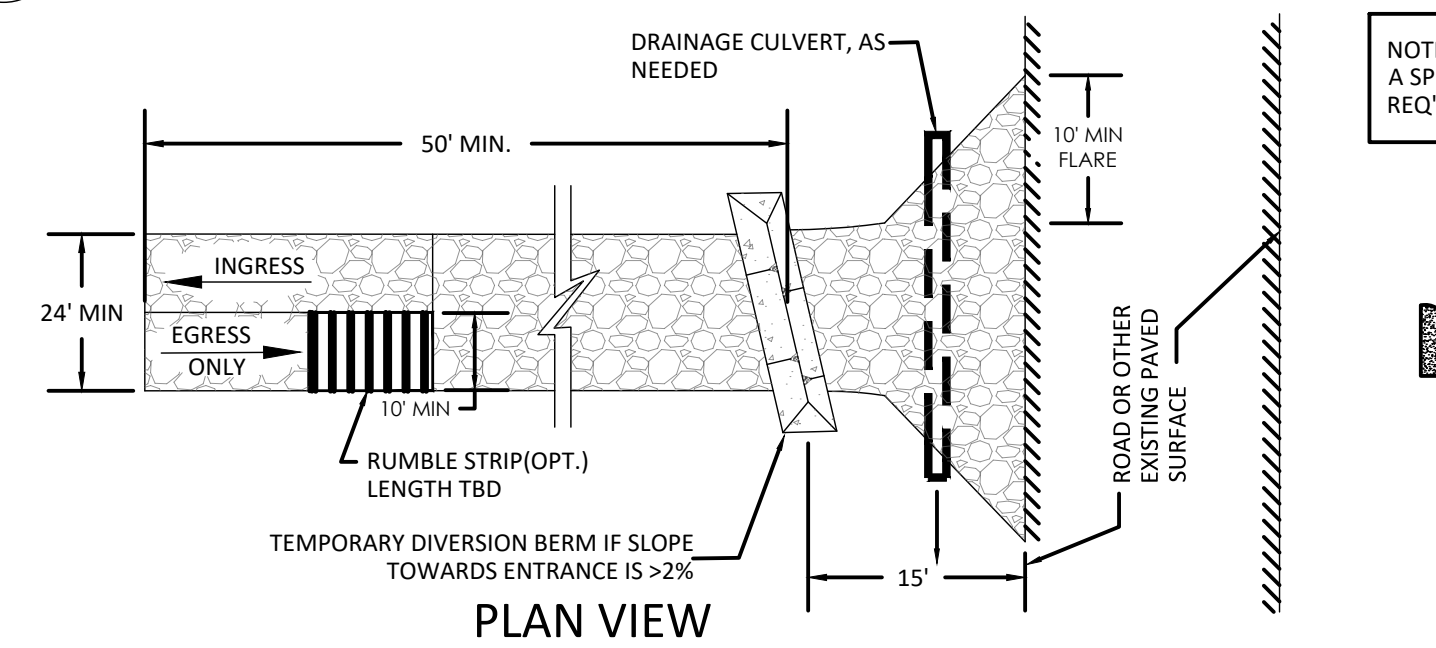

**DESIGN NOTES**

- DIVERT ALL RUNOFF TO A SEDIMENTATION CONTROL DEVICE.
- PROVIDE WATER SUPPLY FOR WASHDOWN.

St. Charles County  
 Erosion & Sediment Controls  
 Standard Drawings

**CONSTRUCTION  
 TRAFFIC WASH-OFF  
 PAD**

DATE: APRIL 2008 DRAWING: ESC-4

**1 CONSTRUCTION TRAFFIC WASH-OFF PAD**

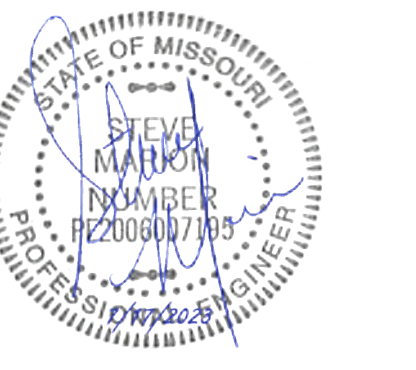

ENGINEERS AUTHENTICATION  
 The responsibility for professional engineering liability on this project is hereby limited to the set of plans authorized by the seal, signature, and date hereunder attached. Responsibility is disclaimed for all other engineering plans involved in this project and specifically excludes reviews after the date when authorized.

STEVEN D. MARKOV, P.E.  
 PROFESSIONAL ENGINEER  
 PE 220007195

NOLES PROPERTIES LLC  
 BRYAN ROAD COMMERCIAL DEVELOPMENT  
 TBD BRYAN ROAD  
 OFALLON, MO 63376  
 NOLES PROPERTIES LLC  
 11361 OLIVE BLVD  
 CREVE COEUR, MO 63141

Project Date: 5/2/2023

#	Revision Date	Description of Changes
1	6/26/2023	REVISED PER CITY OF OFALLON AND OFALLON FIRE COMMENTS
2	7/17/2023	REVISED PER CITY OF OFALLON COMMENTS
3	7/17/2023	REVISED PER CITY OF OFALLON COMMENTS

Sheet No. C-502

Project No. 2202920  
 Drawn By P. HEITZ  
 Checked By M. FOGARTY

ISSUED FOR CONSTRUCTION

EROSION CONTROL DETAILS

V:\work\p\civil\3D PROJECTS\2022\20220302\_Noles\_Bryan Rd Commercial Development\CONSTRUCTION DRAWINGS\SHEETS\C-502 EROSION CONTROL PLAN DETAILS.dwg



UNDERGROUND UTILITIES AND OSHA SAFETY NOTE:  
 Underground utilities and structures have been plotted from available information and therefore, their location must be considered approximate only. It is the responsibility of the individual contractors to notify the utility companies before actual construction. All O.S.H.A. rules and regulations established for the type of construction required by these plans shall be strictly followed (ie. trenching, blasting, etc.)