

GENERAL NOTES

- All utility service lines shall be kept in service and protected during construction operations. The drawings indicate the location of known existing utility service lines as could best be determined. However, such locations are not guaranteed and the plans may not show the location of all existing utility lines. It shall be the Contractor's responsibility to verify and locate all existing utility service lines and immediately notify the Engineer of any conflicts and discrepancies.
- No area shall be cleared without permission of the City Engineer.
- This project shall be administered in accordance with the Saint Charles County Standard Specifications for Highway Construction.

ABBREVIATIONS
(USED IN PLANS)

SLOPE LIMIT	S.L.
RIGHT-OF-WAY	R/W
EXISTING	EXIST
PROPOSED	PROP.
PERMANENT WALL EASEMENT	PWE
PERMANENT SIDEWALK & UTILITY EASEMENT	PSUE
TEMPORARY CONSTRUCTION EASEMENT	TCE
REMOVE	(R)
REMOVE & REPLACE	(R&R)
RELOCATE	(REL)
USE IN PLACE	(UIP)
DO NOT DISTURB	(DND)
ADJUST TO GRADE	(ATG)
TO BE REMOVED BY OTHERS	(TBRBO)
ADJUST TO GRADE BY OTHERS	(ATGBO)
TO BE ABANDONED AND FILLED	TBA&F
FLAT BOTTOM DITCH	F.B.D.
SPECIAL FLAT BOTTOM DITCH	S.F.B.D.
REMOVE AND REPLACE TO SLOPE LIMITS	(R&R TO S.L.)
RELOCATE BY OTHERS	(RELBO)
SAVE	(S)

CONVENTIONAL SYMBOLS
(USED IN PLANS)

BUILDINGS AND STRUCTURES	EXISTING	NEW
GUARD RAIL		
CONCRETE RIGHT-OF-WAY MARKER		
STEEL RIGHT-OF-WAY MARKER		
LOCATION SURVEY MARKER		
UTILITIES		
UNDERGROUND TELEPHONE		
UNDERGROUND TELEVISION		
OVERHEAD/UNDERGROUND POWER		
GAS LINE		
WATER		
STORM MANHOLE		
SANITARY MANHOLE		
FIRE HYDRANT		
WATER VALVE		
WATER METER		
DROP INLET		
SPRINKLER HEAD		
GROUND MOUNTED SIGN		
UTILITY POLE		
LIGHT POLE		
H-FRAME POWER POLE		
TELEPHONE PEDESTAL		
FENCE		
EX CHAIN LINK		
NEW ORNAMENTAL FENCE		
GATE POST		
BENCHMARK		
TREELINE		
TREE		
GUY ANCHOR		

NOTE: DASHED OR OPEN SYMBOLS INDICATE EXISTING FEATURES

CONSTRUCTION PLANS FOR
BRYAN ROAD
LANE WIDENING

FOR THE
CITY OF O'FALLON,
ST. CHARLES COUNTY, MISSOURI

DESIGN CRITERIA

A.A.D.T. - 2013	EXISTING
LANE WIDTH	11'
MAXIMUM GRADIENT	8% (1.75% EXISTING GRADE)
MINIMUM STOPPING SIGHT DISTANCE (CREST)	250'
MINIMUM K VALUE (SAG)	49
MINIMUM K VALUE (CREST)	29
MINIMUM HORIZONTAL CURVE RADIUS	510'
CLASSIFICATION:	PRINCIPAL ARTERIAL
BRYAN ROAD	35 M.P.H.
DESIGN SPEED	

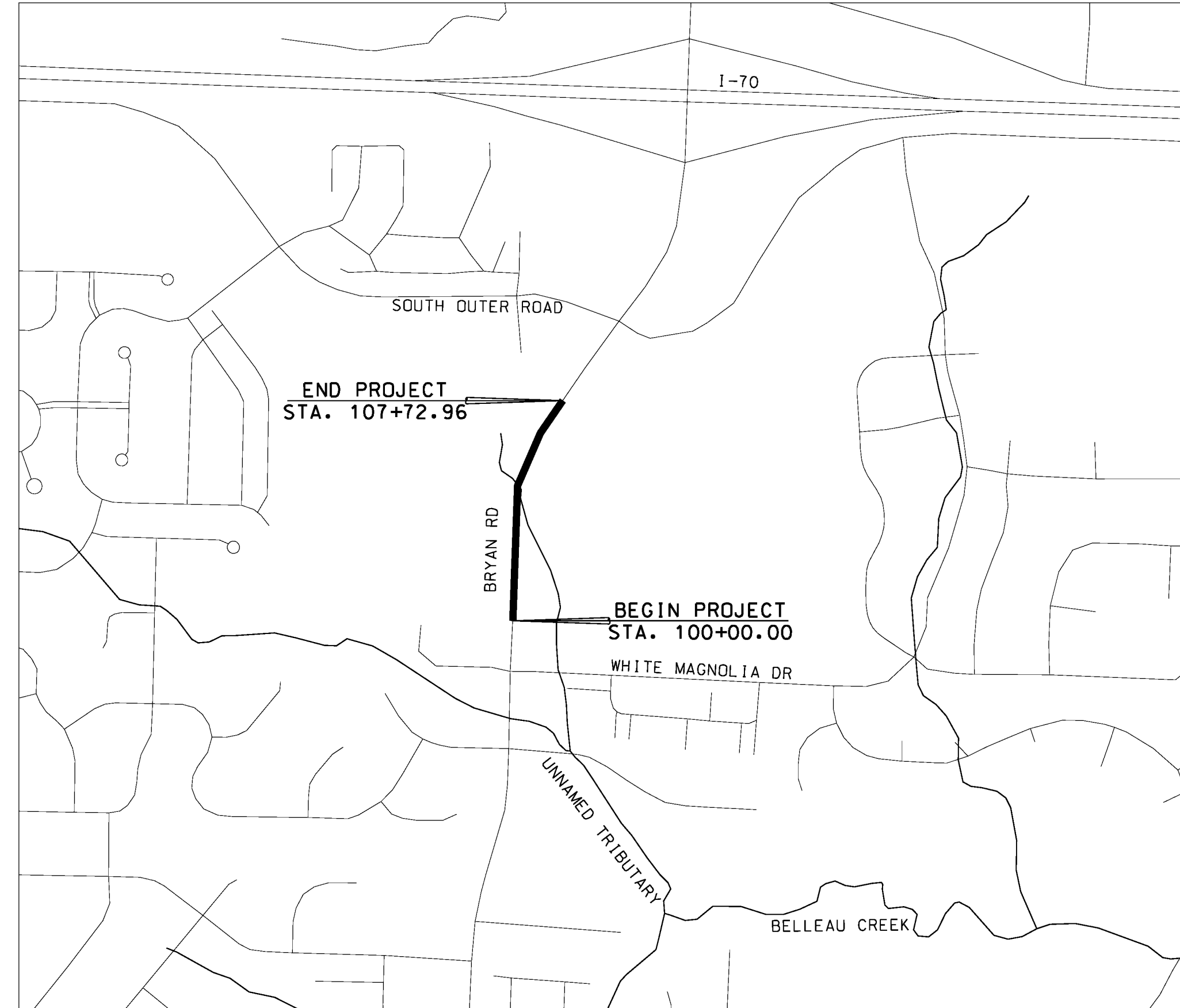

VICINITY MAP

Scale: Not To Scale

LENGTH OF PROJECT

Bryan Road: 772.96 Feet

UTILITY COMPANIES

	COMPANY	NAME	ADDRESS	TELEPHONE	E-MAIL ADDRESS
Electric	Ameren Missouri	Dan Giessmann	1901 Chateau Avenue St. Louis, Missouri 63103	Tel: 636-639-8336	DGiessmann@ameren.com
Phone	CenturyLink	Marcia Gay	1151 CenturyTel Drive Wentzville, Missouri 63385	Tel: 636-332-7261	marcia.gay@centurylink.com
Cable	Charter Communications	John Danowski	815 Charter Commons Town and Country, Missouri 63017	Tel: 636-387-6650	john.danowski@charter.com
Gas	Laclede Gas Company	Kent Thaemert	6400 Graham Road Berkeley, Missouri 63134	Tel: 314-522-2297	kthaemert@lacledegas.com
Water & Sewer	City of O'Fallon	Mike Pratt	1051 Public Works Drive O'Fallon, Missouri 63366	Tel: 636-379-7605	mpratt@ofallon.mo.us

PREPARED & SUBMITTED BY:
GEORGE BUTLER ASSOCIATES, INC.
225 S. MAIN ST., SUITE 200
O'FALLON, MO 63366

PROJECT ENGINEER:

DATE:

APPROVED:

PUBLIC WORKS DIRECTOR:

DATE:

INDEX OF SHEETS

Sht. No.	Description
1	TITLE SHEET
2	TYPICAL SECTIONS
3-4	SUMMARY OF QUANTITIES
5-6	PLAN AND PROFILE
7-9	DETAILS
10	EROSION CONTROL
11	PAVEMENT MARKING AND SIGNING
12-14	TRAFFIC CONTROL
1-4	CROSS SECTIONS

GBA
architects
engineers

225 S. Main, Suite 200
O'Fallon, MO 63366
636.240.2444
www.gbateam.com

BRYAN ROAD
LANE WIDENING
CITY OF O'FALLON, MISSOURI
100 NORTH MAIN STREET
O'FALLON, MISSOURI 63366

PROPOSED FACILITY:

REVISION

PER CITY COMMENTS 03/10/16

PER CITY COMMENTS 04/19/16

PROJECT NUMBER

GBA PROJECT NUMBER
13226.00

DATE

4/20/2016

DESIGNED:
DSB

DRAWN:
MLG

REVIEWED

SHEET TITLE

TITLE SHEET

SHEET NUMBER

1