

BUILDING SIDEWALK CONTROL AND EXPANSION JOINT DETAILS

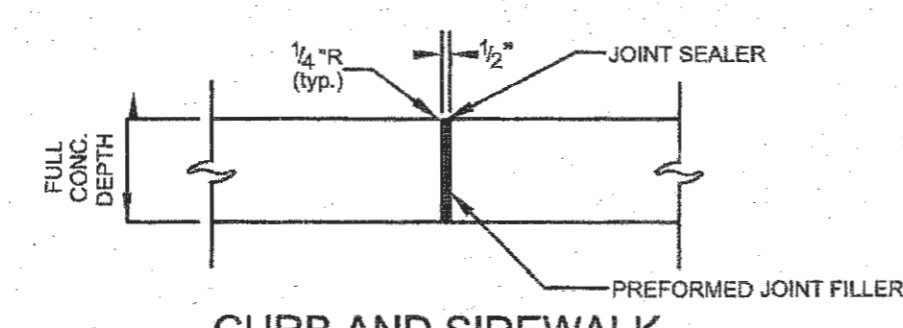

CURB AND SIDEWALK EXPANSION JOINT

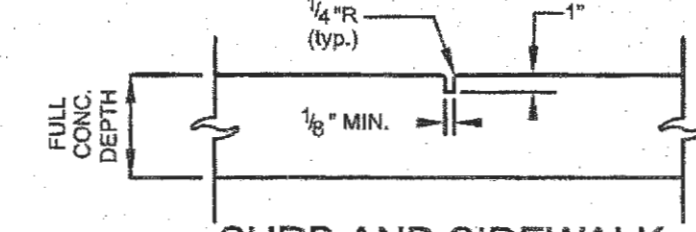

CURB AND SIDEWALK CONTRACTION JOINT

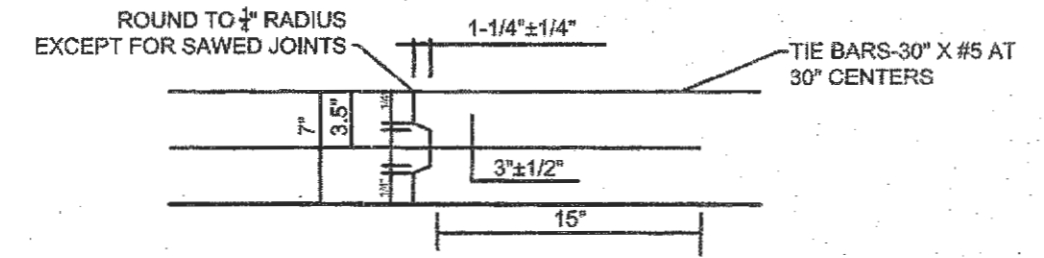

DETAIL OF CONSTRUCTION JOINT FOR COMPACTOR AND DUMPSTER PAD

CONCRETE EXPANSION JOINT SPECIAL NOTE
 DEPTH CANNOT EXCEED 1/4" AND WIDTH SHALL NOT EXCEED 1/2" WITHOUT BEING CLASSIFIED AS A BARRIER BY ADA. SPECIAL ATTENTION SHALL BE PAID TO THE DEPTH AFTER THE JOINT FILLER HAS FULLY CURED. A SECOND APPLICATION OF JOINT FILLER MAY BE REQUIRED. THIS REQUIREMENT SHALL APPLY TO ALL EXPANSION JOINTS WITH THE ADA PATH.

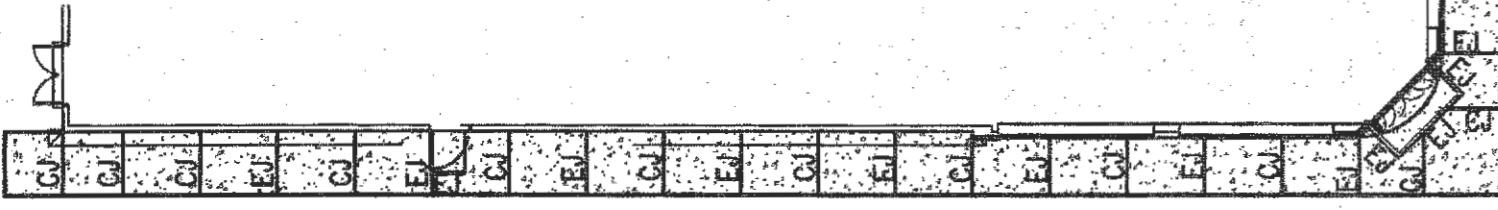

BUILDING SIDEWALK JOINT PATTERN AND SPACING DETAIL

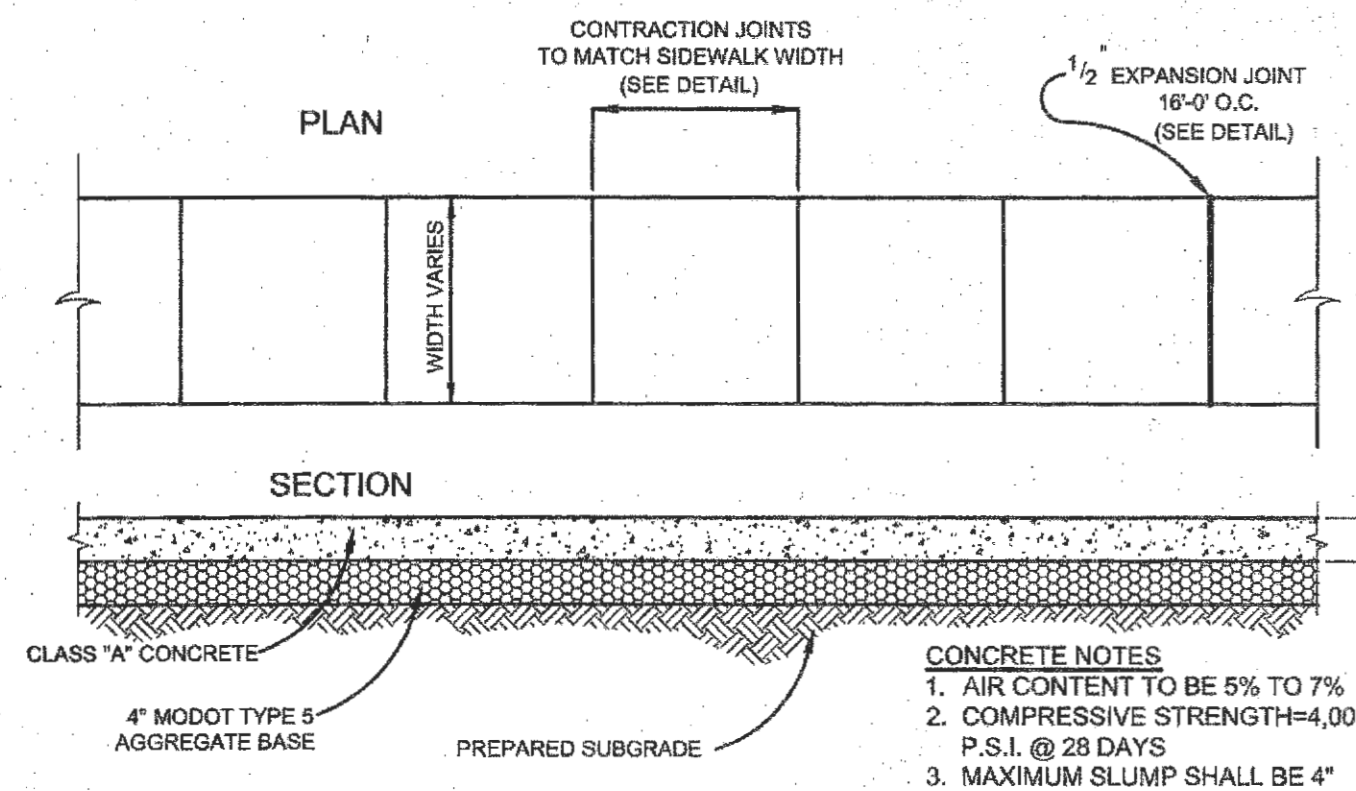

CONCRETE SIDEWALK DETAIL
 N.T.S.
 (NOT TO BE USED FOR BUILDING SIDEWALK)

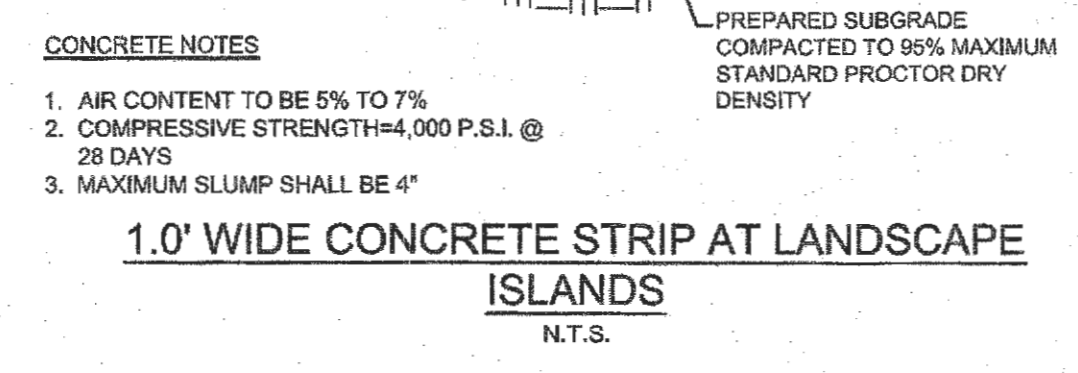

1.0' WIDE CONCRETE STRIP AT LANDSCAPE ISLANDS
 N.T.S.

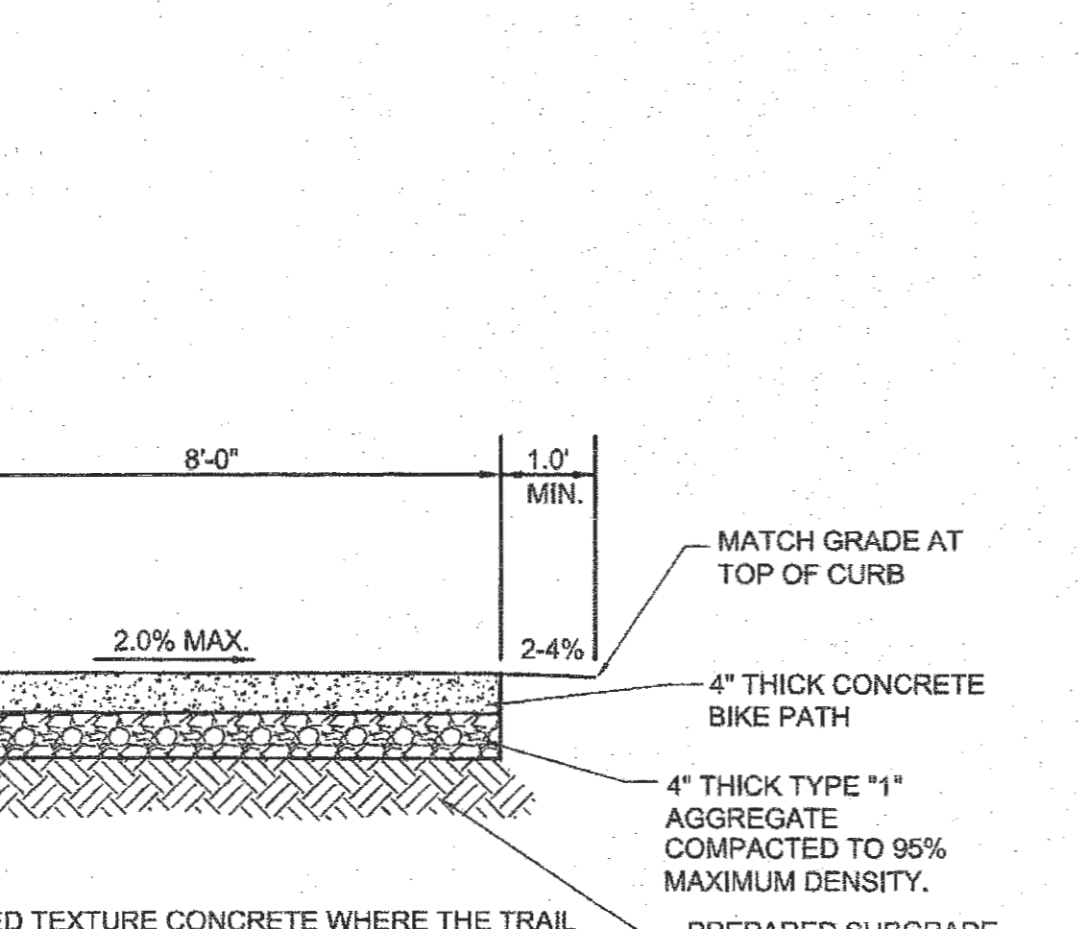

NOTES:
 PROVIDE STRIPING OR A COLORED TEXTURE CONCRETE WHERE THE TRAIL INTERSECTS WITH ACCESS DRIVES INTO THE DEVELOPMENT.
 MAXIMUM SLOPE OF THE PATH SHALL NOT EXCEED 5% AND 2% CROSS SLOPE PER CITY OF O'FALLON SPECIFICATIONS.
 THE TRAIL SHALL BE CONSTRUCTED WITH A CONSISTENT SLOPE WITH VERTICAL CURVES A MINIMUM OF 50' IN LENGTH.
 PROVIDE CONTRACTION JOINTS AT 10' INTERVALS AND EXPANSION JOINTS AT 30' INTERVALS. SEAL ALL EXPANSION JOINTS.

MULTI-USE TRAIL DETAIL
 N.T.S.

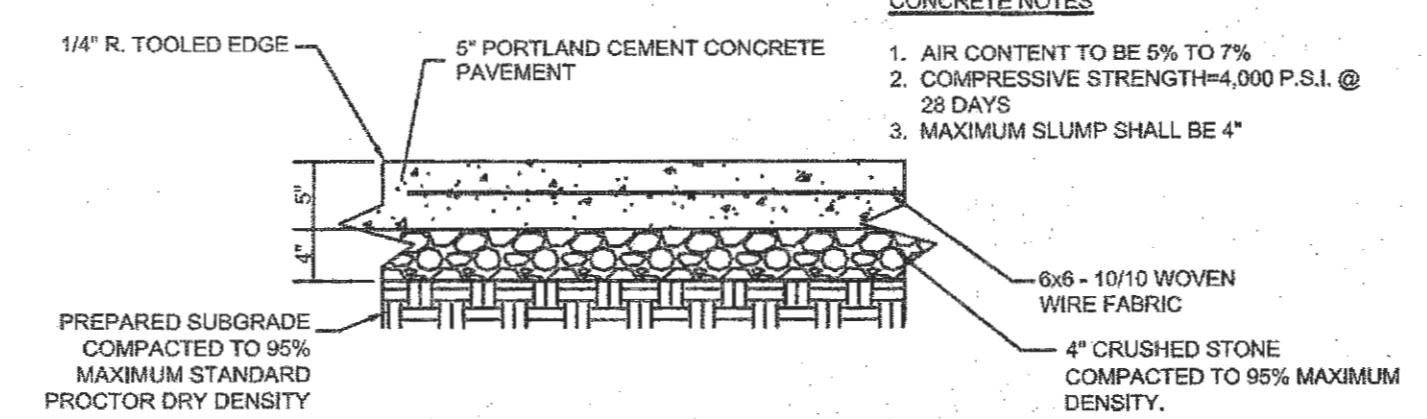

LIGHT DUTY ADA AISLE ACCESSIBLE PAVEMENT DETAIL AT PARKING SPACES
 N.T.S.

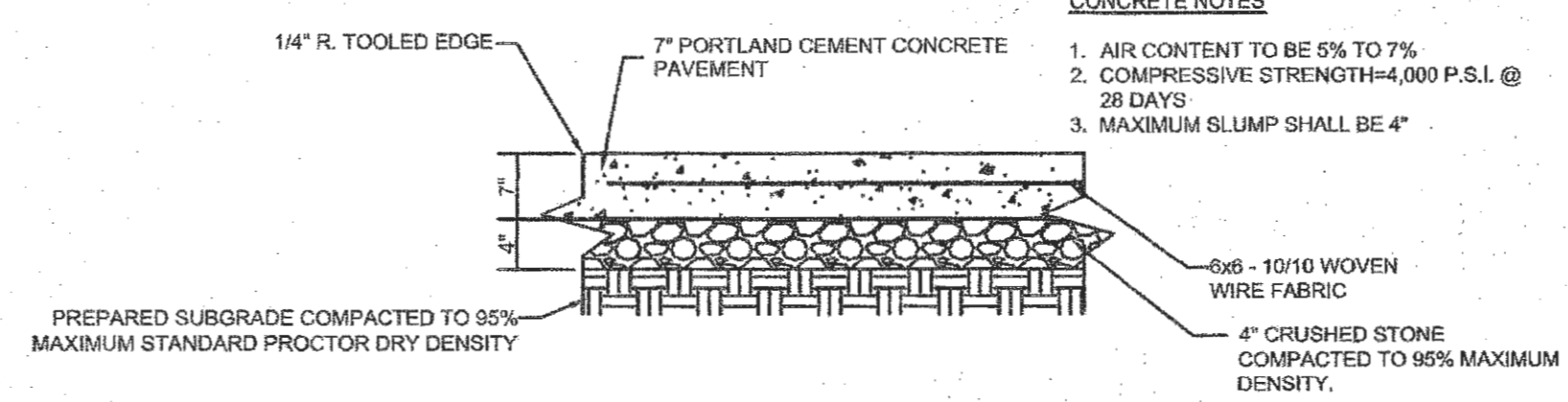

HEAVY DUTY CONCRETE ADA DRIVE AISLE PAVEMENT DETAIL AT DRIVING LANE
 N.T.S.
 PROVIDE CONTRACTION JOINTS AT 12' MAX. SPACING, PROVIDE EXPANSION JOINTS AT 30' MAX. SPACING. SEAL ALL EXPANSION JOINTS.

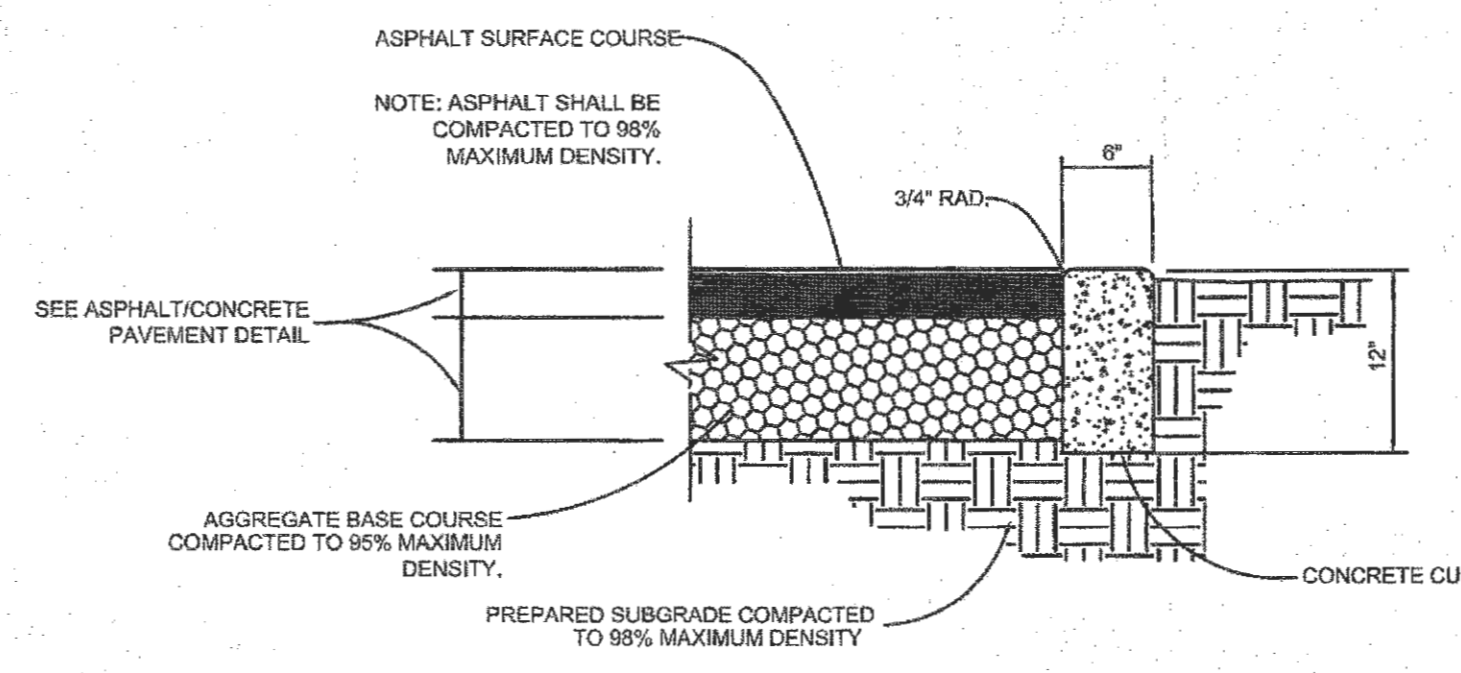

CONCRETE EDGE RESTRAINT
 N.T.S.

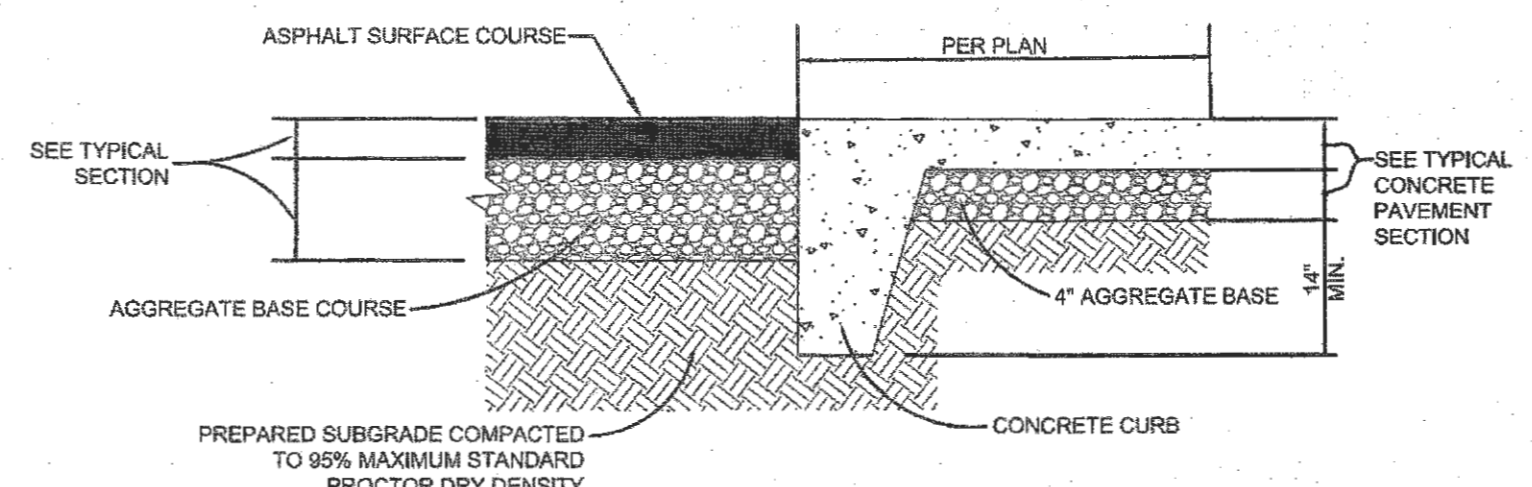

THICKENED EDGE AT ADA STALLS
 N.T.S.

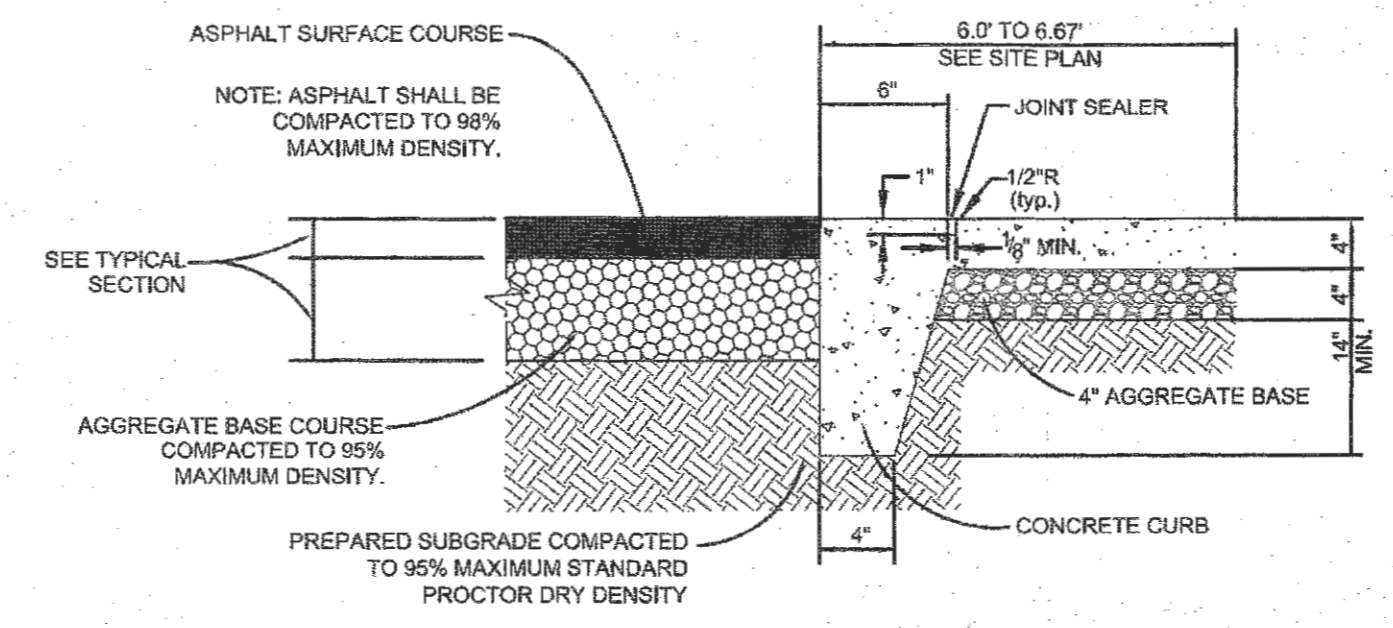

THICKENED EDGE AT SIDEWALK
 N.T.S.

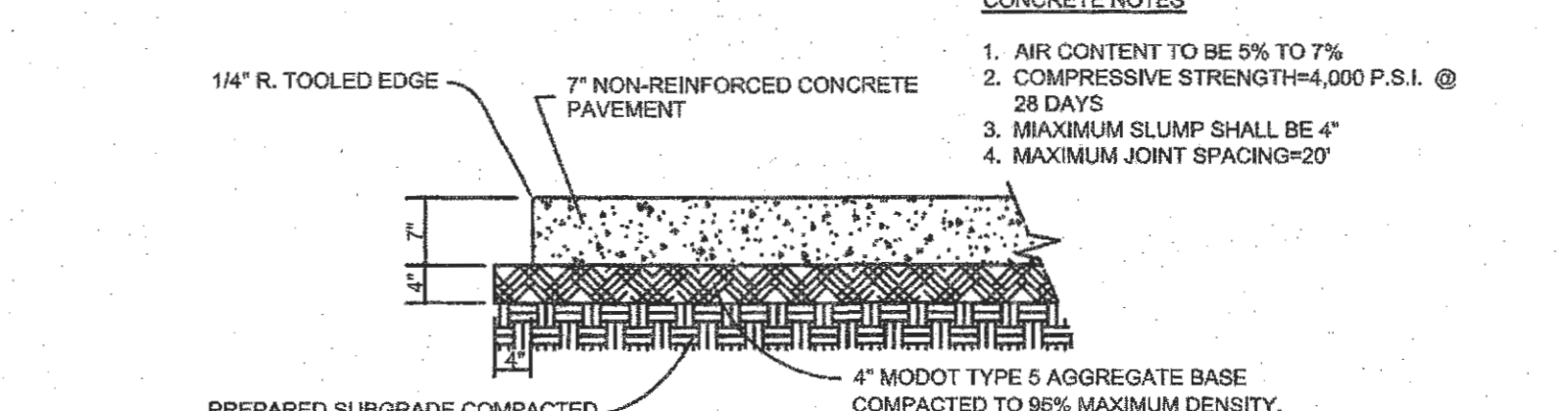

COMPACTOR AND DUMPSTER PAD CONCRETE PAVEMENT DETAIL
 N.T.S.

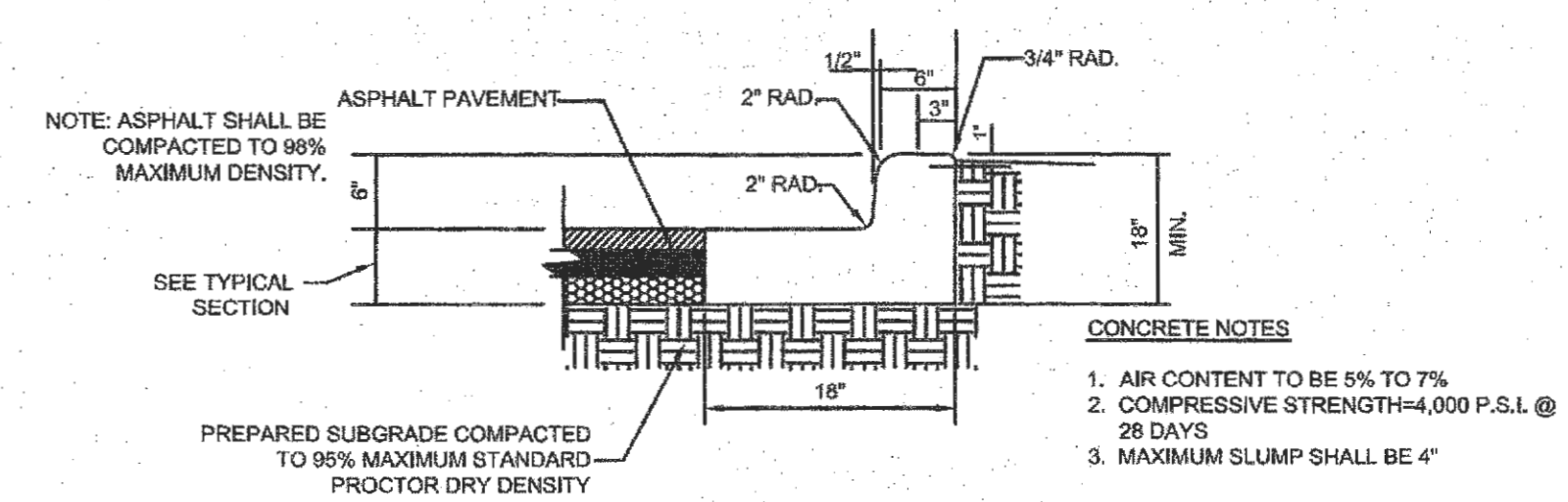

1.5' CONCRETE CURB & GUTTER
 N.T.S.

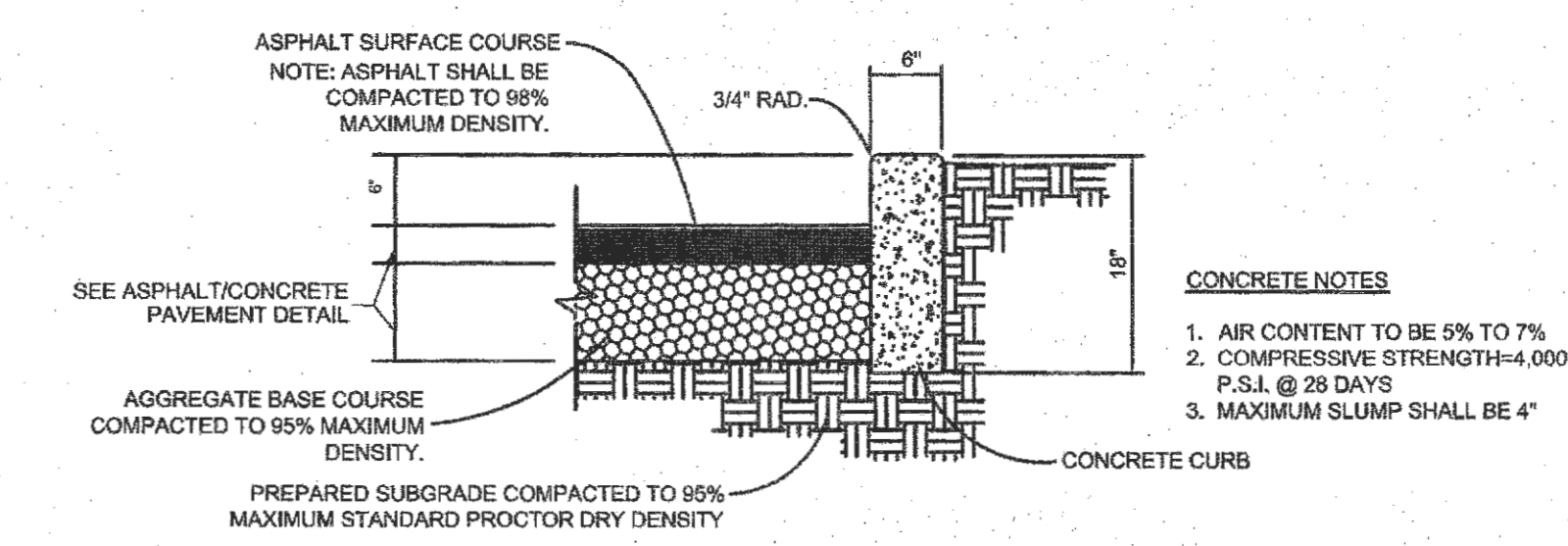

6' VERTICAL CONCRETE CURB
 N.T.S.

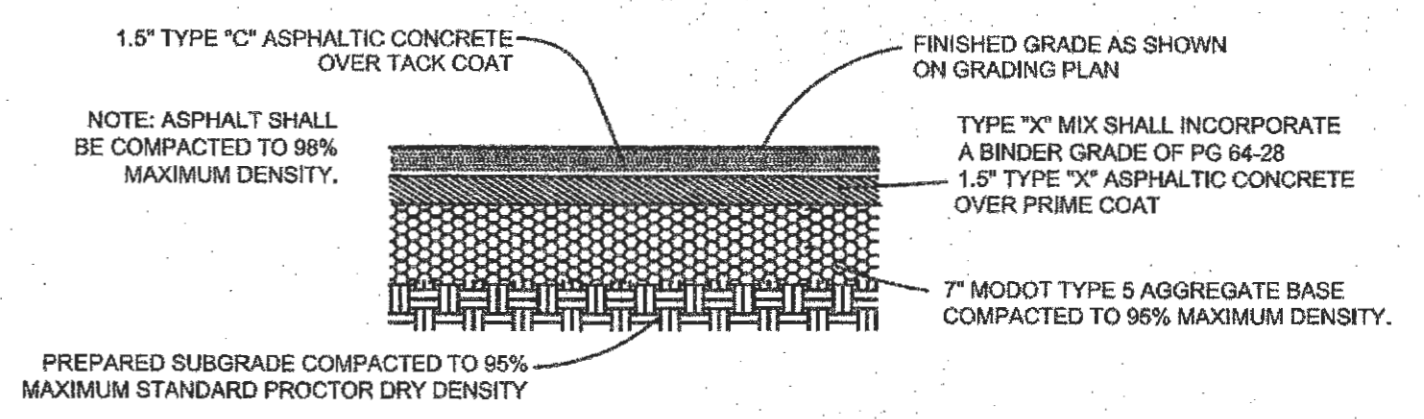

LIGHT DUTY ASPHALT PAVEMENT DETAIL
 N.T.S.

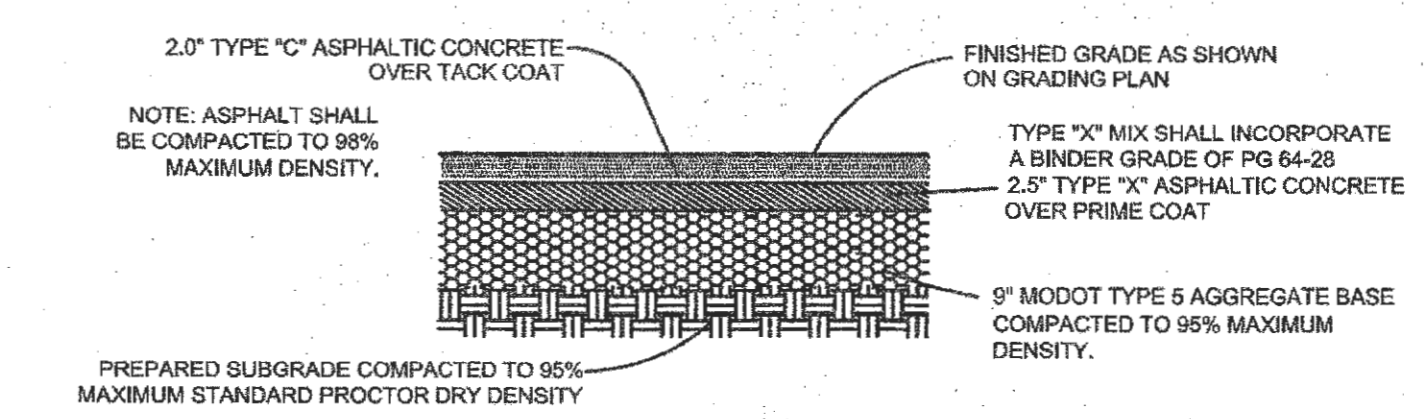

MEDIUM DUTY ASPHALT PAVEMENT DETAIL
 N.T.S.

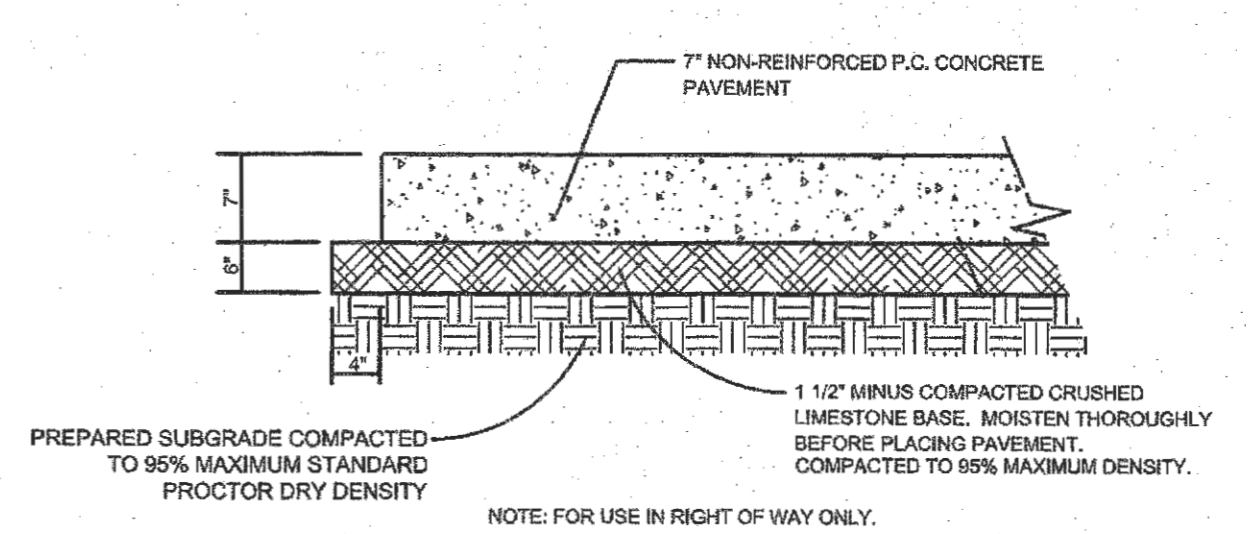

PROPOSED BRYAN ROAD AND FEISE ROAD ENTRANCE CONCRETE PAVEMENT DETAIL
 N.T.S.



PROJECT TITLE
 NORTHWEST 13,225-RIGHT CHAMFER DRIVE-THRU STORE NUMBER: 10546
 NEC FEISE ROAD AND BRYAN ROAD O'FALLON, MO
 PROJECT TYPE: NEW CONSTRUCTION
 DEAL TYPE: Fee for Service
 CS PROJECT NUMBER: 69591



719 Gravel Street
 Suite 1000
 Detroit, MI 48226
 (313) 324-3113



308 TOW COURT
 Lake Saint Louis, MO 63367
 Phone: (314) 925-7444 Fax: (314) 925-7457
 Missouri Certificate of Authority # E-2011000031
 Missouri Certificate of Authority # LS-2012007849

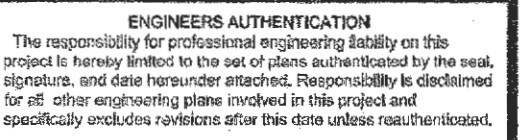

ENGINEER'S AUTHENTICATION
 The responsibility for professional engineering liability on this project is hereby limited to the set of plans authorized by the seal, signature, and date hereunder attached. Responsibility is disclaimed for all other engineering plans involved in this project and specifically includes revisions after this date unless re-authorized.

Developer / Owner Information

T.M. CROWLEY & ASSOCIATES

Pavement Details

P+Z No. 01-15 & 01.15.01
 APPROVED 1-15-15
 City No.

Sheet Number:

19

PCE PROJECT NO. 136101

\\vauf-pc\vauf\civil\3d\PROJECTS\2013\136101_NEC FEISE AND BRYAN\CONSTRUCTION DOCUMENTS\Erosion Control Details.dwg

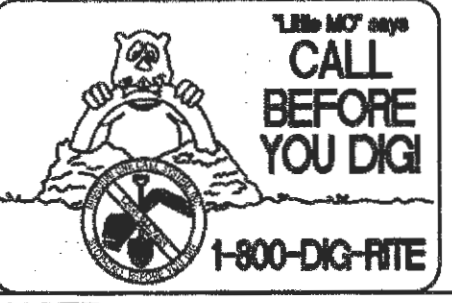

NOTE:
 Underground utilities and structures have been plotted from available information and therefore, their location must be considered approximate only. It is the responsibility of the individual contractors to notify the utility companies before actual construction.