

1. All material to meet Filtrex® specifications.
2. SiltSoxx™ composite/reinforced filter for most applications.
3. SiltSoxx™ applied to the entire slope. Greater slopes may require larger mesh per the Engineer.
4. Composite material to be disposed on site, as determined by Engineer.

Slope Percent	Maximum Slope Length Above SiltSoxx™ in Feet (meters)*				
	8 in (200 mm) SiltSoxx™	12 in (300 mm) SiltSoxx™	18 in (450 mm) SiltSoxx™	24 in (600mm) SiltSoxx™	32 in (800mm) SiltSoxx™
2 (or less)	660 (180)	750 (225)	1000 (300)	1300 (400)	1650 (500)
5	400 (120)	500 (150)	550 (165)	650 (200)	750 (225)
10	200 (60)	250 (75)	300 (90)	400 (120)	500 (150)
15	140 (40)	170 (50)	200 (60)	325 (100)	450 (140)
20	100 (30)	125 (38)	140 (42)	200 (60)	400 (120)
25	80 (24)	100 (30)	110 (33)	200 (60)	325 (100)
30	60 (18)	75 (23)	90 (27)	130 (40)	200 (60)
35	60 (18)	75 (23)	80 (24)	115 (35)	150 (45)
40	60 (18)	75 (23)	80 (24)	100 (30)	125 (38)
45	40 (12)	50 (15)	60 (18)	80 (24)	100 (30)
50	40 (12)	50 (15)	55 (17)	75 (23)	100 (30)

*Based on a datum point of 36 in (9.1 m) above site (mean water reinforcement) at 1000 ft (305 m) of slope, watershed with equivalent receiving length of sediment control device, 1 in 24 (1:24) or (25 mm/76.2 mm) man event. **Effective height of SiltSoxx™ after installation and with constant head from rainfall as determined by Ohio State University.

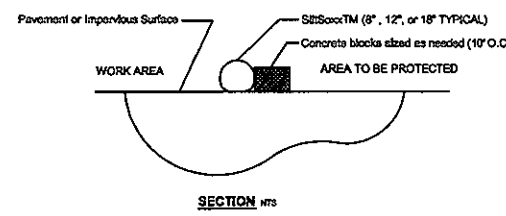

SiltSoxx™ for Sediment Control on Pavement

Table 60-5 Soil Stabilization Schedule

Soil Disturbance Activity or Condition	Required Stabilization Time
Soil disturbance has ceased in areas greater than 2,000 square feet.	14 days
After construction of dikes, swales, diversions, and other concentrated flow areas.	5 days
When slopes are steeper than 3 horizontal to 1 vertical.	7 days
When slopes are greater than 3% and longer than 150 feet.	14 days
Perimeter controls around soil stockpiles.	End of workday
Stabilization or covering of inactive stockpiles.	30 days
When land disturbance is completed, permanent soil stabilization must be installed.	30 days

STORM WATER POLLUTION PREVENTION PLAN

A. PURPOSE:
The purpose of the Storm Water Pollution Prevention Plan (SWPPP) is to inform the Developer/Contractor of the following objectives they are required to meet:

- Prevent erosion where construction activities shall occur.
- Prevent pollutants from mixing with storm water.
- Prevent pollutants from being discharged by trapping them on-site, before they can affect the receiving waters.
- All regulations of Missouri Department of Natural Resources are met.
- All regulations of the Environmental Protection Agency are met.
- All regulations of the local municipality are met.

B. PROJECT DESCRIPTION:
The project is located in the Perdue Creek watershed in St. Charles County, Missouri. This project disturbs approximately 0.99 acres.

The project activities consist of the construction of a building addition and new pavement within an existing lot. The site will be protected by the various erosion protection measures listed below:

1. Siltation Control: The entire perimeter of the project that allows storm water to exit will have siltation control installed. Details of these devices are depicted on the detail plans prepared by Bax Engineering Company, Inc.
2. Revegetation: The site will consist of varying ground slopes, upon completion of the grading activities the slope prone to erosion will be seeded and staked to stabilize the slope and prevent erosion.

C. MAINTENANCE AND INSPECTION:

Regular Maintenance: Weekly inspections of the project will include: (a) The repair of any sediment (silt) fence and/or staked straw bale barriers damaged or out of place; (b) The removal of any accumulated trash and/or debris; and (c) The removal of any externally deposited waste materials.

Periodic Inspections: Following each rain of more than 0.50 inch in 24 hours, the site will be inspected, and any necessary maintenance will be provided for a period of one year following the completion of the above remediation measures. Summaries of the maintenance and the inspections will be maintained and shall be kept available from the owner. An inspection report shall be filed and kept on site for every inspection. The report shall detail the findings of the inspection and if any action was required. The inspection form needs to include, name of the site, name of the inspector, permit number, date of inspection, major observations and actions taken to correct problems and the signature of the inspector. The inspection reports need to be kept on file by the permittee for three years after the project is completed.

The field inspections will be conducted in a systematic manner to minimize the possibility of any significant feature being overlooked. A detailed checklist will be developed and followed for the examination. Particular attention will be given to detecting evidence of erosion, slope instability, undue settlement, displacement, and tilting. Photographs and drawings will be used freely to record conditions in order to minimize descriptions. The field inspection will include appropriate features and items, including potential hazards to human life or property.

The condition of the slopes and vegetative cover will be evaluated and examined for erosion.

Measures will be taken to promote the growth of vegetation and repair of damage caused by erosion and sedimentation. The inspection will also provide recommendations for measures that need to be undertaken immediately, based on the experience and judgment of the inspector. Necessary follow up inspections will be made as necessary to verify that any maintenance, alteration, or repair measures are accomplished by methods acceptable by standard engineering practice.

25' x 50' CONSTRUCTION WASHDOWN AREA WILL BE ON EXISTING GRAVEL. ALL TRUCKS SHALL BE WASHED DOWN PRIOR TO LEAVING SITE. CONTRACTOR SHALL KEEP EXISTING PARKING LOT AND ADJACENT ROADS CLEAN AND FREE OF DEBRIS.

VEGETATION ESTABLISHMENT For Urban Development Sites APPENDIX A

SEEDING RATES:
PERMANENT:
 Tall Fescue - 30 lbs./ac.
 Smooth Brome - 20 lbs./ac.
 Combined - Fescue @ 15 lbs./ac. AND Brome @ 10 lbs./ac.
TEMPORARY:
 Wheat or Rye - 150 lbs./ac. (3.5 lbs. per s.f.)
 Oats - 120 lbs./ac. (2.75 lbs. per s.f.)

SEEDING PERIODS:
 Fescue or Brome - March 1 to June 1
 Wheat or Rye - March 15 to November 1
 Oats - March 15 to September 15

MULCH RATES:
 100 lbs. per 1000 sq. ft. (4,356 lbs. per ac.)

FERTILIZER RATES:
 Nitrogen 30 lbs./ac.
 Phosphate 30 lbs./ac.
 Potassium 30 lbs./ac.
 Lime 600 lbs./ac. ENM*

* ENM = effective neutralizing material as per State evaluation of quarried rock.

SPILL AND SITE POLLUTION:

Should an accidental spill occur refer to material safety data sheets. Any spills of hazardous materials in quantities in excess of reportable quantities as defined by EPA or the state agency regulations, shall be immediately reported to the EPA National Response Center (800-424-8802) and Missouri Department of Natural Resources (573-634-2436). Reportable spills for petroleum products is greater than 50 gallons. All other reportable hazardous materials and their quantities may be found on the web site at <http://www.dnr.mo.gov> on the local number is 573-640-9750. Federal law requires the responsible party to report any release of oil if it reaches or threatens a sewer, lake, creek, stream, river, groundwater, wetlands, or area like a road ditch, that drains into the above.

An emergency spill kit is required to be onsite for all potential spills.

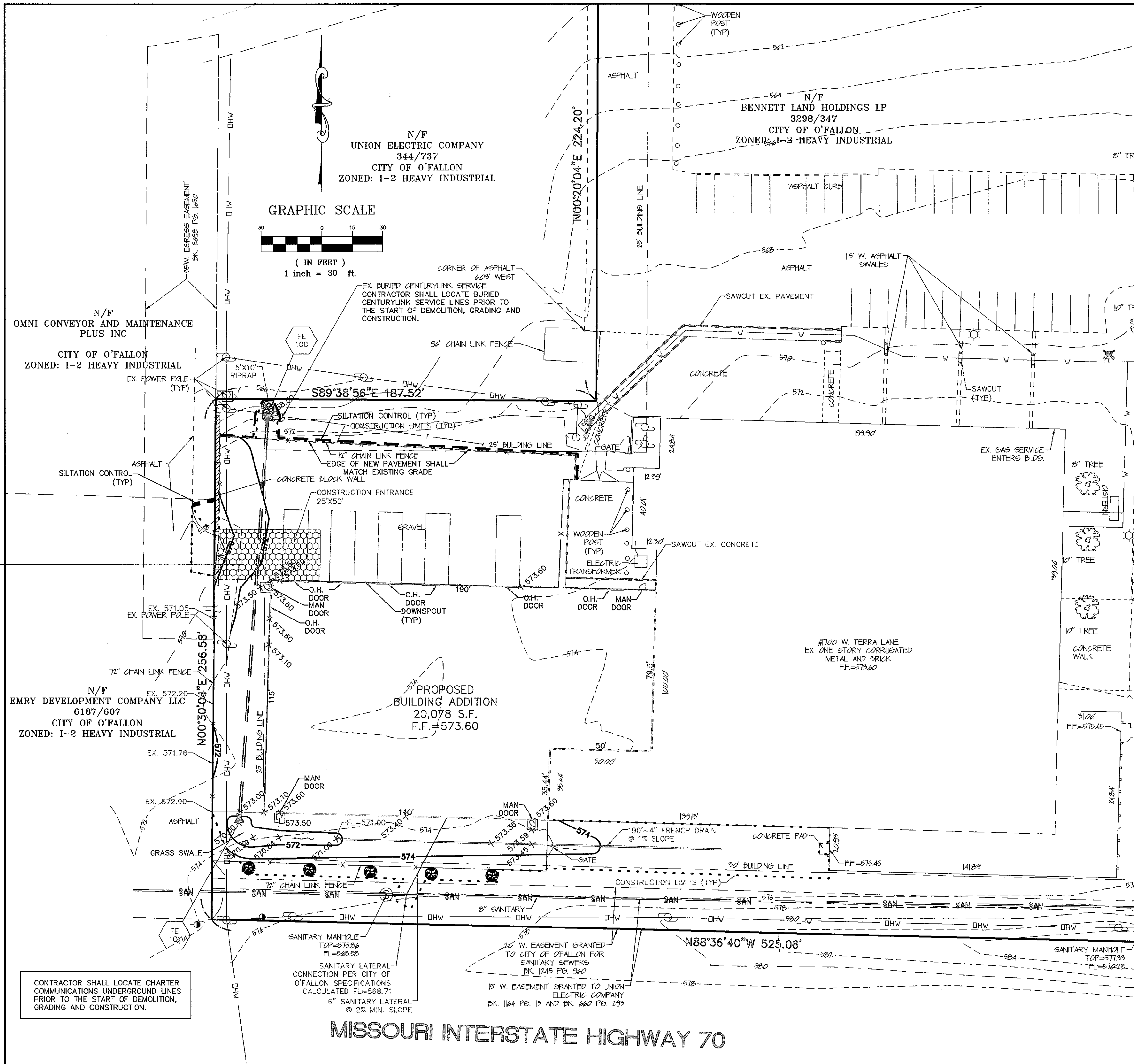

PROJECT TITLE:
C. BENNETT BUILDING ADDITION
 1700 W. TERRA LANE
 O'FALLON, ST. CHARLES COUNTY, MISSOURI, 63366

ENGINEERING PLANNING SURVEYING
 221 Point West Blvd.
 St. Charles, MO 63301
 636-928-6552
 FAX 636-928-1718

DISCLAIMER OF RESPONSIBILITY:
 I hereby specify that the documents intended to be authorized by my seal are limited to this sheet, and I hereby disclaim any responsibility for all other Drawings, Specifications, Estimates, Reports or other documents or instruments related to or intended to be used for any part or parts of the architectural or engineering project or survey.

LARRY D. WALKER
 Missouri State Certificate of Authority
 Engineering #000655
 Missouri State Certificate of Authority
 Surveying #000144

11/10/16
 Larry D. Walker
 Civil Engineer
 Engineers License No. 2007020343

REVISIONS

NO.	DATE	DESCRIPTION
09-13-16		PWS# NO.2 COMMENTS
10-06-16		CITY COMMENTS
10-13-16		CITY COMMENTS
11-01-16		FIRE DIST. COMMENTS
11-10-16		PWS# NO.2 COMMENTS

Developer / Owner:
 SHOCKLEY COMMERCIAL
 501 FIRST CAPITOL DRIVE, SUITE 5
 ST. CHARLES, MISSOURI 63301
 (636) 946-9753

GRADING PLAN

P+Z No. #4503.01.03
 Approved 07-07-16
City No. #16-010181
Page No. 5 of 8

CALL BEFORE YOU DIG!
 1-800-DIG-RITE

UNDERGROUND UTILITIES HAVE BEEN PLOTTED FROM AVAILABLE INFORMATION AND THEREFORE THEIR LOCATIONS SHALL BE CONSIDERED APPROXIMATE ONLY. THE VERIFICATION OF THE LOCATION OF ALL UNDERGROUND UTILITIES, EITHER SHOWN OR NOT SHOWN ON THESE PLANS SHALL BE THE RESPONSIBILITY OF THE CONTRACTOR, AND SHALL BE LOCATED PRIOR TO ANY GRADING OR CONSTRUCTION OF THE IMPROVEMENTS.