

Douglas A. DeLong, Landscape Architect LA-81

Consultants:

# The Streets of Caledonia Phase 1 Residential-North

O'Fallon, MO.

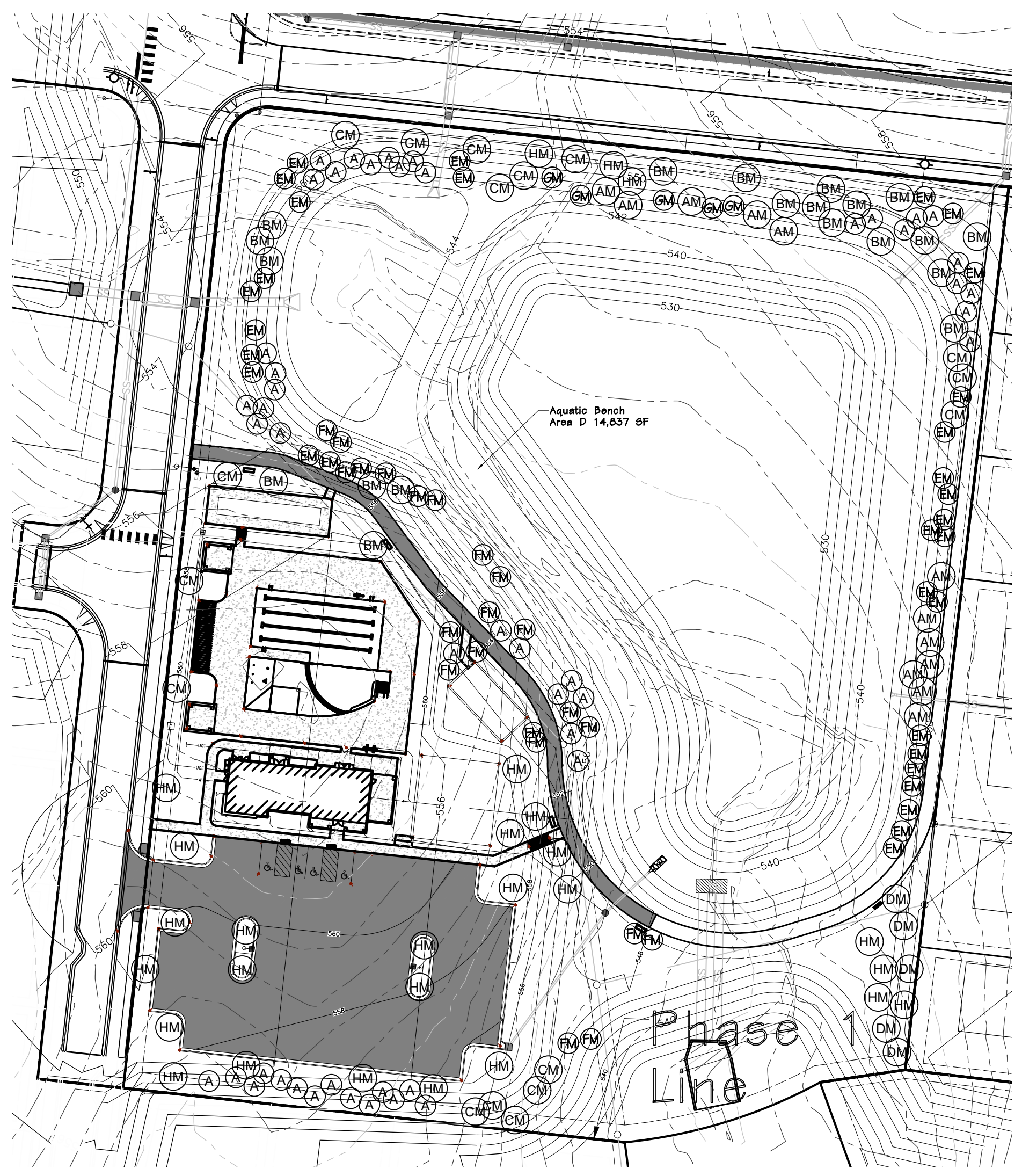

**Landscape Plan-Phase 1 Residential**  
Scale: 1"=60'

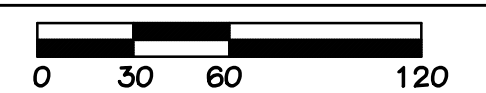

| AQUATIC BENCH PLANTINGS - North of DD |          |                             |                     |            |                         |
|---------------------------------------|----------|-----------------------------|---------------------|------------|-------------------------|
| SYMBOL                                | QUANTITY | BOTANICAL NAME              | COMMON NAME         | SIZE       | Notes                   |
| SUBMERGED AREA C-10,011 SF            |          |                             |                     |            |                         |
|                                       | 25       | <i>Nymphaea odorata</i>     | Fragrant Water Lily | 1 qt pot   | 10' o.c. groups of 3-5  |
|                                       | 400      | <i>Pontedaria cordata</i>   | Pickeral Weed       | 2x2x5" DCP | 2.5' o.c. groups of 3-5 |
|                                       | 400      | <i>Sagittaria latifolia</i> | Arrowleaf           | 2x2x5" DCP | 2.5' o.c. groups of 3-5 |
|                                       | 1,126    | <i>Juncus effusus</i>       | Soft Rush           | 2x2x5" DCP | 1.5' o.c. groups of 3-5 |
| SUBMERGED AREA D-14,837 SF            |          |                             |                     |            |                         |
|                                       | 37       | <i>Nymphaea odorata</i>     | Fragrant Water Lily | 1 qt pot   | 10' o.c. groups of 3-5  |
|                                       | 593      | <i>Pontedaria cordata</i>   | Pickeral Weed       | 2x2x5" DCP | 2.5' o.c. groups of 3-5 |
|                                       | 593      | <i>Sagittaria latifolia</i> | Arrowleaf           | 2x2x5" DCP | 2.5' o.c. groups of 3-5 |
|                                       | 1,669    | <i>Juncus effusus</i>       | Soft Rush           | 2x2x5" DCP | 1.5' o.c. groups of 3-5 |

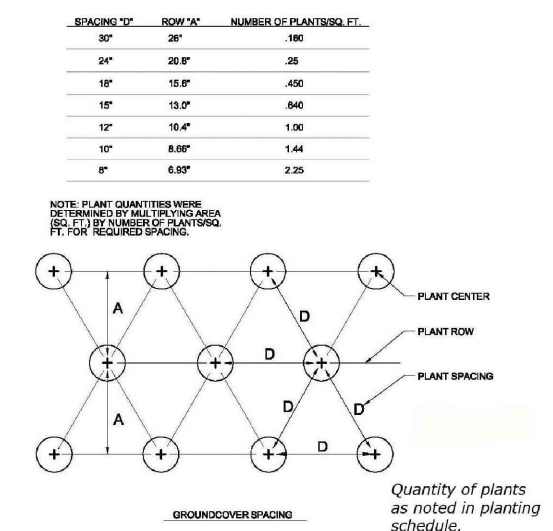

Spacing Diagram  
N.T.S.

| PLANTING SCHEDULE-LOT AND STREET TREES REQUIRED BY CODE - North of DD - 96 LOTS |          |   |                               |      |               |       |
|---|----------|---|-------------------------------|------|---------------|-------|
| SYMBOL  | QUANTITY | BOTANICAL NAME                              | COMMON NAME                   | SIZE | MATURE HEIGHT | Notes |
| B   | 22       | <i>Tilia americana</i> 'Redmond'            | Redmond Linden                | 2"   | 45'+          |       |
| C   | 14       | <i>Tilia cordata</i> 'Greenspire'           | Greenspire Little-leaf Linden | 2"   | 45'+          |       |
| D   | 17       | <i>Acer x freemanii</i> 'Autumn Fantasy'    | Autumn Fantasy Maple          | 2"   | 45'+          |       |
| E   | 10       | <i>Acer rubrum</i>                          | Red Maple                     | 2"   | 45'+          |       |
| F   | 23       | <i>Acer saccharum</i> 'Balleta' Fall Fiesta | Fall Fiesta Sugar Maple       | 2"   | 45'+          |       |
| G   | 25       | <i>Quercus robur</i>                        | English Oak                   | 2"   | 45'+          |       |
| H   | 6        | <i>Quercus bicolor</i>                      | Swamp White Oak               | 2"   | 45'+          |       |
| Total   | 117      |   |                               |      |               |       |

| MITIGATION PLANTING SCHEDULE-NORTH OF DD (PRESERVED TREES)-96 LOTS |          |   |                            |      |               |       |
|--|----------|---|----------------------------|------|---------------|-------|
| SYMBOL   | QUANTITY | BOTANICAL NAME                              | COMMON NAME                | SIZE | MATURE HEIGHT | Notes |
| PHASE 1 RESIDENTIAL  |          |   |                            |      |               |       |
| A  | 75       | <i>Pinus strobus</i>                        | White Pine                 | 6-8' | 30-40'        |       |
| AM   | 61       | <i>Quercus palustris</i>                    | Pin Oak                    | 2"   | 45'+          |       |
| BM   | 59       | <i>Quercus rubra</i>                        | Northern Red Oak           | 2"   | 45'+          |       |
| CM   | 61       | <i>Quercus bicolor</i>                      | Swamp White Oak            | 2"   | 45'+          |       |
| DM   | 66       | <i>Acer saccharum</i> 'Balleta' Fall Fiesta | Fall Fiesta Sugar Maple    | 2"   | 45'+          |       |
| EM   | 52       | <i>Cercis canadensis</i>                    | Redbud                     | 4'   | 20'           |       |
| FM   | 50       | <i>Crataegus phaenopyrum</i>                | Washington Hawthorn        | 4'   | 20'           |       |
| GM   | 39       | <i>Malus</i> 'Spring Snow'                  | Spring Snow Flowering Crab | 4'   | 25'+          |       |
| HM   | 68       | <i>Acer rubrum</i>                          | Red Maple                  | 2"   | 45'+          |       |
| Total  | 539      |   |                            |      |               |       |

| Revisions: |                |     |
|------------|----------------|-----|
| Date       | Description    | No. |
| 5/13/20    | City Comments  | 1   |
| 9/22/20    | Pool Revisions | 2   |
| 9/20/21    | Pool Revisions | 3   |

Drawn: DD  
Checked: BD

DeLong Landscape Architecture, LLC  
7620 West Bruno Ave  
St. Louis, MO. 63117  
(314) 346-4856  
delong.la@gmail.com  
Missouri State Certificate of Authority: 62013001045

Sheet Title: Phase 1 Landscape Plan  
Sheet No: L-2  
Date: 4/6/2020  
Job #: 177.004