

PROPOSED STORMWATER MANAGEMENT:
 STORMWATER QUANTITY DETENTION FOR THIS PROPOSED DEVELOPMENT WILL BE HANDLED VIA THE EXISTING PERSIMMON POINTE REGIONAL DETENTION BASIN.
 AN ONSITE PROPRIETARY STORMWATER DEVICE WILL BE INSTALLED TO TREAT WATER QUALITY

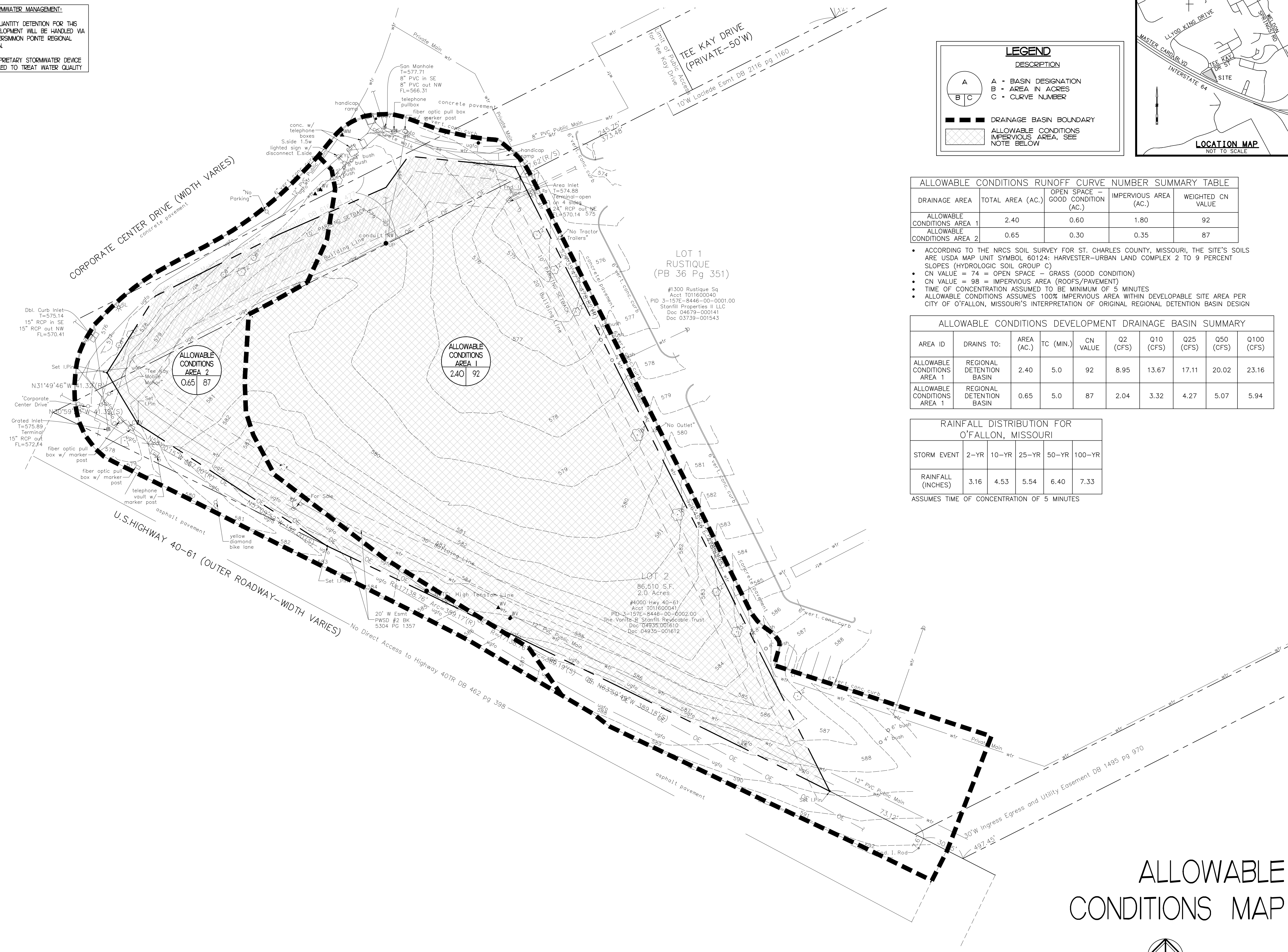

LEGEND

DESCRIPTION

A = BASIN DESIGNATION
 B = AREA IN ACRES
 C = CURVE NUMBER

--- DRAINAGE BASIN BOUNDARY

▨ ALLOWABLE CONDITIONS IMPERVIOUS AREA, SEE NOTE BELOW

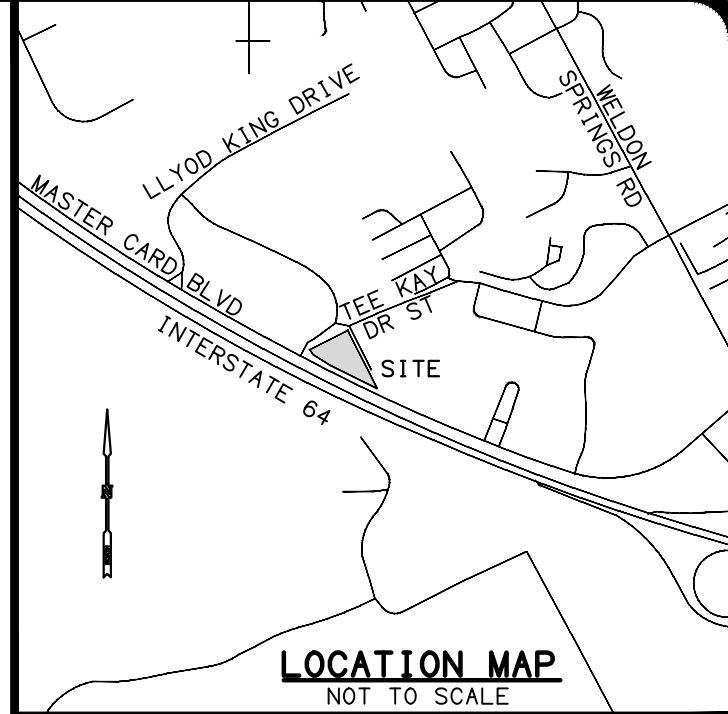

ALLOWABLE CONDITIONS RUNOFF CURVE NUMBER SUMMARY TABLE

DRAINAGE AREA	TOTAL AREA (AC.)	OPEN SPACE - GOOD CONDITION (AC.)	IMPERVIOUS AREA (AC.)	WEIGHTED CN VALUE
ALLOWABLE CONDITIONS AREA 1	2.40	0.60	1.80	92
ALLOWABLE CONDITIONS AREA 2	0.65	0.30	0.35	87

- ACCORDING TO THE NRCS SOIL SURVEY FOR ST. CHARLES COUNTY, MISSOURI, THE SITE'S SOILS ARE USDA MAP UNIT SYMBOL 60124: HARVESTER-URBAN LAND COMPLEX 2 TO 9 PERCENT SLOPES (HYDROLOGIC SOIL GROUP C)
- CN VALUE = 74 = OPEN SPACE - GRASS (GOOD CONDITION)
- CN VALUE = 98 = IMPERVIOUS AREA (ROOFS/PAVEMENT)
- TIME OF CONCENTRATION ASSUMED TO BE MINIMUM OF 5 MINUTES
- ALLOWABLE CONDITIONS ASSUMES 100% IMPERVIOUS AREA WITHIN DEVELOPABLE SITE AREA PER CITY OF O'FALLON, MISSOURI'S INTERPRETATION OF ORIGINAL REGIONAL DETENTION BASIN DESIGN

ALLOWABLE CONDITIONS DEVELOPMENT DRAINAGE BASIN SUMMARY

AREA ID	DRAINS TO:	AREA (AC.)	TC (MIN.)	CN VALUE	Q2 (CFS)	Q10 (CFS)	Q25 (CFS)	Q50 (CFS)	Q100 (CFS)
ALLOWABLE CONDITIONS AREA 1	REGIONAL DETENTION BASIN	2.40	5.0	92	8.95	13.67	17.11	20.02	23.16
ALLOWABLE CONDITIONS AREA 2	REGIONAL DETENTION BASIN	0.65	5.0	87	2.04	3.32	4.27	5.07	5.94

RAINFALL DISTRIBUTION FOR O'FALLON, MISSOURI

STORM EVENT	2-YR	10-YR	25-YR	50-YR	100-YR
RAINFALL (INCHES)	3.16	4.53	5.54	6.40	7.33

ASSUMES TIME OF CONCENTRATION OF 5 MINUTES

REVISIONS BY

PLANS PREPARED BY:
 Charles A. Garcia, P.E.
 Missouri Professional Engineer License #2007025511
 209 West Stone Avenue
 Greenville, South Carolina 29609
 864-233-5497

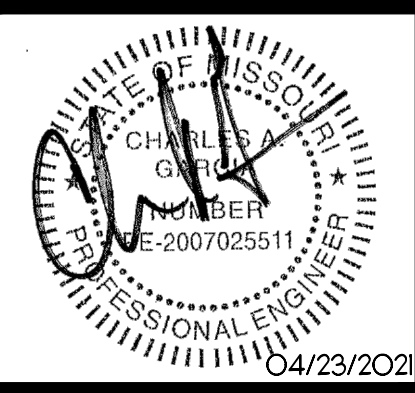

CALIBER COLLISION
 700 CORPORATE CENTRE DRIVE
 O'FALLON, MO 63368
 CROSS DEVELOPMENT CO. OF FALLON, LLC.
 4338 MARSH RIDGE ROAD
 CARROLLTON, TX 75010
 TEL: (214) 614-8252

ALLOWABLE CONDITIONS MAP

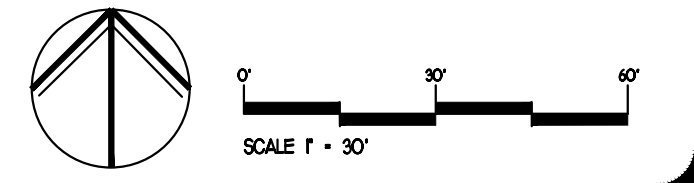

DRAWN: BAC
 CHECKED: TMB
 DATE: 03/19/2021
 SCALE:

DRAWING: 15