

LEGEND		
EXISTING	PROPOSED	DESCRIPTION
wtr	15" W	15" DOMESTIC WATER LINE
wtr	6" F	6" FIRE LINE
wtr	1" IR	1" IRRIGATION WATER LINE
	FD	FIRE HYDRANT
oe	LE	UNDERGROUND ELECTRIC LINE
	UT	UNDERGROUND TELEPHONE LINE
	SD	STORM DRAIN
	SS	SANITARY SEWER LINE
	GAS	GAS LINE
	○	SS MAN-HOLE
	○	SS CLEAN-OUT

**DUCKETT CREEK SANITARY DISTRICT (DCSD) NOTES**

- EXISTING SANITARY SEWER SERVICE SHALL NOT BE INTERRUPTED.
- CONSTRUCTION OF SANITARY SEWERS REQUIRES DCSD INSPECTION. CONTACT DCSD INSPECTION DEPARTMENT AT 636-444-244 TO SCHEDULE AN INSPECTION 48 HOURS ADVANCE NOTICE IS REQUIRED.

**UTILITY CONTACTS**

**WATER:**  
PUBLIC WATER SUPPLY DISTRICT #2  
CONTACT: CHUCK KRADOSKY  
PHONE: (636) 569-3737 EXT. 135

**ELECTRIC:**  
AMEREN MISSOURI  
CONTACT: CUSTOMER CARE  
PHONE: (866) 992-6669

**TELEPHONE/CABLE:**  
AT&T  
CONTACT: CUSTOMER SERVICE  
PHONE: (855) 288-8006

**SEWER:**  
DUCKETT CREEK SANITARY DISTRICT  
CONTACT: MONY RAWLINGS  
PHONE: (636) 498-8056

**GAS:**  
SPIRE, INC.  
CONTACT: MICHAEL LANGAN  
PHONE: (314) 575-4831

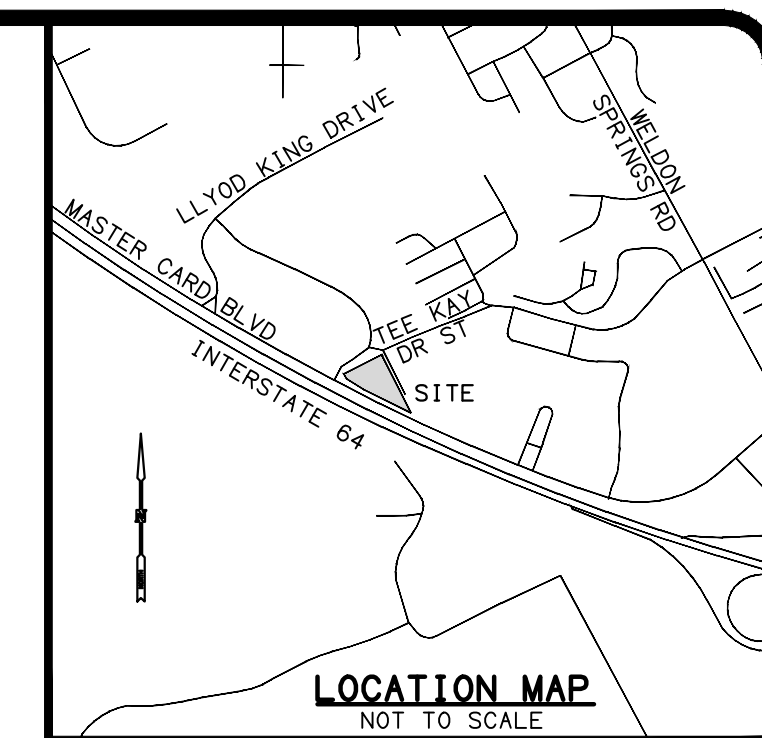

REVISIONS	BY
1	10.17.2019
2	REVISION #2
	TMB

CONTRACTOR SHALL WORK AROUND EXISTING UGPO LINES AND THEY ARE TO REMAIN IN PLACE. CONTRACTOR SHALL COORDINATE CLOSELY WITH UTILITY PROVIDER TO ENSURE THEIR LINES ARE PROTECTED THROUGHOUT CONSTRUCTION. NOTIFY ENGINEER OF RECORD IF FIELD ELEVATIONS VARY FROM WHAT IS SHOWN HEREIN.

CONTRACTOR SHALL WORK AROUND EXISTING UGPO LINES AND THEY ARE TO REMAIN IN PLACE. CONTRACTOR SHALL COORDINATE CLOSELY WITH UTILITY PROVIDER TO ENSURE THEIR LINES ARE PROTECTED THROUGHOUT CONSTRUCTION. NOTIFY ENGINEER OF RECORD IF FIELD ELEVATIONS VARY FROM WHAT IS SHOWN HEREIN.

BEGIN LOWERING/RELOCATION OF EXISTING UNDERGROUND ELECTRIC LINE

REMOVE AND LOWER 260 LINEAR FEET OF EXISTING 12" PVC WATERLINE PER PWS# 2 STANDARD LOWERING DETAIL AND UTILITY PROFILE WITH 12" DP PROFILE TO PROVIDE MINIMUM 42" COVER TO TOP OF PIPE.

CONTRACTOR SHALL WORK AROUND EXISTING UGPO LINES AND THEY ARE TO REMAIN IN PLACE. CONTRACTOR SHALL COORDINATE CLOSELY WITH UTILITY PROVIDER TO ENSURE THEIR LINES ARE PROTECTED THROUGHOUT CONSTRUCTION. NOTIFY ENGINEER OF RECORD IF FIELD ELEVATIONS VARY FROM WHAT IS SHOWN HEREIN.

CONNECT 6" SANITARY SEWER LINE TO EXISTING MANHOLE • INV-566.51 CONNECTION TO BE CORE DRILLED AND INSTALL LINK-SEAL MODULAR SEAL GROUT AROUND CONNECTION TO SEAL TIGHT. MODIFY INVERT TO DRAIN PROPERLY

**UTILITY CROSSING**  
PG-578.3  
SS TOP- 572.67  
SS INV- 570.92  
SD TOP- 568.92  
SD INV- 568.42

**WYE CONNECTION**  
INV-571.03

**PROPOSED CALIBER COLLISION**  
11,582 SF.  
FFE: 581.0'

THE FIRE HYDRANT RELOCATION SHALL TAKE PLACE DURING THE WATER MAIN LOWERING

- KEYNOTES**
- 15" DOMESTIC WATER METER & VALVE IN 36" POLY METER PIT BY PWS# 2 - SEE NOTES AND DETAILS.
  - SANITARY SEWER EXIT (SEE ARCH FOR EXACT LOCATION)
  - 6" PVC PRIVATE SANITARY SEWER LATERAL SEE PLAN FOR SLOPE (SEE ARCH FOR BUILDING ENTRY)
  - SEWER CLEAN-OUT (SEE DETAIL)
  - TRANSFORMER PAD AND METER - SEE DETAIL SEE ELECTRIC SERVICE NOTES THIS SHEET FOR LIST OF RESPONSIBILITIES.
  - UNDERGROUND TELEPHONE & CABLE POINT OF CONNECTION AT VAULT BY AT&T
  - UNDERGROUND ELECTRIC POINT OF CONNECTION AT EXISTING UTILITY POLE BY AMEREN MISSOURI
  - CONTRACTOR TO PROVIDE (4) 35" CONDUIT AND SERVICE FOR SECONDARY UNDERGROUND ELECTRIC UTILITY. (SEE ARCH FOR BUILDING ENTRY)
  - 15" PRIVATE DOMESTIC WATERLINE PER PWS#2 WATER STDS
  - NOT USED
  - GAS SERVICE ENTRY AND METER (SEE ARCH)
  - WATER LINE BEND WITH THRUST BLOCKS 45' UNLESS NOTED OTHERWISE ON THE PLAN SET (SEE DETAIL)
  - TELEPHONE SERVICE ENTRY (SEE ARCH)
  - DOMESTIC WATERLINE ENTRY (SEE ARCH)
  - ELECTRIC SERVICE ENTRY (SEE ARCH FOR EXACT LOCATION)
  - 0-4" PRIMARY ELECTRICAL CONDUIT & PULLWIRE. SEE ELECTRIC SERVICE NOTES THIS SHEET FOR LIST OF RESPONSIBILITIES
  - KNOX BOX PER CITY OF O'FALLON FIRE DEPARTMENT & PWS# 2 STANDARDS
  - 1" RPZ BPP DEVICE IN ABOVE GROUND ENCLOSURE BY CONTRACTOR (SEE DETAIL)
  - 1" PRIVATE IRRIGATION WATERLINE PER PWS# 2 WATER STANDARDS
  - NOT USED
  - 1" GAS SERVICE LINE
  - GAS SERVICE POINT OF CONNECTION SPIRE, INC. TO EXTEND SERVICE FROM MAIN
  - RELOCATED FIRE HYDRANT & VALVE PER PWS# 2
  - SITE LIGHTING, TYPICAL (SEE PHOTOMETRIC)
  - 0-4" TELEPHONE CONDUIT & PULLWIRE BY CONTRACTOR - SERVICE BY AT&T
  - EXISTING FIRE HYDRANT TO REMAIN AND BE UTILIZED FOR THIS PROJECT
  - CONTINUE TO SITE IRRIGATION BY OTHERS
  - SAMPLING WELL (SEE ARCH)
  - SAND/OIL SEPARATOR (SEE ARCH)
  - SANITARY SEWER EXIT FROM DETAIL BAY (SEE ARCH FOR EXACT LOCATION)
  - NOT USED
  - 15" RPZ BACKFLOW PREVENTER DEVICE IN ABOVE GROUND HEATED ENCLOSURE BY CONTRACTOR (SEE DETAIL)
  - 12" X 15" TAP SLEEVE & VALVE PER PWS# 2 STANDARDS
  - NOT USED
  - 15" X 1" TEE & GATE VALVE PER PWS# 2 STANDARDS
  - LOWER PUBLIC WATERLINE AS NECESSARY TO ENSURE ADEQUATE GROUND CLEARANCE IS PROVIDED FOR WATER LINE
  - ELECTRIC LOW VOLTAGE 1" CONDUIT & SERVICE LINE FOR HEATED BPP ENCLOSURE
  - 220 LINEAR FEET OF RELOCATED/LOWERED UNDERGROUND ELECTRIC LINE - COORDINATE WITH LOCAL UTILITY

- UTILITY PLAN NOTES**
- ALL SITE WORK SHALL BE COMPLETED IN ACCORDANCE WITH THE PLANS PREPARED BY FREELAND & KAUFFMAN. CURRENT REQUIREMENTS OF PWS# 2, THE CITY OF O'FALLON, AND ALL OTHER PERTINENT FEDERAL AND STATE LAWS.
  - THE CONTRACTOR SHALL COMPLY AT ALL TIMES WITH APPLICABLE FEDERAL, STATE AND LOCAL LAWS, PROVISIONS, AND POLICES GOVERNING SAFETY AND HEALTH INCLUDING THE FEDERAL CONSTRUCTION SAFETY ACT (PLC) LAW 96-581 FEDERAL REGISTER, CHAPTER XVII PART 1926 OF TITLE 29 REGULATIONS, OCCUPATIONAL SAFETY AND HEALTH REGULATIONS FOR CONSTRUCTION, AND SUBSEQUENT PUBLICATIONS UPDATING THESE REGULATIONS.
  - THE CONTRACTOR SHALL BE RESPONSIBLE FOR EXAMINING THE AREAS AND CONDITIONS UNDER WHICH THE PROJECT IS TO BE CONSTRUCTED PRIOR TO THE SUBMISSION OF A BID. SUBMISSION OF A BID SHALL BE CONSIDERED TO MEAN THE CONTRACTOR HAS REVIEWED THE SITE AND IS FAMILIAR WITH CONDITIONS AND CONSTRAINTS OF THE SITE.
  - BEFORE EXCAVATION ALL UNDERGROUND UTILITIES SHALL BE LOCATED IN THE FIELD BY THE PROPER AUTHORITIES. THE CONTRACTOR SHALL NOTIFY "CALL BEFORE YOU DIG" AT 811 THE LOCATION OF ALL UTILITIES AND UNDERGROUND STRUCTURES ARE APPROXIMATE AND MAY NOT ALL BE SHOWN. IT IS THE RESPONSIBILITY OF THE CONTRACTOR TO DETERMINE THE EXISTENCE AND EXACT LOCATION OF ALL EXISTING UTILITIES.
  - IT IS THE RESPONSIBILITY OF THE CONTRACTOR TO BID AND PERFORM ALL UTILITY WORK IN COMPLIANCE TO ALL APPLICABLE LOCAL AND STATE CODES AND REGULATIONS.
  - THE CONTRACTOR SHALL BE RESPONSIBLE FOR ALL FEES ASSOCIATED WITH THE INSTALLATION, INSPECTION, TESTING AND FINAL ACCEPTANCE OF ALL PROPOSED UTILITIES.
  - CONTRACTOR SHALL COORDINATE WITH THE APPROPRIATE UTILITY COMPANY ON THE ADDITION, REMOVAL AND/OR RELOCATION OF UTILITIES AND UTILITY POLES AND THE EXTENSION OF ALL PROPOSED UTILITIES TO THE BUILDING.
  - ALL UTILITIES SHALL BE INSTALLED IN ACCORDANCE WITH THE SPECIFICATIONS OF THE RESPECTIVE UTILITY COMPANY. IT IS THE RESPONSIBILITY OF THE CONTRACTOR TO ENSURE ALL UTILITIES ARE INSTALLED CORRECTLY TO MEET PROJECT REQUIREMENTS WHETHER PERFORMED BY THE CONTRACTOR OR NOT.
  - A SEALED AS-BUILT DRAWING OF NEW UTILITY SERVICES SHALL BE PREPARED BY THE ENGINEER/SURVEYOR AND SUBMITTED TO PWS# 2 UPON COMPLETION & PRIOR TO ACTIVATION OF THE PROJECT.
  - REFER TO THE BUILDING PLANS FOR ALL CONDUIT SIZES, NUMBER AND LOCATIONS FOR SERVICE TO THE SIGN AND SITE LIGHT POLES. COORDINATE FINAL CONDUIT LOCATIONS WITH THE OWNER.
  - CONTRACTOR SHALL COORDINATE WITH THE OWNER ON CONDUIT ROUTE TO THE STORE FROM THE TRANSFORMER AND/OR SERVICE UTILITY POLE FOR TELEPHONE AND ELECTRICAL SERVICES.
  - ALL FILL MATERIAL IS TO BE IN PLACE AND COMPACTED PRIOR TO INSTALLATION OF PROPOSED UTILITIES.
  - CONTRACTOR SHALL NOTIFY THE UTILITY COMPANY'S INSPECTORS 72 HOURS BEFORE CONNECTION OR DEMOLITION OF ANY EXISTING LINE.
  - MATERIALS AND WORKMANSHIP SHALL CONFORM WITH THE PWS# 2 WATER STANDARDS AND SPECIFICATIONS AND DUCKETT CREEK SANITARY DISTRICT SEWER STANDARDS AND SPECIFICATIONS.
  - MINIMUM TRENCH WIDTH SHALL BE 2 FEET.
  - WATER LINES TO HAVE MECHANICAL JOINTS WITH THRUST BLOCKING.
  - ALL UTILITIES SHOULD BE KEPT TEN (10') APART (PARALLEL) OR WHEN CROSSING 18" VERTICAL CLEARANCE (OUTSIDE EDGE OF PIPE TO OUTSIDE EDGE OF PIPE).
  - MAINTAIN A MINIMUM OF 3'-0" COVER ON ALL WATERLINES.
  - IN THE EVENT OF A VERTICAL CROSSING LESS THAN 18" BETWEEN WATERLINES AND SANITARY LINES (EXISTING AND PROPOSED), THE SANITARY LINE SHALL BE DUCTILE IRON PIPE WITH MECHANICAL JOINTS AT LEAST 10 FEET ON BOTH SIDES OF CROSSING. THE WATERLINE SHALL HAVE MECHANICAL JOINTS WITH APPROPRIATE THRUST BLOCKING AS REQUIRED MEETING REQUIREMENTS OF ANSI A2101 OR ANSI Z11 (AWWA C-90) CLASS 50.
  - ALL LINES UNDERGROUND SHALL BE INSTALLED, INSPECTED AND APPROVED BEFORE BACKFILLING.
  - ALL CONCRETE FOR ENCASUREMENTS SHALL HAVE A MINIMUM 28 DAY COMPRESSION STRENGTH AT 3000 PSL.
  - REFER TO INTERIOR PLUMBING DRAWINGS FOR TEN' OF ALL UTILITIES.
  - 1" REDUCED PRESSURE PRINCIPLE BACKFLOW PREVENTION ASSEMBLY INSTALLED ABOVE-GROUND WITHIN HEATED INSULATED ENCLOSURE PER PWS# 2 REQUIREMENTS. ENCLOSURE TO INCLUDE DRAIN PORT(S) FOR DISCHARGE WATER PER PWS# 2 REQUIREMENTS. SEE DETAIL ON UTILITY DETAILS SHEET.

- PWS# 2 NOTES**
- THE PUBLIC WATER SERVICE DISTRICT #2 WILL REQUIRE A ONE (1) WEEK NOTICE BEFORE THE START OF CONSTRUCTION. THE CONTRACTOR SHALL BE RESPONSIBLE FOR OBTAINING ANY & ALL CITY OF O'FALLON, ST. CHARLES COUNTY, OR MODOT PERMITS REQUIRED TO WORK ALONG THE ROADWAYS.
  - ALL WATER MAINS, VALVES, FITTINGS, FIRE HYDRANTS, AND RELATED ITEMS ARE TO BE INSTALLED IN ACCORDANCE WITH THE CURRENT PWS#2 OF ST. CHARLES COUNTY GUIDELINES AND SPECIFICATIONS AS APPROVED BY MODOT REVIEW NO. 6050808-3.
  - ALL WATER SERVICE LINES, FIRE LINES, AND PRIVATE WATER MAINS MUST BE INSTALLED PER PWS# 2 SPECIFICATIONS.
  - ALL METER PITS/ VAULTS MUST BE INSTALLED IN "GREEN SPACE" PER THE WATER DISTRICT'S SPECIFICATIONS.
  - ANY CONNECTIONS TO AN EXISTING WATER MAIN MUST BE MADE PER THE PWS# 2 SPECIFICATIONS.
  - ALL PRIVATE FIRE HYDRANTS ARE TO BE PAINTED RED PER PWS# 2 SPECIFICATIONS.

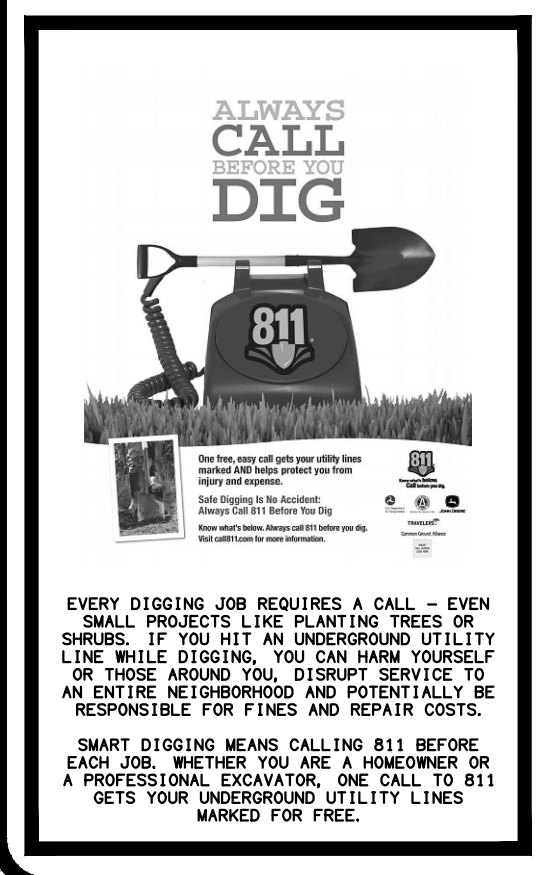
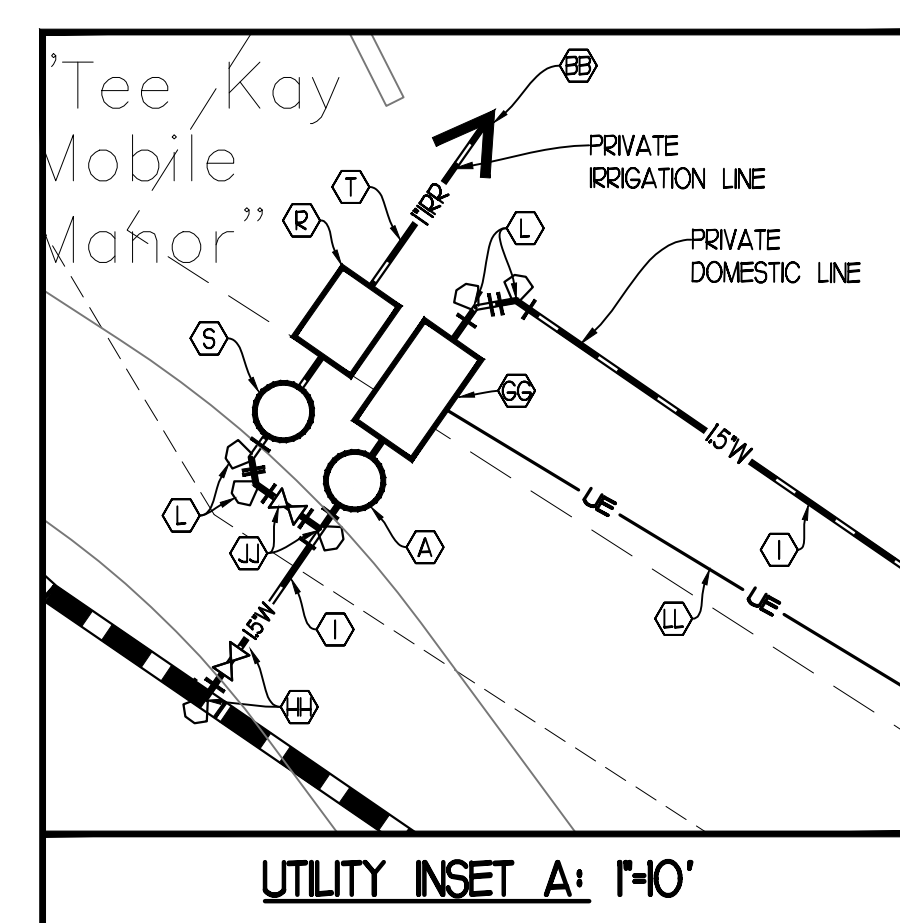

**UTILITY PLAN**

SCALE: 1" = 30'

**PLANS PREPARED BY:**  
Charles A. Garcia, P.E.  
Missouri Professional Engineering License #2007025511  
209 West Stone Avenue  
Greenville, South Carolina 29609  
864-233-5497

**PROFESSIONAL SEAL:**  
Charles A. Garcia, P.E.  
Missouri Professional Engineering License #2007025511  
04/23/2021

**CALIBER COLLISION**  
700 CORPORATE CENTRE DRIVE  
O'FALLON, MO 63368  
CROSS DEVELOPMENT CO. OF O'FALLON, LLC.  
4838 MARSH RIDGE ROAD  
CARRHOLLTON, TX 75010  
TEL: (214) 614-8252

DRAWN
BAC
CHECKED
TMB
DATE
03/19/2021
SCALE
DRAWING
20