

1" = 10'
1" = 50'

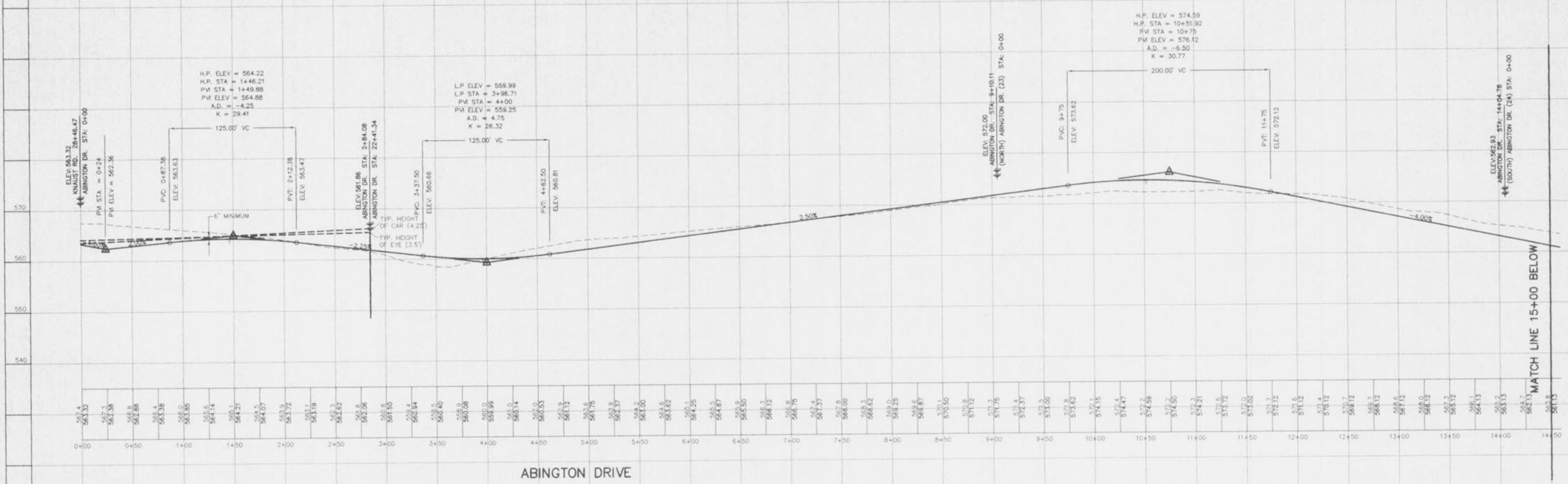

ABINGTON DRIVE

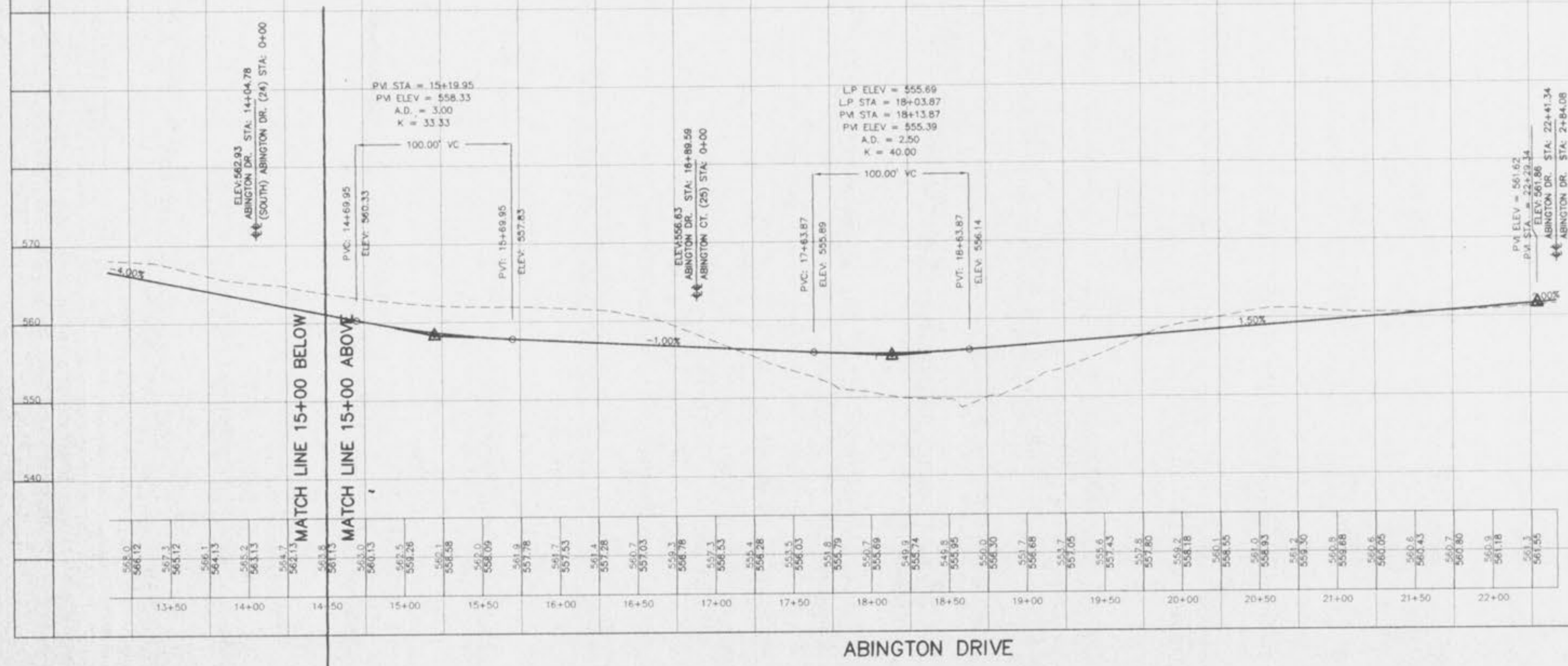

ABINGTON DRIVE

STRUCTURE	STREET	STATION	OFFSET
DCI-2	LUNENBURG DRIVE	37+45.00	17.25
DCI-3	LUNENBURG DRIVE	37+45.00	-17.25
DCI-8	WILLIAMSTOWN DRIVE	11+02.66	-17.25
DCI-9	WILLIAMSTOWN DRIVE	10+96.71	17.25
CI-10	CHANCE DRIVE	0+78.46	17.25
DCI-11	(RELOCATED) KNAUST ROAD	16+14.44	26.00
DCI-16	LUNENBURG DRIVE	13+75.00	-17.25
DCI-18	LUNENBURG DRIVE	14+07.95	17.25
DCI-18	CONSTABLE COURT	0+52.40	17.25
DCI-19	CONSTABLE COURT	0+65.85	-17.25
CI-21	LUNENBURG DRIVE	9+36.37	-17.25
CI-22	LUNENBURG DRIVE	9+36.37	17.25
CI-27	WILLIAMSTOWN DRIVE	6+88.45	-17.25
CI-28	WILLIAMSTOWN DRIVE	6+88.45	17.25
DCI-31	(RELOCATED) KNAUST ROAD	21+55.00	26.00
CI-33.1	(RELOCATED) KNAUST ROAD	23+24.02	-26.00
DCI-33.2	(RELOCATED) KNAUST ROAD	25+50.84	-26.00
CI-35	ABINGTON DRIVE	18+03.87	17.25
CI-37	ABINGTON COURT	0+54.43	-17.25
CI-38	ABINGTON DRIVE	15+69.93	-17.25
CI-40	ABINGTON DRIVE	14+61.51	-17.25
CI-41	ABINGTON DRIVE	13+50.51	-17.25
CI-42	ABINGTON DRIVE	13+50.51	17.25
CI-47	ABINGTON DRIVE	3+86.71	-17.25
CI-48	ABINGTON DRIVE	3+86.71	17.25
CI-49	ABINGTON DRIVE	6+24.35	17.25
SOI-51	ABINGTON DRIVE	8+52.99	17.25
CI-55	ABINGTON DRIVE	6+24.35	-17.25
CI-59	LUNENBURG DRIVE	13+05.68	17.25
CI-61	CHANCE DRIVE	0+78.46	-17.25
CI-63	OLD KNAUST ROAD	2+37.50	-17.25
DCI-64	OLD KNAUST ROAD	2+37.50	17.25
CI-66	(SOUTH) ABINGTON DRIVE	1+70.94	17.25
CI-70	LUNENBURG DRIVE	6+69.68	-17.25
CI-74	LUNENBURG DRIVE	2+88.33	-17.25
CI-75	LUNENBURG DRIVE	2+81.33	17.25
CI-77	WILLIAMSTOWN DRIVE	41+03.56	17.25
CI-78	WILLIAMSTOWN DRIVE	41+03.56	-17.25
CI-79	LUNENBURG DRIVE	32+56.67	17.25
CI-80	LUNENBURG DRIVE	32+56.67	-17.25
CI-86	LUNENBURG DRIVE	25+06.56	-17.25
CI-87	LUNENBURG DRIVE	25+06.56	17.25
CI-90	WILLIAMSTOWN DRIVE	25+73.60	-17.25
CI-91	WILLIAMSTOWN DRIVE	25+74.50	17.25
DCI-99	WILLIAMSTOWN DRIVE	38+43.20	-17.25
DCI-100	WILLIAMSTOWN DRIVE	38+43.20	17.25
CI-102	LUNENBURG DRIVE	28+44.50	-17.25
DCI-103	LUNENBURG DRIVE	28+44.50	17.25
CI-106	WILLIAMSTOWN DRIVE	23+54.94	-17.25
CI-107	WILLIAMSTOWN DRIVE	23+54.94	17.25
CI-107.1	WILLIAMSTOWN COURT	9+53.99	17.25
CI-107.2	WILLIAMSTOWN COURT	0+50.45	-17.25
DCI-114	CRANBROOKE COURT	2+37.64	17.25

