

Architect
Forum Studio
 Structural Engineer
Alper Audi
 Fire Protection Engineer
 Plumbing Engineer
 Mechanical Engineer
 Electrical Engineer

CLAYCO
 CLAYCO CONSTRUCTION COMPANY
 2198 Inverball Business Center Dr.
 St. Louis, MO 63114
 Ph 314.428.5100 Fx 314.428.3185

TRISTAR
 TRISTAR BUSINESS COMMUNITIES
 13397 Lakeloft Drive
 St. Louis, MO 63045
 Ph 314.291.0814

citimortgage
 Progress Point O'Fallon, Mo

DRAWING ISSUE / REVISION

No.	Description	Date
1	PROGRESS SET 1	01-07-02
2	FOR INFO/PERMIT Pkg (INFORMATION ONLY)	01-18-02
3	ISSUE	01-31-02
4	PROGRESS SET 3	03-19-02
5	CITY COMMENTS	04-18-02
6	CITY COMMENTS	04-25-02

The Professional Engineers seal affixed to this sheet indicates that the named Engineer has prepared or directed the preparation of the material shown only on this sheet. Other drawings and documents not exhibiting this seal shall not be considered prepared by or the responsibility of the undersigned.

STORM AND SANITARY SEWER PROFILES

Sheet No. **C6**
 Scale: 1"=40'
 Date: 1-19-02
 Drawn by: J.A.C.
 Checked by: J.A.C.
 Date: 2-20-02

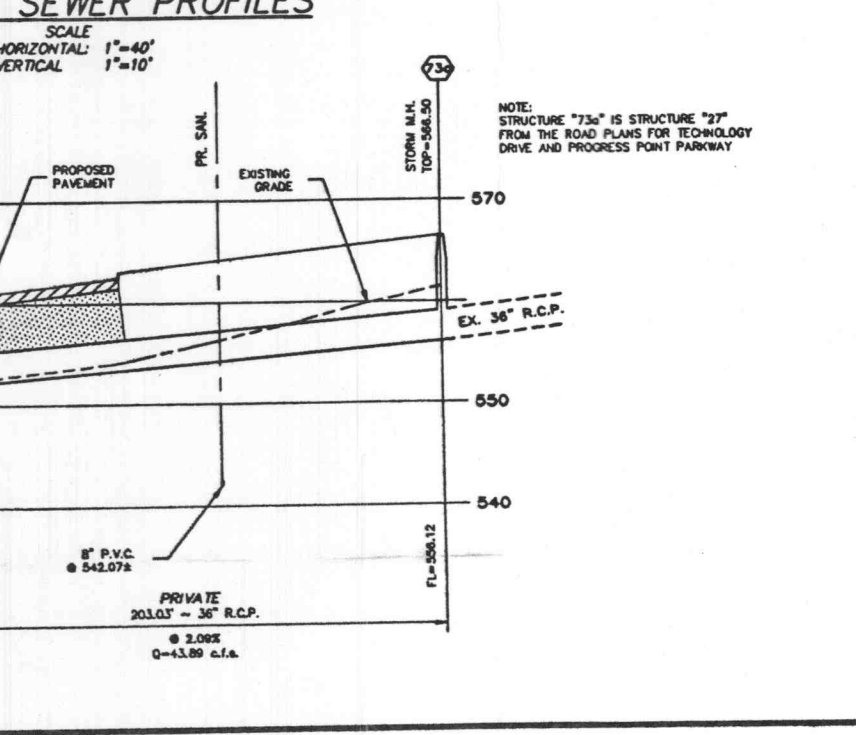
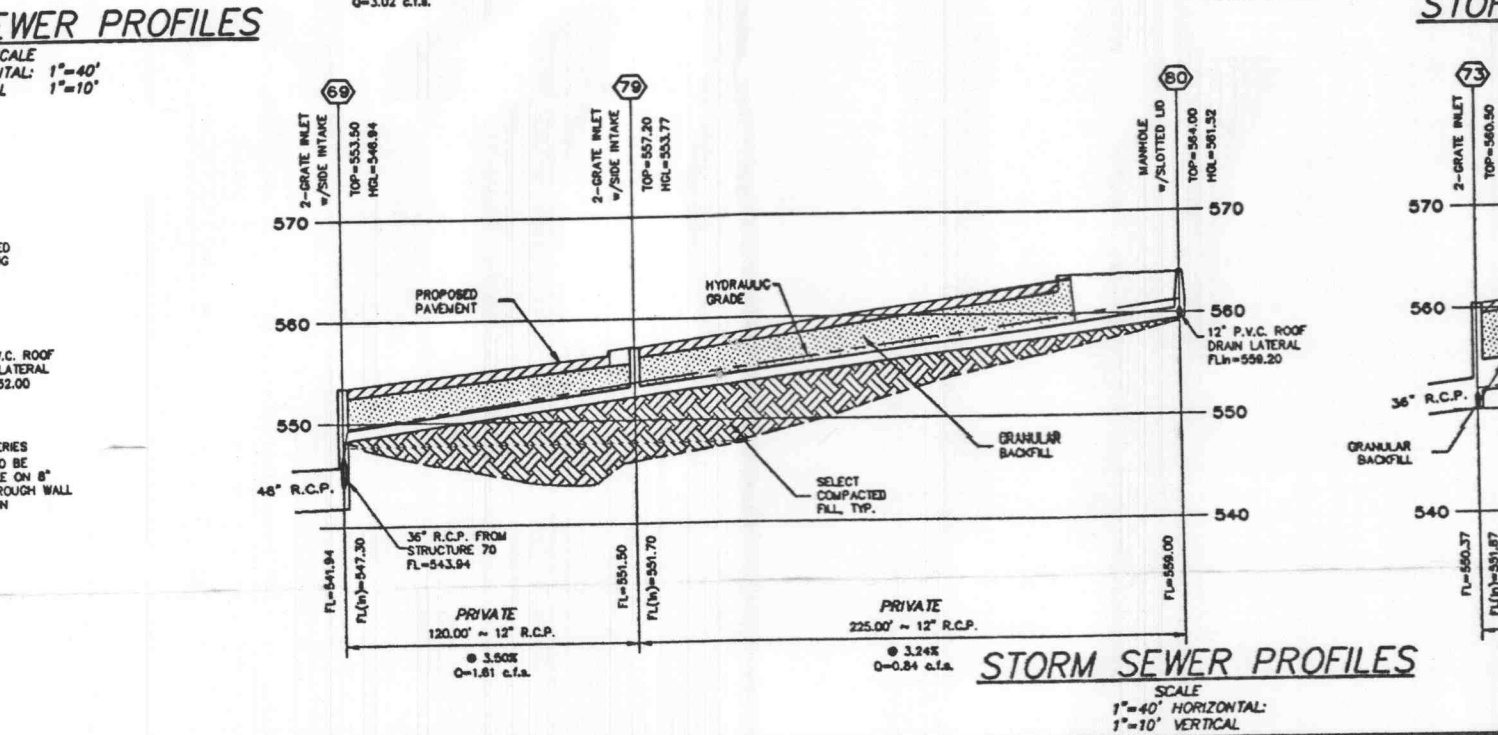
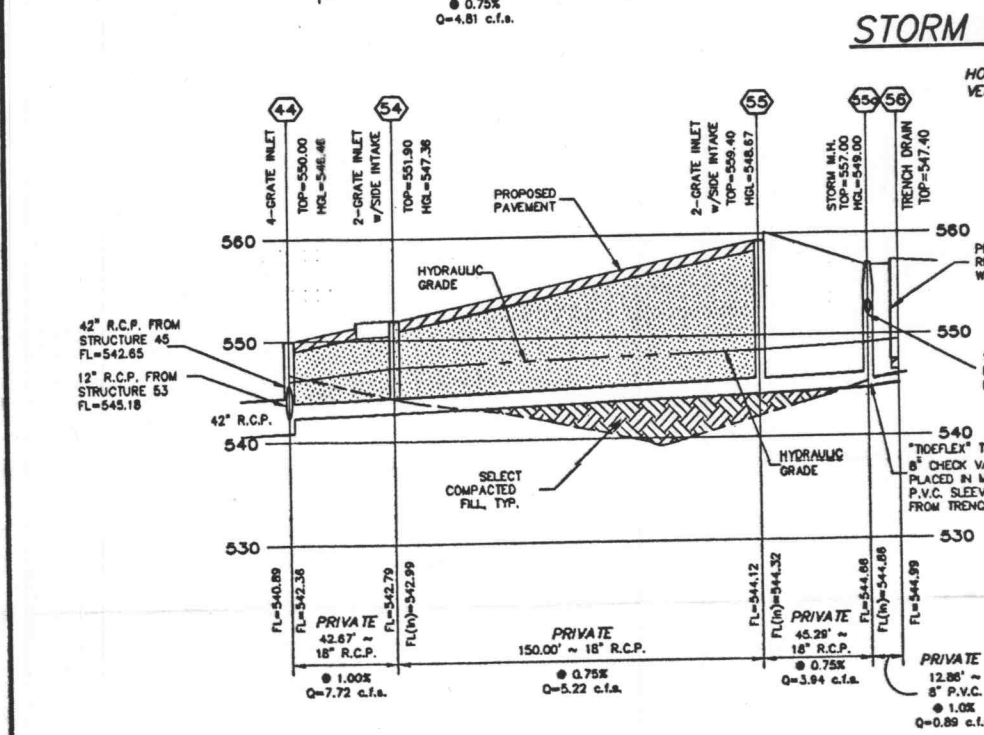
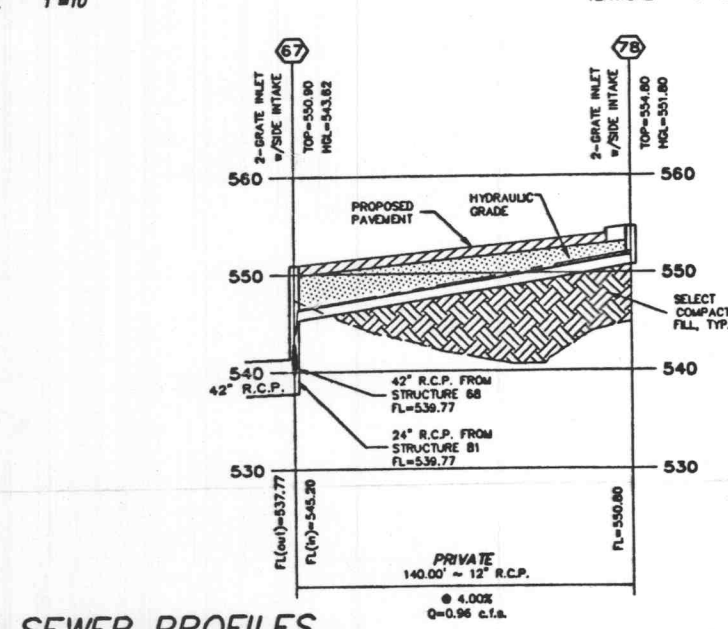
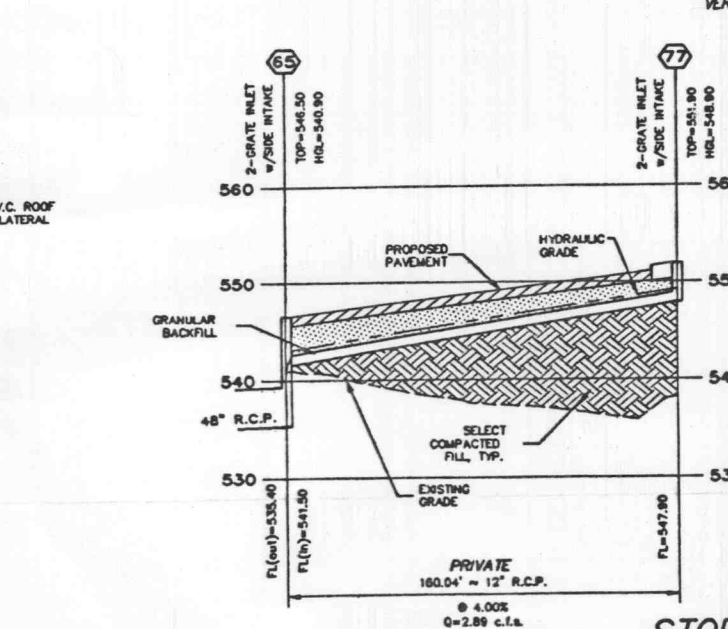
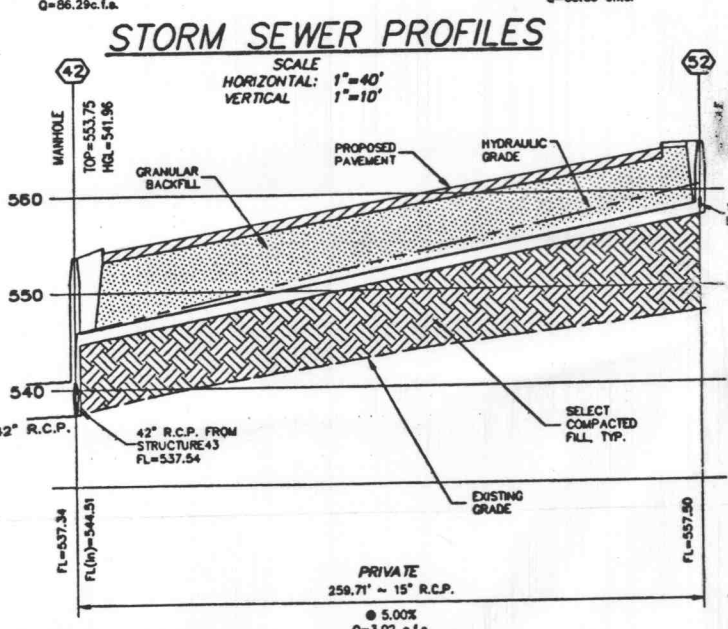
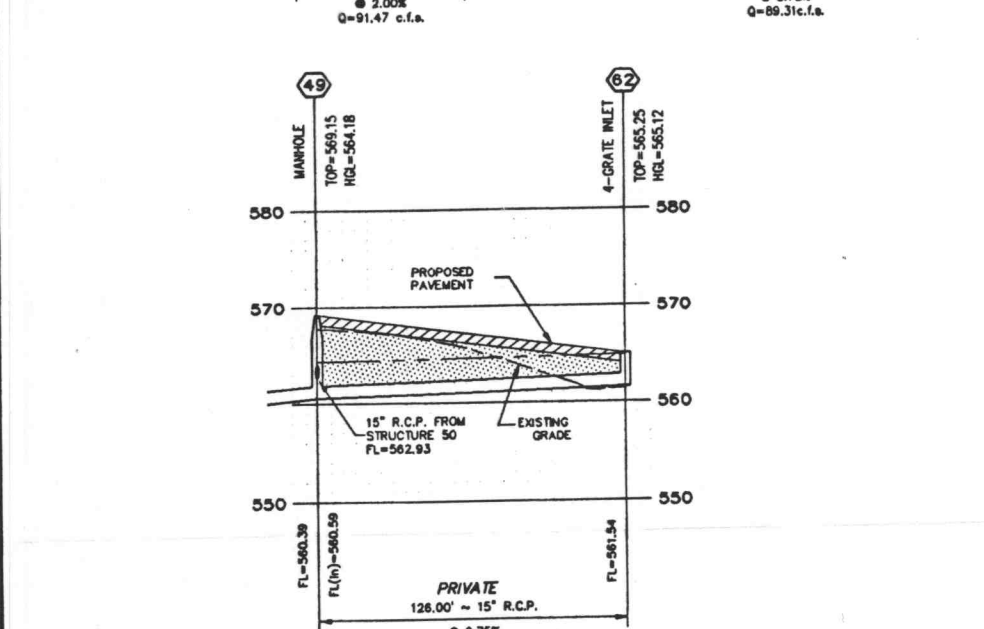
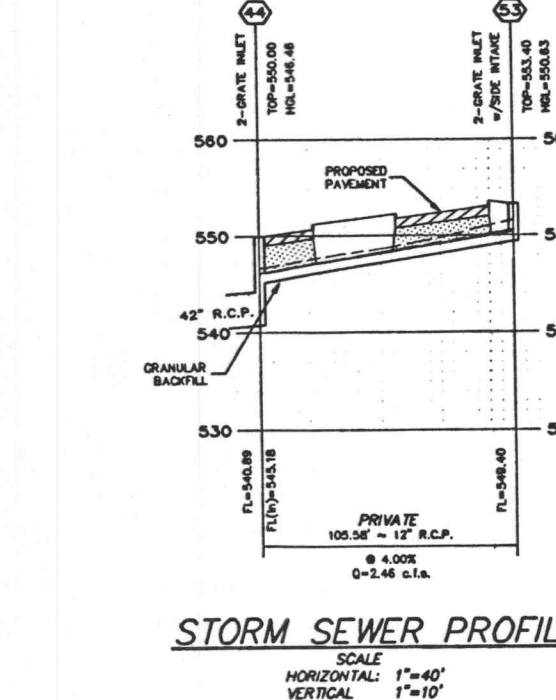
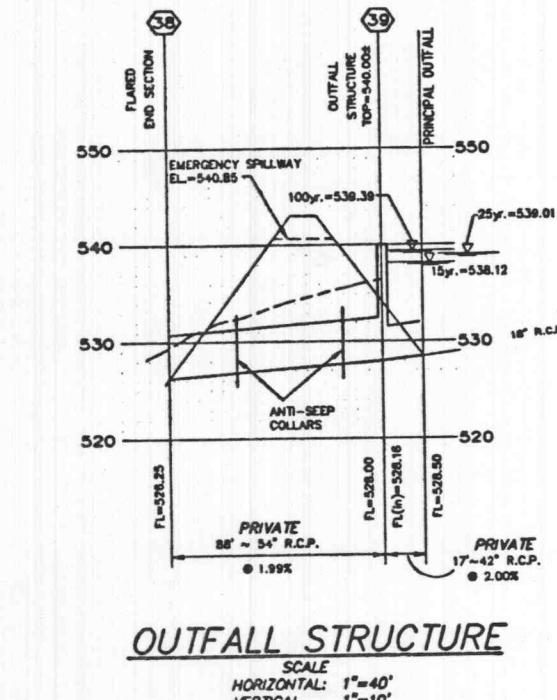
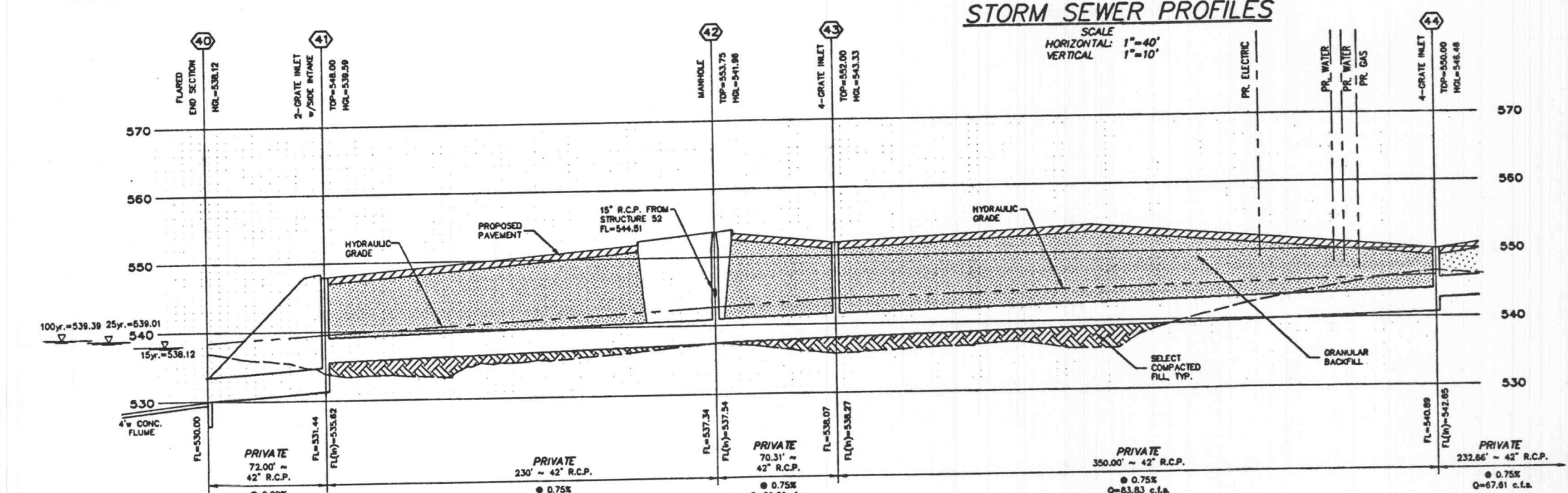
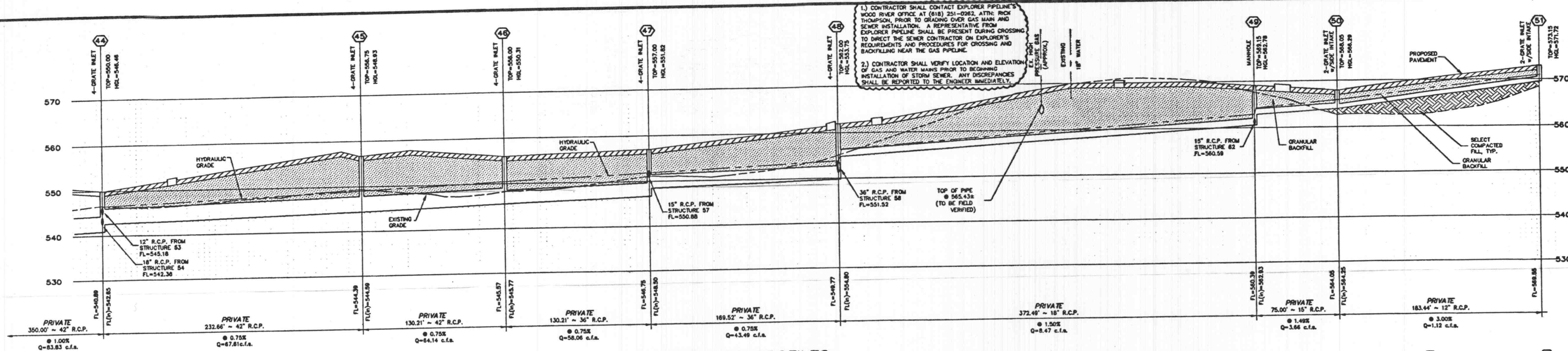

NOTE: STRUCTURE "73" IS STRUCTURE "73" FROM THE ROAD PLANS FOR TECHNOLOGY DRIVE AND PROGRESS POINT PARKWAY