

PLAN VIEW - RETAINING WALL
AT DOCK AREA
SCALE: 1"=40'

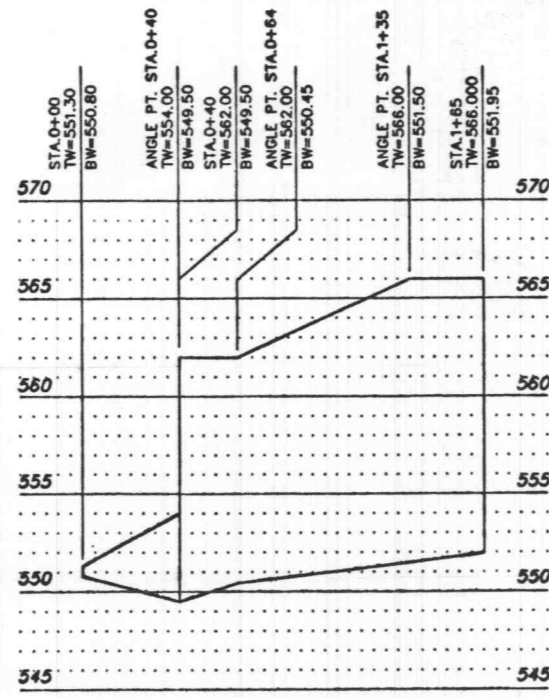

NORTH WALL - DOCK AREA

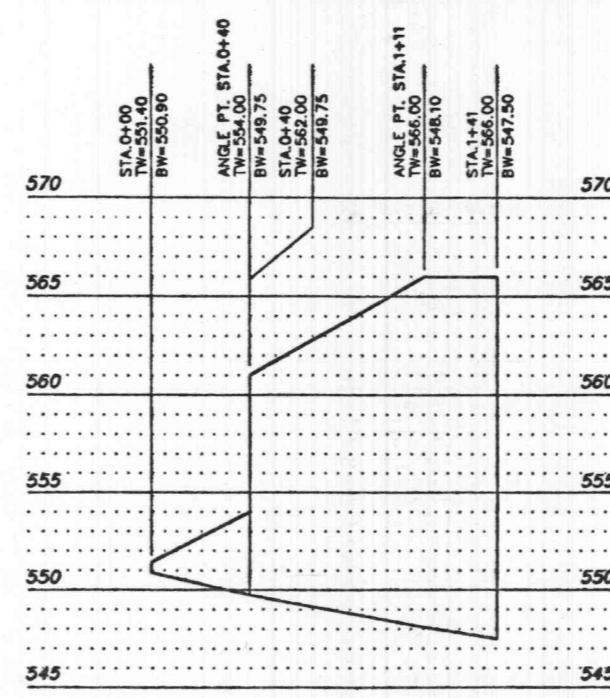

SOUTH WALL - DOCK AREA

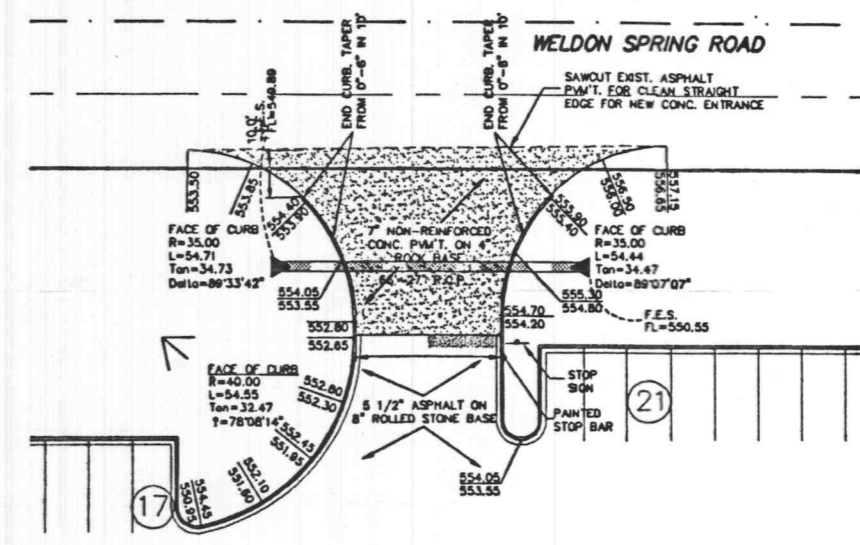

ENTRANCE WARPING
NORTH ENTRANCE - WELDON SPRING ROAD
SCALE: 1"=20'

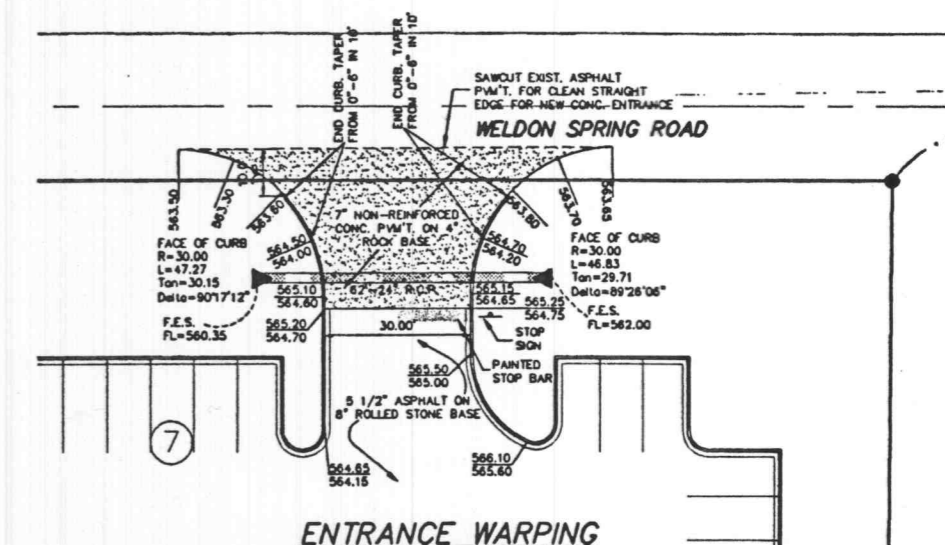

ENTRANCE WARPING
SOUTH ENTRANCE - WELDON SPRING ROAD
SCALE: 1"=20'

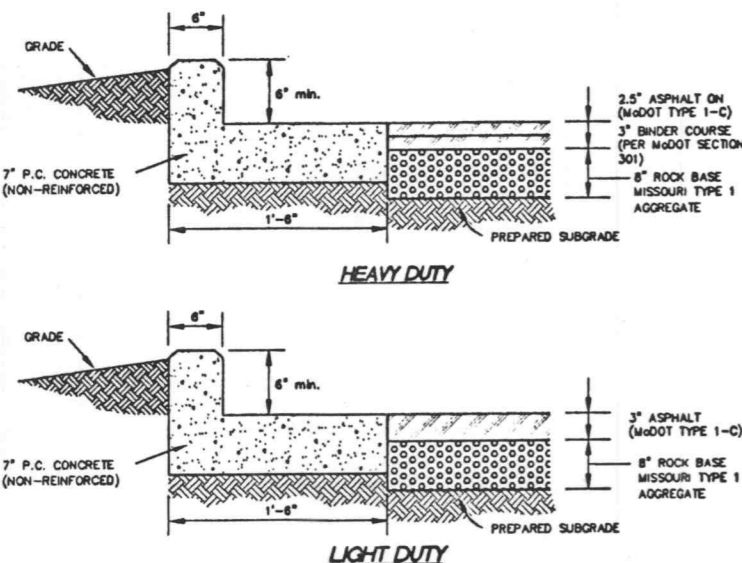

HEAVY DUTY
LIGHT DUTY
CURB AND PAVEMENT DETAIL
(FOR USE ON-SITE)

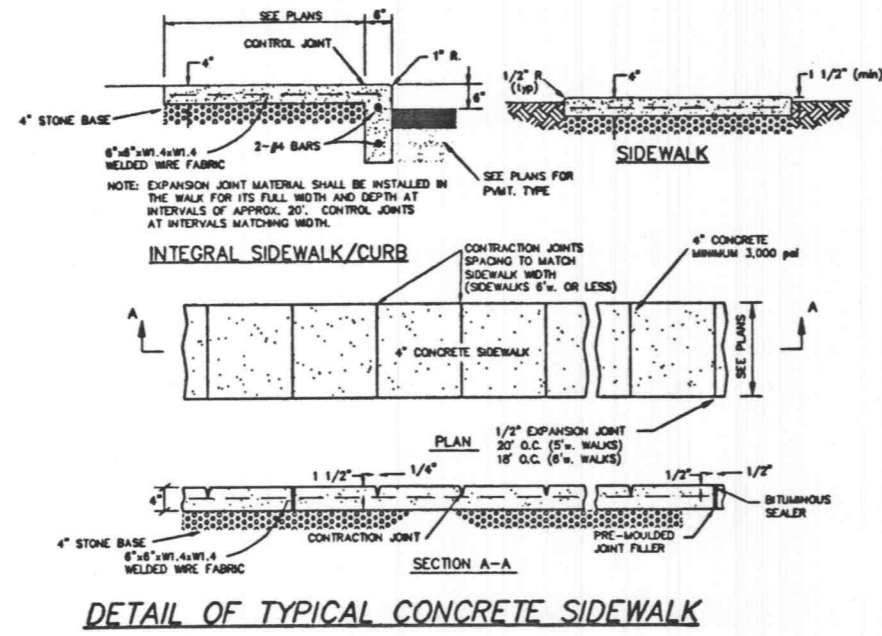

DETAIL OF TYPICAL CONCRETE SIDEWALK

NOTES:

1. ALL CONCRETE SHALL BE MIN. FC=3000 P.S.I. (UNLESS OTHERWISE NOTED)
2. ANY UNSATURABLE SOIL (AS DETERMINED BY SOILS ENGINEER) BELOW STRUCTURE SHALL BE REMOVED AND REPLACED WITH SELECT EARTHEN MATERIAL COMPACTED IN PLACE WITH VIBRATORY TAMPER.
3. ALL EXPOSED CONCRETE EDGES TO HAVE 3/4" CHAMFER.
4. DIMENSIONS SHOWN ARE TO FACE OF CURB.

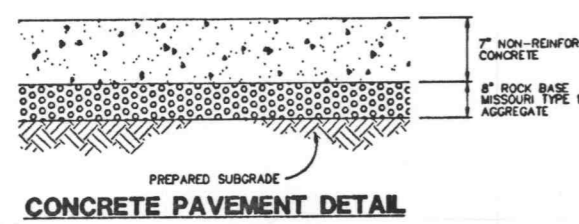

CONCRETE PAVEMENT DETAIL



ACCESSIBLE PARKING SIGN
(N.L.S.)

NOTE: SIDEWALKS, CURB RAMPS, RAMPS AND ACCESSIBLE PARKING SPACES SHALL BE CONSTRUCTED IN ACCORDANCE WITH THE CURRENT APPROVED "AMERICAN WITH DISABILITIES ACT ACCESSIBILITY GUIDELINES (ADAAG)" ALONG WITH THE REQUIRED GRADING, CONSTRUCTION MATERIALS, SPECIFICATIONS AND SIGNAGE. IF ANY CONFLICT OCCURS BETWEEN THE ADAAG GUIDELINES AND THE INFORMATION ON THE PLANS, THE ADAAG GUIDELINES SHALL TAKE PRECEDENCE AND THE CONTRACTOR SHALL NOTIFY THE PROJECT ENGINEER PRIOR TO ANY CONSTRUCTION.



HANDICAP SIGN
(N.L.S.)

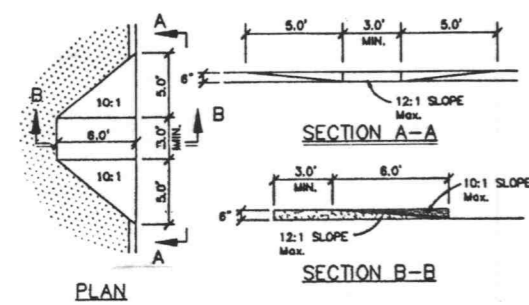

HANDICAP RAMP DETAIL
(N.L.S.)

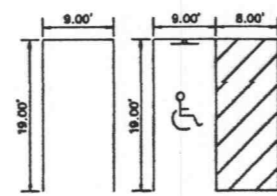

TYPICAL PARKING STALLS
(N.L.S.)

- NOTES
1. RETAINING WALL PROFILES SHOWN FOR COORDINATION PURPOSES AND FOR GRADING. REFER TO STRUCTURAL DRAWINGS FOR CONSTRUCTION DETAILS

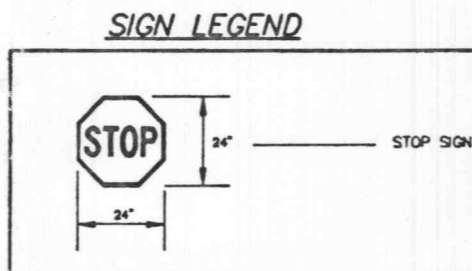

SIGN LEGEND

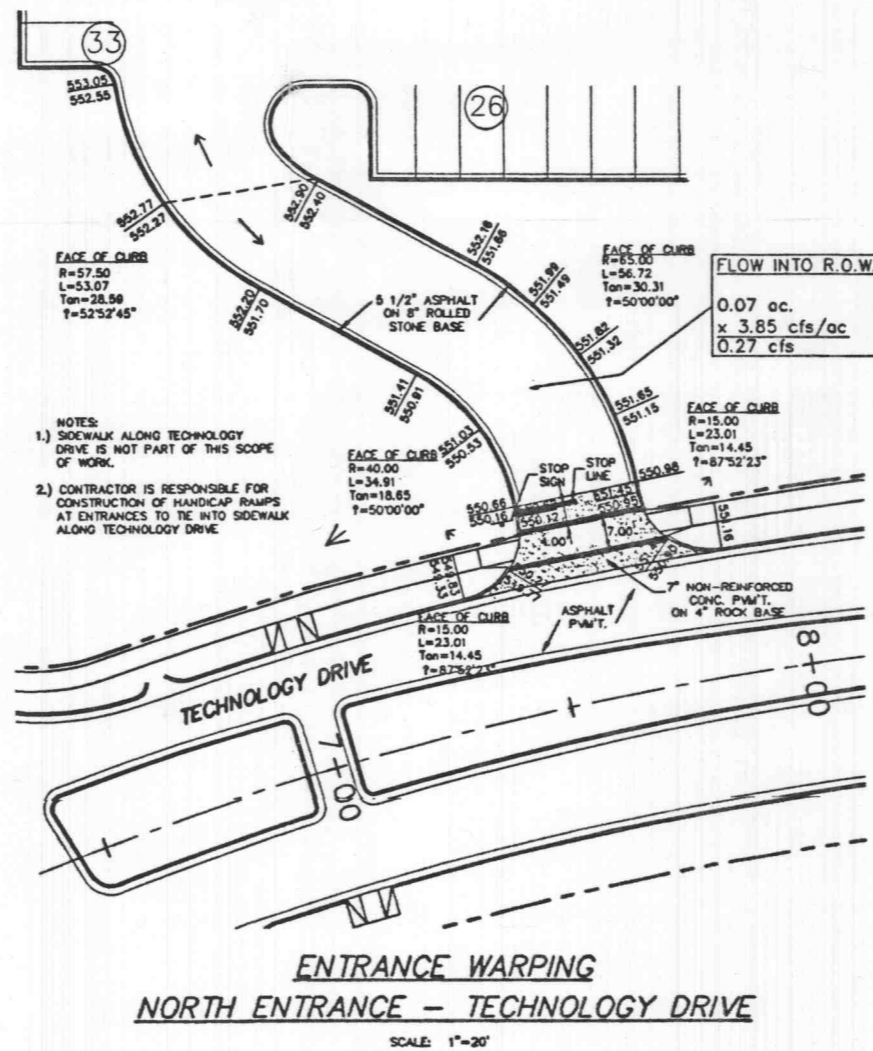

ENTRANCE WARPING
NORTH ENTRANCE - TECHNOLOGY DRIVE
SCALE: 1"=20'

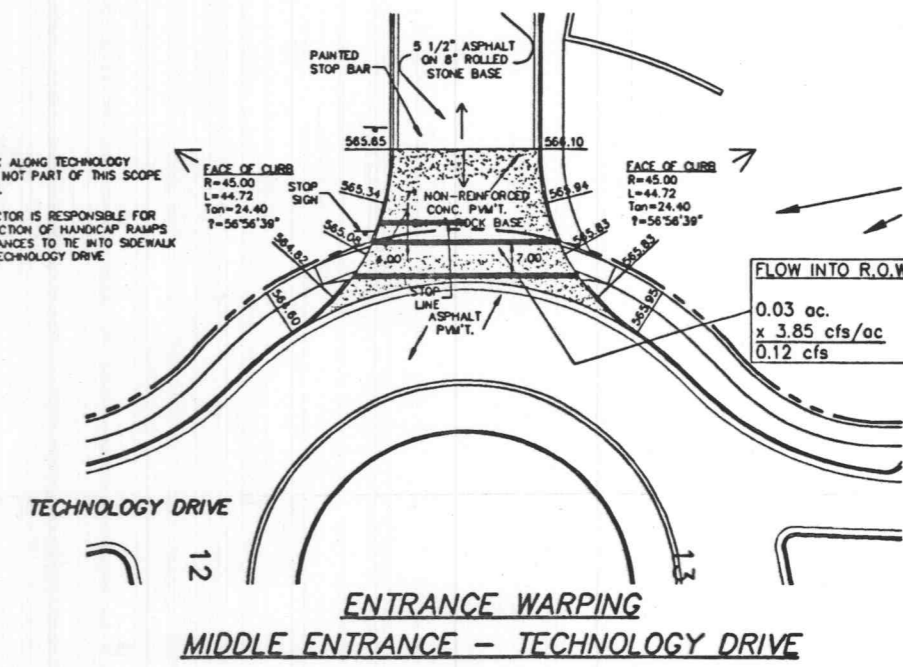

ENTRANCE WARPING
MIDDLE ENTRANCE - TECHNOLOGY DRIVE
SCALE: 1"=20'

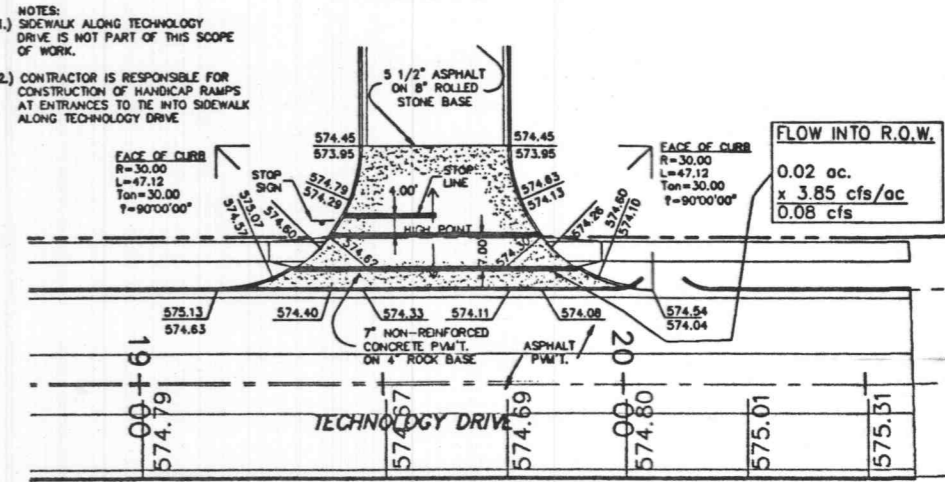

ENTRANCE WARPING
SOUTH ENTRANCE - TECHNOLOGY DRIVE
SCALE: 1"=20'



Forum Studio
Alper Audi
Planning Engineer
Mechanical Engineer
Electrical Engineer

CLAYCO CONSTRUCTION COMPANY
2199 Innerbelt Business Center Dr.
St. Louis, MO 63114
Ph 314.429.5100 Fx 314.429.3165

TRISTAR BUSINESS COMMUNITIES
13397 Lakefront Drive
St. Louis, MO 63045
Ph 314.291.0814

citimortgage
Progress Point O'Fallon, MO

Rev. No.	Description	Date
1	PROGRESS SET 1	01-07-02
2	FDN (NO/PERMIT PKG (INFORMATION ONLY)	01-18-02
3	ISSUE	01-31-02
4	PROGRESS SET 3	03-18-02
5	CITY COMMENTS	04-18-02
6	CITY COMMENTS	04-28-02

The Professional Engineers seal affixed to this sheet indicates that the named Engineer has prepared or directed the preparation of the information on this sheet. Other drawings and documents not exhibiting this seal shall not be considered prepared by or the responsibility of the undersigned.

Drawing Title:	PAVEMENT DETAILS
Drawing No.:	C11
Scale:	1"=40'
Drawn By:	P.J.K.
Check By:	G.M.R.
Date:	1-18-02
Sheet No.:	205-2180.1