



Revisions	
CONSTRUCTION ISSUE	DECEMBER 5, 1997

Project No.	96036
Date	SEPT. 4, 1997
Designed	
Drawn	MAG3
Drawing No.	D-12

**DEMO KEY NOTES**

- ⊠ REMOVE PARTITION, OR WALL, AND ALL ELECTRICAL CONDUIT AND WIRING BACK TO PANEL -- AS SHOWN AS DASHED LINES ON PLAN. (PROTECT ALL EXISTING TERRAZZO FLOORING TO REMAIN IN PLACE).
- ⊠ REMOVE DOOR AND FRAME.
- ⊠ REMOVE DOOR AND FRAME AND SAVE FOR REUSE.
- ⊠ REMOVE LAV, COLD WATER, HOT WATER, SANITARY PIPES AND ALL PIPING BELOW FLOOR.
- ⊠ REMOVE WINDOW FRAME, CAULK AND SILL.
- ⊠ REMOVE CASEWORK - CAP ALL PLUMBING CONNECTION WHERE APPLICABLE.
- ⊠ NOT USED
- ⊠ REMOVE WOOD WORK / CASE WORK AND SAVE FOR RE-INSTALLATION.
- ⊠ EXISTING DOORS TO REMAIN.
- ⊠ REMOVE COUNTERTOP.
- ⊠ NOT USED
- ⊠ NOT USED
- ⊠ NOT USED
- ⊠ REMOVE TOILET STALL PARTITIONS.
- ⊠ NOT USED
- ⊠ NOT USED
- ⊠ REMOVE WATER CLOSET, COLD WATER, AND SANITARY, AND PIPING BELOW FLOOR -- IF MARBLE TOILET PARTITIONS EXIST, REMOVE (INCLUDING DOORS) & SAVE FOR REUSE.
- ⊠ REMOVE CARPET AND TACK STRIP CLEAN.
- ⊠ NOT USED
- ⊠ REMOVE CAST IRON RADIATOR (OR UNIT VENTILATOR) AND ALL ASSOCIATED PIPING.
- ⊠ NOT USED
- ⊠ NOT USED
- ⊠ NOT USED
- ⊠ NOT USED
- ⊠ NOT USED
- ⊠ NOT USED
- ⊠ NOT USED
- ⊠ REMOVE STACK.
- ⊠ REMOVE PORTION OF EXISTING WALL FOR INSTALLATION OF NEW DOOR.
- ⊠ REMOVE EXISTING MARBLE CHASE WALL.
- ⊠ REMOVE EXISTING DOORS & FRAME ARCH -- CLERESTORY TO REMAIN.
- ⊠ REMOVE DRAPERY ROD.
- ⊠ REMOVE HAND RAIL(S).
- ⊠ REMOVE EXISTING A.C. UNIT, PATCH AND FILL OPENING TO MATCH ADJOINING SURFACES. REUSE SALVAGE BRICKS OR APPROVED EQUAL. TOOTH IN ALL MASONRY.

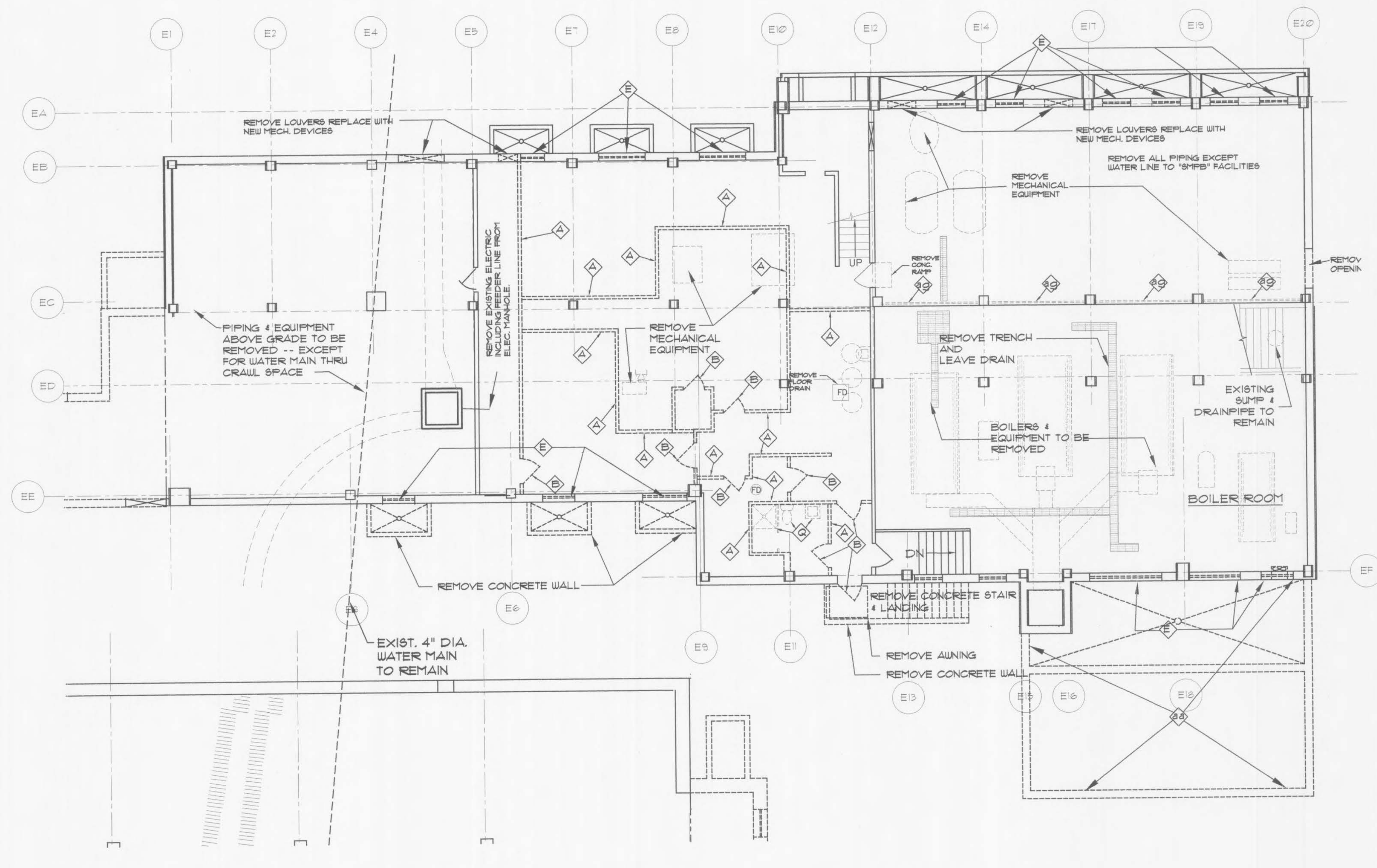

**BASEMENT PLAN - EAST WING**  
 SCALE: 1/8" = 1'-0"

