

SOUTH WING - BASEMENT PLAN
 SCALE: 1/8" = 1'-0"
 0 2 4 6

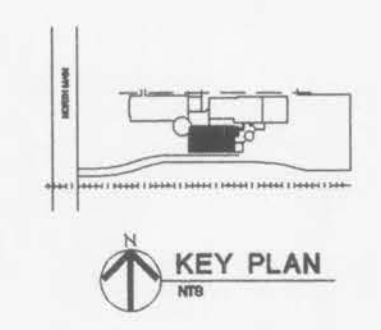

- NOTE** --- PARTITION TYPES: ALL NEW SHADED INTERIOR PARTITIONS ARE TYPE P1, UNLESS OTHERWISE NOTED.
- PLAN KEY NOTES**
- ◇ PATCH TO MATCH EXISTING PARTITION AND BASE.
 - ◇ PATCH TO MATCH EXISTING BASE.
 - ◇ PATCH TO MATCH EXISTING FLOOR.
 - ◇ NEW COAT ROD AND SHELF.
 - ◇ NEW STC RATED FOLDING PARTITION.
 - ◇ FLOOR EXPANSION JOINT (SEE DETAILS).
 - ◇ REFURBISH EXISTING WINDOWS.
 - ◇ EXISTING MILLWORK REMAINS --- CLEAN AND REFURBISH --- SEE SPECIFICATIONS.
 - ◇ RELOCATED EXISTING MILLWORK.
 - ◇ INFILL CONSTRUCTION FOR FLOOR AREA (SEE DETAILS).
 - ◇ REPLACE STAIR HANDRAIL (SEE DETAIL).
 - ◇ INSTALL GUARDRAIL (SEE DETAIL).
 - ◇ INSTALL SEVEN (7) ADJUSTABLE SHELVES.
 - ◇ 3" PC CONC. CEILING --- SEE DTG & STRUCT.
 - ◇ PROVIDE NEW LIGHTWEIGHT CONCRETE FILL TO TAPER UP SHOWER ROOM FLOOR TO ACCESSIBLE SHOWER STALL.
 - ◇ PROVIDE 1/2" UP AT 2:1 SLOPE AT ACCESSIBLE STALL.
 - ◇ PROVIDE ACCESSIBLE RECESSED SHOWER RECEPTOR WITH 1/2" UP AT 2:1 SLOPE.
 - ◇ CASD OPENING.
 - ◇ HORIZONTAL BLINDS.
 - ◇ TRANSLUCENT GLASS INNER PANE.
 - ◇ SECONDARY GLAZED WINDOW. INSTALL AFTER EXISTING WINDOW REFURBISHED.
 - ◇ OPERABLE WINDOWS.
 - ◇ NEW HANDRAIL/GUARDRAIL.
 - ◇ EXISTING WALL TO REMAIN.
 - ◇ EXISTING TO REMAIN WITH DOOR OPENING.

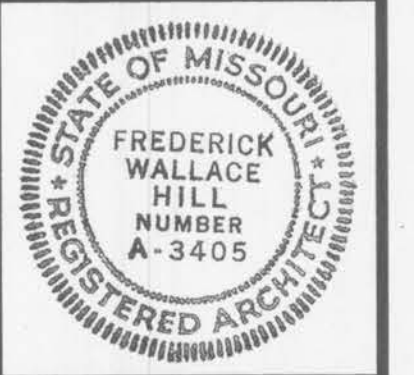

Revisions

CONSTRUCTION ISSUE	DECEMBER 5, 1997
--------------------	------------------

Project No.	96036
Date	SEPT. 4, 1997
Designed	
Drawn	
Drawing No.	A-12