

BASEMENT PLAN - EAST WING
SCALE: 1/8" = 1'-0"

NOTE --- PARTITION TYPES: ALL NEW SHADED INTERIOR PARTITIONS ARE TYPE P1, UNLESS OTHERWISE NOTED.

- PLAN KEY NOTES**
- ① PATCH TO MATCH EXISTING PARTITION AND BASE.
 - ② PATCH TO MATCH EXISTING BASE.
 - ③ PATCH TO MATCH EXISTING FLOOR.
 - ④ NEW COAT ROD AND SHELF.
 - ⑤ NEW STC RATED FOLDING PARTITION.
 - ⑥ FLOOR EXPANSION JOINT (SEE DETAILS).
 - ⑦ REFURBISH EXISTING WINDOWS.
 - ⑧ EXISTING MILLWORK REMAINS -- CLEAN AND REFURBISH -- SEE SPECIFICATIONS.
 - ⑨ RELOCATED EXISTING MILLWORK
 - ⑩ INFILL CONSTRUCTION FOR FLOOR AREA (SEE DETAILS).
 - ⑪ REPLACE STAIR HANDRAIL (SEE DETAIL).
 - ⑫ INSTALL GUARDRAIL. (SEE DETAIL).
 - ⑬ INSTALL SEVEN (7) ADJUSTABLE SHELVES.
 - ⑭ 3" PC CONC. CEIL'G - SEE DTL & STRUCT.
 - ⑮ PROVIDE NEW LIGHTWEIGHT CONCRETE FILL TO TAPER UP SHOWER ROOM FLOOR TO ACCESSIBLE SHOWER STALL. PROVIDE 1/2" LIP AT 2:1 SLOPE AT ACCESSIBLE STALL.
 - ⑯ PROVIDE ACCESSIBLE RECESSED SHOWER RECEPTOR WITH 1/2" LIP AT 2:1 SLOPE.
 - ⑰ CASED OPENING
 - ⑱ HORIZONTAL BLINDS

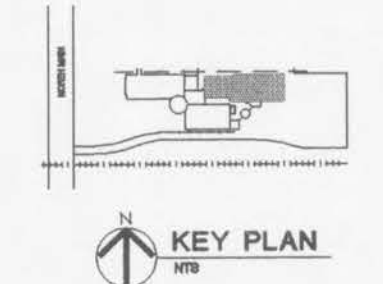

CONSTRUCTION DOCUMENTS