

ATTIC PLAN - WEST WING
SCALE: 1/8" = 1'-0"

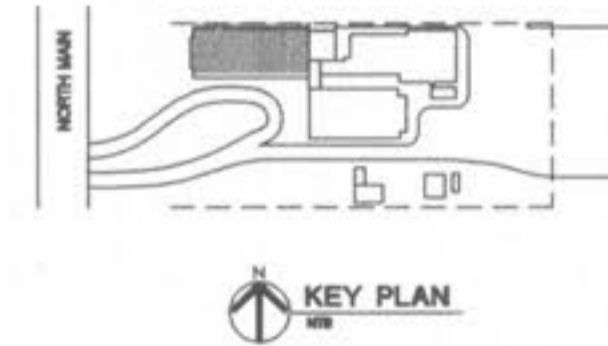

- DEMO KEY NOTES**
- ⓐ REMOVE PARTITION, OR WALL, AND ALL ELECTRICAL CONDUIT AND WIRING BACK TO PANEL -- AS SHOWN AS DASHED LINES ON PLAN. (PROTECT ALL EXISTING TERRAZZO FLOORING TO REMAIN IN PLACE).
 - ⓑ REMOVE DOOR AND FRAME.
 - ⓒ REMOVE DOOR AND FRAME AND SAVE FOR REUSE.
 - ⓓ REMOVE L.V., COLD WATER, HOT WATER, SANITARY PIPES AND ALL PIPING BELOW FLOOR.
 - ⓔ REMOVE WINDOW FRAME, CAULK AND SILL.
 - ⓕ REMOVE CASEWORK - CAP ALL PLUMBING CONNECTION WHERE APPLICABLE.
 - ⓖ NOT USED
 - ⓗ REMOVE WOOD WORK / CASE WORK AND SAVE FOR RE-INSTALLATION.
 - ⓘ EXISTING DOORS TO REMAIN.
 - ⓙ REMOVE COUNTERTOP.
 - ⓚ NOT USED
 - ⓛ NOT USED
 - ⓜ NOT USED
 - ⓝ REMOVE TOILET STALL PARTITIONS.
 - ⓞ NOT USED
 - ⓟ NOT USED
 - ⓠ REMOVE WATER CLOSET, COLD WATER, AND SANITARY, AND PIPING BELOW FLOOR -- IF MARBLE TOILET PARTITIONS EXIST, REMOVE (INCLUDING DOORS) & SAVE FOR REUSE.
 - ⓡ REMOVE CARPET AND TACK STRIP CLEAN.
 - ⓢ NOT USED
 - ⓣ REMOVE CAST IRON RADIATOR (OR UNIT VENTILATOR) AND ALL ASSOCIATED PIPING.
 - ⓤ NOT USED
 - ⓖ NOT USED
 - ⓗ NOT USED
 - ⓙ NOT USED
 - ⓚ NOT USED
 - ⓛ NOT USED
 - ⓜ NOT USED
 - ⓝ NOT USED
 - ⓞ NOT USED
 - ⓟ REMOVE STACK.
 - ⓠ REMOVE PORTION OF EXISTING WALL FOR INSTALLATION OF NEW DOOR.
 - ⓡ REMOVE EXISTING MARBLE CHASE WALL.
 - ⓢ REMOVE EXISTING DOORS & FRAME ARCH -- CLERESTORY TO REMAIN.
 - ⓣ REMOVE DRAPERY ROD.
 - ⓤ REMOVE HAND RAIL(S).
 - ⓖ REMOVE EXISTING A.C. UNIT, PATCH AND FILL OPENING TO MATCH ADJOINING SURFACES. REUSE SALVAGE BRICKS OR APPROVED EQUAL. TOOTH IN ALL MASONRY.