

BASEMENT CEILING PLAN - EAST WING
 SCALE: 1/8" = 1'-0"

- KEYED NOTES:**
- EXISTING GAS METER (2# PRESSURE) NO CHANGE, WITH EXISTING 6" GAS PIPING TO BOILER ROOM.
 - ROUTE 1" GAS TO EACH WATER HEATER. FURNISH #/IN. REGULATOR PRIOR TO CONNECTION. PROVIDE GROUND JOINT UNION, GAS SHUTOFF, AND DIRTLEG.
 - 3" GAS TO NEW BOILER, SEE MECHANICAL PLANS FOR ENLARGED PLAN.
 - CONNECT NEW 3" GAS TO EXISTING 6" GAS AT THIS POINT. ALL GAS PIPING TO BE SCHEDULE 40 WELDED BLACK IRON PIPE.

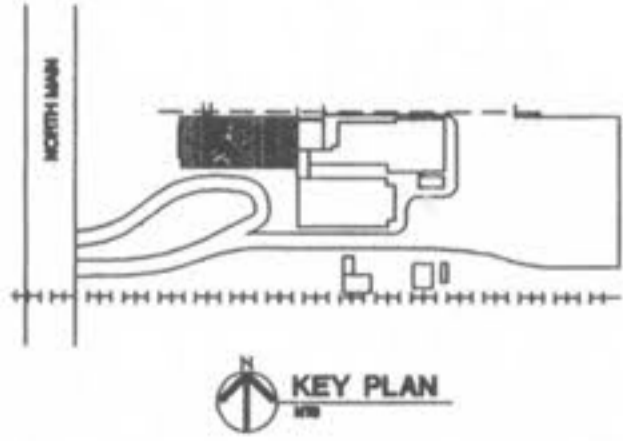

138 South Main Street
 O'Fallon, Missouri 63366
City of O'Fallon
NEW CITY HALL COMPLEX

**EAST WING
 BASEMENT CEILING
 PLAN
 CONSTRUCTION DOCUMENTS**

Revisions
 CONSTRUCTION ISSUE
 DECEMBER 5, 1997

Project No. 96036
 Date 4 SEPT 97
 Designed
 Drawn
 Drawing No. **A-63**

**BID
 ISSUE**