

NOTE--NO.  
**STORM PIPING AT ATTRIUM**  
 NTS

- KEYED NOTES:**
- [1] EXISTING STORM SEWER TO BE ABANDONED, REMOVE EXISTING STORM PIPING UNDER BUILDINGS.
  - [2] PLUMBING CONTRACTOR TO RE-ROUTE EXISTING STORM LINE AROUND NEW BUILDING ADDITION, PC TO VERIFY SIZE & DEPTH.
  - [3] NEW STORM MANHOLE EXTEND TO DAYLIGHT.
  - [4] COORDINATE INSTALLATION HEIGHT WITH SANITARY PIPING.

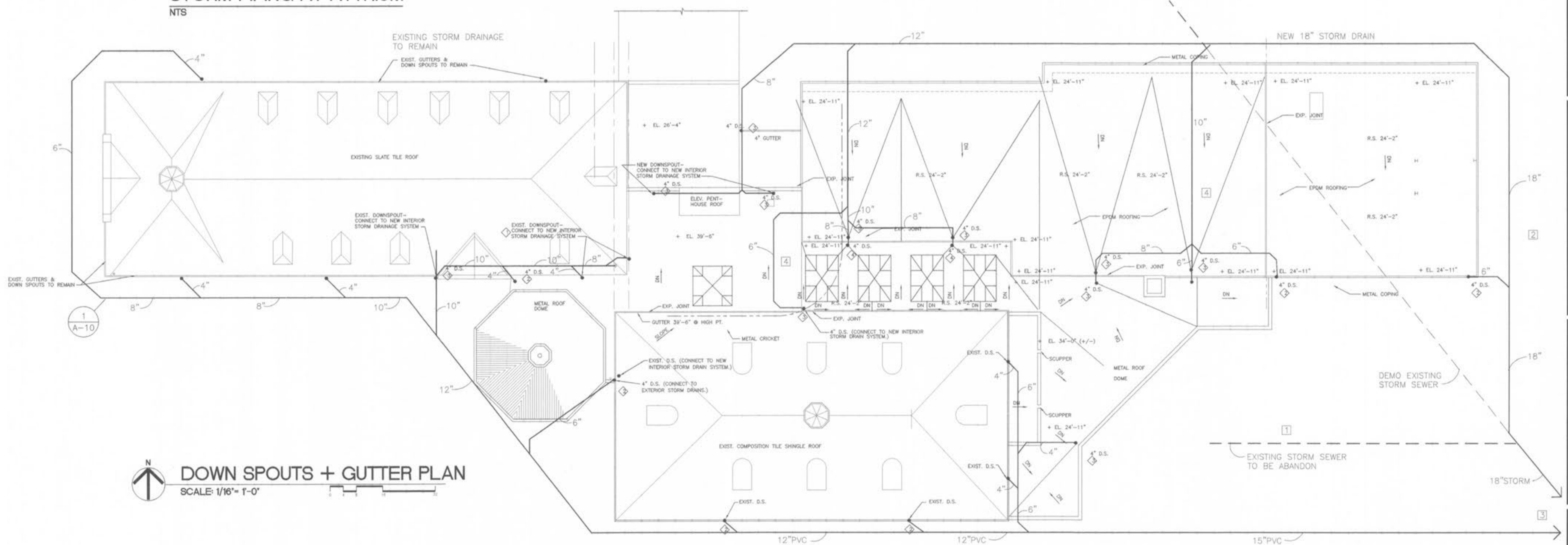

**DOWN SPOUTS + GUTTER PLAN**  
 SCALE: 1/16" = 1'-0"

Revisions  
 CONSTRUCTION ISSUE  
 DECEMBER 5, 1997  
 CHANGE ORDER NO. 1  
 JANUARY 27, 1998

Project No. 960  
 Date SEPT, 4, 1997  
 Designed  
 Drawn  
 Drawing No. **F**