

A TRACT OF LAND BEING PART OF  
SECTION 21, TOWNSHIP 47 NORTH, RANGE 3 EAST,  
OF THE FIFTH PRINCIPAL MERIDIAN,  
ST. CHARLES COUNTY, MISSOURI

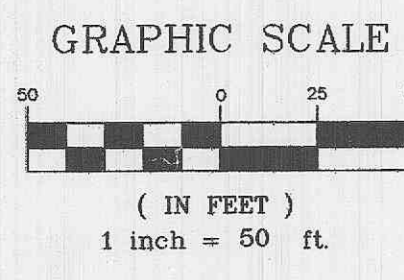

1. THE UNDERGROUND UTILITIES SHOWN HEREON WERE PLOTTED FROM BASE MAPS SUPPLIED TO BAX FROM THE RESPECTIVE UTILITY COMPANIES SERVING THIS SITE AND SHOULD BE VERIFIED BEFORE ANY DESIGN OR CONSTRUCTION BEGINS.
2. FOR PARKING STRIPING DIMENSIONS SEE DETAILS, THIS SHEET.
3. FOR SIGNS AND PAVEMENT MARKINGS DETAILS, SEE SHEET C-4.

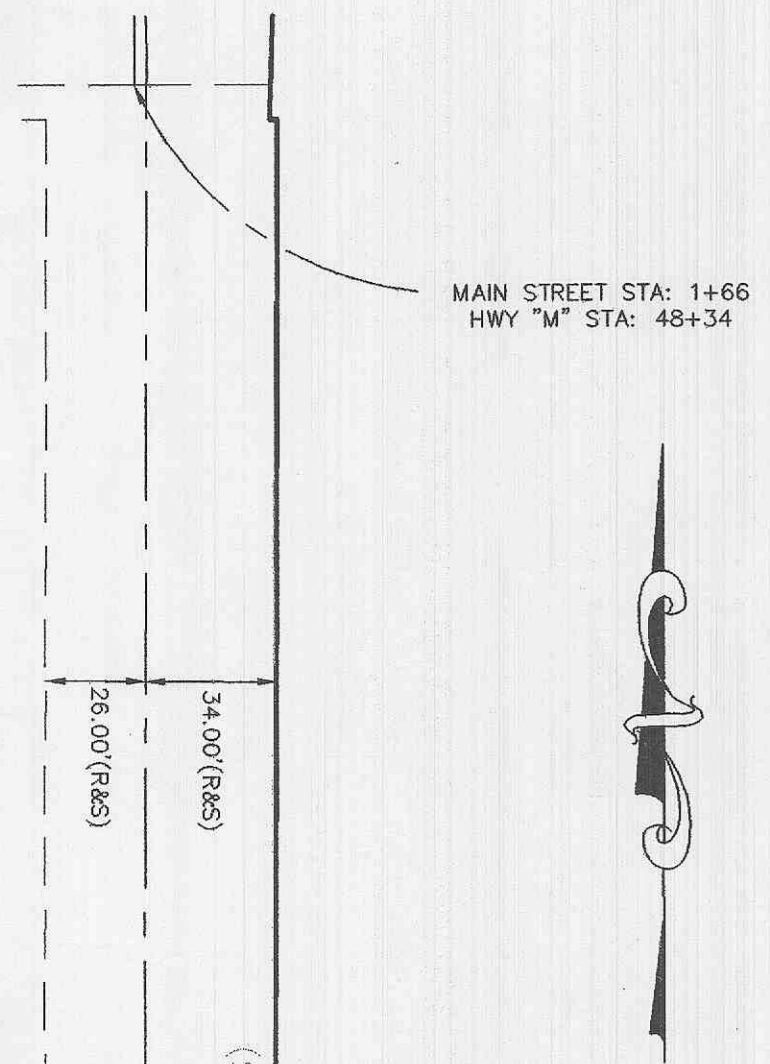
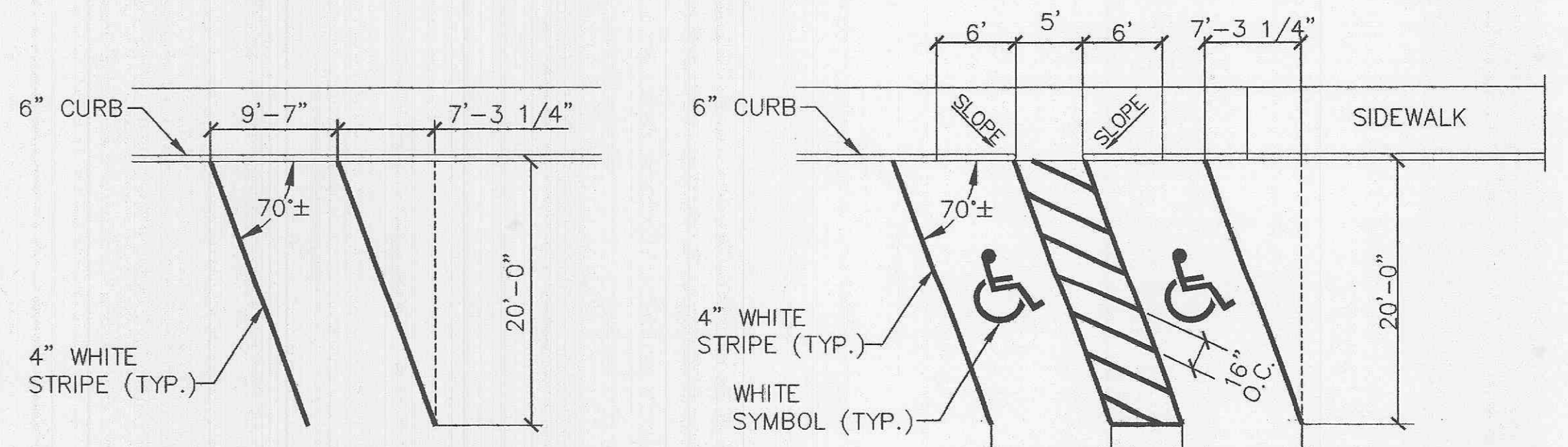
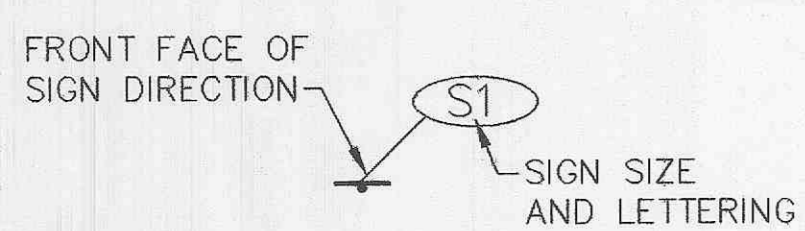

PARKING STALL-TYPE A  
SCALE: 1" = 10'

PAIR OF HANDICAP PARKING STALL-TYPE HCA  
SCALE: 1" = 10'

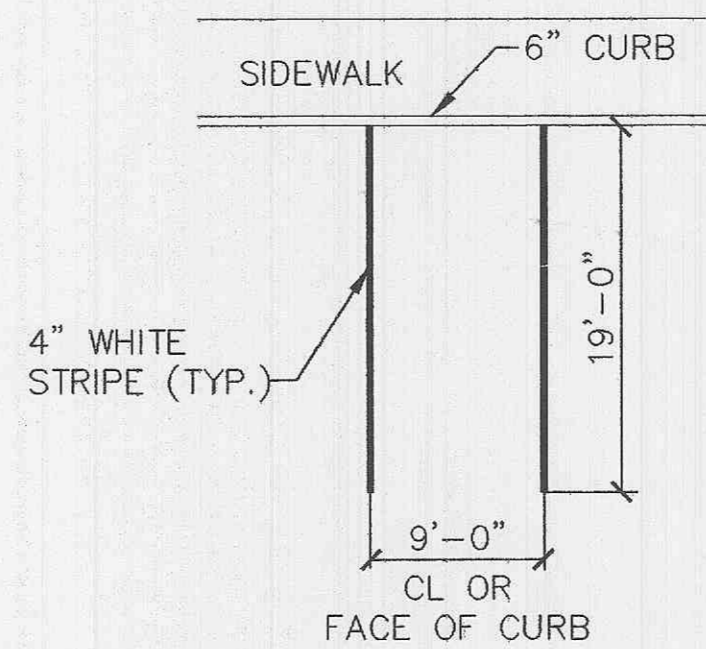

PARKING STALL-TYPE B  
SCALE: 1" = 10'

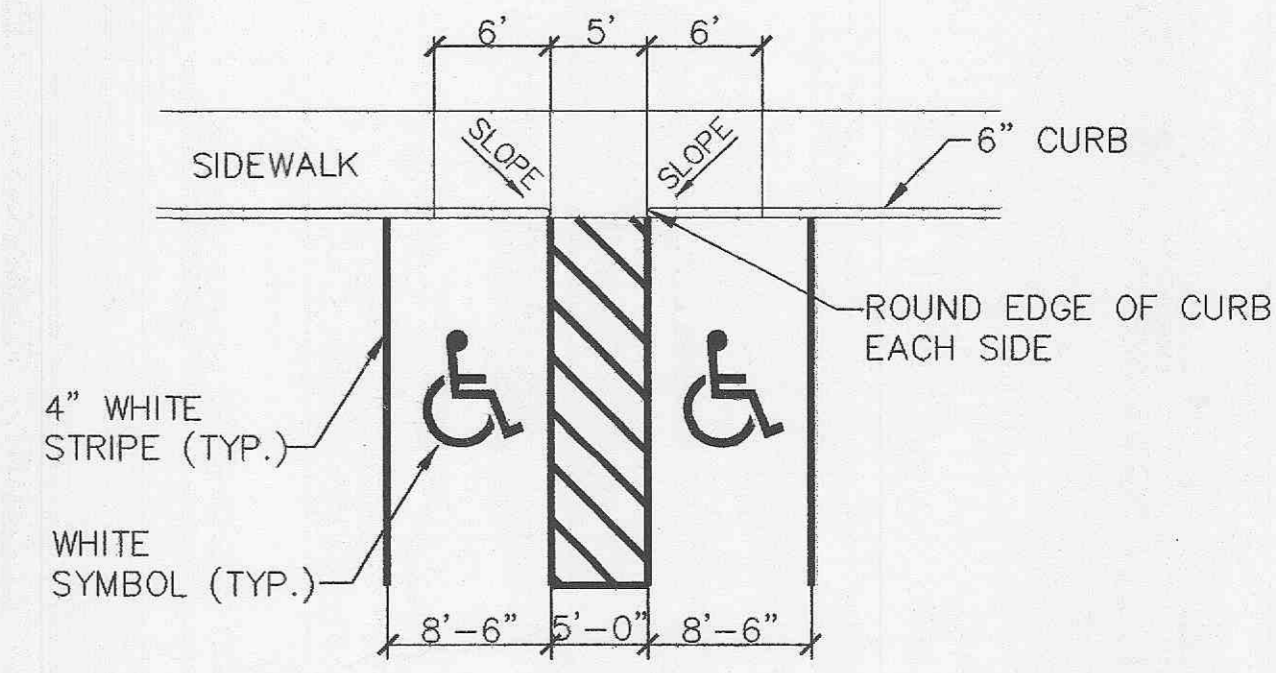

PAIR OF HANDICAP PARKING STALL-TYPE HCB  
SCALE: 1" = 10'

215 PARKING SPACES PLUS 8 HANDICAP SPACES = 223 TOTAL SPACES.

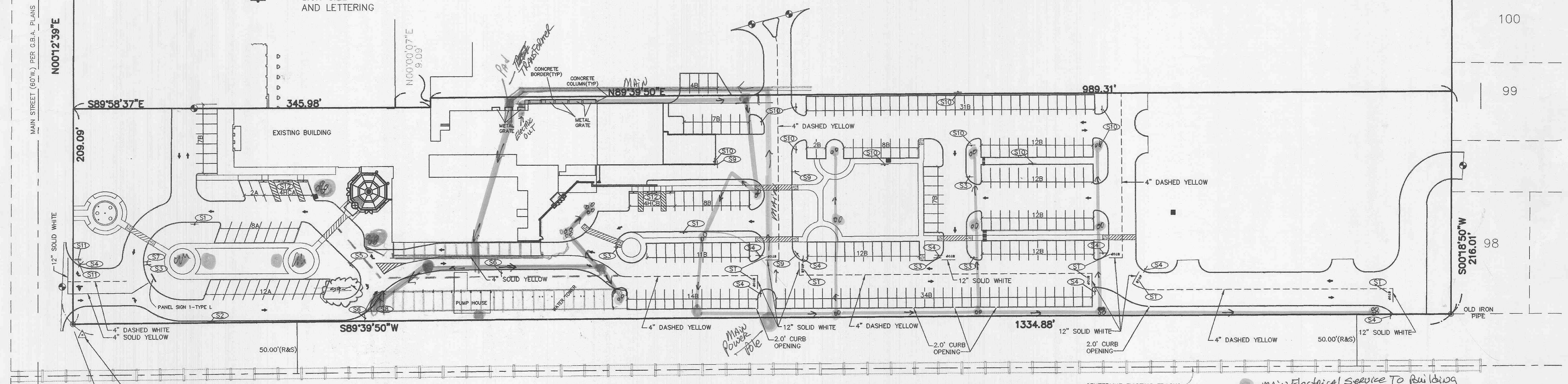

*Please Return TO Rod Stakson OR Facilities MAINTENANCE*

- MAIN Electrical service TO Building
- LIGHT STANDARDS
- POWER FEED TO POLES
- SUCTION BOXES

CONSTRUCTION DOCUMENTS

Revisions  
CONSTRUCTION ISSUE  
DECEMBER 5, 1997  
CHANGE ORDER NO. 71  
JAN 27, 1998

Project No. 96036  
Date SEPT. 4, 1997  
Designed  
Drawn  
Drawing No. **C-3**