

PROFILE VIEW OF PROFILE GRADE LINE

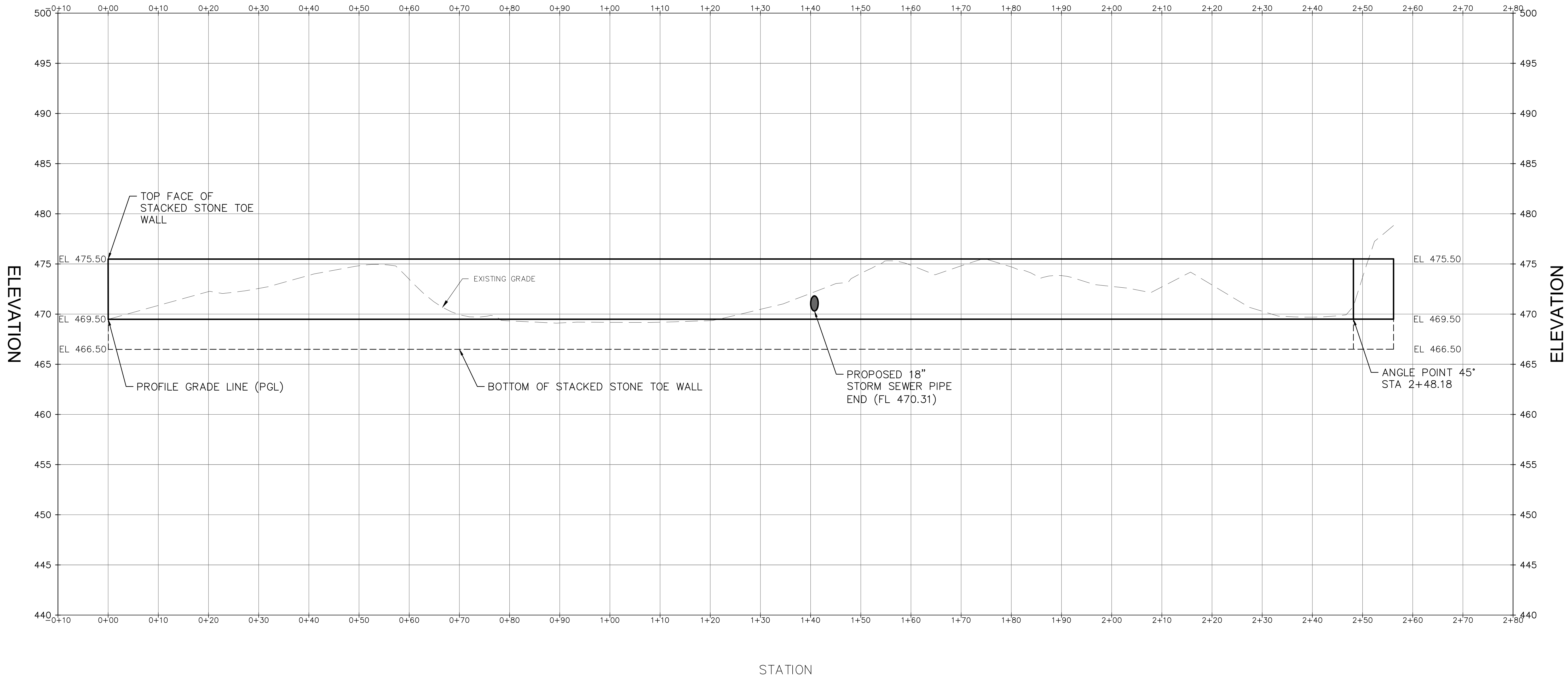

 M3 ENGINEERING GROUP, PC 911 WASHINGTON AVE, SUITE 620 SAINT LOUIS, MISSOURI 63101 PH: (314) 558-0699	REV.	DATE	DESCRIPTION	BY
	CITY OF O'FALLON			
	COACHMAN WAY STREAM IMPROVEMENTS CITY OF O'FALLON, MISSOURI ST. CHARLES COUNTY, MISSOURI			
 MICHAEL SEAN MARTIN, P.E. PROFESSIONAL ENGINEER P.E. No. PE-2008002186 Date: 2/28/2018	Designed	SLW	Date	SEP 2018
	Drawn	SLW	Sheet No	3 of 12
	Checked	TDW		