

Drawing name: V:\1608239\Drawings\Engineering\Improvements\1608239\Imp - SURFACE.dwg Plotted on: Aug 07, 2017 - 2:59pm Plotted by: jmlnar

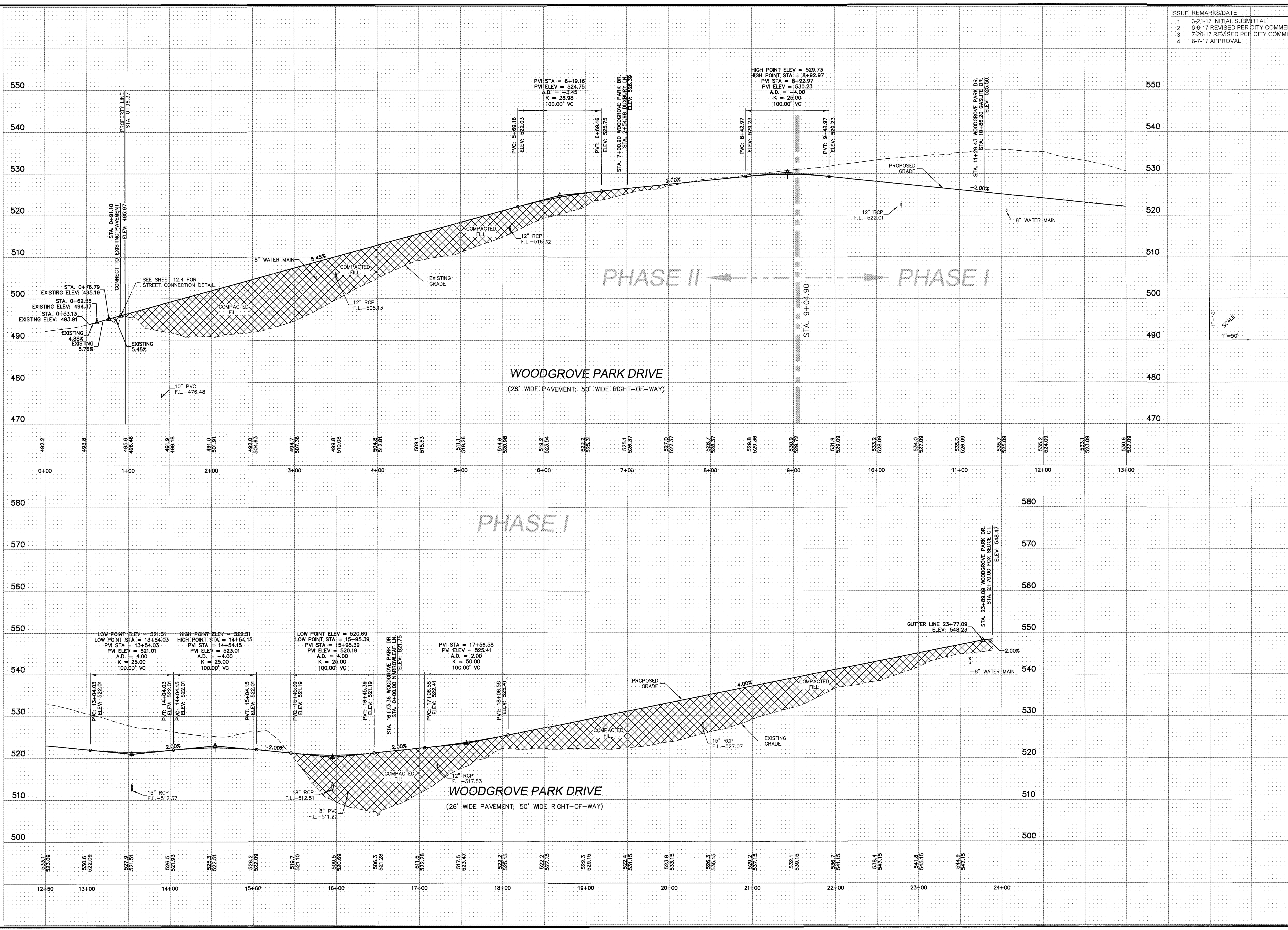

ISSUE	REMARKS/DATE
1	3-21-17 INITIAL SUBMITTAL
2	6-6-17 REVISED PER CITY COMMENTS
3	7-20-17 REVISED PER CITY COMMENTS
4	8-7-17 APPROVAL

PROJECT TITLE
COBBLESTONE CROSSING
OT'ALLON, MISSOURI

THE STERLING CO.
ENGINEERS & SURVEYORS
 5055 New Baumgartner Road
 St. Louis, Missouri 63129
 Ph 314-487-0440 Fax 314-487-8844
 www.sterling-eng-srv.com
 Corporate Certificate of Authority #001348



Date: 8/7/2017
 Michael G. Boerding
 License No. MO E-28643
 Civil Engineer

McBRIDE HYLAND GREEN, LLC
 16091 SWINGLEY RIDGE ROAD, SUITE 300
 CHESTERFIELD, MISSOURI 63017
 Ph. 636-537-2000
 Fax 636-537-2546
 www.mcbridehomes.com

STREET PROFILES

P+Z No. 29-16.01
City No.
Date: Aug. 7, 2017
Job No. 16-08-239

Page No.
6.5
 IMP