

Drawing name: V:\1606239-Dames Park\Drawings\Engineering\Improvements\239 Imp Sanitary.dwg Plotted on: Aug 07, 2017, 3:02pm Plotted by: Imhler

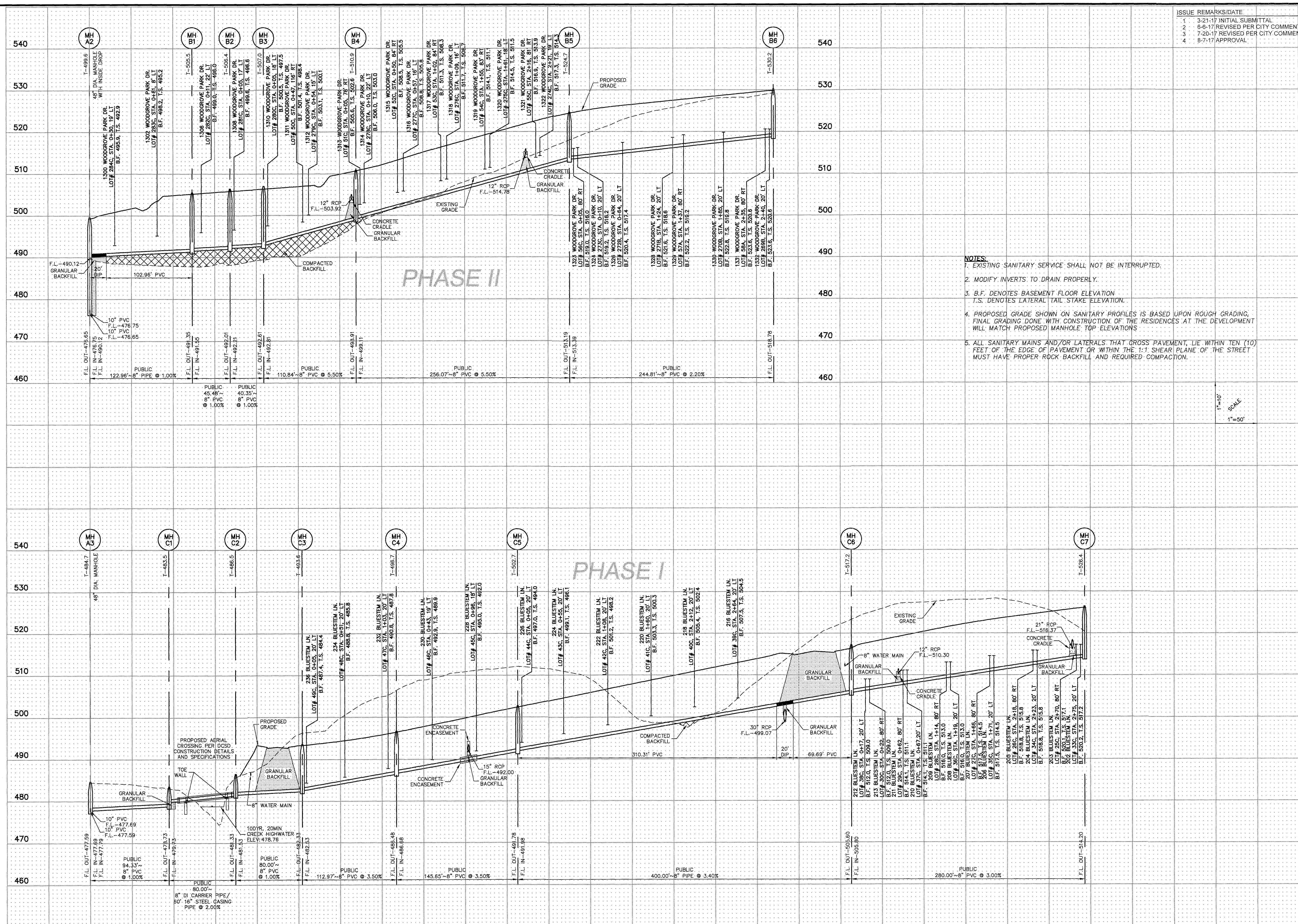

ISSUE	REMARKS/DATE
1	3-21-17 INITIAL SUBMITTAL
2	6-6-17 REVISED PER CITY COMMENTS
3	7-20-17 REVISED PER CITY COMMENTS
4	8-7-17 APPROVAL

- NOTES:**
- EXISTING SANITARY SERVICE SHALL NOT BE INTERRUPTED.
  - MODIFY INVERTS TO DRAIN PROPERLY.
  - B.F. DENOTES BASEMENT FLOOR ELEVATION  
T.S. DENOTES LATERAL TAIL STAKE ELEVATION.
  - PROPOSED GRADE SHOWN ON SANITARY PROFILES IS BASED UPON ROUGH GRADING, FINAL GRADING DONE WITH CONSTRUCTION OF THE RESIDENCES AT THE DEVELOPMENT WILL MATCH PROPOSED MANHOLE TOP ELEVATIONS
  - ALL SANITARY MAINS AND/OR LATERALS THAT CROSS PAVEMENT, LIE WITHIN TEN (10) FEET OF THE EDGE OF PAVEMENT OR WITHIN THE 1:1 SHEAR PLANE OF THE STREET MUST HAVE PROPER ROCK BACKFILL AND REQUIRED COMPACTION.

1"=10'  
SCALE  
1"=50'

**PROJECT TITLE**  
**COBBLESTONE CROSSING**  
OTTAWA, MISSOURI

**THE STERLING CO.**  
ENGINEERS & SURVEYORS  
5065 New Baumgartner Road  
St. Louis, Missouri 63129  
Ph 314-487-0440 Fax 314-487-8944  
www.sterling-eng-sur.com  
Corporate Certificate of Authority #001348

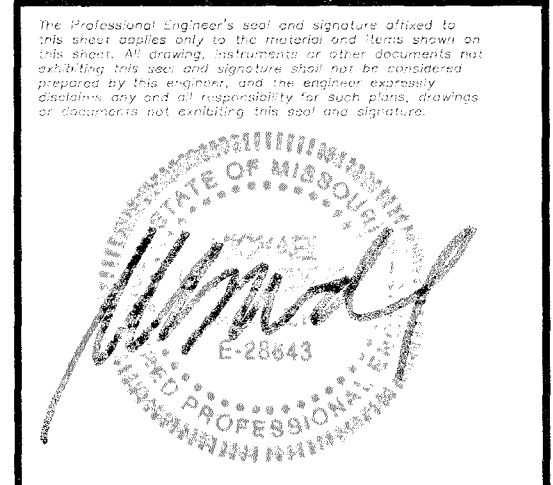

Date: 8/7/2017  
Michael G. Boerding  
License No. MO E-28643  
Civil Engineer

**McBRIDE HYLAND GREEN, LLC**  
16091 SWINGLEY RIDGE ROAD, SUITE 300  
CHESTERFIELD, MISSOURI 63017  
Ph. 636-537-2000  
Fax 636-537-2546  
www.mcbridehomes.com

P+Z No. 29-16.01  
City No.  
Date: Aug. 7, 2017  
Job No. 16-08-239  
Page No.

**7.2**  
IMP