

Drawing name: V:\1808238\Drawings\Engineering\Improvements\8238 Imp Storm.dwg Plotted on: Aug 07, 2017 - 3:14pm Plotted by: mhaber

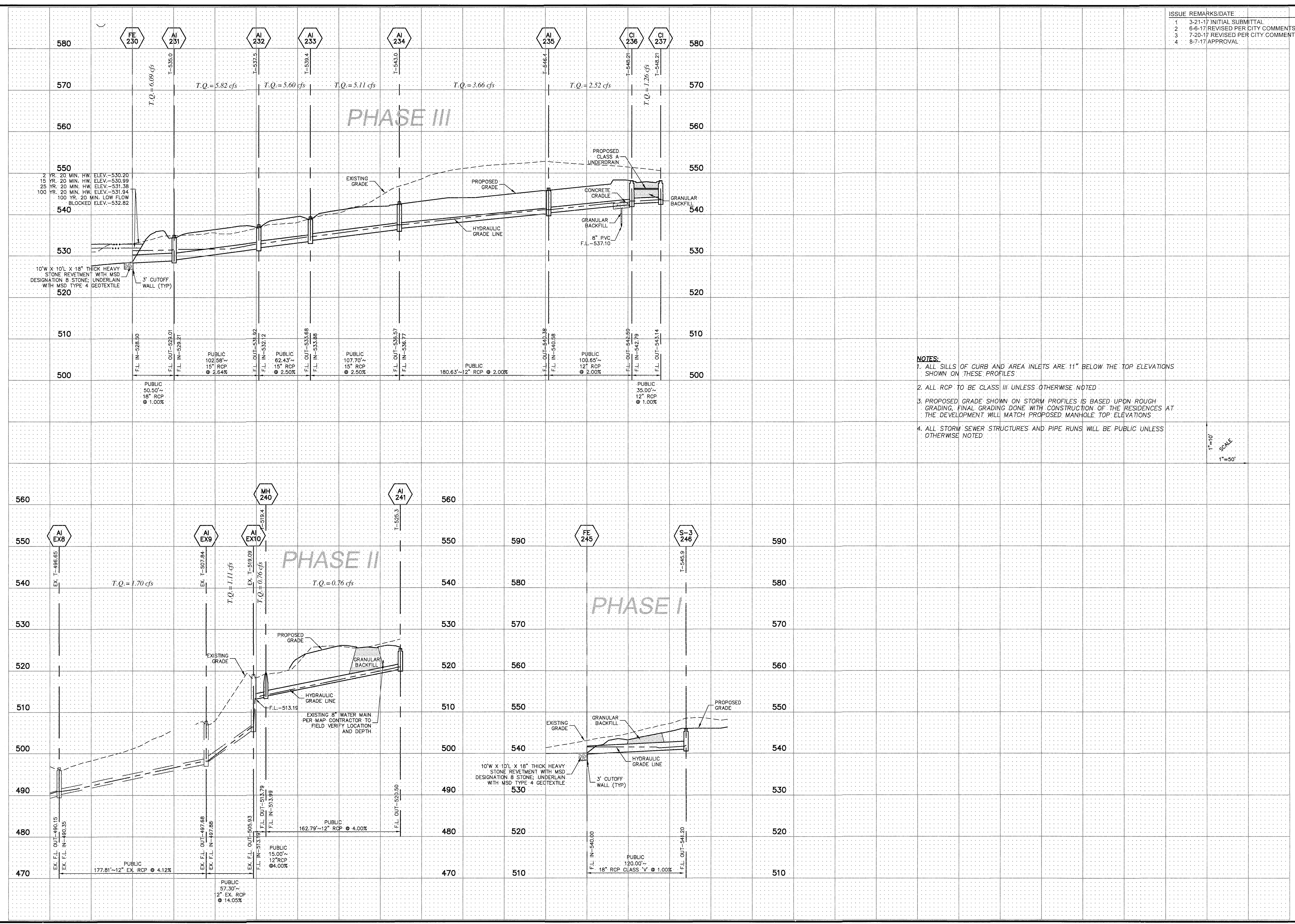

ISSUE	REMARKS/DATE
1	3-21-17 INITIAL SUBMITTAL
2	6-8-17 REVISED PER CITY COMMENTS
3	7-20-17 REVISED PER CITY COMMENTS
4	8-7-17 APPROVAL

- NOTES:**
1. ALL SILLS OF CURB AND AREA INLETS ARE 11" BELOW THE TOP ELEVATIONS SHOWN ON THESE PROFILES.
  2. ALL RCP TO BE CLASS III UNLESS OTHERWISE NOTED
  3. PROPOSED GRADE SHOWN ON STORM PROFILES IS BASED UPON ROUGH GRADING; FINAL GRADING DONE WITH CONSTRUCTION OF THE RESIDENCES AT THE DEVELOPMENT WILL MATCH PROPOSED MANHOLE TOP ELEVATIONS
  4. ALL STORM SEWER STRUCTURES AND PIPE RUNS WILL BE PUBLIC UNLESS OTHERWISE NOTED.

1"=10'  
1"=50'  
SCALE

PROJECT TITLE

**COBBLESTONE CROSSING**  
OF FALLON, MISSOURI

**THE STERLING CO.**  
ENGINEERS & SURVEYORS  
5065 New Baumgartner Road  
Falls Church, VA 22041  
Ph 314.877.0400  
www.sterling-eng.sur.com  
Corporate Certificate of Authority #001348

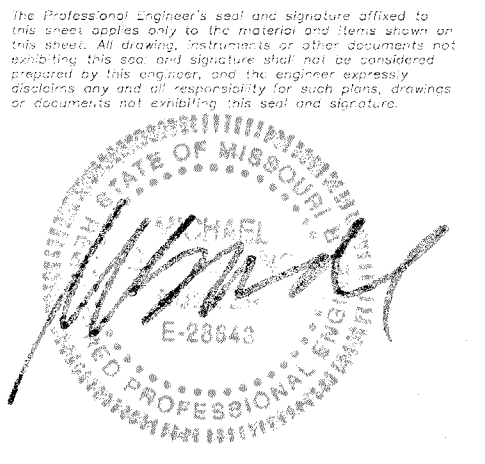

Date: 8/7/2017  
Michael G. Boerding  
License No. MO E-28643  
Civil Engineer

**McBRIDE HYLAND GREEN, LLC**  
16091 SWINGLEY RIDGE ROAD, SUITE 300  
CHESTERFIELD, MISSOURI 63017  
Ph 636-537-2000  
Fax 636-537-2546  
www.mcbriehomes.com

STORM SEWER PROFILES

P+Z No. 29-16.01  
City No.  
Date: Aug. 7, 2017  
Job No. 16-08-239

Page No.  
**8.10**

IMP