

Drawing name: V:\1608239\Drawings\Engineering\Improvements\239 Imp Storm.dwg Plotted on: Aug 07, 2017 - 3:10pm Plotted by: thalmer

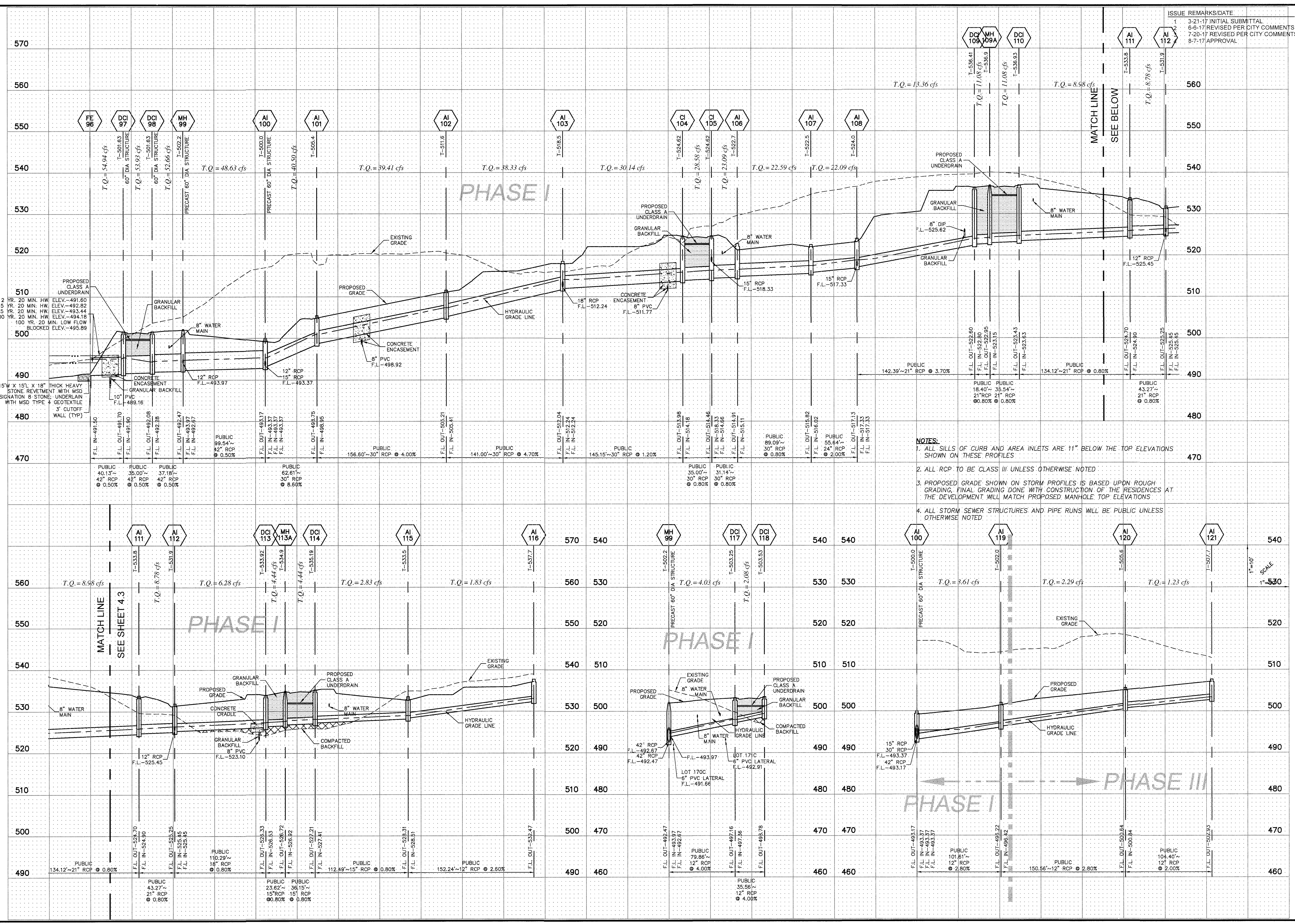

- NOTES:**
1. ALL SILLS OF CURB AND AREA INLETS ARE 11" BELOW THE TOP ELEVATIONS SHOWN ON THESE PROFILES
 2. ALL RCP TO BE CLASS III UNLESS OTHERWISE NOTED
 3. PROPOSED GRADE SHOWN ON STORM PROFILES IS BASED UPON ROUGH GRADING, FINAL GRADING DONE WITH CONSTRUCTION OF THE RESIDENCES AT THE DEVELOPMENT WILL MATCH PROPOSED MANHOLE TOP ELEVATIONS
 4. ALL STORM SEWER STRUCTURES AND PIPE RUNS WILL BE PUBLIC UNLESS OTHERWISE NOTED

PROJECT TITLE
COBBLESTONE CROSSING
 OT FALLON, MISSOURI

THE STERLING CO.
 ENGINEERS & SURVEYORS
 5065 New Baumgardner Road
 St. Louis, Missouri 63129
 Ph 314-487-0440 Fax 314-487-8944
 www.sterling-eng-sur.com
 Corporate Certificate of Authority #001348

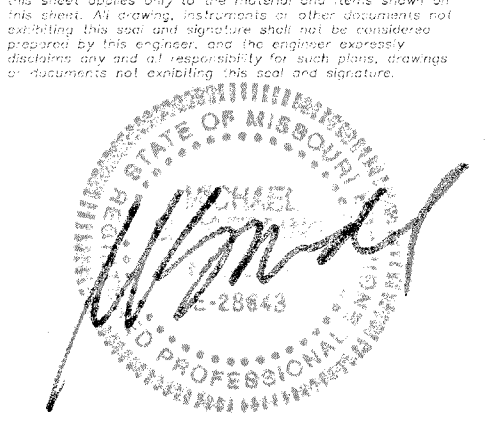

Date: 8/7/2017
 Michael G. Boerding
 License No. MO E-28643
 Civil Engineer

McBRIDE HYLAND GREEN, LLC
 16091 SWINGLEY RIDGE ROAD, SUITE 300
 CHESTERFIELD, MISSOURI 63017
 Ph 636-537-2000
 Fax 636-537-2546
 www.mcbridehomes.com

P+Z No. 29-16.01
City No.
Date: Aug. 7, 2017
Job No. 16-08-239
Page No.

8.5
 IMP