

Drawing name: V11606239 Dames ParkDrawingsEngineeringImprovements6239 Imp Storm.dwg Plotted on: Aug 07, 2017 - 3:11pm Plotted by: Imaher

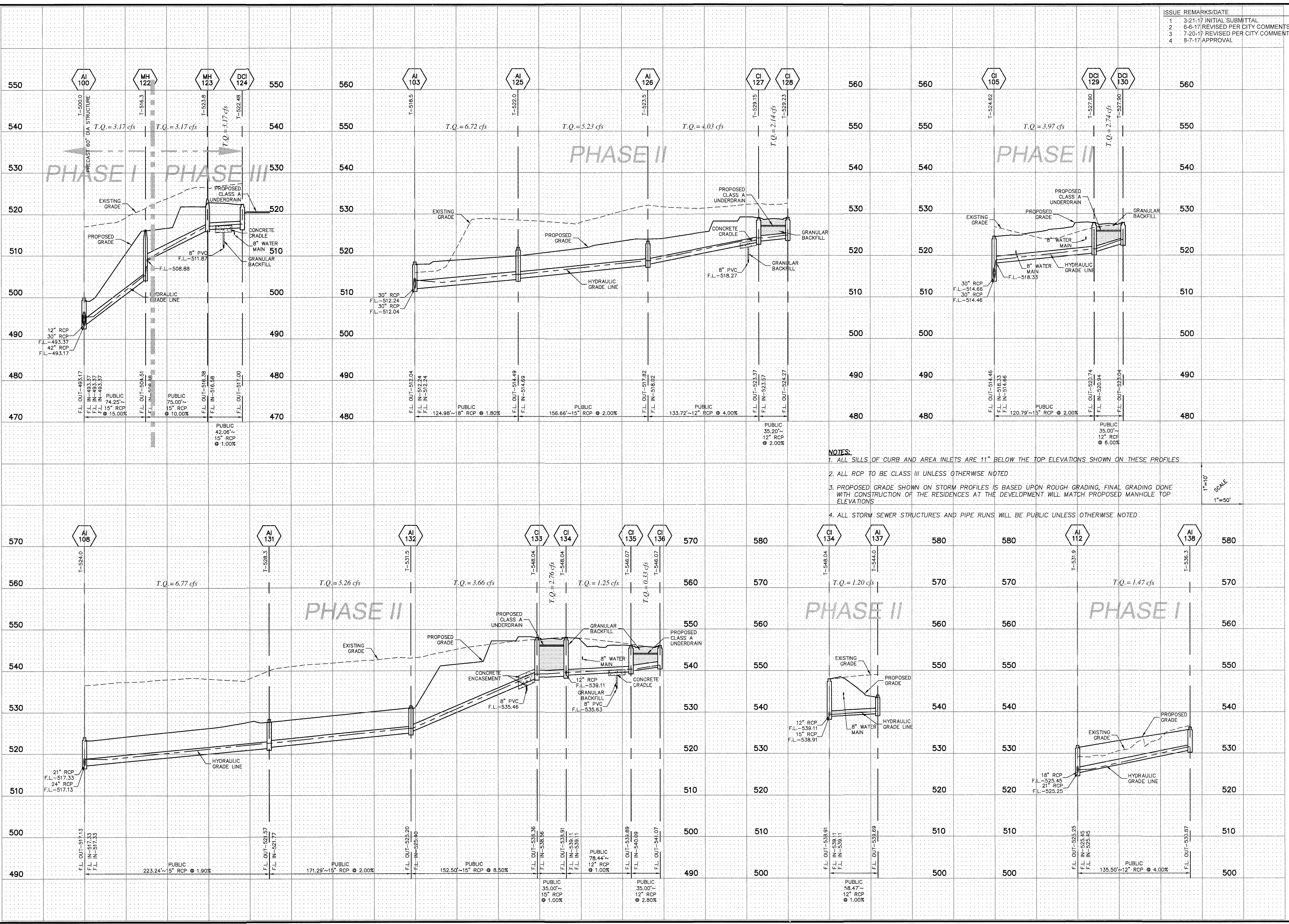

ISSUE	REMARKS/DATE
1	3-21-17 INITIAL SUBMITTAL
2	6-6-17 REVISED PER CITY COMMENTS
3	7-20-17 REVISED PER CITY COMMENTS
4	8-7-17 APPROVAL

- NOTES:**
- ALL SILLS OF CURB AND AREA INLETS ARE 11" BELOW THE TOP ELEVATIONS SHOWN ON THESE PROFILES
  - ALL RCP TO BE CLASS III UNLESS OTHERWISE NOTED
  - PROPOSED GRADE SHOWN ON STORM PROFILES IS BASED UPON ROUGH GRADING, FINAL GRADING DONE WITH CONSTRUCTION OF THE RESIDENCES AT THE DEVELOPMENT WILL MATCH PROPOSED MANHOLE TOP ELEVATIONS
  - ALL STORM SEWER STRUCTURES AND PIPE RUNS WILL BE PUBLIC UNLESS OTHERWISE NOTED

1"=10'  
1"=50'

PROJECT TITLE

**COBBLESTONE CROSSING**  
OF FALLON, MISSOURI

**THE STERLING CO.**  
ENGINEERS & SURVEYORS  
5055 New Baumgartner Road  
St. Louis, Missouri 63129  
Ph 314-487-0440 Fax 314-487-8844  
www.sterling-eng-survey.com  
Corporate Certificate of Authority #0013348

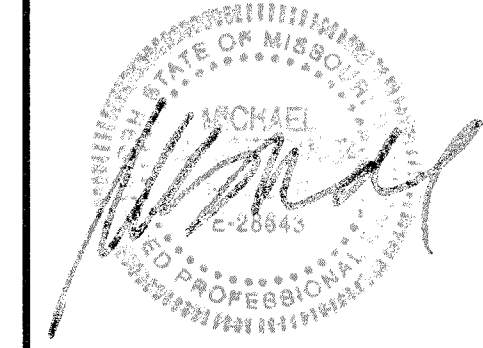

Date: 8/7/2017  
Michael G. Boering  
License No. MO E-28643  
Civil Engineer

**McBRIDE HYLAND GREEN, LLC**  
16091 SWINGLEY RIDGE ROAD, SUITE 300  
CHESTERFIELD, MISSOURI 63017  
Ph 636-537-2000  
Fax 636-537-2546  
www.mcbridehomes.com

STORM SEWER PROFILES

P+Z No. 29-16.01  
City No.  
Date: Aug. 7, 2017  
Job No. 16-08-239

Page No.  
**8.6**

IMP