

ISSUE	REMARKS	DATE
1	3-21-17 INITIAL SUBMITTAL	
2	6-6-17 REVISED PER CITY COMMENTS	
3	7-20-17 REVISED PER CITY COMMENTS	
4	8-7-17 APPROVAL	

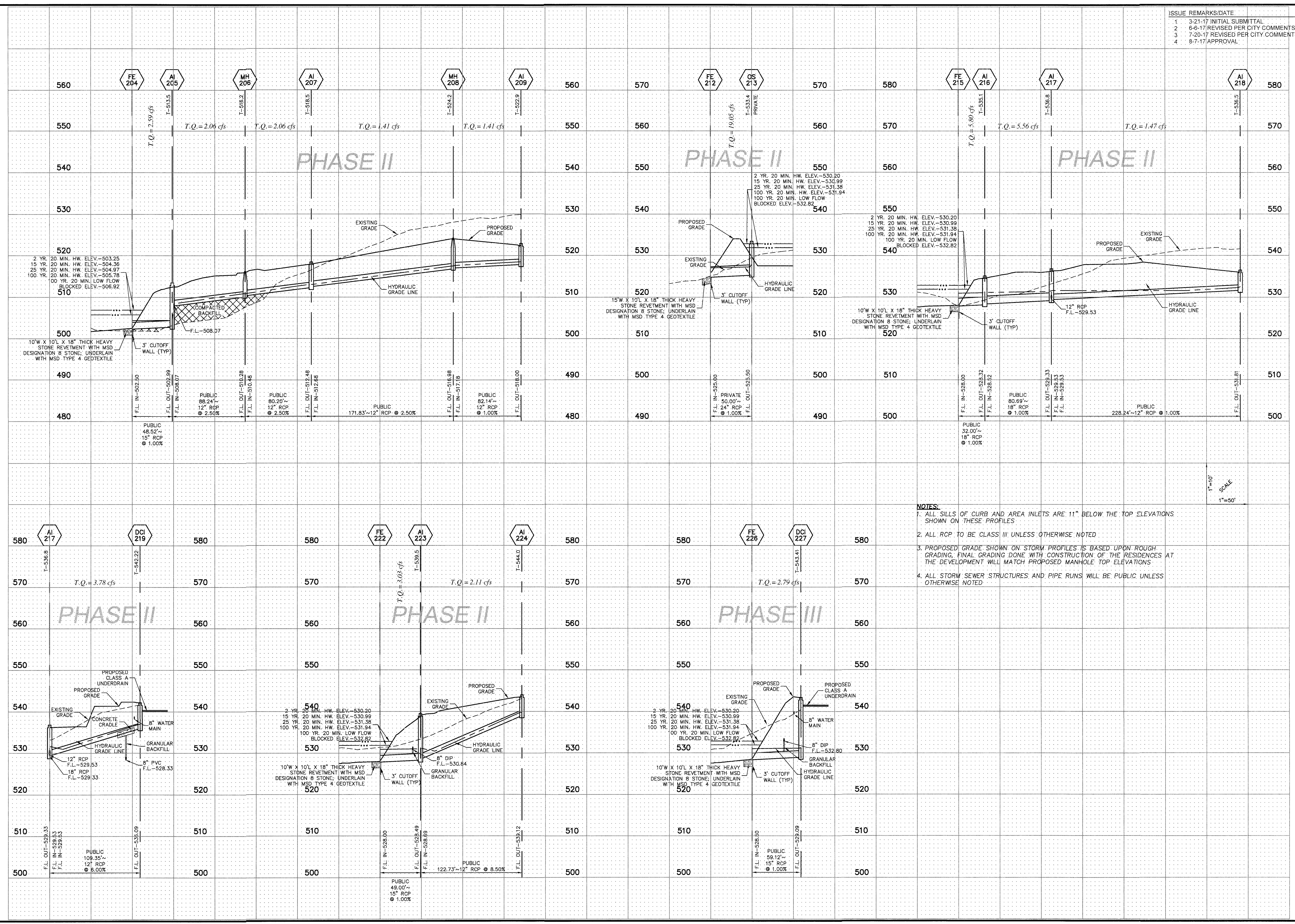

- NOTES:**
1. ALL SILLS OF CURB AND AREA INLETS ARE 11" BELOW THE TOP ELEVATIONS SHOWN ON THESE PROFILES
 2. ALL RCP TO BE CLASS III UNLESS OTHERWISE NOTED
 3. PROPOSED GRADE SHOWN ON STORM PROFILES IS BASED UPON ROUGH GRADING, FINAL GRADING DONE WITH CONSTRUCTION OF THE RESIDENCES AT THE DEVELOPMENT WILL MATCH PROPOSED MANHOLE TOP ELEVATIONS
 4. ALL STORM SEWER STRUCTURES AND PIPE RUNS WILL BE PUBLIC UNLESS OTHERWISE NOTED

1"=10'
SCALE
1"=50'

PROJECT TITLE

COBBLESTONE CROSSING
OF ALLON, MISSOURI

THE STERLING CO.
ENGINEERS & SURVEYORS
5065 New Baumgartner Road
Ferguson, MO 63108
Ph 314-487-0440 / Fax 314-487-8944
www.sterling-eng-survey.com
Corporate Certificate of Authority #001348

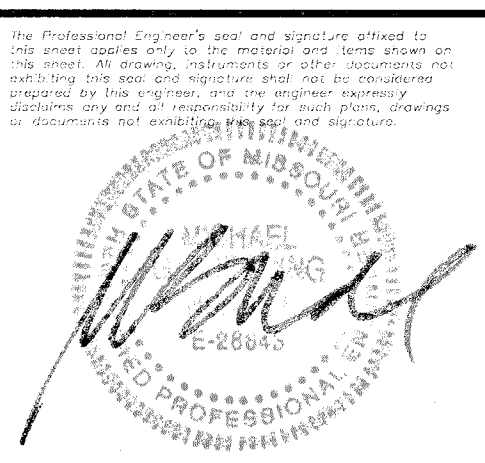

Date: 8/7/2017
Michael G. Boerding
License No. MO E-28643
Civil Engineer

McBRIDE HYLAND GREEN, LLC
16091 SWINGLEY RIDGE ROAD, SUITE 800
CHESTERFIELD, MISSOURI 63017
Ph 636-537-2000
Fax 636-537-2546
www.mcbridehomes.com

STORM SEWER PROFILES

P+Z No. 29-16.01
City No.
Date: Aug. 7, 2017
Job No. 16-08-239
Page No.

8.9

IMP