

ISSUE	REMARKS/DATE
1	12/21/17 INITIAL SUBMITTAL
2	01/16/18 CITY COMMENTS
3	02/01/18 CITY COMMENTS

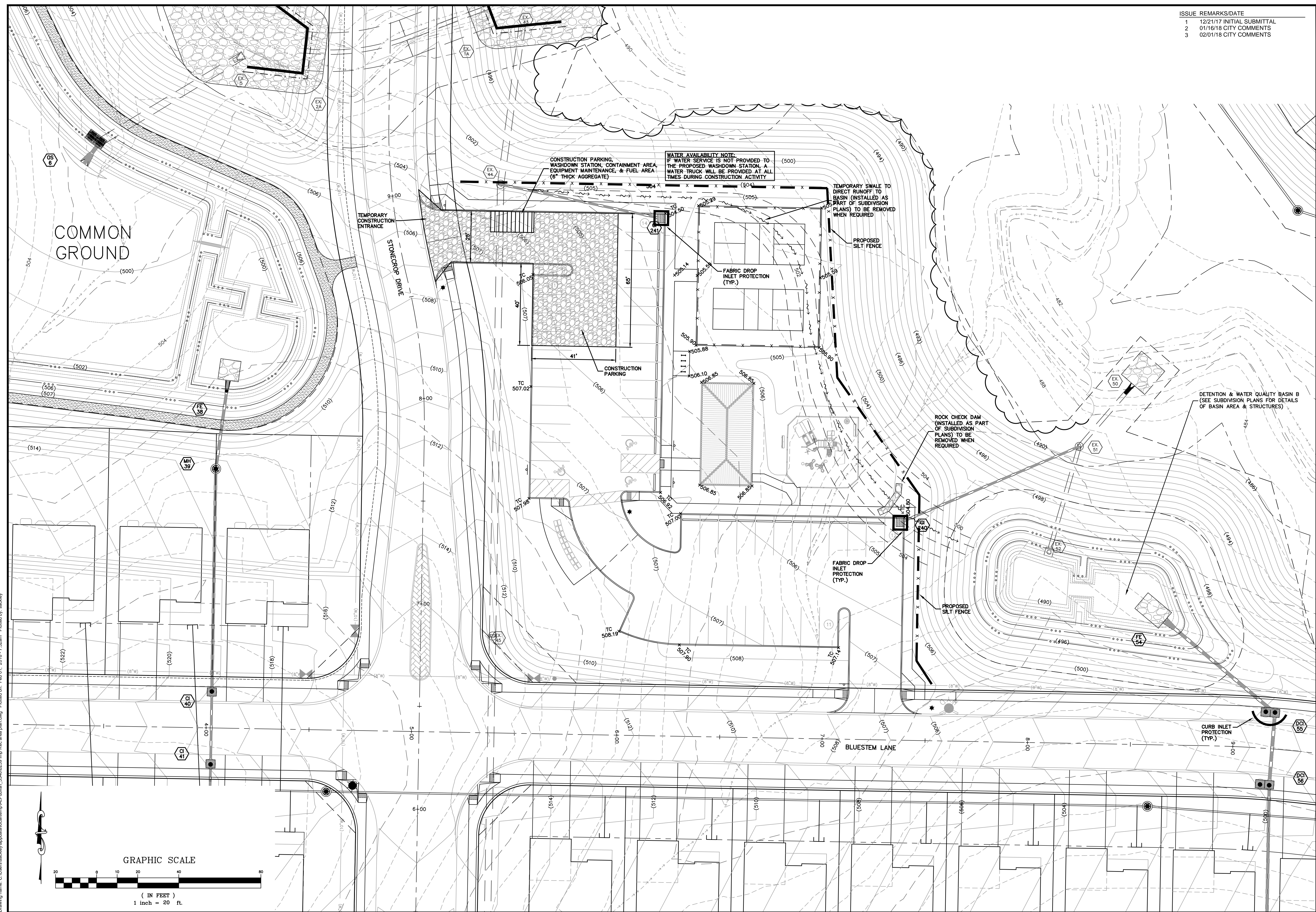

COMMON GROUND

WATER AVAILABILITY NOTE:
 IF WATER SERVICE IS NOT PROVIDED TO THE PROPOSED WASHDOWN STATION, A WATER TRUCK WILL BE PROVIDED AT ALL TIMES DURING CONSTRUCTION ACTIVITY

DETENTION & WATER QUALITY BASIN B
 (SEE SUBDIVISION PLANS FOR DETAILS OF BASIN AREA & STRUCTURES)

ROCK CHECK DAM
 (INSTALLED AS PART OF SUBDIVISION PLANS) TO BE REMOVED WHEN REQUIRED

FABRIC DROP INLET PROTECTION (TYP.)

CURB INLET PROTECTION (TYP.)

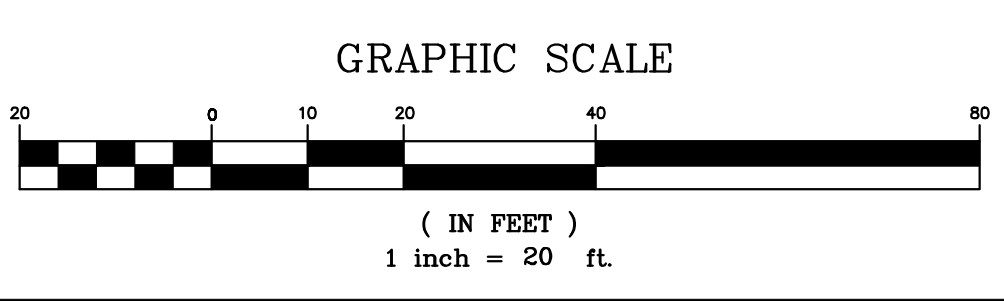

PROJECT TITLE

COBBLESTONE CROSSING
 OFALLON, MISSOURI

THE STERLING CO.
 ENGINEERS & SURVEYORS
 5055 New Baumgartner Road
 St. Louis, Missouri 63129
 Ph 314-487-0440 Fax 314-487-8944
 www.sterling-eng-sur.com
 Corporate Certificate of Authority #001348



Date: 02/01/18
 Sean M. Ackley
 License No. PE-2009018679
 Civil Engineer

McBRIDE HYLAND GREEN, LLC
 16091 SWINGLEY RIDGE ROAD, SUITE 300
 CHESTERFIELD, MISSOURI 63017
 Ph. 636-537-2000
 Fax 636-537-2546
 www.mcbridehomes.com

STORM WATER POLLUTION PREVENTION PLAN

P+Z No. 29-16.01
 City No.
 Date: Feb. 1, 2018
 Job No. 16-08-239

Page No.

3.1

SITE

Drawing name: C:\Users\sackley\appdata\local\temp\AcPublish_53488239.tmp_Rec area plan.dwg. Plotted on: Feb 01, 2018 - 7:32am. Plotted by: sackley