

NEW CARWASH FOR:
CONVENIENT FOOD MART
 FEISE ROAD AND HIGHWAY 'K'
 OF FALLON, MISSOURI

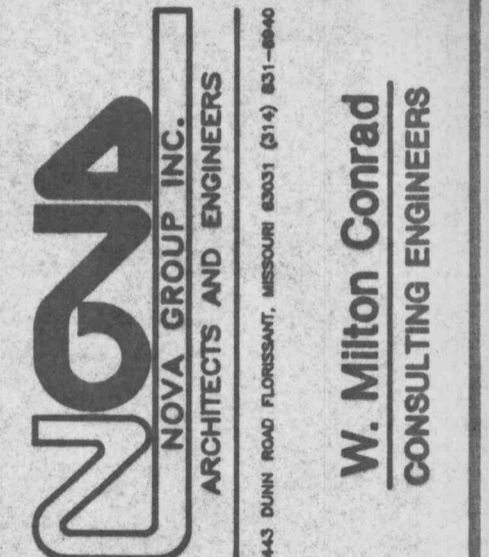
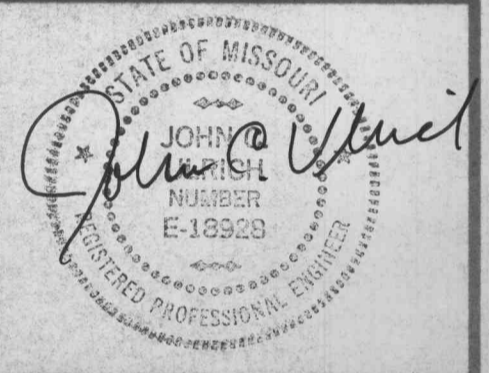

project no. 92018A
 drawn by
 date 5-30-92
 revision 1 5-7-92

SITE PLAN

C-1
 sheet 1 of 1

- KEYED NOTES:**
- RELOCATE POLE AND LIGHT FIXTURE TO DRIVE LEADING TO CARWASH.
 - REWIRE RELOCATED LIGHT POLE AND FIXTURE AS SHOWN.
 - REWORK GRADES TO SPOT ELEVATIONS AS SHOWN.
 - RELOCATE POLE AND LIGHT FIXTURE TO EDGE OF PAVEMENT AT WEST SIDE OF CONVENIENT FOOD MART AS SHOWN.
 - DO NOT ENTER SIGN BY OWNER.
 - KEY PAD AND CONCRETE PIER SEE DETAIL 1/M/A1.
 - NOT USED
 - 2'-0" X 2'-0" X 4" THICK CONCRETE PADS ON GRADE FOR VACUUM CLEANERS. VERIFY SIZE, LOCATION, AND ANCHORAGE WITH OWNER AND MANUFACTURER PRIOR TO INSTALLATION.
 - INSTALL PRECAST INTERCONNECTING, PRESLOPED TRENCH DRAINAGE SYSTEM IN CONCRETE SLAB PER MANUFACTURER'S RECOMMENDATIONS. PRECAST TRENCH DRAINAGE SYSTEM SHALL BE BY 'L.M. SCOFFIELD COMPANY' INDUSTRIAL SERIES 3-100 WITH CAST IRON GRATING OR EQUAL.
 - OUT EXISTING CONCRETE CURB AND PROVIDE SWALE IN GRADE TO ALLOW FOR DRAINAGE OF TRAPPED WATER.
 - REMOVE SECTION OF CONCRETE AND REPLACE IF REQUIRED.
 - 6" Ø PVC PIPE TO BE INSTALLED WITH NO LESS THAN 1% SLOPE AND TO BE TIED INTO EXISTING INLET ON THIS PROPERTY AS SHOWN. VERIFY THAT 6" Ø PVC PIPE CAN BE CONNECTED TO PRECAST TRENCH DRAIN.
 - ADD ADDITIONAL LIGHT FIXTURE TYPE 'E' TO RELOCATED LIGHT POLE. SEE SHEET 5-1.

NOTE:
 PER THE GENERAL CONTRACTOR FOR THIS PROJECT THE INSTALLATION OF STORM SEWER AND SANITARY SEWER MODIFICATIONS AS SHOWN ON THIS PLAN HAS BEEN REVIEWED AND APPROVED BY DUCKETT CREEK SEWER DISTRICT.

NEW TREE TO BE PIN OAK (QUERCUS PALUSTRIS) 2" CALIPER, 6' TALL MIN. TYPICAL 3 PLACES.

NOTE:
 REPAIR OF TWO LARGE AREAS OF ASPHALT PAVEMENT IN THIS AREA IS TO BE ADDRESSED AT A LATER DATE. IT IS THE OWNERS INTENTION TO HAVE ENTIRE LOT RESURFACED AFTER SOME FUTURE UNDERGROUND MODIFICATIONS ARE PERFORMED

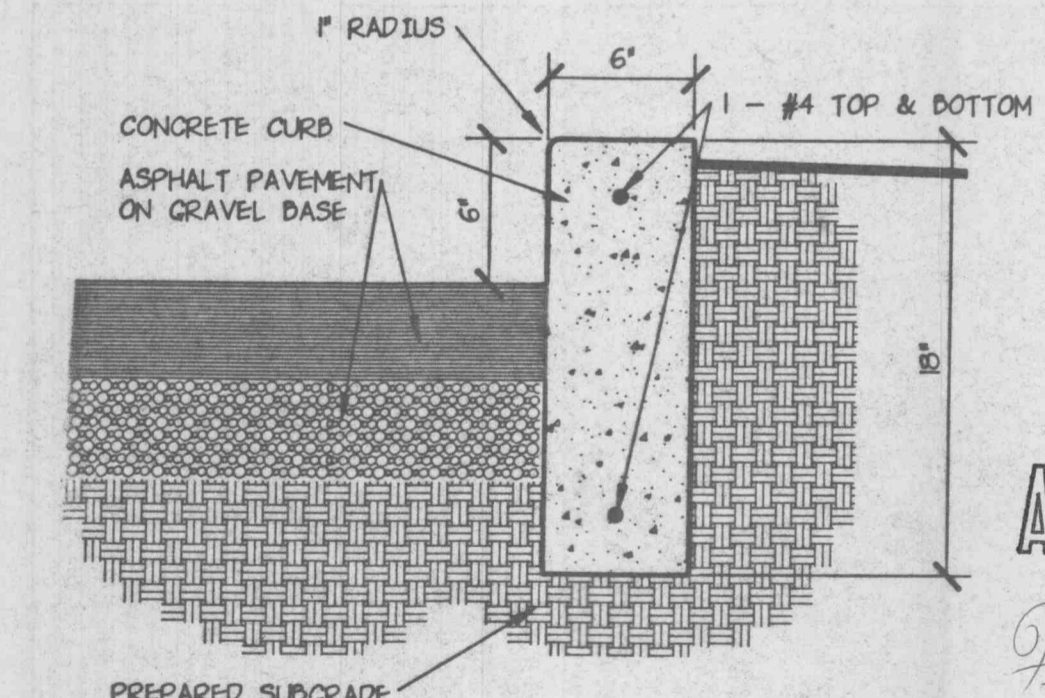

CONCRETE CURB DETAIL
 SCALE: 1 1/2" = 1'-0"

File Copy
APPROVED
 8-11-92
 Frank Adams

APPROVED
 DATE 8/11/92 JP
 P & Z

DRAWING INDEX

C-1	SITE PLAN
A-1	FLOOR PLAN & ELEVATIONS
A-2	SECTIONS & DETAILS
A-3	ROOF PLAN & DETAILS
A-4	SPECIFICATION
A-5	SPECIFICATION
MP-1	PLUMBING & MECH
E-1	ELECTRICAL FLOOR PLAN

LEGEND:

T/C	TOP OF NEW CONCRETE CURB
T/P	TOP OF NEW ASPHALT PAVEMENT
---	NEW 3" ASPHALT PAVEMENT ON 8" ROCK BASE - SEE SPEC.
---	NEW 6" THICK CONCRETE SLAB REINFORCED WITH 2 LAYERS OF W2.1 X W2.1 W.W.F.
---	PROPERTY LINE
---	EASEMENT LINE
-G-04	EXISTING CONTOUR LINE
-E-	ELECTRIC LINE (EXIST.)
-W-	WATER LINE (EXIST.)
-SAN-	SANITARY SEWER (EXIST.)
○	MANHOLE
⊗	WATER METER
●	UTILITY POLE
□	EXISTING 1/2" POLE LIGHT
■	NEW POLE LIGHT AND FIXTURE

GENERAL NOTES:

- EXISTING INFORMATION SHOWN ON THIS DRAWING IS BASED ON DOCUMENTS RECEIVED FROM OWNER. VERIFY EXISTING CONDITIONS PRIOR TO CONSTRUCTION.
- REWORK GRADES TO SPOT ELEVATIONS AS SHOWN.
- LOCATE EXISTING UNDERGROUND UTILITIES PRIOR TO STARTING CONSTRUCTION.

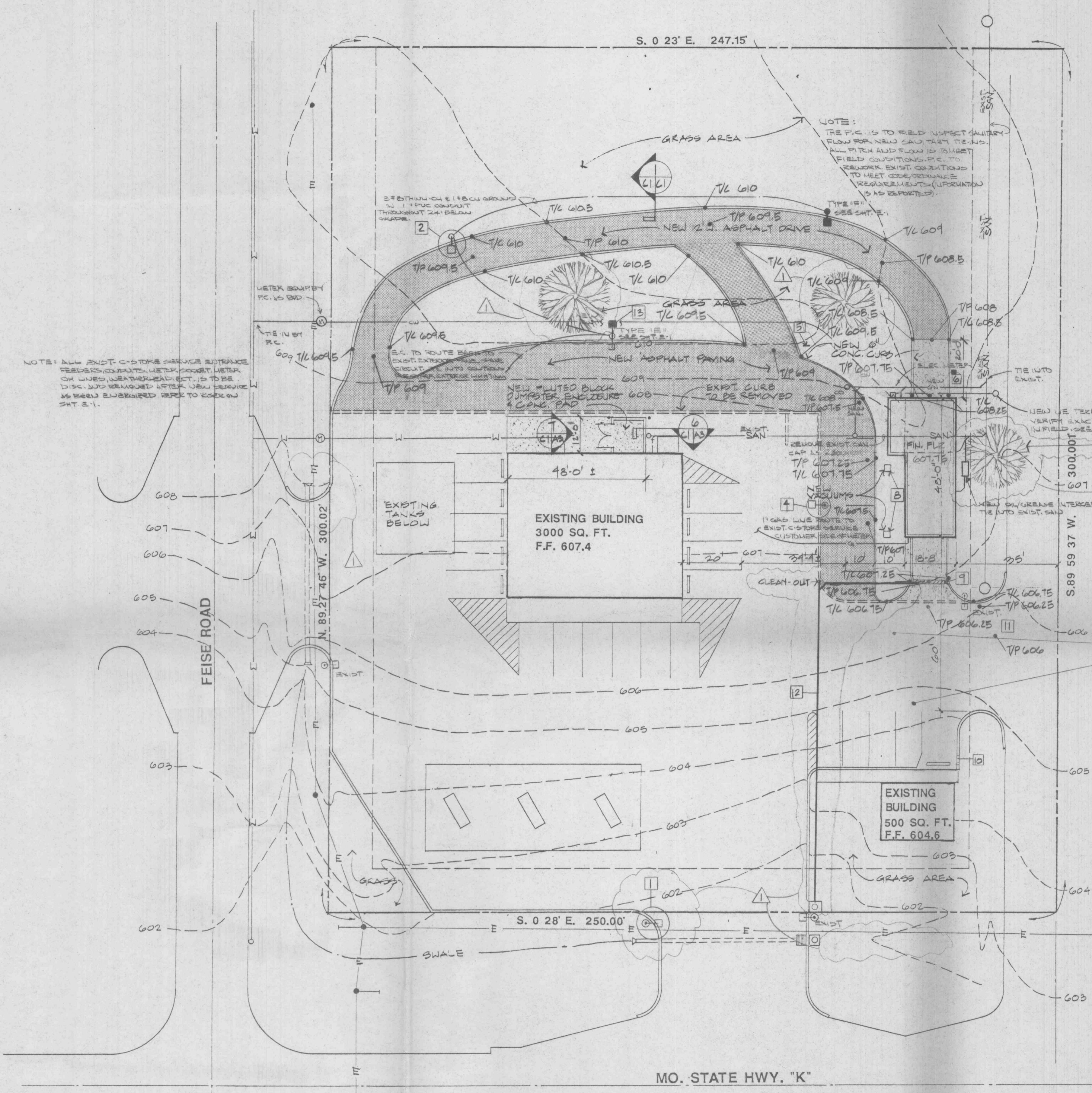

SITE PLAN
 1" = 20'