



Missouri One Call System, Inc.
 Call Before You Dig!
 1-800-DIG-RITE
 (1-800-344-7483)

All the improvements & facilities and utilities, above ground and underground shown herein were plotted from available information and do not necessarily reflect the actual existence, nonexistence, elevation, size, type, number or location of these or other improvements, facilities, or utilities. The General Contractor and/or owner shall be responsible for verifying the actual location & elevation of all improvements, facilities, & utilities, shown or not shown, and said improvements, facilities, & utilities shall be located in the field prior to any grading, excavation or construction of any improvements. These provisions shall in no way absolve any part from complying with the Underground Facility Safety & Damage Prevention Act, Chapter 319, RSMo.

CALL MISSOURI ONE-CALL, 1-800-DIG-RITE

STORM SEWER NOTES:

- CONTRACTOR TO FOLLOW ALL STANDARDS SET FORTH BY THE CITY OF O'FALLON SECTION 405.230.
- ALL STORM AND SANITARY SEWER STRUCTURES ARE TO BE PRECAST CONCRETE, BRICK SHALL NOT BE USED IN THE CONSTRUCTION OF STORM OR SANITARY SEWER STRUCTURES.
- STORM SEWER PIPES NOT LOCATED IN PUBLIC RIGHT-OF-WAY OR EASEMENT SHALL BE REINFORCED CONCRETE PIPE. STORM SEWERS 18 INCHES IN DIAMETER OR SMALLER SHALL BE ASTM C-14, ASPHALT COATED, POLYMER OR ALUMINIZED COATED CORRUGATED STEEL PIPE OR THERMOPLASTIC PIPE MAY BE SUBSTITUTED WITH APPROPRIATE SUBMITTED CALCULATIONS.
- ALL PIPE JOINTS TO BE GASKETED O-RING TYPE.
- MINIMUM OF 36" COVER OVER STORM LINES.
- ENSURE 0.20' DROP THROUGH ALL STRUCTURES AND MANHOLES.
- PROVIDE 5/8" DIA. TRASH BAR FOR ALL INLETS.
- HDPE PIPE IS TO BE N-12WT OR EQUAL AND SHALL MEET ASTM F1417 WATER TIGHT FIELD TEST PER CITY STANDARDS.
- PROVIDE GRANULAR FILL AROUND SANITARY LINES WITH TRENCHES WITHIN 10 FEET OF THE EDGE OF PAVEMENT CURB AND IN THE 1 TO 1 SHEAR PLANE OF THE ROAD.

- POLYVINYL CHLORIDE (PVC) SHALL CONFORM TO THE REQUIREMENT OF ASTM D-3034 STANDARD SPECIFICATIONS FOR THE PSM POLYVINYL CHLORIDE SEWER PIPE AND FITTINGS, SDR 35.
- CORRUGATED METAL PIPE SHALL CONFORM TO THE STANDARD SPECIFICATIONS FOR CORRUGATED CULVERT PIPE M 36, AASHTO.
- ALL STORM AND SANITARY TRENCH BACKFILLS WILL BE WATER JETTED. GRANULAR FILL TO BE USED UNDER PAVEMENT AREAS.
- ALL MANHOLE AND CATCH BASIN TOPS BUILT WITHOUT ELEVATIONS FURNISHED BY THE ENGINEER WILL BE THE RESPONSIBILITY OF THE SEWER CONTRACTOR. AT THE TIME OF CONSTRUCTION STAKE-OUT OF THE SEWER LINES, ALL CURB AND GRATE INLETS WILL BE STAKED. IF NORMAL FACE STAKES FALL IN LINE WITH SEWER CONSTRUCTION, THE SURVEYOR WILL SET THESE STAKES ON A DOUBLE OFF-SET. IT SHALL BE THE RESPONSIBILITY OF THE SEWER CONTRACTOR TO PRESERVE ALL FACE STAKES FROM DESTRUCTION.
- ALL STANDARD STREET CURB INLETS TO HAVE FRONT OF INLET 2 FEET BEHIND THE CURB.
- GAS, WATER, AND OTHER UNDERGROUND UTILITIES SHALL NOT CONFLICT WITH THE DEPTH OR HORIZONTAL LOCATION OF EXISTING AND PROPOSED SANITARY AND STORM SEWERS.
- ESTIMATED SANITARY SEWER FLOW: 2,000 G.P.D./AC. = 6,000 G.P.D.
- CONNECTIONS AT ALL SANITARY OR STORM STRUCTURES WITH PIPES 24" OR SMALLER TO BE MADE WITH A-LOCK JOINT OR EQUAL.

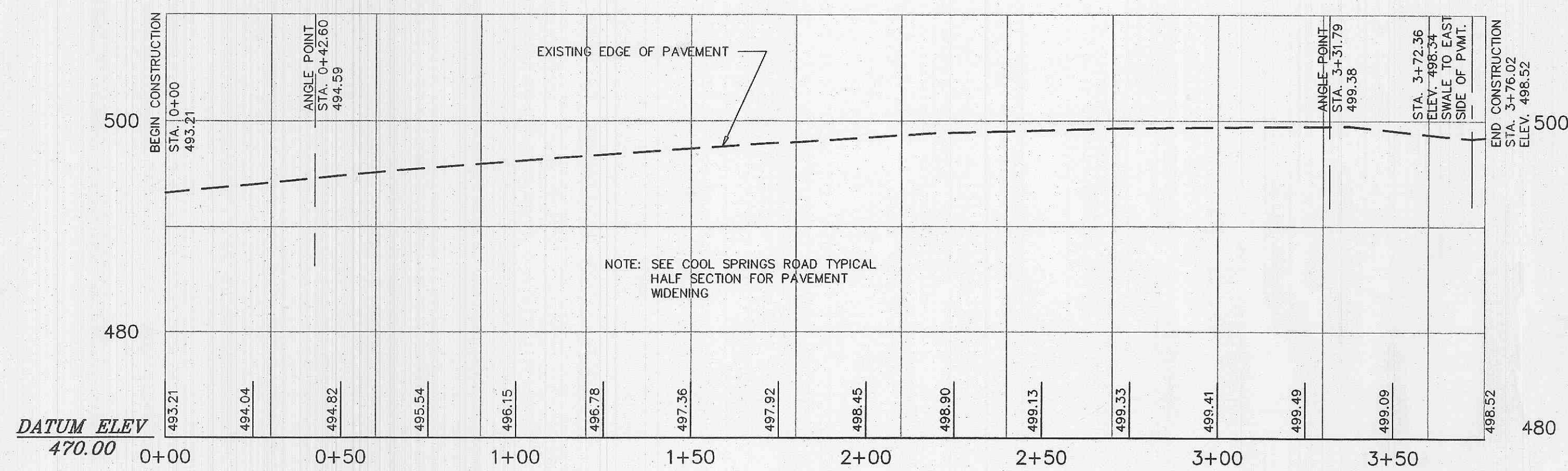

COOL SPRINGS ROAD EDGE OF PAVEMENT PROFILE

SCALE: 1"=30' HORIZ.
 1"=10' VERT.

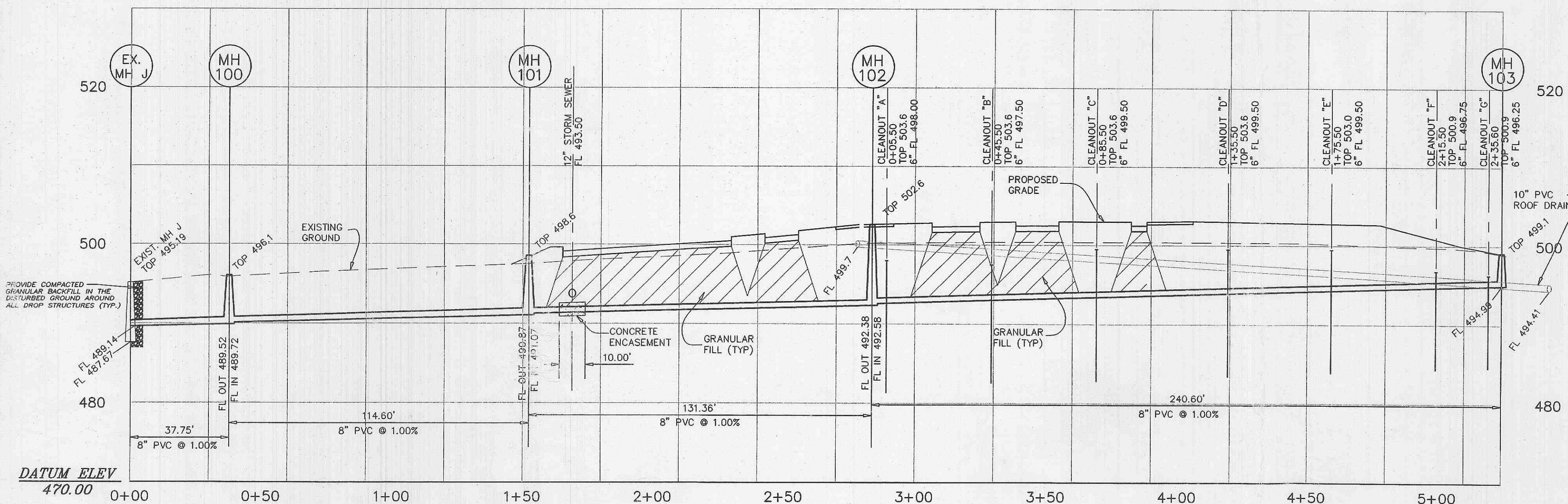

SANITARY SEWER PROFILES

NOTE: CONNECTIONS AT ALL SANITARY OR STORM STRUCTURES WITH PIPES 24" OR SMALLER TO BE MADE WITH A-LOCK JOINT OR EQUAL.

SCALE: 1"=30' HORIZ.
 1"=10' VERT.

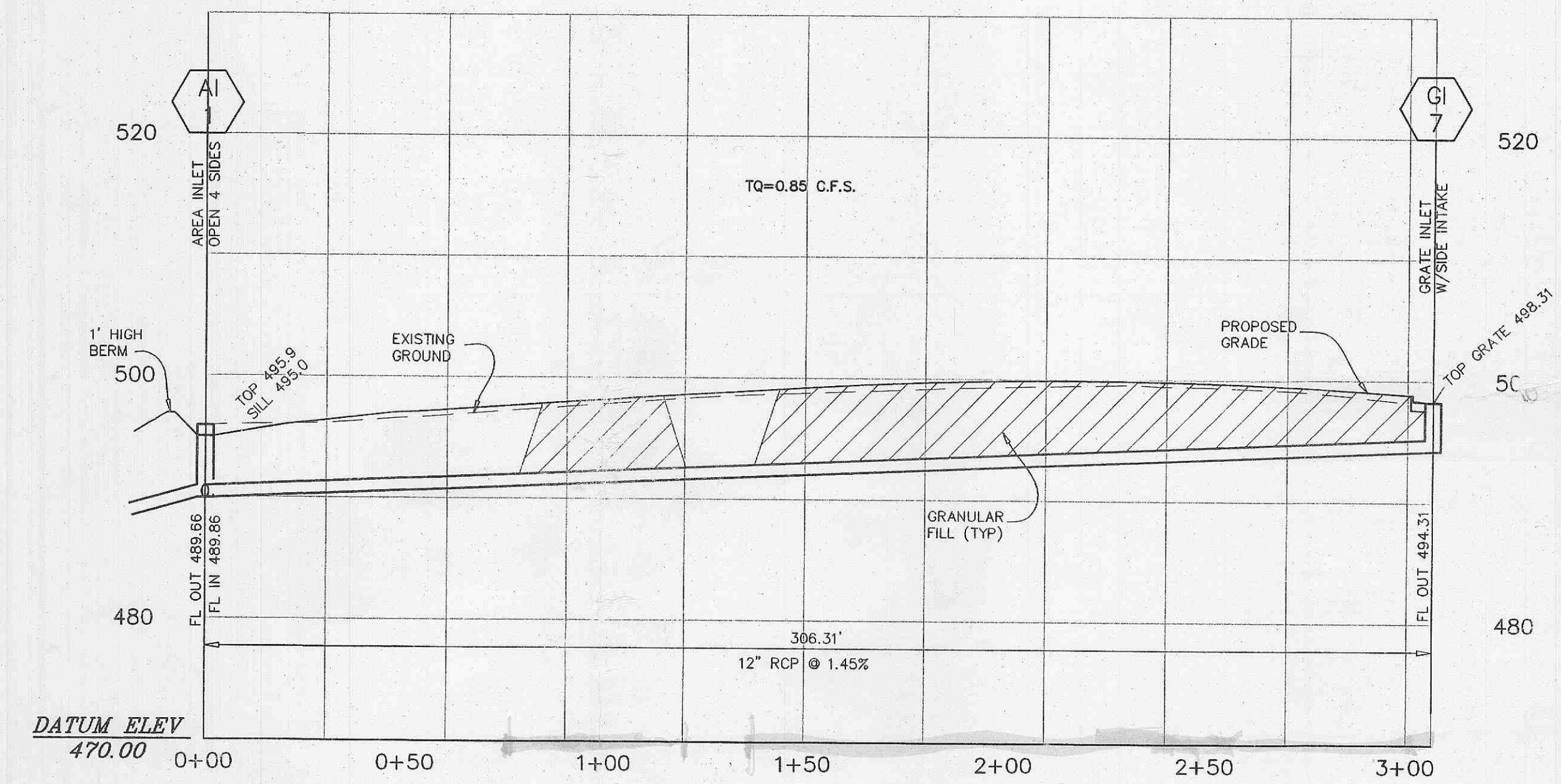

STORM SEWER PROFILES

SCALE: 1"=30' HORIZ.
 1"=10' VERT.

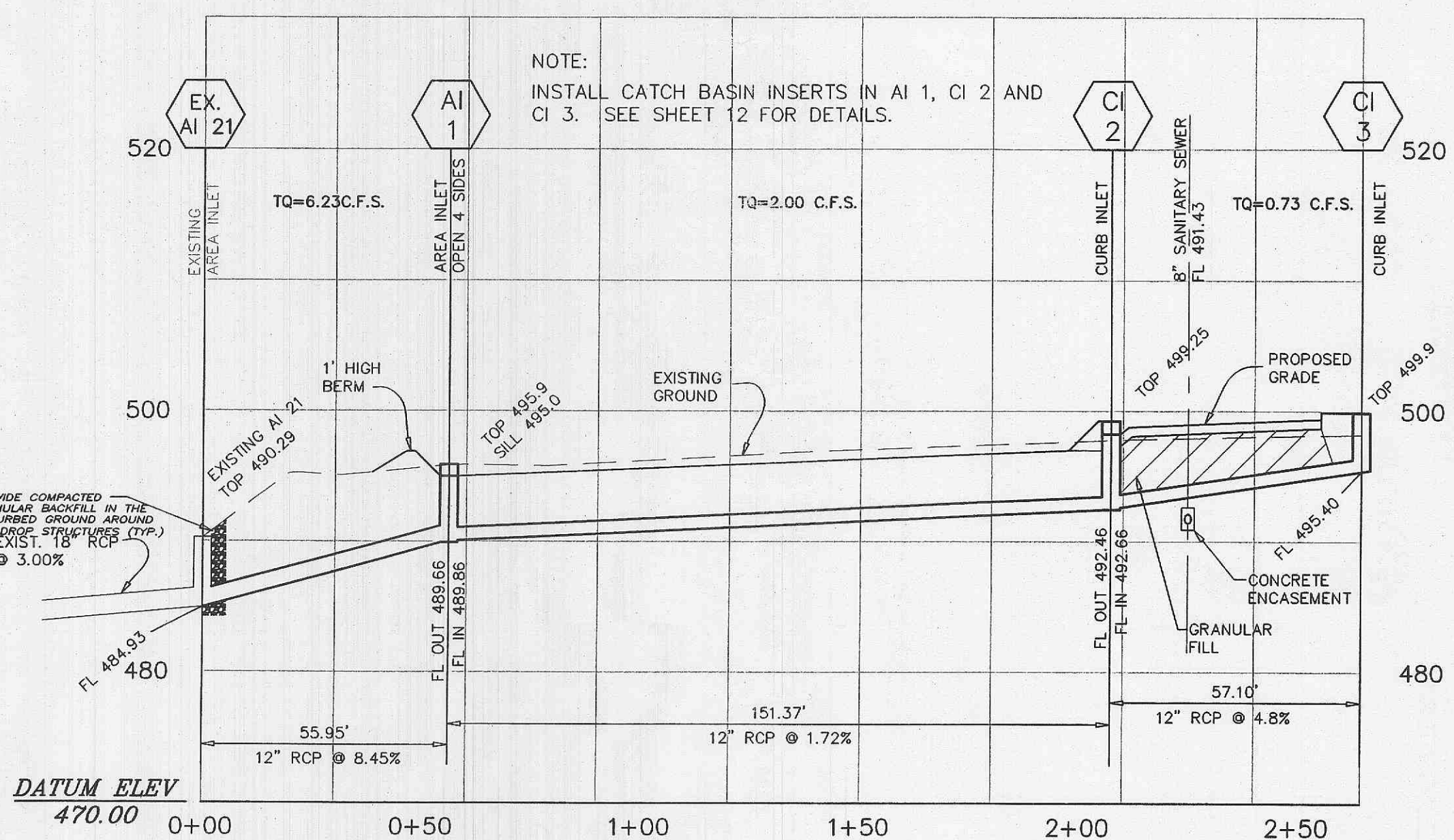

PRIVATE SEWER

NOTE: CONNECTIONS AT ALL SANITARY OR STORM STRUCTURES WITH PIPES 24" OR SMALLER TO BE MADE WITH A-LOCK JOINT OR EQUAL.

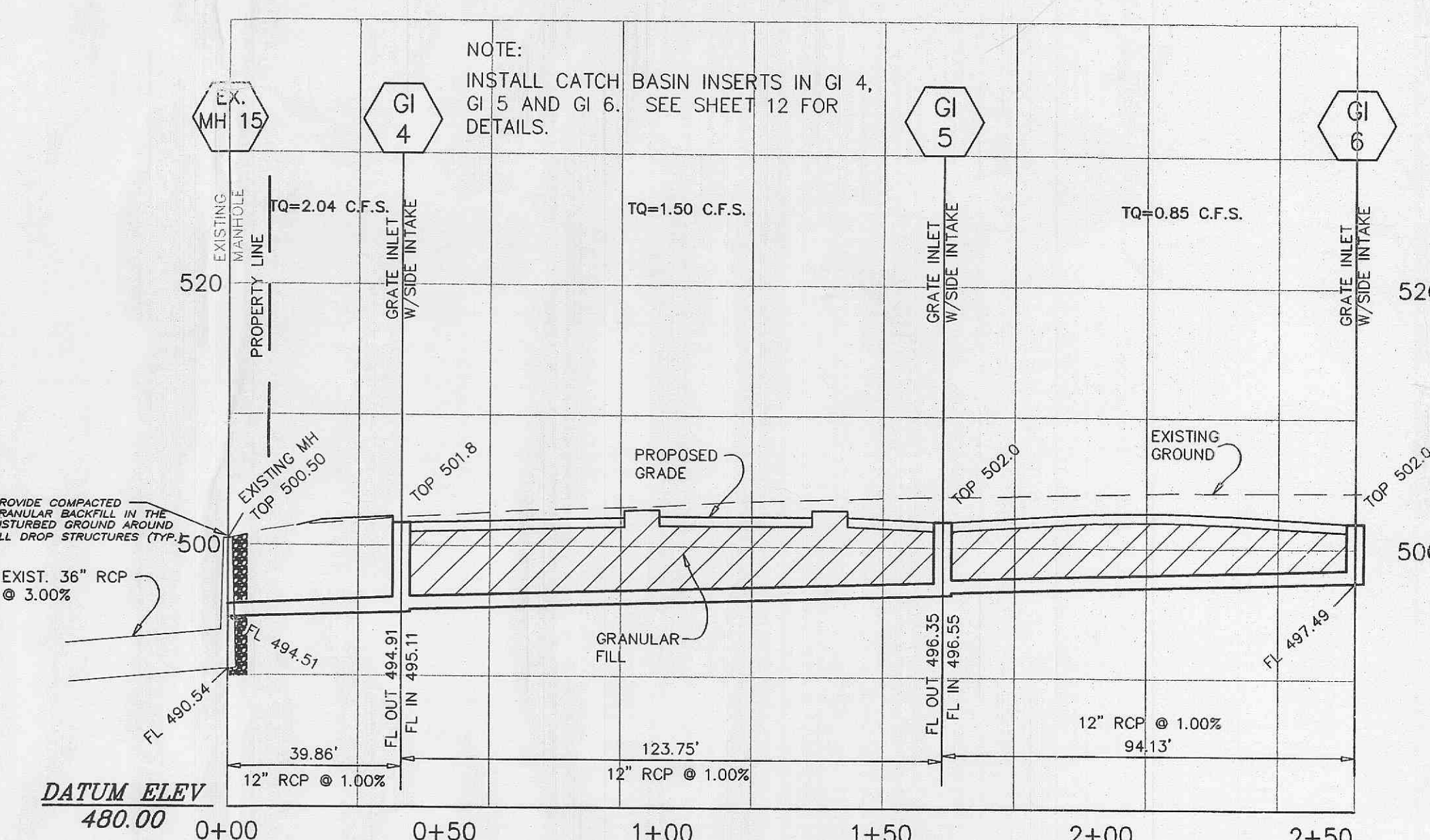

PRIVATE SEWER

SCALE: 1"=30' HORIZ.
 1"=10' VERT.

STORM SEWER PROFILES

O'FALLON P&Z # 904.01
 04/06/06

ENGINEERS CERTIFICATION:
 The following applies to ALL sheets and documents involved in the preparation of the plans and documents for this project. The responsibility for Professional Engineering liability on this project is limited to the set of plans displaying the signature and an original stamped seal of the Engineer on each sheet. ALL responsibility is Disclaimed: until ALL review agency approvals are granted, for all other plan sheets issued prior to this issue date, for this set when another set is issued after this date; if the sheets are used individually instead of a set. This applies for ALL sheets and documents involved in this project whether this certification appears on it or not. Copyright: All Rights Reserved.
 ZAVRADINOS & ASSOCIATES, INC. DBA
 ZAVRADINOS ENGINEERING & SURVEYING

