

PLANT SCHEDULE:

TREES	QTY	BOTANICAL/COMMON	SIZE
SHL	2	Gleditsia triacanthos 'Skyline' / 'Skyline' Locust	2.5' Cal
GL	6	Tilia cordata 'Greenspire' / Greenspire Littleleaf Linden	2.5' Cal
SHRUBS	QTY	BOTANICAL/COMMON	SIZE
CH	10	Ilex meserveae 'China Boy/Girl' TM / China Boy/Girl Holly	5 gal
AWS	7	Spiraea bumalda 'Anthony Waterer' / Anthony Waterer Spirea	5 gal
SGJ	21	Juniperus chinensis 'Sea Green' / Sea Green Juniper	5 gal
ANNUAL/PERENNIAL	QTY	BOTANICAL/COMMON	SIZE
HRD	15	Hemerocallis hybrid 'Happy Returns' / Happy Returns Daylily	1 gal
RS	7	Perovskia atriplicifolia / Russian Sage	1 gal
GRASSES	QTY	BOTANICAL/COMMON	SIZE
MLMG	3	Miscanthus sinensis 'Morning Light' / Morning Light Maiden Grass	5 gal

NOTES:
1. THE LANDSCAPE PLAN AND ASSOCIATED SHRUBERY AND PLANTING DETAILS ARE NOT COVERED BY THE CIVIL ENGINEER'S SEAL ON THESE IMPROVEMENT PLANS.

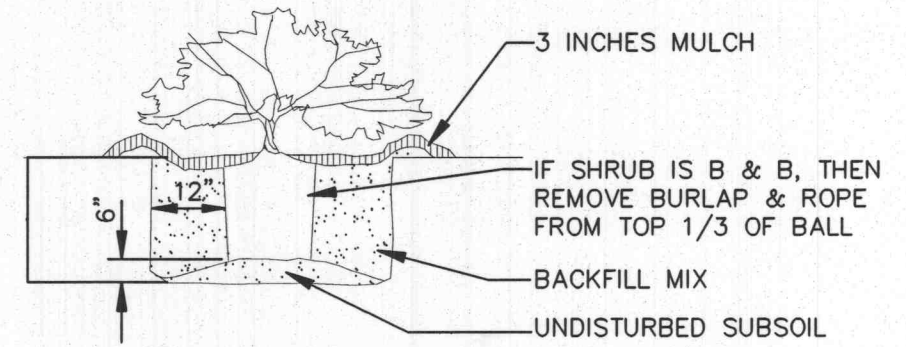

NOTE: USE SHREDDED BARK MULCH ONLY

SHRUB PLANTING
N.T.S.

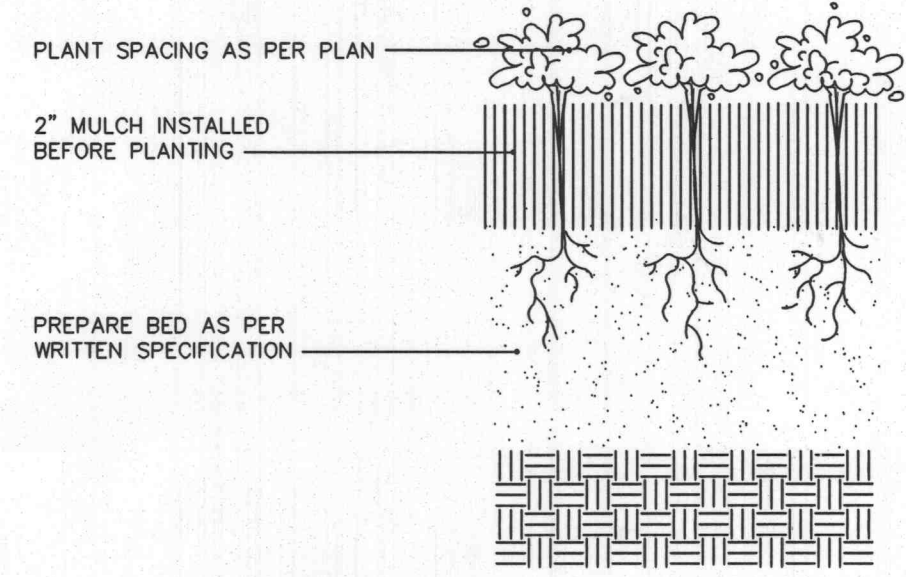

PERENNIAL / ANNUAL PLANTING
N.T.S.

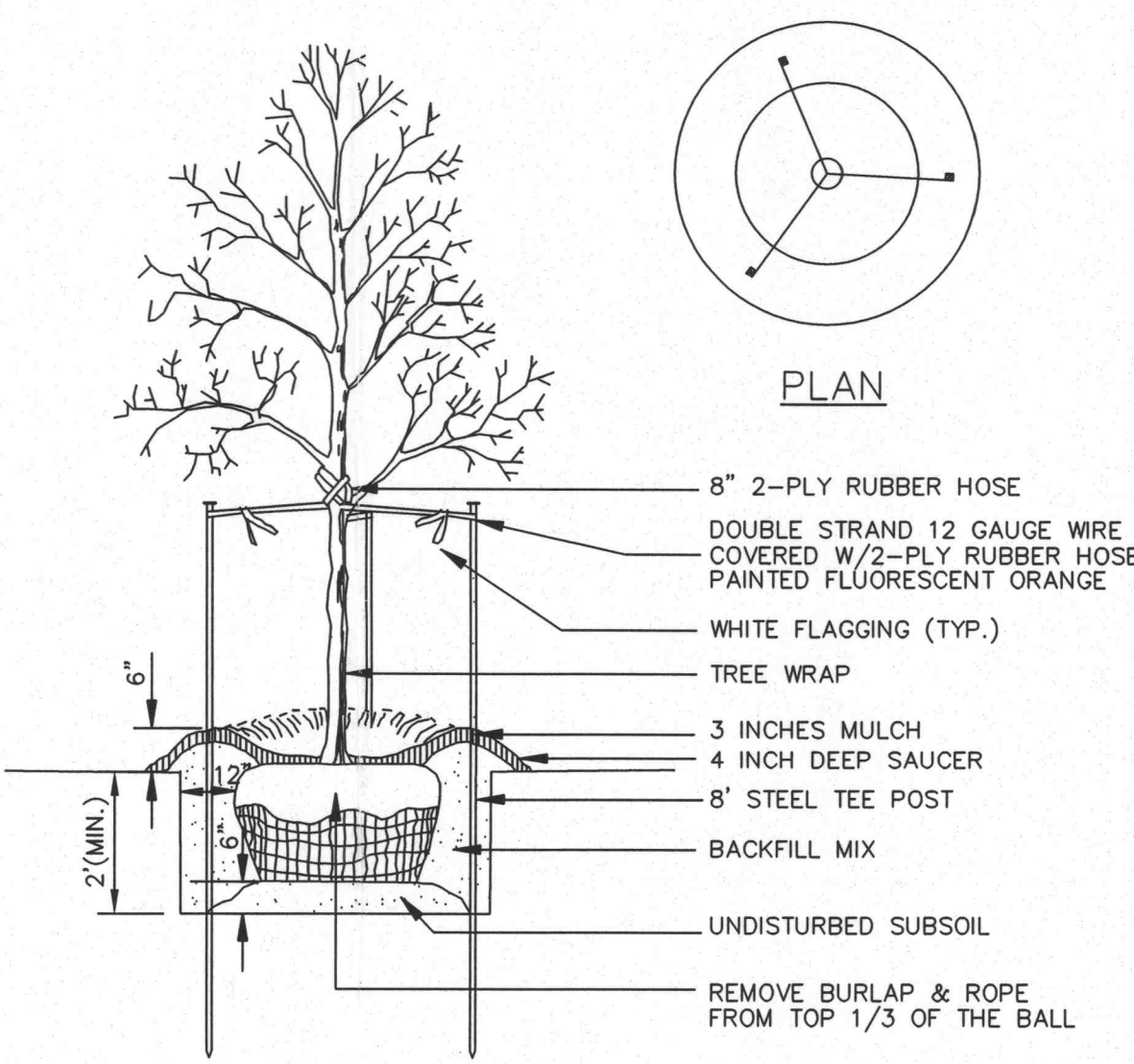

DECIDUOUS TREE PLANTING
N.T.S.

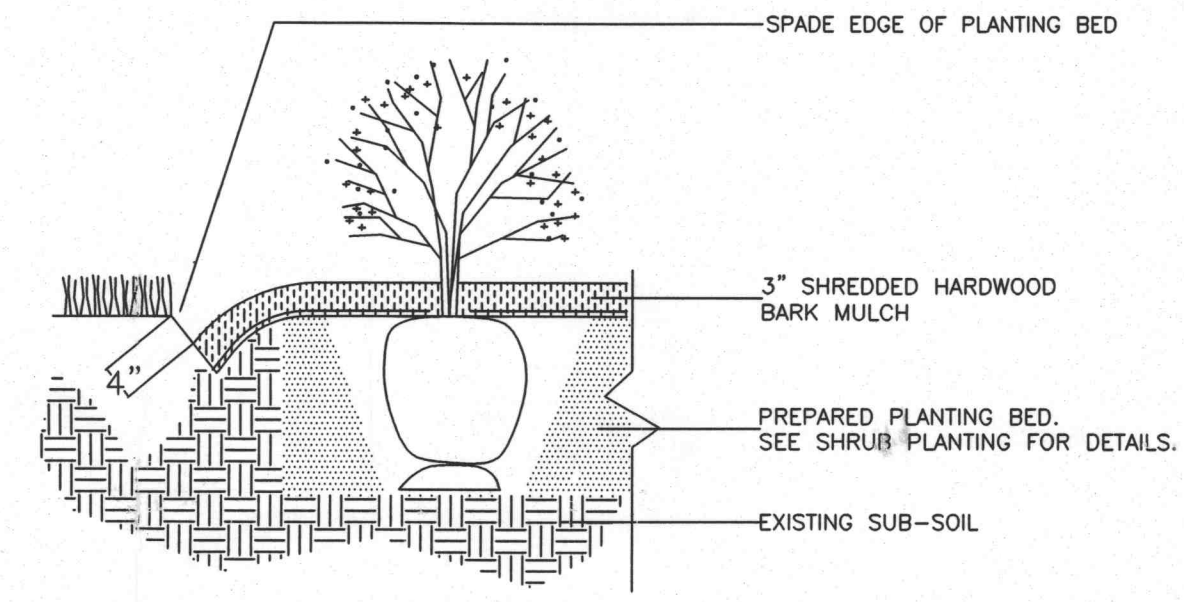

SPADE-CUT EDGE DETAIL
N.T.S.

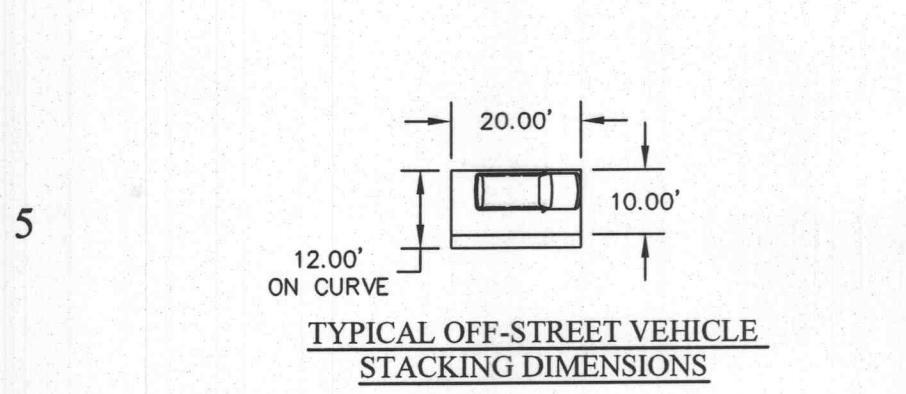
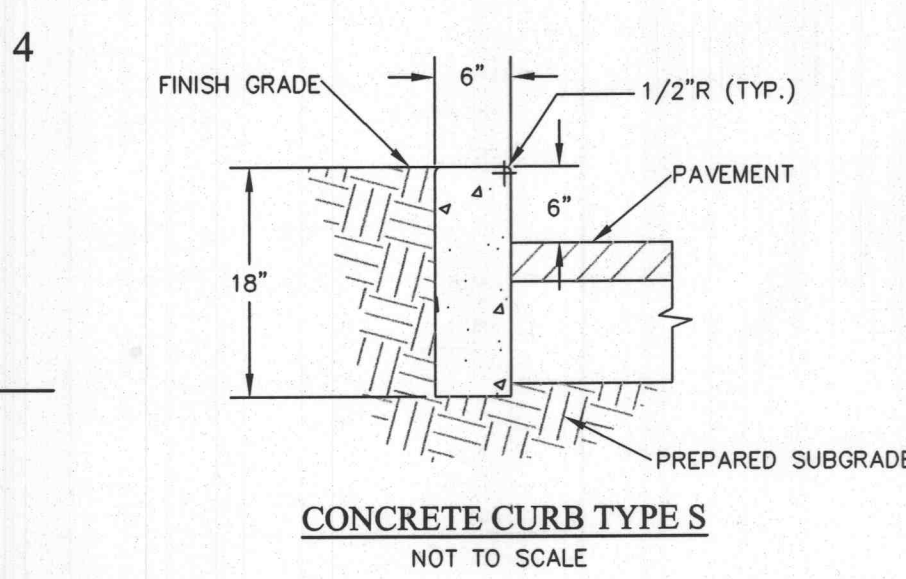

Missouri One Call System, Inc.
Call Before You Dig!
1-800-DIG-RITE
(1-800-344-7483)

All the improvements & facilities and utilities, above ground and underground shown herein were plotted from available information and do not necessarily reflect the actual existence, nonexistence, elevation, size, type, number or location of these or other improvements, facilities, or utilities. The General Contractor and/or owner shall be responsible for verifying the actual location & elevation of all improvements, facilities, & utilities shown or not shown, and all improvements, facilities, & utilities shall be located in the field prior to any grading, excavation or construction of any improvements. These provisions shall in no way relieve any party from complying with the Underground Facility Safety & Damage Prevention Act, Chapter 319, RSMo. CALL MISSOURI ONE-CALL, 1-800-DIG-RITE.

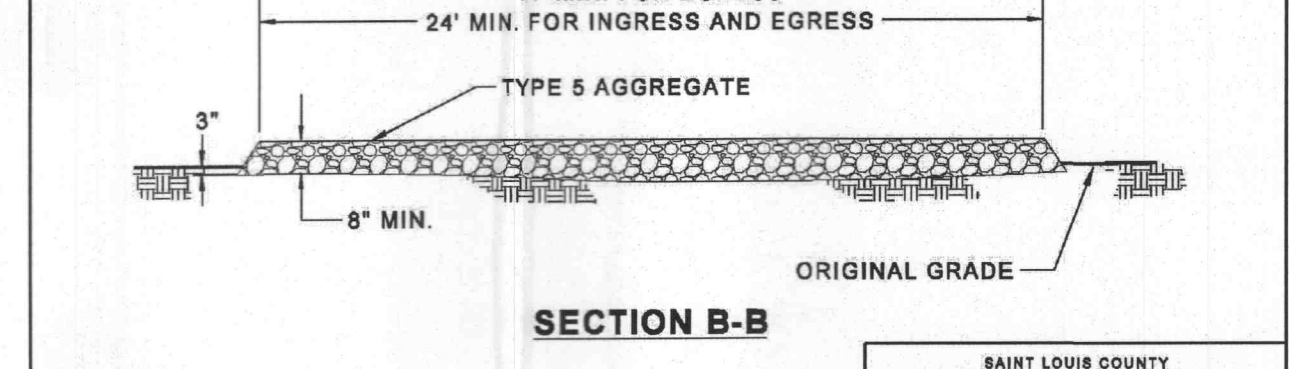
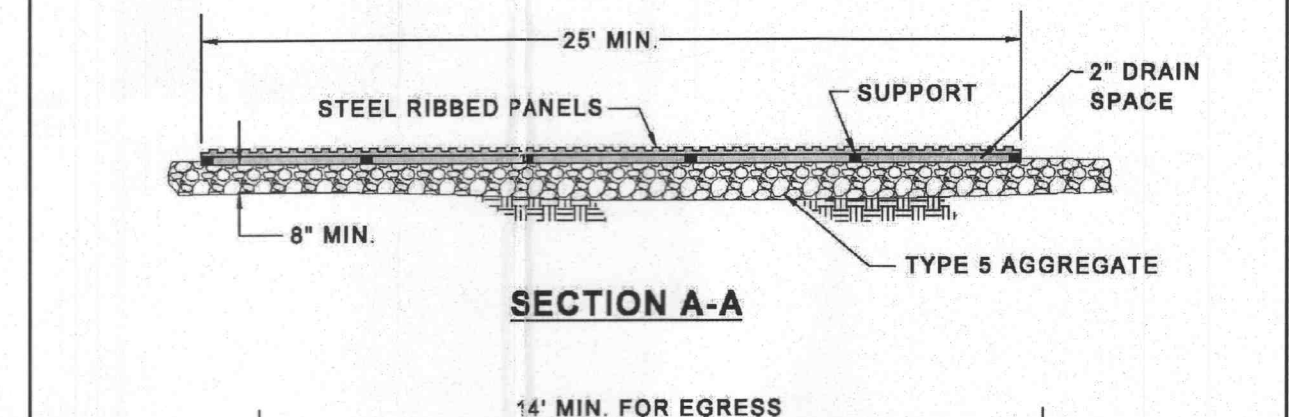
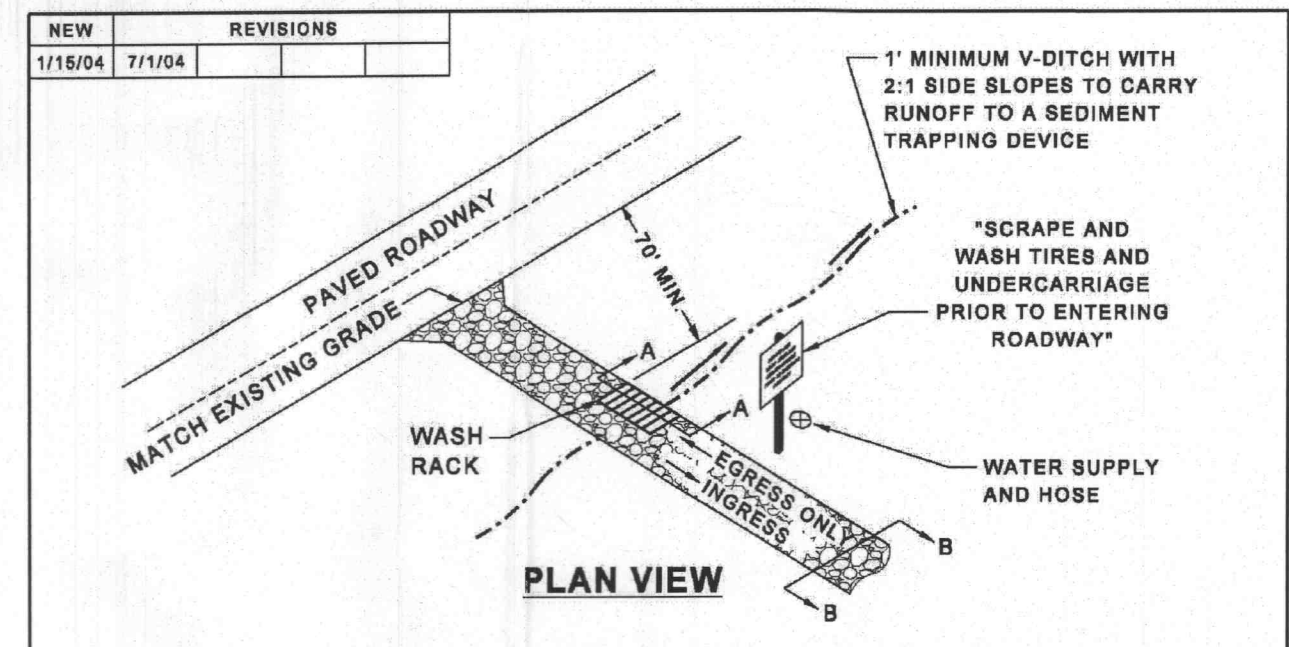

SAINT LOUIS COUNTY
DEPARTMENT OF HIGHWAYS AND TRAFFIC
KLAYTON, MISSOURI
TYPICAL BMP DETAIL
WASHDOWN STATION
REVISION DATE: July 1, 2004
DRAWING TC-4

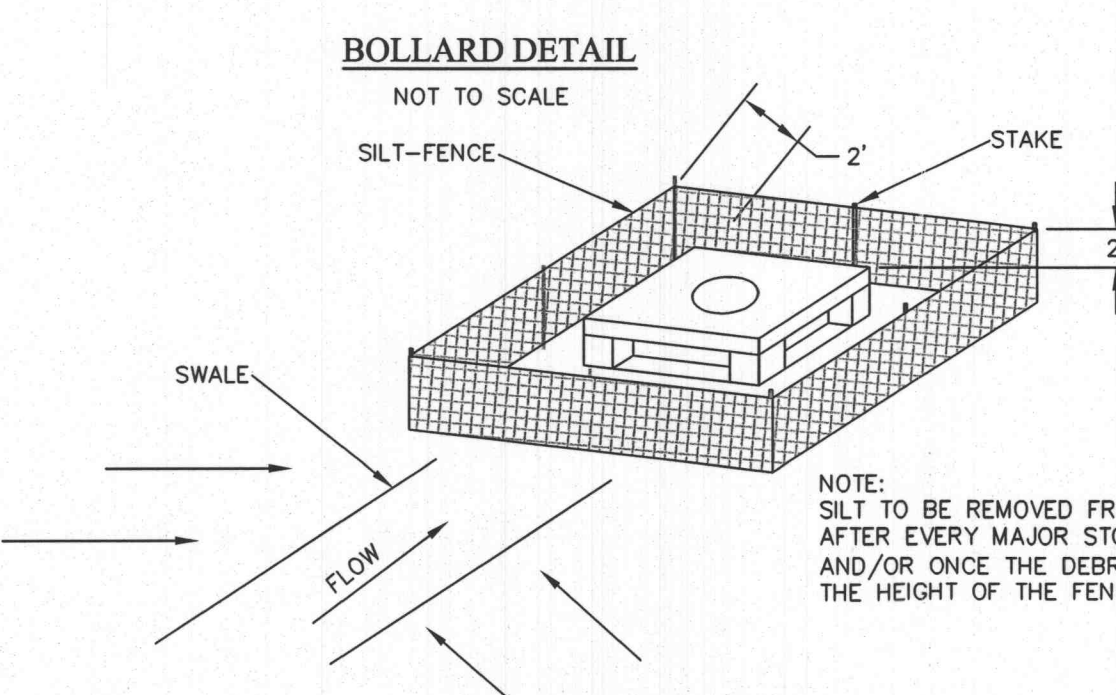
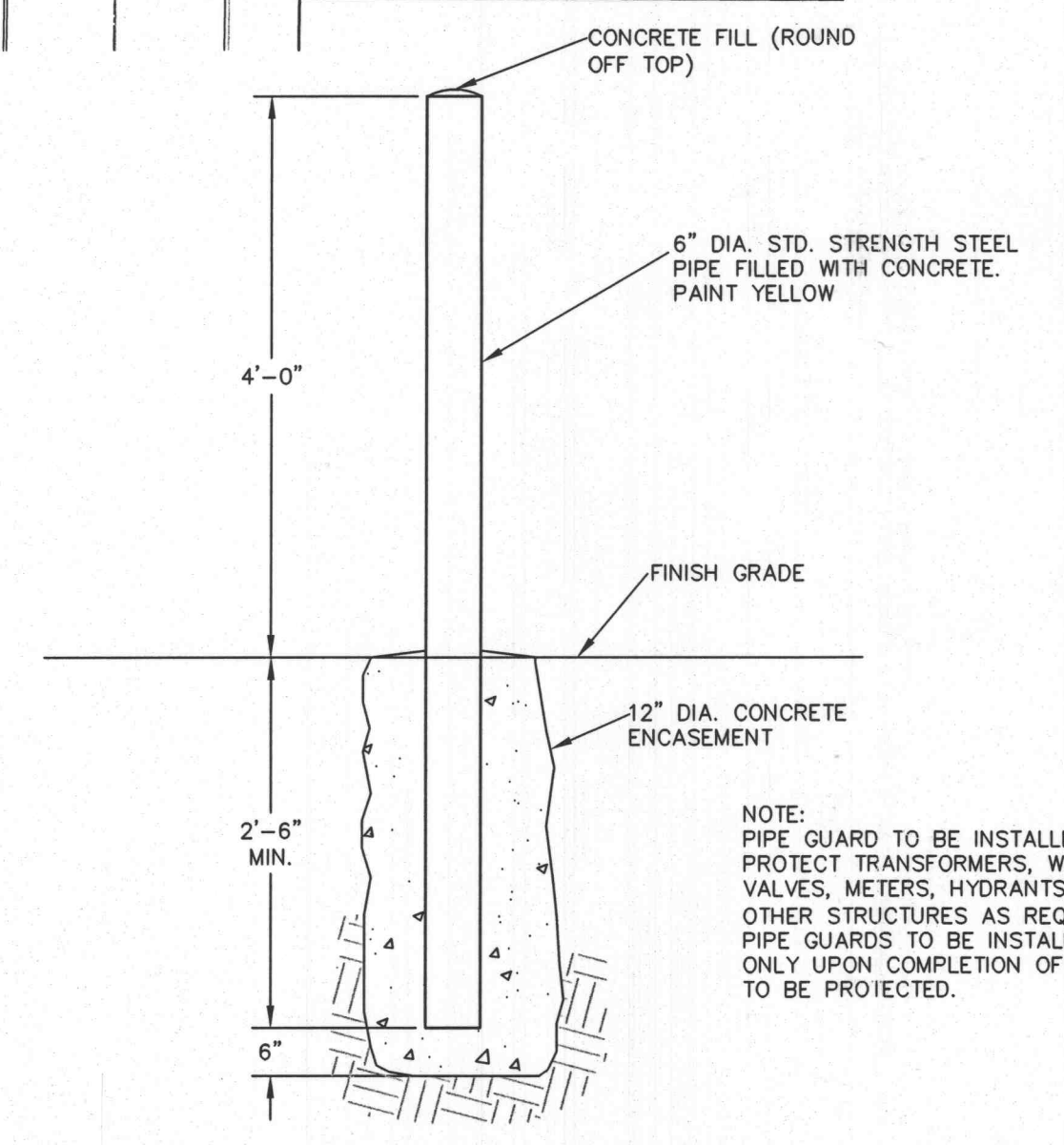

SILTATION CONTROL AROUND AREA INLETS
NOT TO SCALE

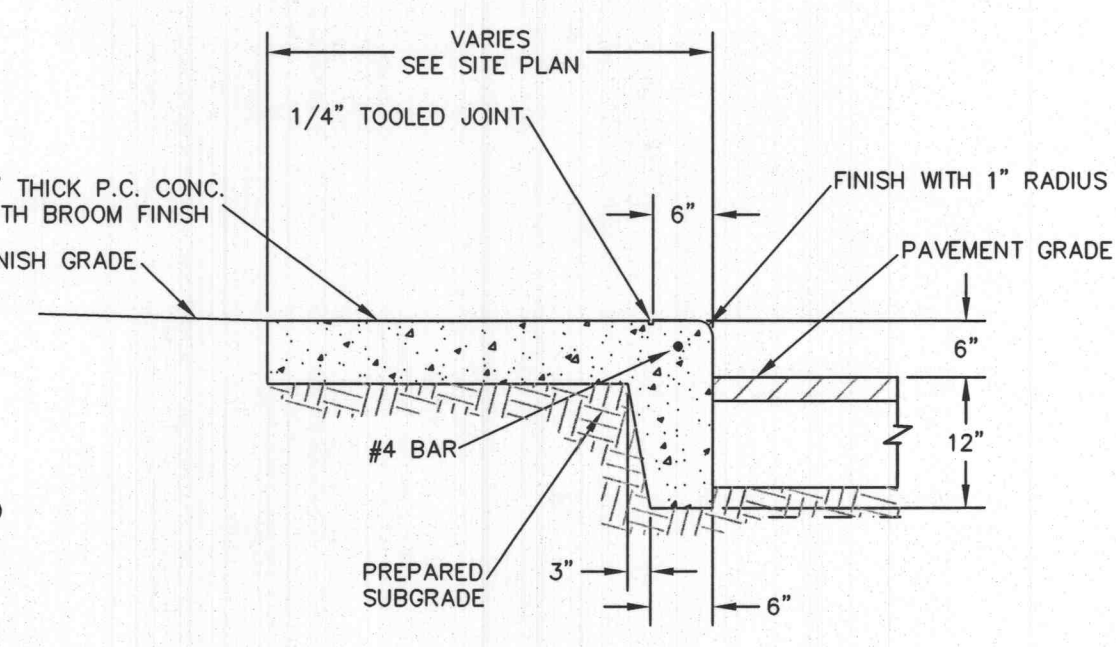

RAISED CONCRETE ISLAND
NOT TO SCALE

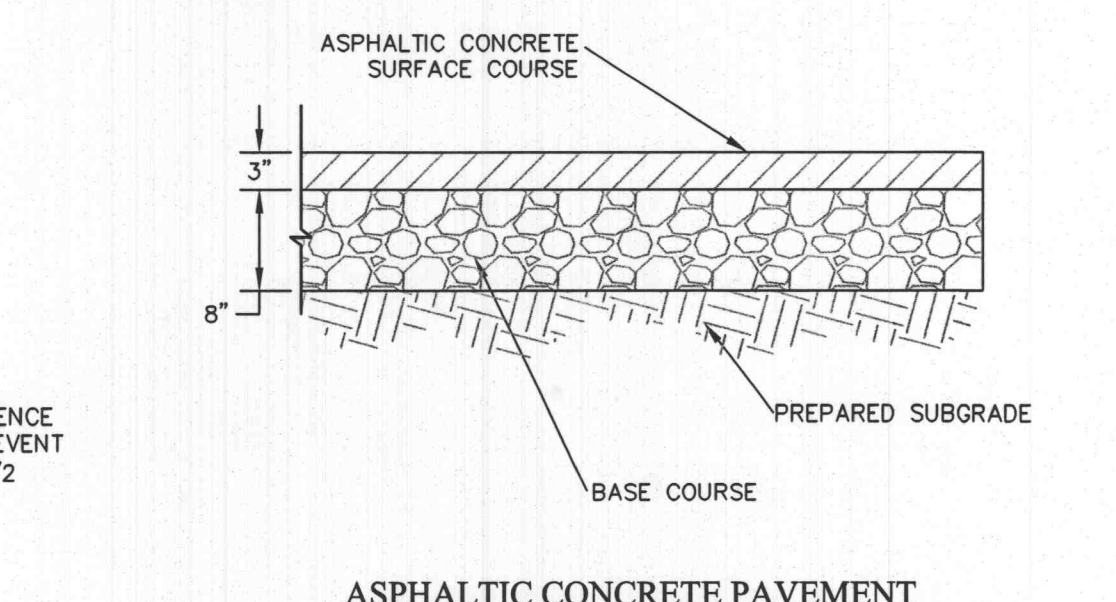

ASPHALTIC CONCRETE PAVEMENT
NOT TO SCALE

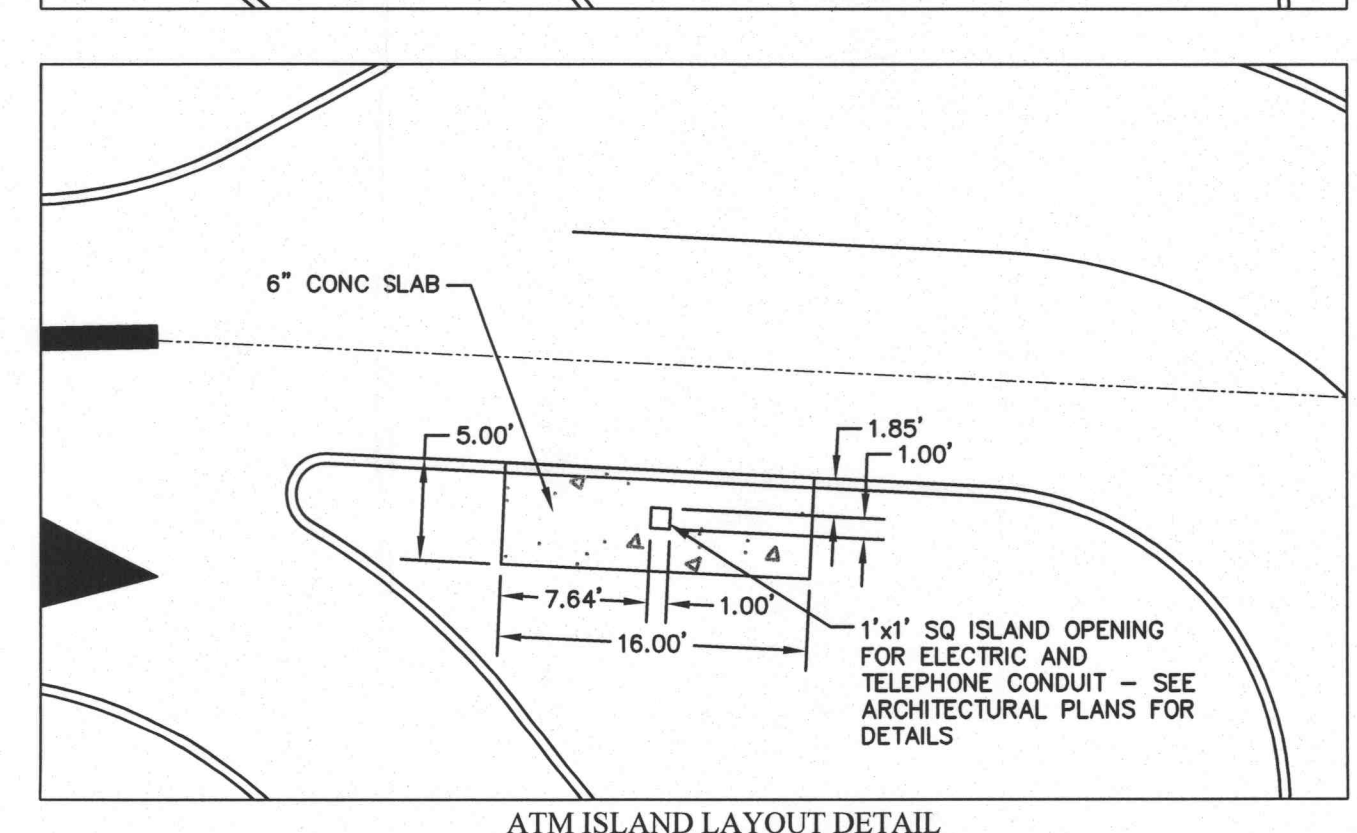
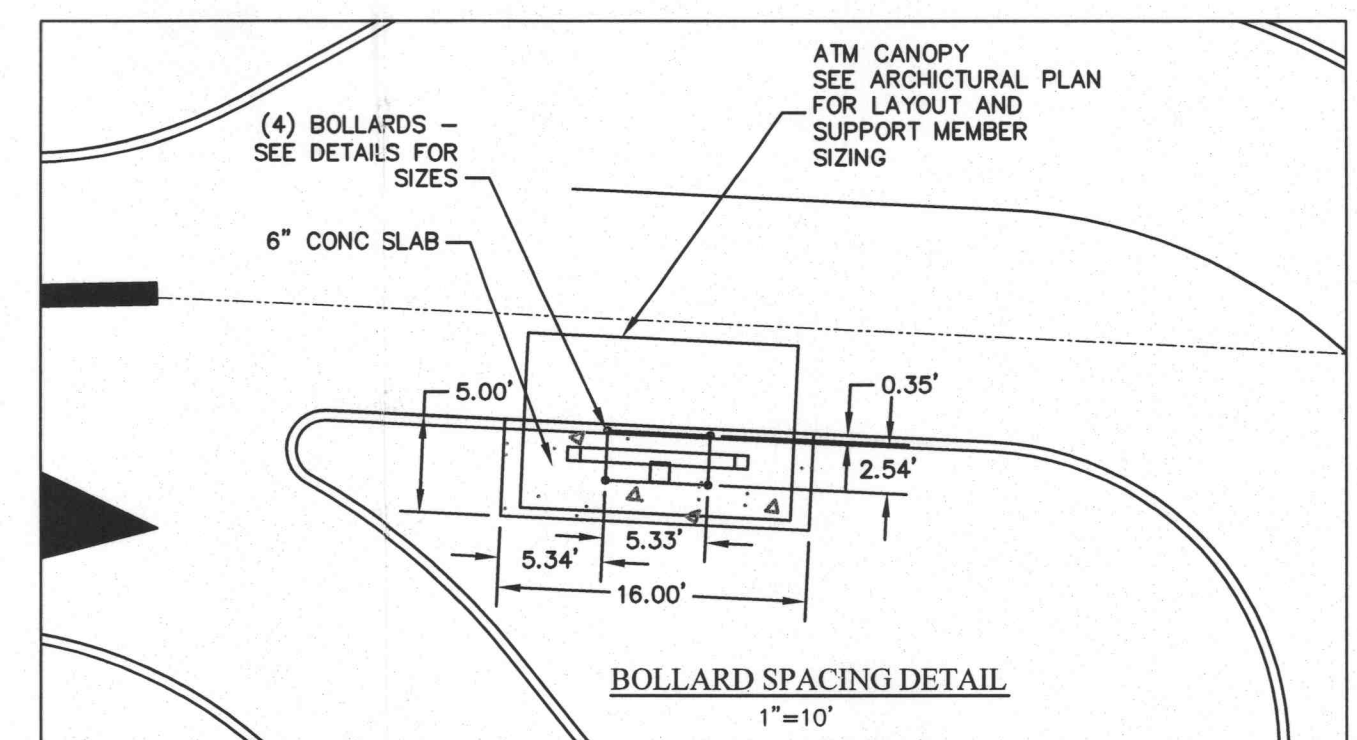

Professional Engineer's Seal
ZAVRADINOS & POLK, INC.
11-21-07

No.	Date	Revision/Issue
1	11-28-07	Per City Comment LTR, dated 11-16-07

The Professional Engineer's and/or Professional Land Surveyor's Seal is required on all drawings, documents displaying his/her signature and seal. Unauthorized use of plans and other documents is prohibited. All previously issued versions of this sheet are void. This sheet when used in any sheet that is part of a set of plans for this project, whether this statement appears on them or not.

First Community Credit Union - ATM DETAILS AND LANDSCAPING PLAN

Zavradinos & Polk, Inc.
engineers & surveyors
9045 S. Old Highway 04, Salt Charles, MO 63005-9724
TEL: (636) 946-5555 FAX: (636) 449-0168 www.zavradinos.com

Client: First Community Credit Union
17151 Chesterfield Airport Road
Chesterfield, MO 63005
Phone: 636-537-4407
Fax: 636-537-4484
Attn: Rick Strutman
rstrutman@firstcommunity.com

City/County Job No: 904.02; Approved 10-18-07
MSD P - BASEMAP
Proj Manager: R. Wischmann
rich@zavradinos.com
CAD Filename: 07077DITL.dwg
Original Issue Date: October 24, 2007
Project No. 07077 Sheet 3