

Scale:
Vert. 1"=10'
Hori. 1"=50'

FINAL SURVEY
DATE: _____
BY: _____
SURVEYED: _____
PLOTTED: _____
NOTE BOOK NO. _____
AREAS CHECKED: _____

ORIGINAL SURVEY
DATE: _____
BY: _____
SURVEYED: _____
PLOTTED: _____
NOTE BOOK NO. _____
AREAS CHECKED: _____

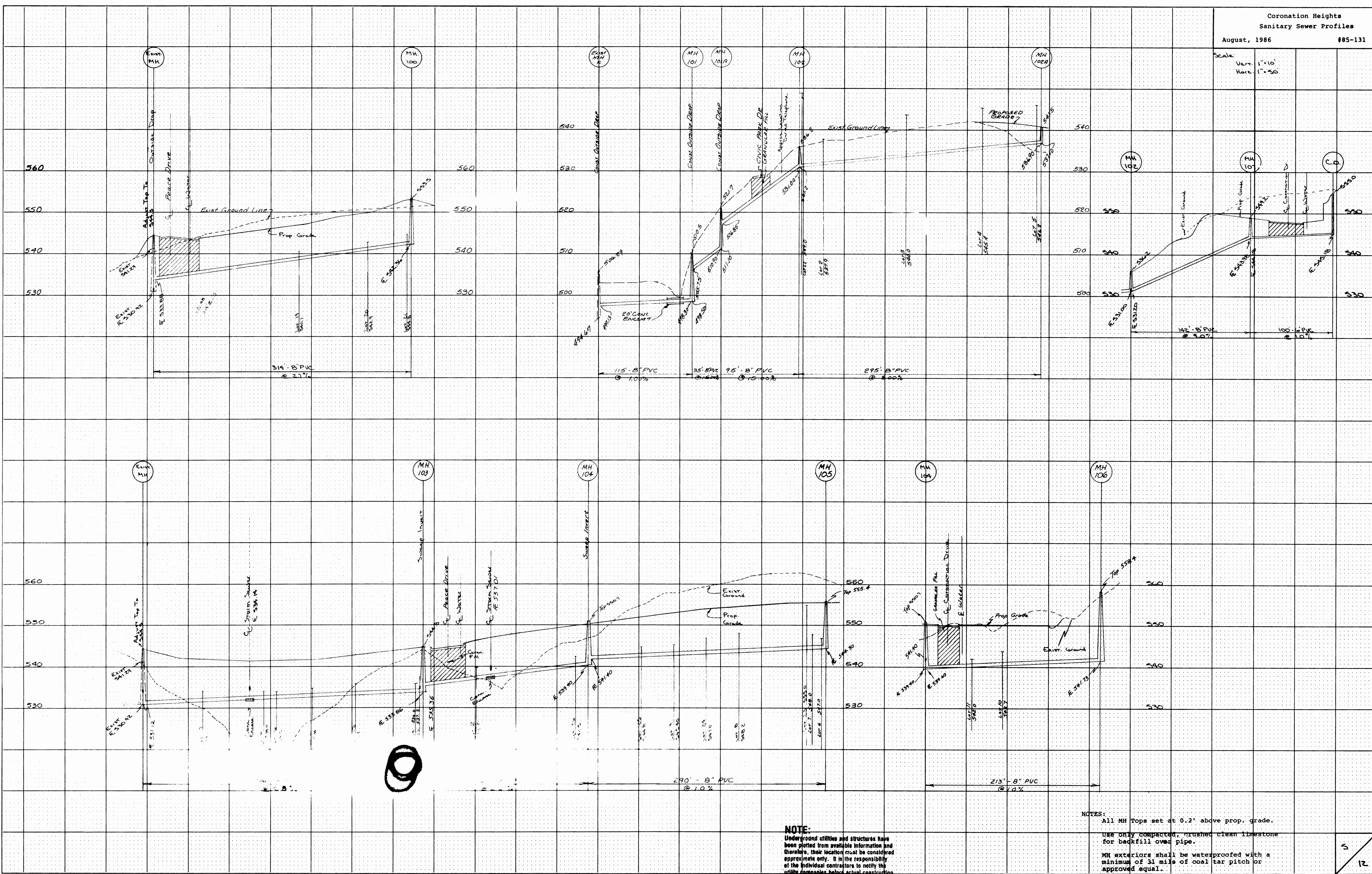

NOTE:
Underground utilities and structures have been plotted from available information and therefore, their location must be considered approximate only. It is the responsibility of the individual contractors to notify the utility companies before actual construction.

NOTES:
All MH Tops set at 0.2' above prop. grade.
Use only compacted, crushed clean limestone for backfill over pipe.
MH exteriors shall be waterproofed with a minimum of 31 mils of coal tar pitch or approved equal.