

Drawing name: K:\0212311 RHODES TRACT.dwg IMPROVEMENTS\2311Sanitary.dwg Plotted on Feb 14, 2006 - 6:28pm Plotted by: Igreen

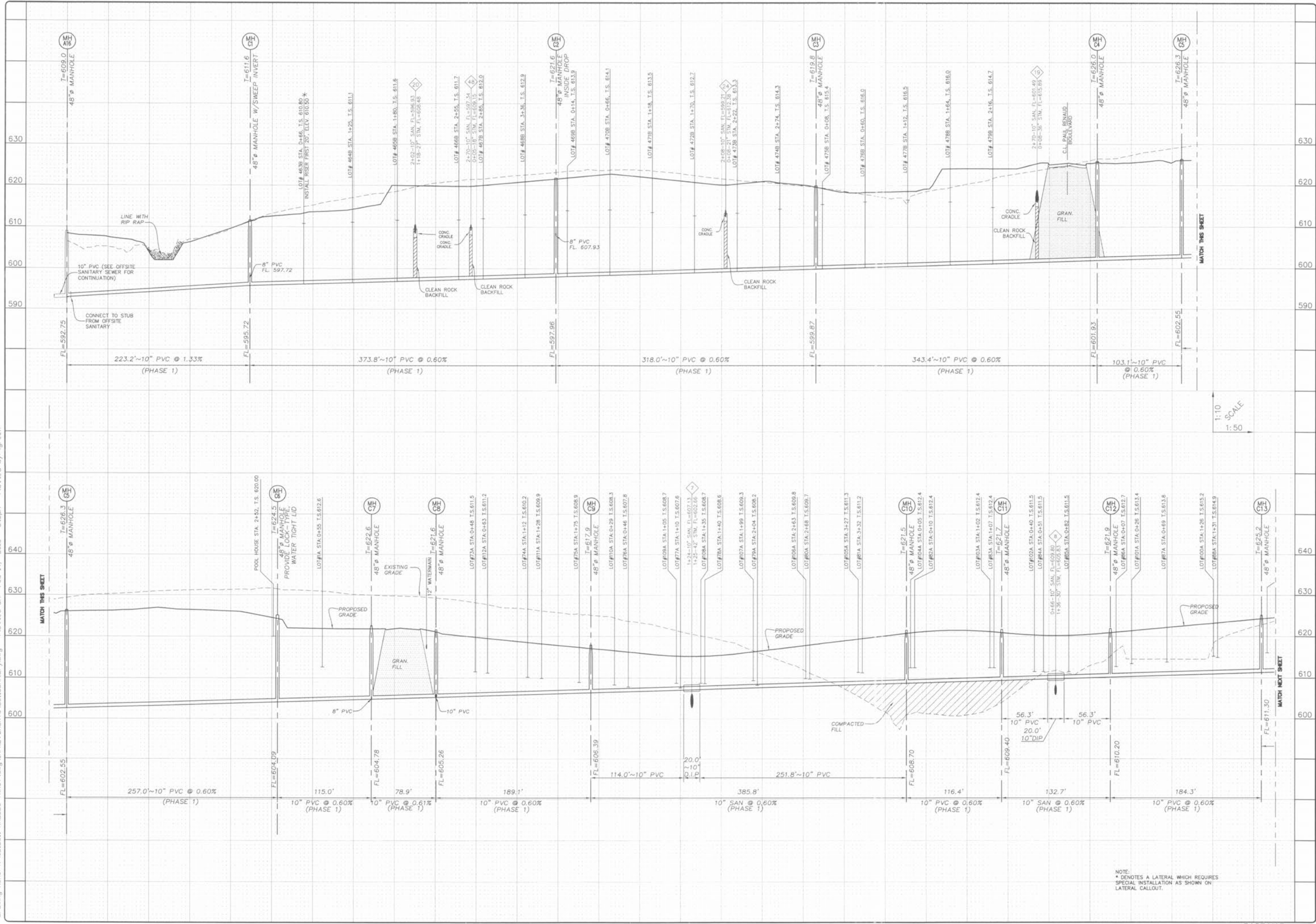

|       |                                     |
|-------|-------------------------------------|
| ISSUE | REMARKS/DATE                        |
| 10    | CITY COMMENTS/02-03-06              |
| 11    | CITY COMMENTS/02-15-06              |
| 3     | DCSD COMMENTS/09-28-05              |
| 4     | DCSD COMMENTS/10-13-05              |
| 5     | DCSD AND CITY COMMENTS/11-14-05     |
| 6     | CITY COMMENTS/11-22-05              |
| 7     | CITY COMMENTS/12-30-05              |
| 8     | WATER DISTRICT #7 COMMENTS/01-17-06 |
| 9     | DEVELOPER REVISIONS/01-24-06        |

PREPARED FOR:  
**STERLING CO.**  
 ENGINEERS & SURVEYORS  
 5055 NEW BAUMGARTNER ROAD  
 ST. LOUIS, MISSOURI 63129  
 (314) 487-0440 FAX 487-8944  
 E-Mail: Sterling@sterling-eng-survey.com

PROJECT: **COUNTRYSHIRE**  
 SHEET TITLE: SANITARY PROFILES

NO. **02 12 311**  
 M.S.D. SHEET  
 OF  
 5.2

BASE MAP